

USER MANUAL



NaviLink Lite™

Wi-Fi Remote Control System

ENG

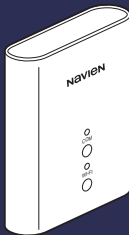

THE LEADER IN CONDENSING TECHNOLOGY

If your NaviLink requires service, you have several options for getting service, contact Technical Support at 1-800-519-8794 or on the website: www.navienc.com.

For warranty service, always contact Technical Support first.

TEL: 1-800-519-8794

FAX: 1-949-420-0430

Add: 20 Goodyear Irvine, CA 92618

This product can be used in the following countries: USA, Canada

FCC STATEMENT



This equipment has been tested and found to comply with the limits for a Class B digital device, pursuant to part 15 of the FCC Rules. These limits are designed to provide reasonable protection against harmful interference in a residential installation. This equipment generates, uses and can radiate radio frequency energy and, if not installed and used in accordance with the instructions, may cause harmful interference to radio communications. However, there is no guarantee that interference will not occur in a particular installation. If this equipment does cause harmful interference to radio or television reception, which can be determined by turning the equipment off and on, the user is encouraged to try to correct the interference by one or more of the following measures:

- Reorient, or relocate, the receiving antenna.
- Increase the distance between the equipment and receiver.
- Connect the equipment into an outlet on a circuit different from that to which the receiver is connected.
- Consult the dealer or an experienced radio/TV technician for help.

This device complies with part 15 of the FCC Rules. Operation is subject to the following two conditions:

- (1) This device may not cause harmful interference.
- (2) This device must accept any interference received, including interference that may cause undesired operation.

Any changes or modifications in construction of this device which are not expressly approved by the party responsible for compliance could void the user's authority to operate the equipment.

 The manufacturer is not responsible for any radio or TV interference caused by unauthorized modifications to this equipment. Such modifications could void the user's authority to operate the equipment.

FCC RF Radiation Exposure Statement

This equipment complies with FCC RF Radiation exposure limits set forth for an uncontrolled environment. This device and its antenna must not be co-located or operating in conjunction with any other antenna or transmitter.

“To comply with FCC FR exposure compliance requirements, this grant is applicable to only Mobile Configurations. The antennas used for this transmitter must be installed to provide a separation distance of at least 8 inches (20 cm) from all persons and must not be co-located of operating in conjunction with any other antenna or transmitter.”

FCC IDENTIFIER: P53-EMC3280

Canadian Compliance Statement

This device complies with industry Canada license-exempt RSS standard(s). Operation is subject to the following two conditions:

- (1) This device may not cause interference.
- (2) This device must accept any interference, including interference that may cause undesired operation of the device.

Cet appareil est conforme aux normes CNR exemptes de licence d'Industrie Canada. Le fonctionnement est soumis aux deux conditions suivantes :

- (1) cet appareil ne doit pas provoquer d'interférences et
- (2) cet appareil doit accepter toute interférence, y compris celles susceptibles de provoquer un fonctionnement non souhaité de l'appareil.

To reduce potential radio interference to other users, the antenna type and its gain should be so chosen that the equivalent isotropically radiated power (e.i.r.p) is not more than that permitted for successful communications.

Industry Canada Statement

Complies with the Canadian ICES-003 Class B specifications.

Cet appareil numérique de la classe B est conforme à la norme NMB-003 du Canada.

This device complies with RSS 210 of Industry Canada. This Class B device meets all the requirements of the Canadian interference-causing equipment regulations.

Cet appareil numérique de la classe B respecte toutes les exigences du Règlement sur le matériel brouilleur du Canada.

This radio transmitter (IC: 23507-EMC3280) has been approved by Industry Canada to operate with the antenna types listed below with the maximum permissible gain and required antenna impedance for each antenna type indicated. Antenna types not included in this list, having a gain greater than the maximum gain indicated for that type, are strictly prohibited for use with this device.

Le présent émetteur radio (IC: 23507-EMC3280) a été approuvé par Industrie Canada pour fonctionner avec les types d'antenne énumérés ci-dessous et ayant un gain admissible maximal. Les types d'antenne non inclus dans cette liste, et dont le gain est supérieur au gain maximal indiqué, sont strictement interdits pour l'exploitation de l'émetteur.

Important Safety Information

 The following Safety Alert Symbols are used in this manual. They are used to alert you to potential personal injury hazards. Obey all safety messages that follow this symbol to avoid possible serious injury or death. This Safety Alert Symbol precedes any safety message about risk of personal injury. It may also be accompanied by one of the following signal words.

If the information in these instructions is not followed exactly, unsafe operating conditions may result, causing property damage, personal injury or death.

Safety messages used in this manual

WARNING

Indicates a hazardous situation that if not avoided could result in death or serious injury.

CAUTION

Indicates a potentially hazardous situation that if not avoided could result in minor or moderate injury.

NOTICE

Indicates information considered important but not hazard-related (such as property damage).

⚠ WARNING

- **This device is designed for indoor use. Please install and use this device indoors.**
- **Do not disassemble or attempt to repair the device.**
 - You can damage the device and expose yourself to the risk of an electric shock.
 - Any attempt to disassemble or repair the device voids Navien's Limited Warranty. Navien is not responsible for damage or injuries caused by voiding the Navien's Limited Warranty.
- **Do not store flammable materials near the device.**
 - This may cause a fire or electric shock.
- **Do not handle the device with wet hands.**
 - This may result in an electric shock.
- **Do not clean the device with water or a damp cloth.**
 - You can damage the device and expose yourself to the risk of an electric shock.

Product Installation Information

Serial Number

Date Purchased

⚠ CAUTION

- **Use only Navien-approved accessories.**
 - Using third-party accessories, such as power adapters, cables, or antennas can damage the device or cause injury.
 - Navien is not responsible for damage or injuries caused by third-party accessories, such as power adapters, cables, or antennas.
- **When mounting the NaviLink Lite on a wall, make sure that the wall is strong enough to support the device.**
 - The device could fall if the wall is not strong enough and this can damage the device or cause injury.
- **Use suitable tools and appropriate force to install the NaviLink Lite.**
 - Using unsuitable tools or excessive force during installation can cause damage to the device.
- **Do not expose the device to direct sunlight or high temperatures for an extended period of time.**
 - Prolonged exposure to sunlight or extreme temperature can cause permanent damage to the device's internal components.
- **Avoid water and wet areas.**
 - This may damage the device's internal components.
- **The operating temperature of the device is 32 °F–104 °F (0 °C–40 °C).**
- **Do not use loose or damaged cables.**
 - This may result in a poor connection or cause the device to malfunction.
- **Use the antenna in the normal position.**
 - Avoid contact with the antenna while the NaviLink Lite is turned on.

Contents

Overview	11	Starting the NaviLink App	29
Included Items	11	Installing the app	29
Device Features.....	12	Registering for membership – create account.....	29
Installing the NaviLink Lite	15	Registering for membership – Owner....	31
Installing on a Navien Boiler/Water Heater	15	Registering product (product owner accounts only).....	32
Installing on a wall.....	16	Registering for membership - Member..	35
Connecting to Navien Boilers/ Water Heaters	18	Registering for membership – Installer .	39
Connecting to a single boiler/water heater.....	18	Deregistering/delegating the permission of a product owner member.....	40
Configuring the Connection Settings for Navien NPE and NPN Models.....	20	Adding an installer/servicer NaviLink....	42
Configuring the connection setting mode for NPE-2 models.....	22	Adding and deleting NaviLink (product owner accounts only).....	44
Configuring the Connection Settings for Navien NCB and NHB Models	23	Changing NaviLink router (product owner accounts only).....	49
Configuring the Connection Settings for Navien NFB, NFB-H, NFC, NFC-H, and NCB-H models.....	26	Troubleshooting.....	53
Connecting to a Network	28	Appendix	54
		Specifications.....	54

Overview

The NaviLink Lite is an indoor converter for remotely controlling and monitoring boilers or water heaters via a smartphone app. A boiler or water heater can be connected to a NaviLink Lite.

- Note**
- Hardware or software specifications of the NaviLink Lite or the contents of this manual may be changed without prior notice if the NaviLink Lite's functions are upgraded.
 - NaviLink Lite functions can be limited by the operating environment.

Included Items

Open the packaging and ensure that the following items are provided before starting the installation.



NaviLink Lite



NaviLink Lite cable



Screws and anchors



User manual

Device Features

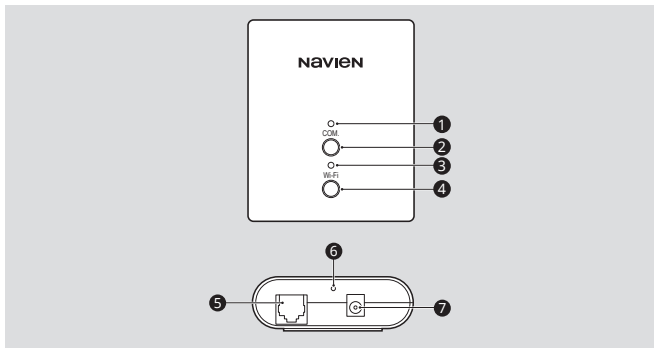

Note Depending on the latest specifications, the actual appearance of the NaviLink Lite may differ from the illustration.

No	Part name	Description
①	COM LED	<ul style="list-style-type: none"> • The green light blinks when a NaviLink Lite cable is connected to the communication port and the NaviLink Lite and boilers/ water heaters normally communicate. • The red light is turned on when the communication stops for 10 seconds or more. • The red light blinks three times with the Wi-Fi LED when you press and hold the Factory Reset button for more than 10 seconds.
②	Unused	N/A
③	Wi-Fi LED	<ul style="list-style-type: none"> • The red light is turned on when the NaviLink Lite is disconnected from a Wi-Fi network. • The blue light blinks when the NaviLink Lite enters Wi-Fi pairing mode. • The Wi-Fi strength is displayed when the NaviLink Lite is connected to a Wi-Fi network: <ul style="list-style-type: none"> – -69 or higher: Solid blue, indicating a great signal strength. – -70—-79 dBm: Solid green, indicating that the signal strength is good enough for the data traffic. – -80—-89 dBm: Solid yellow, indicating an insufficient signal strength. – -90 dBm or lower: Solid purple, indicating that a weak signal strength. • The red light blinks three times with the COM LED when you press and hold the Factory Reset button for 10 seconds or more.

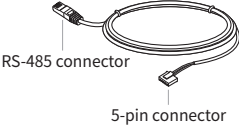
No	Part name	Description
4	Wi-Fi button	Press and hold the button for more than 3 seconds to start Wi-Fi pairing mode.
5	Communication port	<p>A NaviLink Lite cable is connected to the port for communication with boilers or water heaters.</p> <ul style="list-style-type: none"> The NaviLink Lite cable's RS-485 connector should be connected to the communication port.  <p>The diagram shows a coiled cable. One end has a black connector labeled 'RS-485 connector'. The other end has a white 5-pin connector labeled '5-pin connector'.</p>
6	Factory Reset button	Press and hold the button for more than 10 seconds to factory reset the NaviLink Lite.
7	Power port	The DC 12 V power adapter (sold separately) is connected to the power port.

Installing the NaviLink Lite

You can install the NaviLink Lite on a boiler or water heater unit using the magnet plates affixed on the rear, or on a wall using the supplied screws and anchors.

NOTICE

This device is designed for indoor use only. Please install and use this device indoors.

Installing on a Navien Boiler/Water Heater

With the magnet plates on the rear, you can attach the NaviLink Lite to the boiler or water heater case.

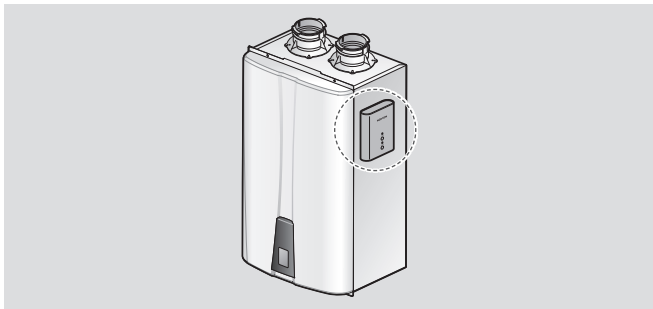

Installing on a wall

You can install the NaviLink Lite on a wall using the supplied screws and anchors.

- 1 Drill holes which fit the keyhole of the NaviLink Lite into the selected wall, and then insert the plastic anchor into the hole.
 - Ensure the plastic anchors are inserted to their full depth in the holes.
- 2 Insert the screws into the plastic anchors, and screw them in a clockwise direction.
- 3 Place the backside keyhole on the NaviLink Lite to the screw and push the NaviLink Lite downward until you hear a click for the secure attachment.

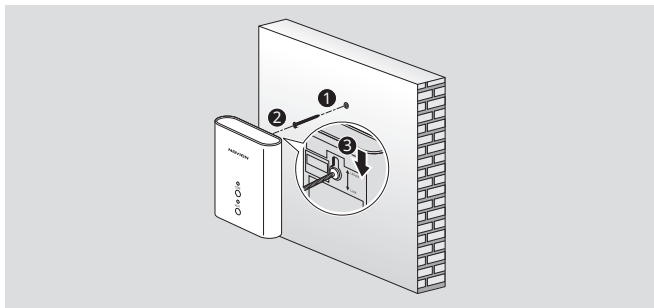

-
- Note**
- When the NaviLink Lite is connected to a Wi-Fi network, check the following conditions to ensure the best network connection status.
 - To secure the best network signal quality and the maximum communication range, install the NaviLink Lite in an area where there are no shadows and obstacles that can block the network signal.
 - Do not place the NaviLink Lite close to metallic objects and do not expose the NaviLink Lite to direct sunlight.
 - Do not place the NaviLink Lite near 802.11g or 20 MHz Wi-Fi devices, computers or electronic devices using 2.4 GHz (e.g. Bluetooth devices, wireless or mobile phones, fluorescent lamps, microwaves, refrigerators, etc.), or industrial equipment (e.g. transformers, large motors, etc.). This may damage the NaviLink Lite or other devices, or cause them to malfunction, due to interference.

Connecting to Navien Boilers/Water Heaters

You can remotely control and monitor boilers or water heaters by connecting them to the Navilink Lite communication port and setting parameters on the front panel of boilers or water heaters.

Connecting to a single boiler/water heater

You can connect the Navilink Lite and a boiler or water heater via the Navilink Lite cable.

- 1 Connect the RS-485 connector of the Navilink Lite cable to a communication channel port.
- 2 Connect the 5-pin connector of the Navilink Lite cable to the boiler or water heater.

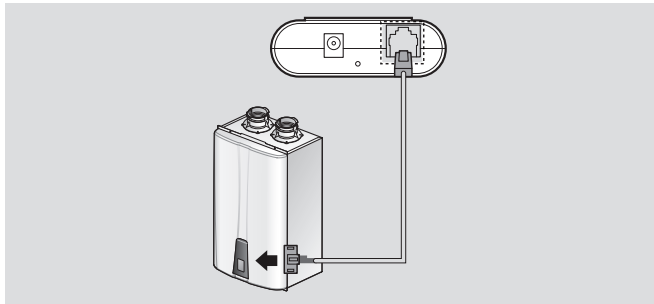

You can also download the full-version User Manual from <https://www.navieninc.com>.

Note



- Only Navien boilers and water heaters can operate through Navilink Lite.
- You can connect a single boiler or water heater unit to the Navilink Lite communication port.
- The maximum communication range between the Navilink Lite and a connected boiler's or water heater's front panel is 164 ft (50 m).
- If the Navilink Lite cable length is too short, use CAT5 couplers, direct LAN cables, and Navien Ready-Link cables (optional) to extend the Navilink Lite cable.
- The usage data of boilers or water heaters is saved normally, when the Navilink Lite communicates with the Internet server and the local time of where the Navilink Lite is installed is synchronized on the Navilink, after you join and register your Navilink Lite on the Navilink smartphone app. (p. 28)
- When the power supply is unstable or electrical shock occurs at the Navilink Lite, the usage trend data may not be saved or can be deleted.

Configuring the Connection Settings for Navien NPE and NPN Models





Note Adjusting this setting is required for single NPE or NPN units ONLY. Cascade systems cannot be linked with NaviLink. Do not adjust the following parameters for cascade systems.

You can configure the NaviLink connection setting mode from the front panel of Navien NPE and NPN water heaters connected to the NaviLink.

- 1 On the front panel, press the Power button to turn off the water heater.
- 2 Enter the R&D information menu by pressing the Up (+) button three times, the Down (-) button three times, and then the Up (+) button four more times.
- 3 Use the Up (+) or Down (-) buttons to move to “2.PAR” (Parameter information mode), and then press the Info button.

Display	Description
	Technical information
	Parameter information

- 4 In the Parameter information time mode, use the Up (+) or Down (-) buttons to select "P.18." Then, press the Info button to enter the NaviLink connection setting mode.
- 5 In the NaviLink connection setting mode, use the Up (+) or Down (-) buttons to change the value and press the Info button to set to the desired mode.

Display	Description
	NaviLink connection setting mode
	Cascade connection setting mode or connection setting unavailable
	NaviLink connection enabled (ON)
	NaviLink connection disabled (OFF)

Configuring the connection setting mode for NPE-2 models

Note Adjusting this setting is required for single NPE-2 units ONLY. Cascade systems cannot be linked with NaviLink. Do not adjust the following parameters for cascade systems.

- 1 Press the Menu button (M) and the Back button (↶) simultaneously for 3 seconds, and then select “3. Application Setting.”

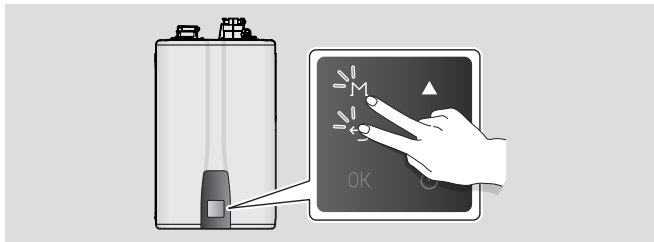

- 2 Press the Up (▲) or Down (▼) buttons to move to 1.NaviLink, and then set the desired mode.

Configuring the Connection Settings for Navien NCB and NHB Models

Note Adjusting this setting is required for single NCB or NHB units ONLY. Cascade systems cannot be linked with NaviLink. Do not adjust the following parameters for cascade systems.



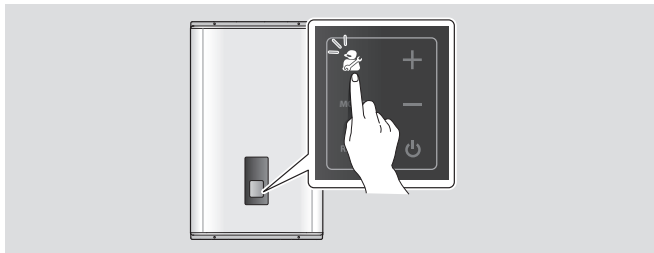

You can configure the NaviLink connection setting mode on the front panel of NCB and NHB boilers connected to the NaviLink.

- 1 Press and hold the Diagnostic button for 5 seconds to enter the Parameter mode.



- 2 Press the Up (+) or Down (-) buttons to move to "1.PAR" (Parameter Setting mode), and then press the Mode button. You will be asked to enter a password ("PASS" is displayed). The factory default password is "1234."

- 3 Press the Mode button and enter your 4-digit password. Use the Up (+) or Down (-) buttons to increase or decrease numbers and the Diagnostic button to move between digits.
- 4 When you are done, press the Mode button.
- 5 Press the Up (+) or Down (-) buttons to move to the X. parameter setting for NCB models and the 9. parameter setting for NHB models, and then press the Mode button to enter Parameter Edit mode.
- 6 Press the Up (+) or Down (-) buttons to change the parameter value.

Display		Description
NCB models (X. parameter)	NHB models (9. parameter)	
		NaviLink connection enabled (ON)
		NaviLink connection disabled (OFF)

-
- 7 When you are done, press the Mode button to save the settings.
 - 8 To exit the Special Parameter mode, press the Reset button twice.

 CAUTION



Parameters must be set by a qualified professional with an extensive understanding of the boiler system. Setting parameters improperly may lead to property damage or injury.

Configuring the Connection Settings for Navien NFB, NFB-H, NFC, NFC-H, and NCB-H models

Note Adjusting this setting is required for single NFB, NFB-H, NFC, NFC-H, and NCB-H units **ONLY**. Cascade systems cannot be linked with NaviLink. Do not adjust the following parameters for cascade systems.

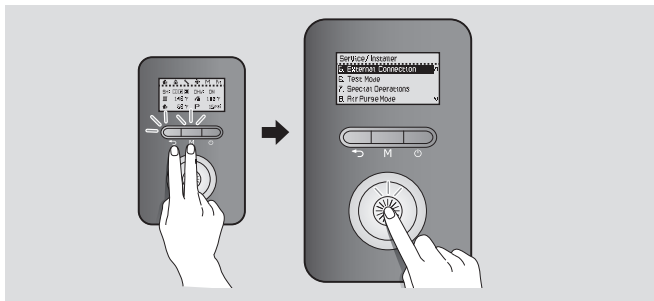
To view and configure the external network connection, press the Back button (↩) and the Menu button (M) simultaneously for 3 seconds, and then select “5. External Connection.”



Rotate the Command dial () to switch between the parameters or to increase/decrease setting values. Press the Command dial () to select a parameter or to confirm after making changes.

Press the Back button () to return to the previous screen or menu.

Item	Description
NaviLink Connect	Turn on or turn off the remote control capabilities via the NaviLink connection. <ul style="list-style-type: none">• Setting range: On/Off• Default: Off

Connecting to a Network

The NaviLink Lite supports a network connection via Wi-Fi for its remote control and monitoring functions. Supply power to the NaviLink Lite by connecting it to a boiler or water heater via a NaviLink Lite cable. (If power is not supplied to the NaviLink Lite via the NaviLink Lite cable, you have to use a power adapter sold separately.) Then, the NaviLink Lite is ready to be connected to a network.

Note

- The NaviLink Lite can be connected to a 2.4 GHz router.
- The NaviLink Lite supports connection with up to 11 router channels.
- The NaviLink Lite supports WEP, TKIP, and TKIP/AES authentication types. Other Wi-Fi authentication types or Wi-Fi connections compatible with non-standard Wi-Fi authentication types are not supported.
- The network connection quality of a router can be determined by the operating environment.
- When NaviLink Lite is connected to a Wi-Fi network, select a location referring to the Wi-Fi strength indicator LED.
- Basements and mechanical rooms may have poor wireless signals.

Starting the NaviLink App

Installing the app

You can download the NaviLink app by searching “NaviLink” in the Google Play Store or Apple App Store.

Once the download is complete, start the app.



[Google Play Store]



[Apple App Store]

Registering for membership – create account

- 1 On the main screen of the app, tap Sign up to create an account.
 - To change the router in order to change the device’s network for an account that is already registered, see *Changing NaviLink router (product owner accounts only)* on page 49.
 - You can register up to 4 accounts per NaviLink. To register a NaviLink already registered with a Product Owner account, see *Registering for membership - Member* on page 35.

- You can register up to 10 NaviLink/NaviLink Lite devices per Product Owner account. To add a new NaviLink/NaviLink Lite, see *Adding and deleting NaviLink (product owner accounts only)* on page 44.



2 After creating an account, verify your account via email.

- Verify your email to complete the email verification, and return to the app and press **Done**.
- If you do not receive the email, check your trash or spam folder.

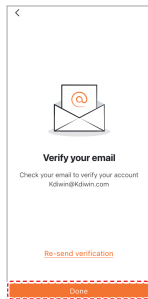
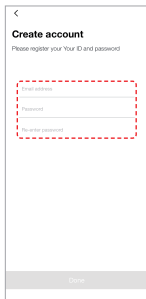

Registering for membership – Owner

- 1 Tap **Owner** on the Membership Type screen after signing up.
 - The owner is the member who owns the NaviLink/NaviLink Lite device. If you are already registered as a NaviLink/NaviLink Lite Owner, see *Registering for membership - Member on page 35*.

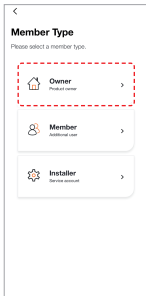

- 2 Enter the user information. After entering user information, tap **Done** to complete the Owner registration.
 - After completing the owner registration, you will be taken to the Select Product screen. See *Registering product (product owner accounts only) on page 32* to complete your product registration. You can use the NaviLink app when the product registration is completed.

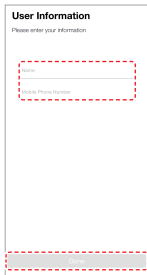

Registering product (product owner accounts only)

- 1 Select the type of Navilink you want to register.
 - This user guide only describes registration for the Navilink Lite.



- 2 Enter pairing mode on your Navilink Lite. Tap **Product Search** after entering pairing mode.
 - If your smartphone's Bluetooth and location information access is not allowed, set it to the allowed status. To register a product, it must be set to the allowed status during product registration.

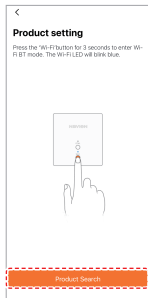

3 Select the searched NaviLink from the NaviLink list.

- If there is only one NaviLink found, it will automatically connect and move to the Router setting screen.
- If there is no NaviLink found, check the pairing status of the NaviLink Lite and tap **Product Search**.

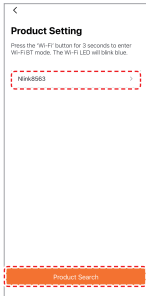

4 Select a router to connect the NaviLink Lite → enter the router's password → tap **Done**.

- If the router does not appear on the list, refresh the router list.
- If the password has not been set, select the list and connect to the router.



5 When the router setting for the NaviLink Lite is completed, it moves to the Product Location screen. Move the pin on the map to specify the location where the Navilink Lite is currently installed.

- If access is not granted to your smartphone's Bluetooth and location information, set it to the allowed status. To register a product, it must remain allowed during product registration.
- After checking the address displayed at the top, tap **Next**.



6 Enter the NaviLink/NaviLink Lite information, then tap **Done**.

- State and City information cannot be edited, only Address information can be edited.

Product Registration
Please enter the product information.

Product Name

Product Type

California

Irvine

20 Goodyear

Installer/Serviceur Email

Installer/Serviceur Cell Phone

Done

- 7 You will be taken to the Sign-up complete screen after you finish entering the device information. Tap **Start** to control the NaviLink device from the NaviLink app.

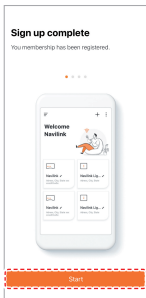

Registering for membership - Member

[Using your Owner Account]

- 1 Proceed after completing the steps in *Registering for membership – create account*. Sign in with your Owner account and tap the Menu button (☰) to enter the menu.

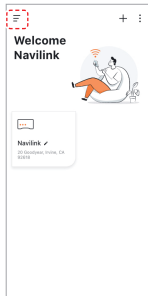

2 Select **Manage Members**.

- Manage Members can only be viewed with the Owner account.

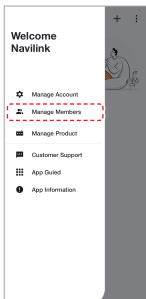

3 Tap **+ Invite Members** to move to the Invite Members screen.

- In Manage Members, you can view the current member status, add members, or delete members.
- You can register up to 4 accounts per Owner account.

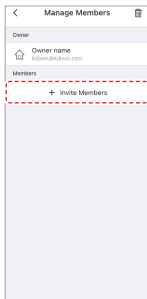

- 4 Enter the account email address to be added and tap **Confirmation**.
- After adding the account, you can check the current member's account addition status in Manage Members.
 - Inviting a member will be complete if the verification on the additional member's account is completed within the indicated expiration date and time.

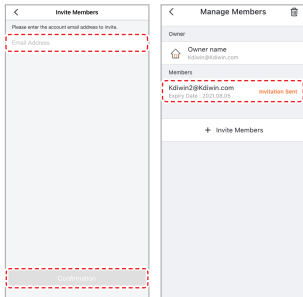

[Member Side]

- 5 Check the invitation email in your member account.
- If you do not receive the mail, check your trash or spam folder.

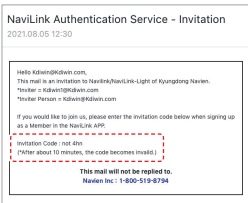

- 6 Complete the account registration steps in *Registering for membership* – create account on page 29 and select **Member** on the member type selection screen.
- The Member is someone who will share the NaviLink/NaviLink Lite with the Owner. To register a new NaviLink/NaviLink Lite, see *Adding and deleting NaviLink (product owner accounts only)* on page 44.

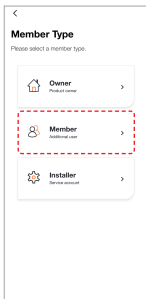

- 7 Enter the invite code and tap **Confirmation**.

- You can check the invite code in the verification email.
- If the validity time of the verification code expires, the verification will not be completed.

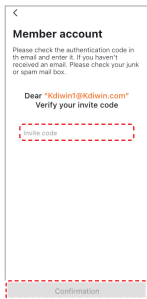

- 8 Enter the user information and tap **Done** to complete the member account registration. After completing the account registration, tap **Start** to start the NaviLink app.

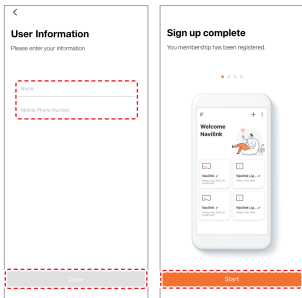

Registering for membership – Installer

- After registering a member account, tap **Installer** on the Member Type screen of the app.
 - The Installer member account is an account only for NaviLink/ NaviLink Lite installers. After signing up for an account, you can check the device by adding an Installer account to the Owner account. See *Installer Settings on page 43*.

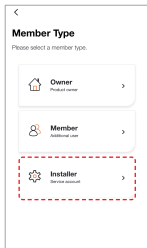

- 2 Enter the user information and tap **Done** to complete the registration of the Installer account. Then, tap **Start** to launch the NaviLink app.

User Information
Please enter your information

Name
Mobile Phone Number
Gender

Done

Sign up complete
Your membership has been registered.

Start

Deregistering/delegating the permission of a product owner member

- 1 On the main screen of the app, tap the Menu button (☰) after logging in to the Product Owner member account.

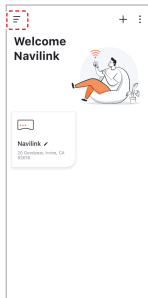

2 Select **Manage Account** → **Deregistration**.

- If the account is not registered, a pop-up window will appear asking whether to deregister without transferring permissions.

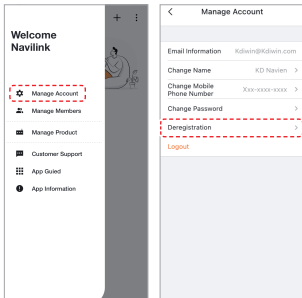

3 Select the member account to receive the permissions of the Product Owner member, and tap **Confirmation**.

- Members/Installer members will be deregistered without transferring permissions.
- When deregistration is complete, you will be taken to the login screen.



Adding an installer/servicer NaviLink

- 1 On the main screen of the app, log in using the Product Owner member account.
 - You can set up an Installer/ Servicer member permission to access NaviLink from the Product Owner account.



- 2 Select the Menu button (☰) → **Manage Product**.

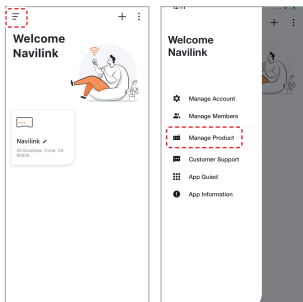

3 Select a device to register an Installer/ Servicer account from the registered product list and select **Installer Settings**.

- You can designate Installer/ Servicer member for each NaviLink connected to the account.
- You can only view NaviLink information in the Installer/ Servicer account and the control feature is not supported.

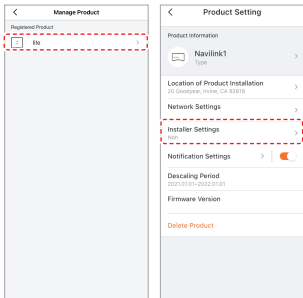

4 In the installer settings menu, tap **+ Register the installer** to move to the Installer registration screen.

- To deregister an Installer account, tap **Delete**.



Adding and deleting NaviLink (product owner accounts only)

- 1 On the main screen of the app, log in using the Product Owner member account.
 - You can use the feature to add and delete additional NaviLinks/ NaviLink Lite devices in the Product Owner account.



- 2 Tap + to start adding NaviLink Lite.
 - You may register up to 10 NaviLink Lite devices.
 - You can view the registered devices in the Member or Installer account connected to the Owner account.
 - You can add a device by pressing the + button → **Add Product**.

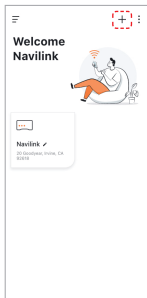

- 3 Select the type of Navilink to register.
- This user guide only describes the Navilink Lite registration.



- 4 Change NaviLink Lite to pairing mode.
- Tap **Product Search** after entering pairing mode.
- If access to your smartphone's Bluetooth and location information access is not granted, set it to the allowed status. To register a product, it must be set to the allowed status during product registration.

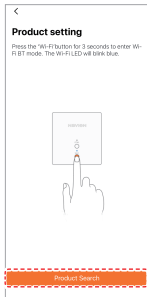

5 Select the NaviLink from the NaviLink list.

- If only one NaviLink is found, it will automatically connect and move to the Router Setting screen.
- If no NaviLink is found, check the pairing mode status of the NaviLink Lite and tap **Product Search**.



6 Select a router to connect the NaviLink Lite → enter the router's password → tap **Done**.

- If the router does not appear on the list, refresh the router list.
- If the password has not been set, select the list and connect to the router.



7 When the router setting of NaviLink Lite is completed, it moves to the Product Location screen. Move the pin on the map to specify the location where the NaviLink Lite is currently installed.

- If access to your smartphone's Bluetooth and location information access is not granted, set it to the allowed status. To register a product, it must be set to the allowed status during product registration.
- After checking the address displayed at the top, tap **Next**.



8 Enter the NaviLink/NaviLink Lite information and tap **Done**.

- State and City information cannot be edited, only the Address (Street) information can be edited.
- When a device is added, you will be taken to the gateway screen. You can view the added devices in the product list.

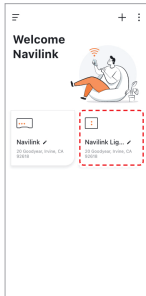
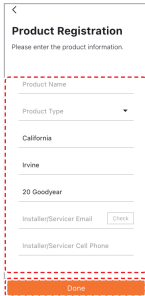

9 To delete a device, select the + button → **Delete Product**.

- You cannot delete a device if only one device is registered.
- When a device is deleted, the member account registered to the owner account and the installer account registered to the device will also be deleted.

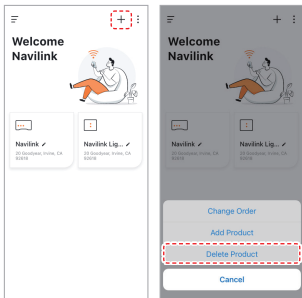

10 Select the deleted NaviLink/NaviLink Lite and tap **Save**.

- When finished deleting a device, you can verify if the device has been deleted on the main screen.

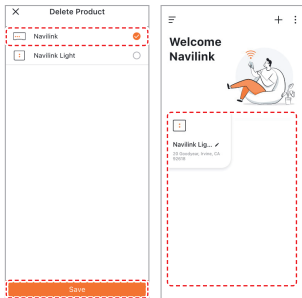

Changing NaviLink router (product owner accounts only)

- 1 Log in using an Owner account.
 - You can change the NaviLink/ NaviLink Lite router only from the Product Owner account.

NaviLink

E-mail address

Password

[Forgot ID](#) | [Forgot Password](#) | [Sign Up](#)

[Sign In](#)

- 2 Select the Menu button (☰) → **Manage Product**.

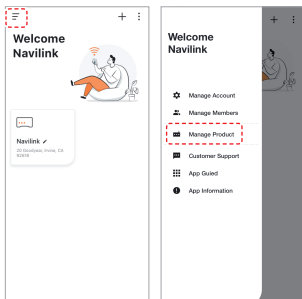

- 3 Tap the desired device from the registered product list and tap **Network Settings** to start connecting to a router.

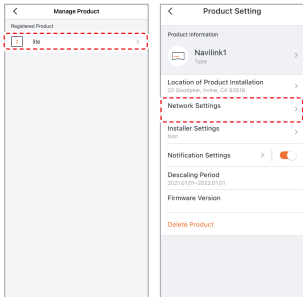

- 4 Enter pairing mode on the NaviLink Lite by pressing the Wi-Fi button (shown below) down for 3 seconds. The LED light will blink BLUE once the pairing is completed. Tap **Product Search** after entering pairing mode.

- If access to your smartphone's Bluetooth and location information access is not granted, set it to the allowed status. To register a product, it must be set to the allowed status during product registration.

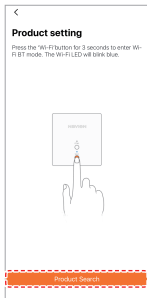

- 5 Select a router to connect the NaviLink Lite → enter the router's password → tap **Done**.
- If the router does not appear on the list, refresh the router list.
 - If the password has not been set, select the list and connect to the router.

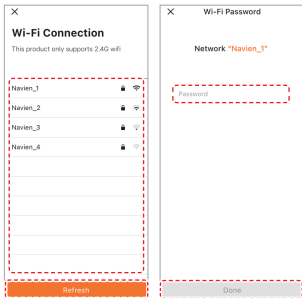

- 6 When the NaviLink Lite is successfully connected to a router, you will be taken to the main screen.

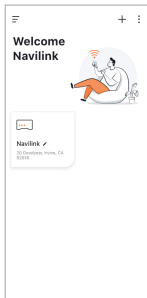

- 7 The NaviLink Lite and app is now ready for use. The user can adjust temperature settings, monitor the system status and energy usage, and also receive error code push notifications.



Troubleshooting

Situation	Suggested remedies
Cannot connect the NaviLink Lite to a router via Wi-Fi	<ul style="list-style-type: none">• The router may be out of range.<ul style="list-style-type: none">– Place the NaviLink Lite and the router closer together.– Change the channel settings of the router.• Authentication may have failed after the NaviLink Lite and the router have connected.<ul style="list-style-type: none">– Check the WLAN security settings.– Reset the Wi-Fi settings in pairing mode by pressing and holding the Wi-Fi button for more than 3 seconds.
Cannot detect an available router	<ul style="list-style-type: none">• Ensure the router is operating normally.• Ensure that the SSID and password of the router are set correctly.
Cannot connect with boilers or water heaters, or check the status information	<p>The green light of the COM LED blinks when the NaviLink Lite and boilers/water heaters are communicating normally.</p> <ul style="list-style-type: none">• Check the connection status of the NaviLink Lite cable connected to the NaviLink Lite and boilers/water heaters.• When a single boiler or water heater unit is connected to the NaviLink Lite, ensure the parameter is configured correctly.

Appendix

Specifications

Wi-Fi	
Specification	2.4 GHz, IEEE Std. 802.11b/g/n (20 MHz) & 802.11n (40 MHz)
Frequency range	2,412 MHz–2,462MHz for 802.11b/g/n (20 MHz)
	2,422 MHz–2,452MHz for 802.11n (40 MHz)
Channel	11 channels for 802.11b/g/n (20 MHz)
	7 channels for 802.11n (40 MHz)
Modulation type	802.11b: DSSS/CCK
	802.11g/n: OFDM
Max. transmit power	16.23 dBm
Bluetooth	
Device type	Bluetooth V5.0
Frequency range	2,402MHz-2,480 MHz
Channel	40 channels for Bluetooth DTS
Max. transmit power	7.544 dBm
Wi-Fi/BT Module FCC/IC	
FCC ID	P53-EMC3280
IC ID	23507-EMC3280

General	
Ports	RS-485 communication RJ45 ports
LEDs	Wireless 2.4 GHz, RS-485
NaviLink Lite power rating	12 VDC, 0.15 A
Safety & Emissions	FCC, IC
Environment	
Temperature	Operating: 32 °F–104 °F (0 °C–40 °C) Storage: -40 °F–158 °F (-40 °C–70 °C)
Humidity	Operating: 10 %–90 % RH, Non-condensing Storage: 5 %–90 % RH, Non-condensing
Physical specifications	
Dimensions (W X H X D)	3.22 in X 3.52 in X 0.98 in (82 mm X 89.5 mm X 25 mm)
Weight	Whole package: 7.9 oz (224 g) NaviLink Lite unit: 2.82 oz (80 g)
Smartphone	
OS version	Android OS 4.0 or later iOS 8.0 or later (iPhone 5S or later)

LIMITED WARRANTY NAVIEN, INC.

Navien products come with a limited warranty covering parts. The following warranty periods begin to run from the date of original installation. The date of original installation must be provided to Navien, and upon request, proof of the original installation date must also be provided to Navien. When the product is installed in a new construction, the commencement date shall be dated upon which the end-user takes title to the property.

APPLICABLE WARRANTY PERIOD

Period of Coverage	
All other parts and components	3 years

Warranty claim procedures

To obtain warranty repair service, the end user or homeowner must contact the original installer of your Navien product. If the original installer cannot be identified, the end user or home owner may contact Navien's Technical Administration Department at (800) 519-8794. Proof of purchase is required to obtain warranty service.

Warranty service

At its option, Navien will replace the defective component (part), in accordance with the terms of this Limited Warranty, if it fails in normal use and service during the applicable warranty period identified above. The replacement component must be Navien original factory component. Navien, at its sole discretion, may replace the product with a new or refurbished product of comparable quality and design. The replacement component or product will be warranted only for the unexpired portion of the original component's applicable warranty period. Payment for labor in completing the warranty service is subject to Navien's prior written approval and shall be subject to Navien's schedule of approved labor allowances.

Warranty exclusions

Navien's Limited Warranty shall be void in the event of an occurrence of any of the following:

- Improper installation, failure to install in strict compliance with the Installation & Operation Manual procedures, installed by a non-licensed installer, and installation in violation of applicable rules, laws or building codes.
- Product purchased through the internet, other e-commerce channels, or any installer that obtained the product from a supplier or distributor not authorized by Navien.
- Failure to perform regular maintenance, misuse, operation at settings other than those recommended or specified, noncompliance with instructions or guidelines set forth in the User's Information Manual.
- Modification or alteration of the product in any manner, including but not limited to, removal of any component or part, addition of any non-approved components, relocating or moving the product from its original installation site, or any accidental or intentional damage to the Product.

-
- Installer's failure to fully comply with the warranty service and return policy procedures previously provided to installer and as is available on Navien's website. Such policies include but are not limited to the installer's failure to first contact Navien Technical Support while in front of the product for purposes of trouble shooting the identified problem or issue.
 - Any damage, malfunction or failure caused by abuse, negligence, alteration, accident, fire, flood, freezing, wind, lightning and other acts of God.
 - Operating, using or storing the NaviLink Lite in a corrosive or contaminated atmosphere or environment.
 - Installation at any location outside the United States and Canada.

Other Terms: This Limited Warranty is subject further to the terms and conditions set forth herein and as may be further specified in the terms and conditions page located on Navien's website at www.navien.com. WITH THE EXCEPTION OF THIS LIMITED WARRANTY, NAVIEN DISCLAIMS ANY OBLIGATION OR LIABILITY WITH RESPECT TO THE PRODUCTS OR THEIR SALE AND USE, AND NAVIEN NEITHER ASSUMES NOR AUTHORIZES THE ASSUMPTION OF, ANY OBLIGATION OR LIABILITY IN CONNECTION WITH THE PRODUCTS. THIS DISCLAIMER INCLUDES ANY OTHER WARRANTIES, EXPRESS, IMPLIED OR STATUTORY RESPECTING THE PRODUCTS OR ANY PARTS OR COMPONENTS THEREOF, INCLUDING, BUT NOT LIMITED TO, ANY IMPLIED WARRANTY OF MERCHANTABILITY OR FITNESS FOR A PARTICULAR PURPOSE. Navien's total liability for any claim arising hereunder shall not exceed the purchase price which you paid for the product. NAVIEN SHALL NOT IN ANY EVENT BE LIABLE FOR INDIRECT, SPECIAL, CONSEQUENTIAL OR LIQUIDATED DAMAGES OR PENALTIES, INCLUDING CLAIMS FOR LOST REVENUE, PROFITS OR BUSINESS OPPORTUNITIES, EVEN IF NAVIEN HAD OR SHOULD HAVE HAD ANY KNOWLEDGE, ACTUAL OR CONSTRUCTIVE, OF THE POSSIBILITY OF SUCH DAMAGES.



Navieninc.com



THE LEADER IN CONDENSING TECHNOLOGY