

Figure 1401



NFP140107A

FEATURES & BENEFITS

- Size: 4" IPS Outlet, (2) 2-1/2" NST Inlets
- UL/FM approved
- Available in 90 degree pattern
- Single clapper design with brass seats and brass body
- Pin lug design on inlets

INSTALLATION

Before installation, make sure the proper identification sign has been installed on the receiving nipple (if required). Apply a suitable pipe thread sealant to the male threads of the receiving nipple. Tighten FDC one full turn past hand tight and ensure the FDC is aligned according to requirements. **DO NOT OVERTIGHTEN.** Overtightening may cause cracks or deformities in the valve body which could lead to failure.

DIMENSION (INCHES)

| PART # | CONFIGURATION | THREAD |
|------------|---------------|---------------------------|
| NFP140107A | 90 | 4" MNPT x 2-1/2" FNST (2) |



*Not for use in potable systems

FIRE DEPARTMENT CONNECTION

Figure 1401

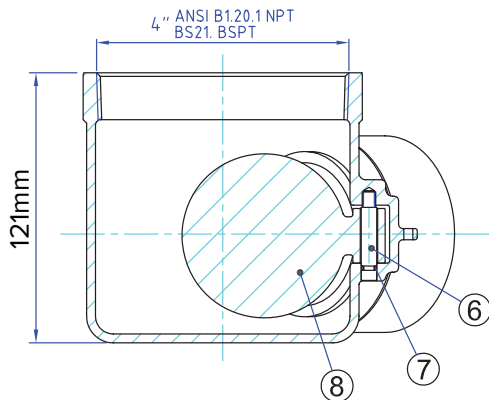
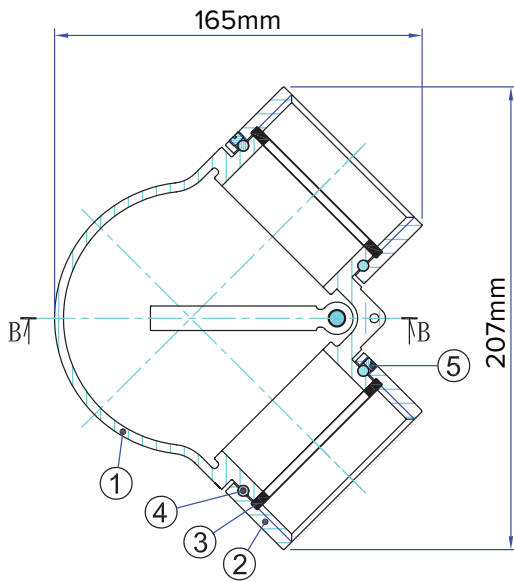

MATERIAL CHART

| NO. | PART NAME | MATERIAL |
|-----|---------------|-----------------|
| 1 | Body | Brass ASTM B584 |
| 2 | Hose Coupling | Brass ASTM B584 |
| 3 | Rubber Facing | NBR |
| 4 | Ball | Stainless Steel |
| 5 | Screw | Brass |
| 6 | Hinge Pin | Brass |
| 7 | O-Ring | NBR |
| 8 | Clapper | Forged Brass |

