

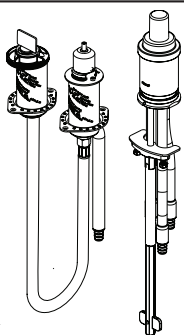

see what Delta can do™

## 3 HOLE ROMAN TUB WITH HAND SHOWER ROUGH- IN KIT

R3708-PX



R3709-PX

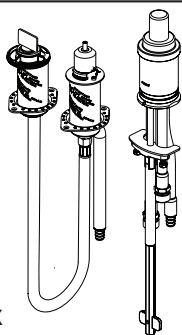

### Finished Deck (Standard) Installation

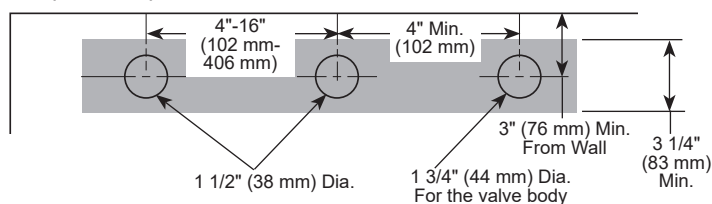

R3708-PX

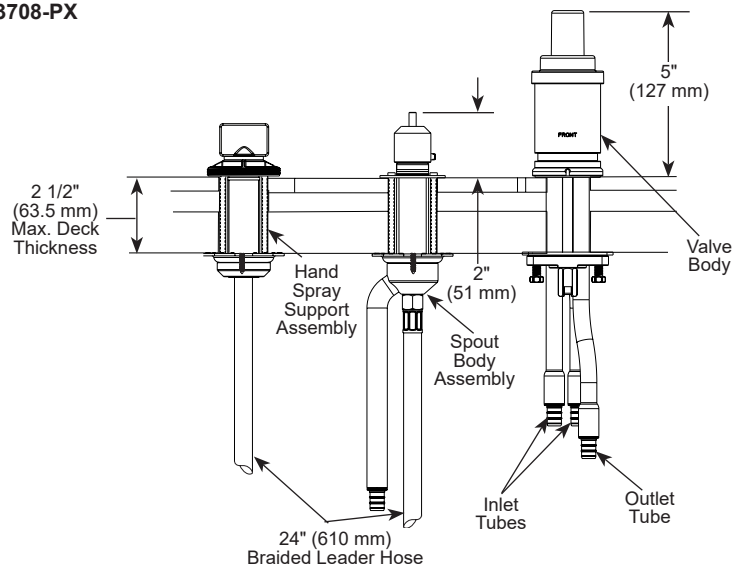

R3709-PX

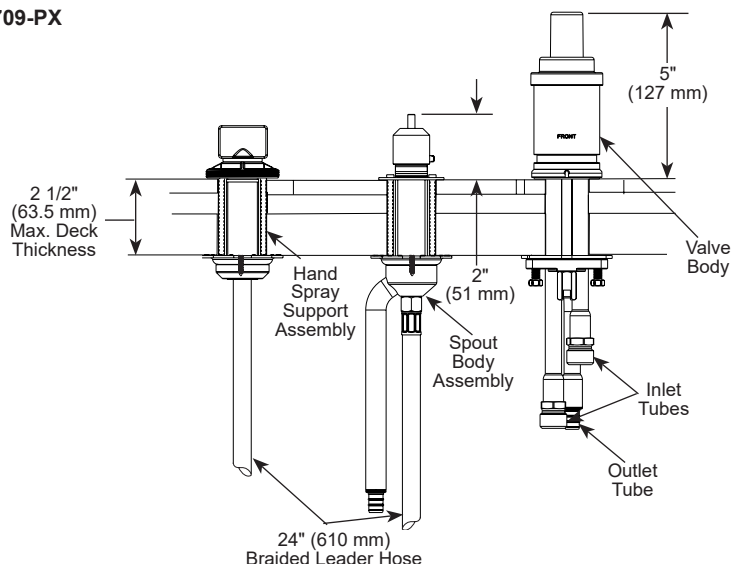

### STANDARD SPECIFICATIONS

- Deck mount on either free standing tub or garden tub
- Three hole installation
- Installed on the finished deck, 2 1/2" maximum deck thickness
- 3 1/4" minimum width required for both deck surface and the internal space under it
- Single handle controls the volume and temperature
- High flow ceramic mixing cartridge
- 1/2" PEX tubing connection allows flexible spacing among handle, spout and hand shower
- Auto resetting diverter
- Solid fabricated brass end valves and spout body
- R3708-PX uses crimping 1/2" PEX connections
- R3709-PX uses two flexible supply hoses to stop valves, use crimping 1/2" PEX connection between valve body and spout body
- Crimping PEX between valve body and spout body
- Flexible deck or ledge mount installation
- R3708-PX flows roughly 9-10 GPM @ 60 psi
- R3709-PX flows roughly 11-12 GPM @ 60 psi

◆ **NOTE: Trim kit must also be ordered to complete installation. Refer to separate trim kit specifications to determine the best rough-in kit and handle spacing for your situation.**

### WARRANTY

- Parts and Finish - Lifetime limited warranty; or for commercial purchasers, 10 years for multi-family residential (apartments and condominiums) and 5 years for all other commercial uses, in each case from the date the product is received by the original purchaser or their authorized representative (installation contractor, etc.).
- Electronic Parts and Batteries (if applicable) - 5 years from the date the product is received by the original purchaser or their authorized representative (installation contractor, etc.); or for commercial purchasers, 1 year from the date the product is received by the original purchaser or their authorized representative (installation contractor, etc.). No warranty is provided on batteries.

### COMPLIES WITH:

- ASME A112.18.1/ CSA B125.1

Delta reserves the right (1) to make changes in specifications and materials, and (2) to change or discontinue models, both without notice or obligation. Dimensions are for reference only. See current full-line price book or [www.deltafaucet.com](http://www.deltafaucet.com) for finish options and product availability.

DSP-B-R3708-PX Rev. B

### Delta Faucet Company

55 E. 111th Street, Carmel, IN 46280  
350 South Edgeware Road, St. Thomas, ON N5P 4L1  
© 2024 Delta Faucet Company