



ROOFTOP SUPPORT BLOCK



**MADE FROM 100%
RECYCLED RUBBER**
ENVIRONMENTALLY FRIENDLY

Support Block is designed for superior support of piping systems, cable tray, electrical conduit, HVAC equipment and many other applications. It is UV resistant and suitable for installation on most types of roofing material or other flat surfaces. Can be used as a curb (sleeper) replacement.

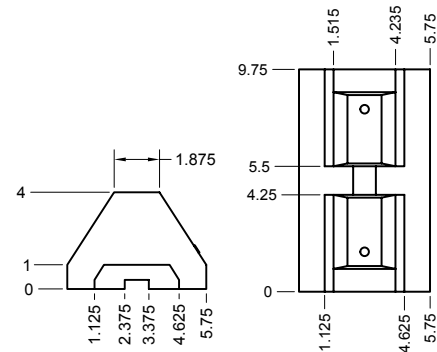

ROOFTOP SUPPORT BLOCK

Designed for superior support of applications on rooftops

- Mounting pierce screw point to penetrate metal studs
- Made from High Grade Recycled Rubber
- Green Reflector for High Visibility and Safety
- Available with and without strut
- Screw fasteners can be used to attach one or two hole pipe straps or a piece of strut
- UV resistant
- Dampens vibrations

Sizes: 1-5/8" x 13/16"

Block Material: Recycled Rubber

Strut Material: Pregalvanized Steel

ITEM	DESCRIPTION	MAX LOAD	WEIGHT LBS	HEIGHT	LENGTH	WIDTH	INNER QTY	PALLET QTY
RSB-10S	10" Rooftop Support Block with Strut	750	5.5	4-13/16"	9-3/4"	5-3/4"	1	352
RSB-10	10" Rooftop Support Block without Strut	750	5.2	4"	9-3/4"	5-3/4"	1	352



H-Strut Channels are manufactured by a series of forming dies and rolls which progressively work the strip steel into the desired channel configuration. This method produces a cross section of uniform dimensions within a tolerance of plus or minus 0.015", on outside dimensions.

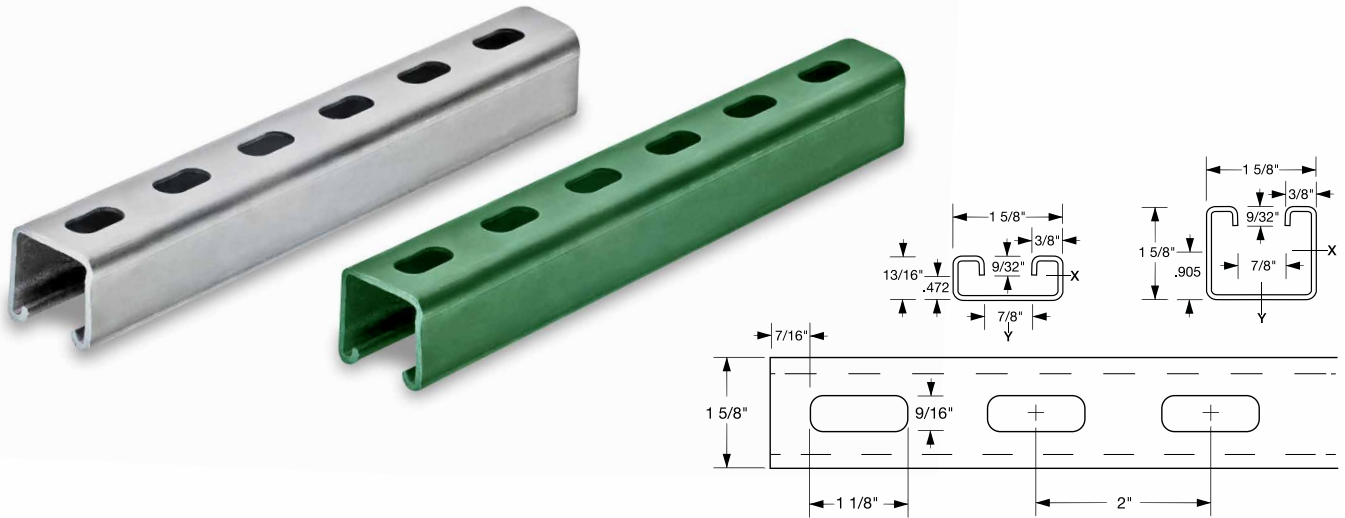

PRE GALVANIZED & SUPR GREEN STRUT CHANNEL



Designed to support hanging pipes

- Slotted series of channels offer full flexibility
- Pre-punched slots eliminate the need for precise field measuring for hole locations
- Slots offer wide adjustments in the alignment and bolt sizing
- Underwriters Laboratories Listed (UL)
- H-Strut channels are produced from prime structural steel
- Pre-Galvanized ASTM A-653 & Powder Coated Supr-Freen ASTM B-117

Sizes: 1-5/8" x 13/16" - 1-5/8" x 1-5/8"

Material: Prime Structural Steel

Finish: Pre Galvanized ASTM-A653 & Powder Coated Supr-Green ASTM-B117

Color: Zinc & Green

Approvals: UL

I = Moment of Inertia S = Section Modulus R = Radius of Gyration

SIZE INCHES	ITEM PRE GALVANIZED	ITEM SUPR-GREEN	GAUGE SIZE	WEIGHT LBS	AREA OF SECTION Sq. In.	X-X AXIS I in ⁴	X-X AXIS S in ³	X-X AXIS R in.	Y-Y AXIS I in ⁴	Y-Y AXIS S in ³	Y-Y AXIS R in.	BUNDLE QUANTITY
1-5/8" x 13/16" x 10'	STC12-GP131610	STC12-GN131610	12GA	0.98	0.294	0.027	0.058	0.303	0.11	0.135	0.612	50
1-5/8" x 13/16" x 20'	STC12-GP131620	STC12-GN131620	12GA	0.98	0.294	0.027	0.058	0.303	0.11	0.135	0.612	50
1-5/8" x 1-5/8" x 10'	STC12-GP15810	STC12-GN15810	12GA	1.4	0.416	0.149	0.166	0.598	0.183	0.225	0.663	50
1-5/8" x 1-5/8" x 20'		STC12-GN15820	12GA	1.4	0.416	0.149	0.166	0.598	0.183	0.225	0.663	50
1-5/8" x 13/16" x 10'	STC14-GP131610	STC14-GN131610	14GA	0.98	0.294	0.027	0.058	0.303	0.11	0.135	0.612	50
1-5/8" x 1-5/8" x 10'	STC12-GP15810	STC14-GN15810	14GA	1.4	0.416	0.149	0.166	0.598	0.183	0.225	0.663	50

Additional sizes and finishes are available on demand.