

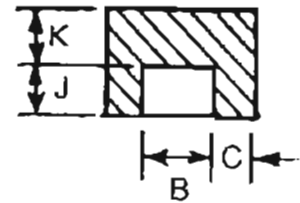

SOCKET-WELDING FITTINGS

ASME B16.11-1996 (REVISION OF ASME B16.11-1991)

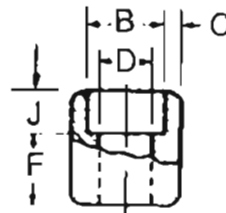
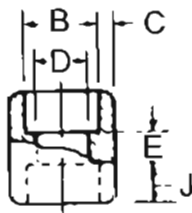

COUPLING

HALF COUPLING

CAP

Dimensions in Millimeters.

Center to Bottom of Socket-A						Laying Lengths		Tolerances \pm			End Wall Thickness K Min.			Nom. Pipe Size	DN
90° Elbows Tees, Crosses			45° Elbows			Couplings E	Half Couplings F	A	E	F	Class Designation				
3000	6000	9000	3000	6000	9000						3000	6000	9000		
11.0	11.0		8.0	8.0		6.5	16.0	1.0	1.5	1.0	4.8	6.4		1/8	6
11.0	13.5		8.0	8.0		6.5	16.0	1.0	1.5	1.0	4.8	6.4		1/4	8
13.5	15.5		8.0	11.0		6.5	17.5	1.5	3.0	1.5	4.8	6.4		3/8	10
15.5	19.0	25.5	11.0	12.5	15.5	9.5	22.5	1.5	3.0	1.5	6.4	7.9	11.2	1/2	15
19.0	22.5	28.5	13.0	14.0	19.0	9.5	24.0	1.5	3.0	1.5	6.4	7.9	12.7	3/4	20
22.5	27.0	32.0	14.0	17.5	20.5	12.5	28.5	2.0	4.0	2.0	9.6	11.2	14.2	1	25
27.0	32.0	35.0	17.5	20.5	22.5	12.5	30.0	2.0	4.0	2.0	9.6	11.2	14.2	1-1/4	32
32.0	38.0	38.0	20.5	25.5	25.5	12.5	32.0	2.0	4.0	2.0	11.2	12.7	15.7	1-1/2	40
38.0	41.0	54.0	25.5	28.5	28.5	19.0	41.0	2.0	4.0	2.0	12.7	15.7	19.0	2	50
41.0			28.5			19.0	43.0	2.5	5.0	2.5	15.7	19.0		2-1/2	65
57.0			32.0			19.0	44.5	2.5	5.0	2.5	19.0	22.4		3	80
66.5			41.0			19.0	48.0	2.5	5.0	2.5	22.4	28.4		4	100

NOTES:

- (1) Average of Socket Wall Thickness around periphery shall be no less than listed values.
The minimum values are permitted in localized areas.
- (2) Upper and lower values for each size are the respective maximum and minimum dimensions.
- (3) DIMENSIONAL TOLERANCES: see page 17