

225M DI Mechanical Joint Valve

Specification Sheet

FEATURES & BENEFITS • 2" – 12"

- Mechanical Joint Ductile Iron Gate Valve • 300 PSI 2"- 12"
- Resilient Wedge • 250 PSI 14"- 18"
- Non Rising Stem • 200 PSI 20"- 24"
- AWWA C515-20 • UL Listed / FM Approved
- Temp Range of 32°F - 180°F
- NSF-61 / NSF-372 verified by UL Water Quality
- AWWA C550 Epoxy
- Can Be Fitted With Post Indicator Plate

MATERIAL SPECIFICATIONS

No.	Part	Material	ASTM Spec.
1	Body	Ductile Iron	A536-65-45-12
2	Wedge	Ductile Iron EPDM Encapsulated	A536-65-45-12
3	Stem Nut	Bronze	ASTM C95200
4	Stem	Stainless Steel	ANSI 304
5	Gasket	Rubber	EPDM
6	Bolt	Stainless Steel	SS304
7	Bonnet	Ductile Iron	A536-65-45-12
8	O-Ring	Rubber	NBR
9	Thrust Collar	Bronze	ASTM C95200
10	O-Ring	Rubber	NBR
11	Gland	Ductile Iron	A536-65-45-12
12	O-Rings	Rubber	NBR
13	Dust Ring	Rubber	NBR
14	Operating Nut (Optional)	Ductile Iron	A536-65-45-12
15	Bolts	Stainless Steel	SS304
16	Washer	Stainless Steel	SS304
17	Handwheel (Optional)	Ductile Iron	A536-65-45-12
18	Bolts	Stainless Steel	SS304

No Plate

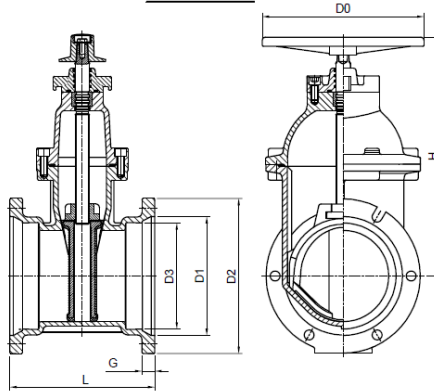

With Plate: SIZE 4"-12"

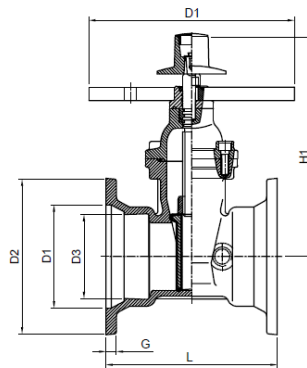

DIMENSIONS

Part #	Size	L	D2	D1	D3	G	H	D0	D1	H1	Bolt Circle	Qty.*Dia Bolt Hole
225M08	2"	9.25	6.4	3.5	2.8	0.63	9.5	7	-	10.3	4.75	4*0.75
225M10	3"	9.50	7.6	4.9	4.1	0.59	11.0	10	-	11.6	6.25	4*0.75
225M11	4"	10.00	9.1	6.0	4.9	0.60	11.8	10	12	13.8	7.50	4*0.88
225M13	6"	11.50	11.1	8.1	7.1	0.63	16.4	12	12	18.0	9.50	6*0.88
225M14	8"	12.50	13.3	10.3	9.2	0.66	20.7	14	12	21.5	11.75	6*0.88
225M15	10"	14.75	15.6	12.3	11.2	0.70	24.5	16	12	25.5	14.00	8*0.88
225M16	12"	15.00	17.9	14.4	13.3	0.73	28.0	16	12	28.8	16.25	8*0.88

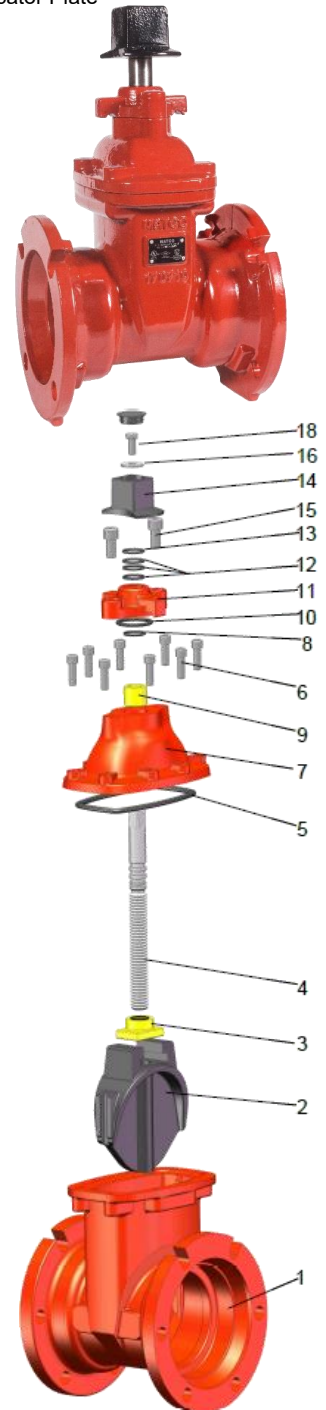

225M DI Mechanical Joint Valve

Specification Sheet

FEATURES & BENEFITS • 14" – 24"

- Mechanical Joint Ductile Iron Gate Valve
- Resilient Wedge
- Non Rising Stem
- Temp Range of 32°F - 180°F
- 300 PSI 2" - 12"
- 250 PSI 14" - 18"
- 200 PSI 20" - 24"
- AWWA C515-20
- UL Listed / FM Approved
- NSF-61 / NSF-372 verified by UL Water Quality
- AWWA C550 Epoxy

MATERIAL SPECIFICATIONS

No.	Part	Material	ASTM Spec.
1	Body	Ductile Iron	A536-65-45-12
2	Wedge	Ductile Iron EPDM Encapsulated	A536-65-45-12
3	Stem Nut	Bronze	ASTM C95200
4	Stem	Stainless Steel	AISI 431
5	Gasket	Rubber	EPDM
6	Bolt	Stainless Steel	SS304
7	Nuts	Stainless Steel	A2470
8	Washer	Stainless Steel	SS304
9	Bonnet	Ductile Iron	A536-65-45-12
10	O-Ring	Rubber	NBR
11	Thrust Washer	Bronze	ASTM C95200
12	O-Rings	Rubber	NBR
13	Gland	Ductile Iron	A536-65-45-12
14	O-Ring	Rubber	NBR
15	Dust Ring	Rubber	NBR
16	Operating Nut	Ductile Iron	A536-65-45-12
17	Bolt	Stainless Steel	SS304
18	Bolt	Stainless Steel	SS304
19	Washer	Stainless Steel	SS304
20	Lifting Bolt	Stainless Steel	SS304
21	Washer	Stainless Steel	SS304

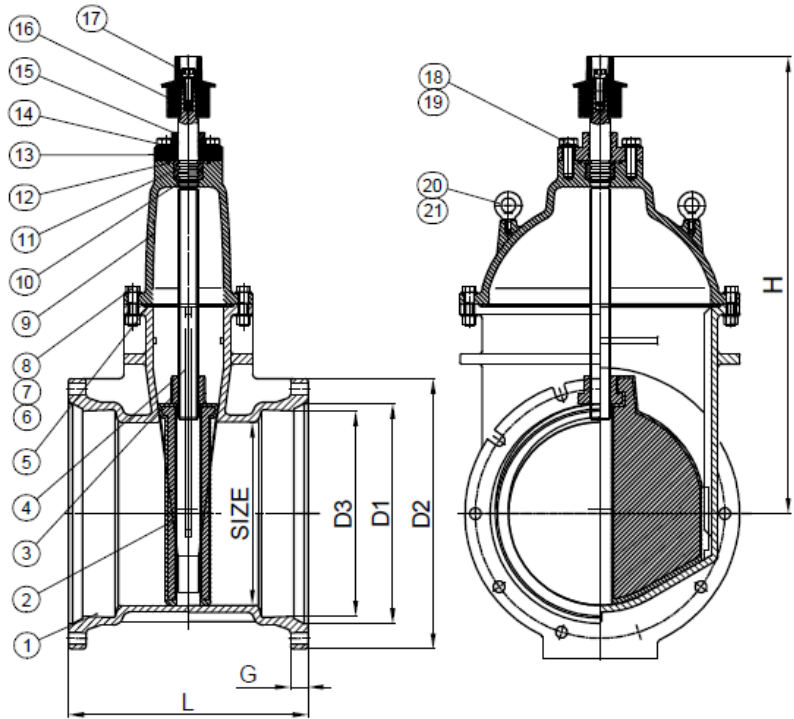

DIMENSIONS

Part #	Size	L	D2	D1	D3	G	H	D0	Bolt Circle	Qty.*Dia Bolt Hole
225M17	14"	17.0	20.3	16.5	15.4	0.79	35.6	22	18.75	10*0.88
225M18	16"	17.0	22.6	18.6	17.5	0.85	38.5	22	21.00	12*0.88
225M19	18"	18.0	24.8	20.7	19.6	1.00	44.0	24	23.25	12*0.88
225M20	20"	18.0	27.1	22.8	21.7	1.02	47.0	24	25.50	14*0.88
225M24	24"	20.0	32.6	27.0	25.9	1.02	52.8	30	30.00	16*0.88

