

Schedule 40 Flexible Bath Waste Kit with Quick Test

Specifications

- Fits 1-1/2" pipe
- Flexible tubing eliminates the need to use 45° elbows for offsets and makes the installation process simple
- Snap-on faceplate
- Includes test plug and test membrane
- 5-year limited warranty

Material

- PVC

Dimensions and Product Offering

Part Code	Finish	Size	Stopper
B0F16PZLCP	Chrome Plated	16"	Lift and Turn
B0F16PBPCP	Chrome Plated	16"	Push/Pull
B0F16PZLBN	Brushed Nickel	16"	Lift and Turn
B0F16PZTBN	Brushed Nickel	16"	Toe Touch
B0F24PZLCP	Chrome Plated	24"	Lift and Turn
B0F24PBPCP	Chrome Plated	24"	Push/Pull
B0F24PZTCP	Chrome Plated	24"	Toe Touch
B0F24PBPN	Brushed Nickel	24"	Push/Pull

Certifications/Listings/Approvals

- ASME A112.18.2/CSA B125.2



Job Name _____
 Location _____
 Engineer _____
 Contractor _____
 Tag _____ PO# _____

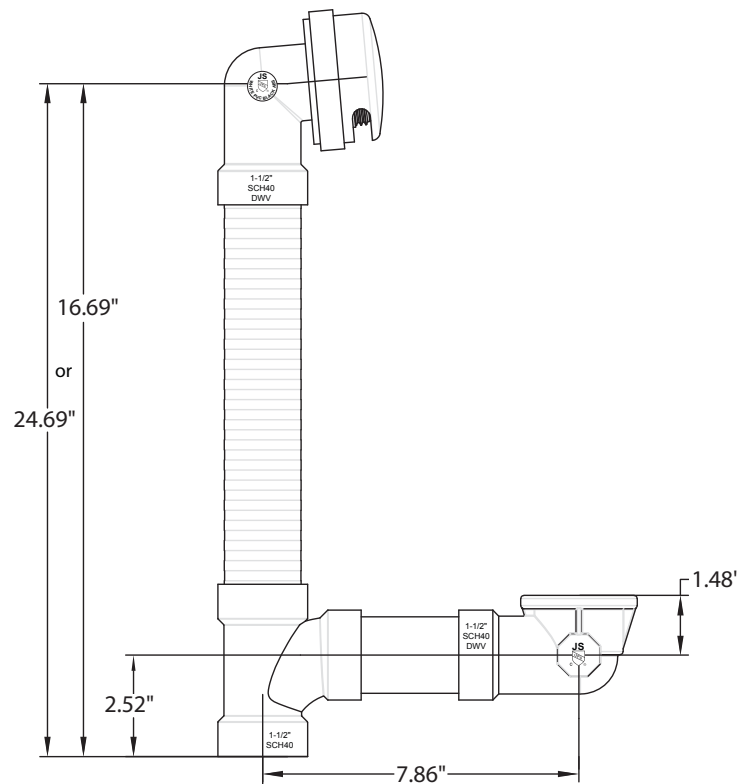

See page 2 for drain drawing and dimensions.

Schedule 40 Flexible Bath Waste Kit with Quick Test

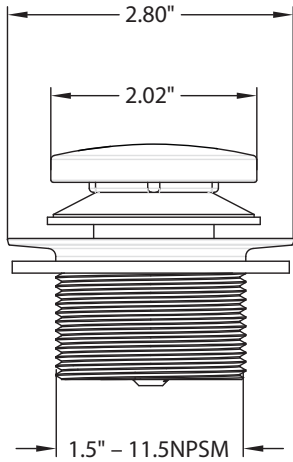
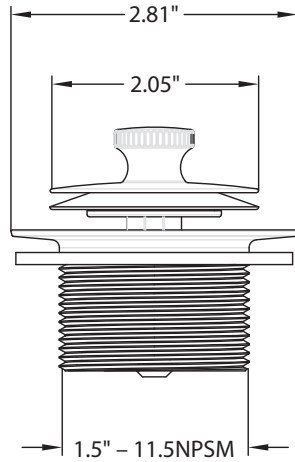
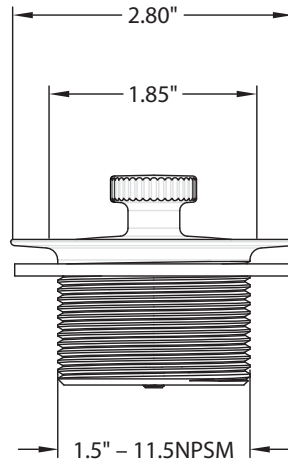
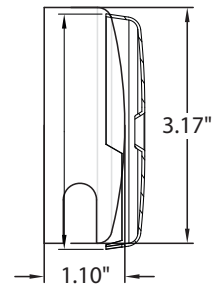
**Toe Touch****Push/Pull****Lift and Turn****Faceplate**