

One-Hole Bathtub Faceplate with Conversion Bar

Job Name _____

Location _____

Engineer _____

Contractor _____

Tag _____ PO# _____

Specifications

- 5-year limited warranty

Material

- Zinc

Dimensions and Product Offering

Part Code	Finish
B1BCP	Chrome Plated

Certifications/Listings/Approvals

- ASME A112.18.2/CSA B125.2

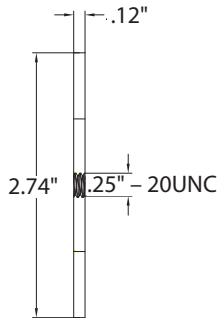

Conversion Bar



Faceplate

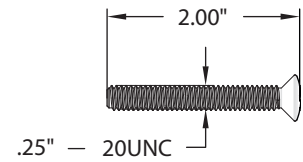

Screw