

RVU6100

UNDERMOUNT LAUNDRY SINK

RU VATI®
SPECIFICATION SHEET

MATERIAL

- True 16 Gauge Thickness
- Premium T304 Grade Stainless Steel
- 18/10 Chromium/Nickel Content
- Commercial Brushed Finish

FEATURES

- Heavy duty sound guard padding and undercoating
- Slanted bottom with elegant drain grooves for easy draining
- Extra deep sink for utility room

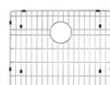

IN THE BOX



Basket Strainer
[RVA1025]



Mounting Clips
[RVA11031]

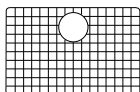

Rinse Grid
[RVA67100]



Cut-out
Template

NOMINAL DIMENSIONS

- Exterior:** 23" (wide) x 18" (front-to-back)
- Interior Bowl:** 21" (wide) x 16" (front-to-back)
- Bowl Depth:** 12-3/8"
- Minimum Cabinet Size:** 25" wide
- Drain Hole Size:** 3 1/2"

Installation Type:
Undermount

Inside Corners:
Zero Radius

Drain Location:
Rear Center

RU VATI USA
www.ruvati.com

Phone: 1.855.478.8284
Email: support@ruvati.com

OPTIONAL ACCESSORIES (SOLD SEPARATELY)



DIMENSIONS

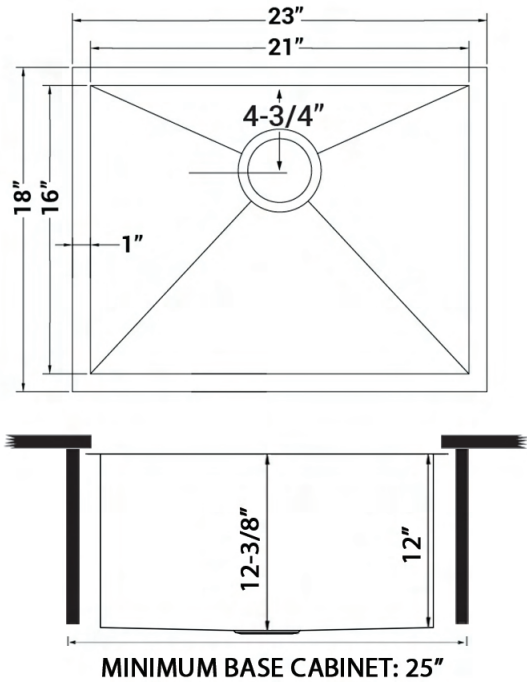

cUPC certified by IAPMO
to meet US and Canada
plumbing standards.



SCAN TO REGISTER
YOUR WARRANTY

or visit
ruvati.com/register

RUVATI USA
www.ruvati.com

Phone: 1.855.478.8284
Email: support@ruvati.com