

PROJECT NAME _____

LOCATION _____



ARCHITECT _____

ENGINEER _____

CONTRACTOR _____

REFERENCE _____

SUBMITTED BY _____ DATE _____

Indoor Unit (IDU): DRAW06F2A	Outdoor Unit (ODU): DRA1H06S2A	Wireless Remote Control
		

PRODUCT FEATURES

- Up to 100% heating capacity at 0°F
- Low ambient heating down to -22°F
- Low ambient cooling down to -22°F
- A2L refrigerant detection system
- Variable speed inverter compressor
- Quiet operation
- Wireless remote control with "Follow Me" technology
- Turbo, ECO, Active Clean, Sleep modes and more
- Auto restart
- 46°F freeze protection
- Included base pan heater
- Anti-corrosive fin coating
- Compatible with DRSTAT101 wired thermostat

CAPACITIES		
Cooling Capacity (BTU/hr)	Rated at 95°F (35°C) ¹	6000
	at 109°F (43°C)	10000
	at 5°F (-15°C)	11400
	Cooling Range	2500~11500
Heating Capacity (BTU/hr)	Rated at 47°F (8°C) ²	7000
	Rated at 17°F (-8°C) ³	7600
	Rated at 5°F (-15°C) ⁴	7500
	at -13°F (-25°C)	3900
	at -22°F (-30°C)	3500
	Heating Range	3200~10700

SYSTEM DATA	
Refrigerant Type	R-454B
Refrigerant Charge (oz. (kg))	32.5 (0.92)
Design Pressure (PSIG)	550/340
Indoor/ Outdoor Coil Coating	Golden Fin Coating

EFFICIENCY DATA	
SEER2	25.3
EER2	16.0
HSPF2	14.6
COP at 47°F (8°C) ²	3.80
COP at 17°F (-8°C) ³	2.50
COP at 5°F (-15°C) ⁴	2.30





SIRIUS HEAT™ WALL MOUNT HEAT PUMP SYSTEM

6,000 BTU/H

SPECIFICATIONS

LINE SET REQUIREMENTS	
Connection Type	Flare
Liquid (in. (mm))	Ø1/4 (Ø6.35)
Gas (in. (mm))	Ø3/8 (Ø9.52)
Pre-Charge Length (ft. (m))	25 (7.5)
Minimum Length (ft. (m))	10 (3.0)
Maximum Length (ft. (m))	82 (25.0)
Maximum Height Differential (ft. (m))	49 (15.0)
Additional Refrigerant (oz./ft (g/m))	0.16 (15)

OUTDOOR UNIT		
Unit Dimensions	Width	30-1/8 (765)
	Depth	11-15/16 (303)
	Height	21-7/8 (555)
Carton Dimensions	Width	34-15/16 (887)
	Depth	13-1/4 (337)
	Height	24 (610)
Net Weight (lbs. (kg))	62.2 (28.2)	
Gross Weight (lbs. (kg))	67.7 (30.7)	
Cooling Operating Temp. (°F (°C))	-22 - 122 (-30 - 50)	
Heating Operating Temp. (°F (°C))	-22 - 75 (-30 - 24)	
Voltage/Phase/Frequency	208-230V, 1 Phase, 60 Hz	
Voltage Range	187-253V	
Recommended Breaker (Amps)	15	
Minimum Circuit Ampacity (Amps)	12	
Communication Wire Size	14*4 AWG Stranded	
Rated Current - Cooling (Amps) ¹	3.1	
Rated Current - Heating (Amps) ²	4.0	
Sound Pressure (dB(A))	53	

¹ Value at AHR1 Rated Capacity at 95°F (35°C) (AFull)

² Value at AHR1 Rated Capacity at 47°F (8°C) (H1Full)

³ Value at AHR1 Rated Capacity at 17°F (-8°C) (H32)

⁴ Value at AHR1 Rated Capacity at 5°F (-15°C) (H42)

INDOOR UNIT		
Unit Dimensions (in. (mm))	Width	28-11/16 (729)
	Depth	7-7/8 (200)
	Height	11-1/2 (292)
Carton Dimensions (in. (mm))	Width	31-1/8 (790)
	Depth	10-5/8 (270)
	Height	14-3/4 (375)
Net Weight (lbs. (kg))	17.6 (8.0)	
Gross Weight (lbs. (kg))	23.1 (10.5)	
Indoor Unit Air Flow (CFM (m³/h))	Low	141 (240)
	Medium	177 (300)
	High	235 (400)
	Turbo	294 (500)
Moisture Removal (Pints/day (L/h))	15.2 (0.3)	
Drain Port O.D. (in. (mm))	Ø5/8 (Ø16)	
Recommended Breaker (Amps)	15	
Minimum Circuit Ampacity (Amps)	3.0	
Sound Pressure (dB(A))	Silent	20
	Low	24
	Medium	32
	High	37
	Turbo	42

COMPRESSOR	
Type	DC Rotary Inverter
Oil Type	Ester Oil VG74
Oil Charge (oz. (ml))	10.5 (310)

Unit Dimensions

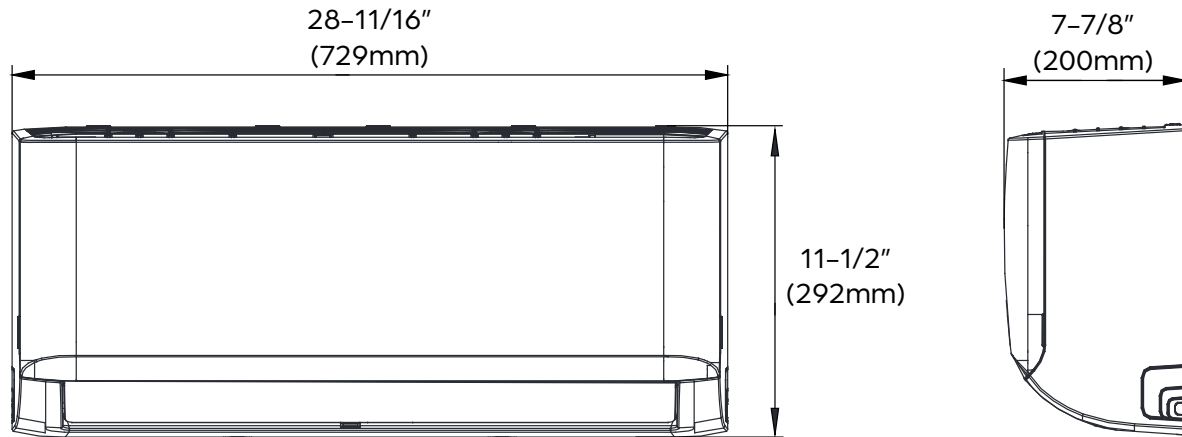

Mounting Plate Dimensions

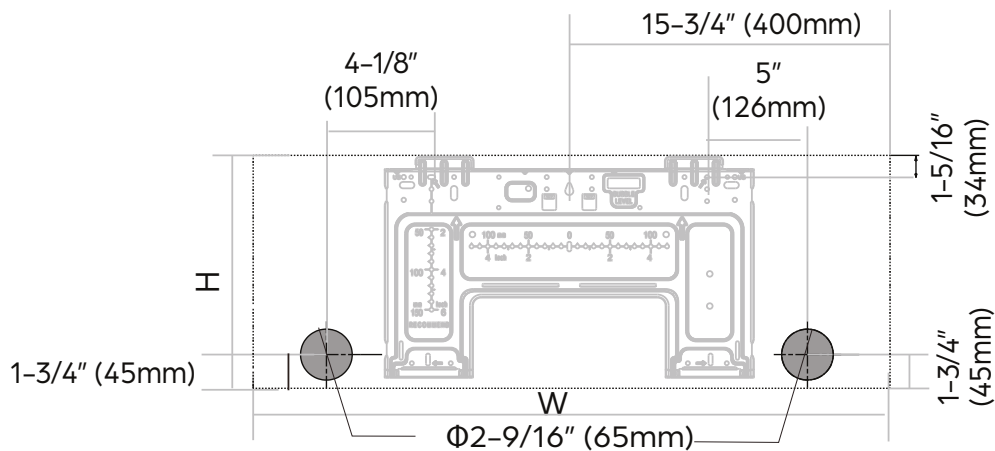

Indoor unit dimensions (WxH):
28-11/16" (729mm) x 11-1/2" (292mm)

Clearance Distances

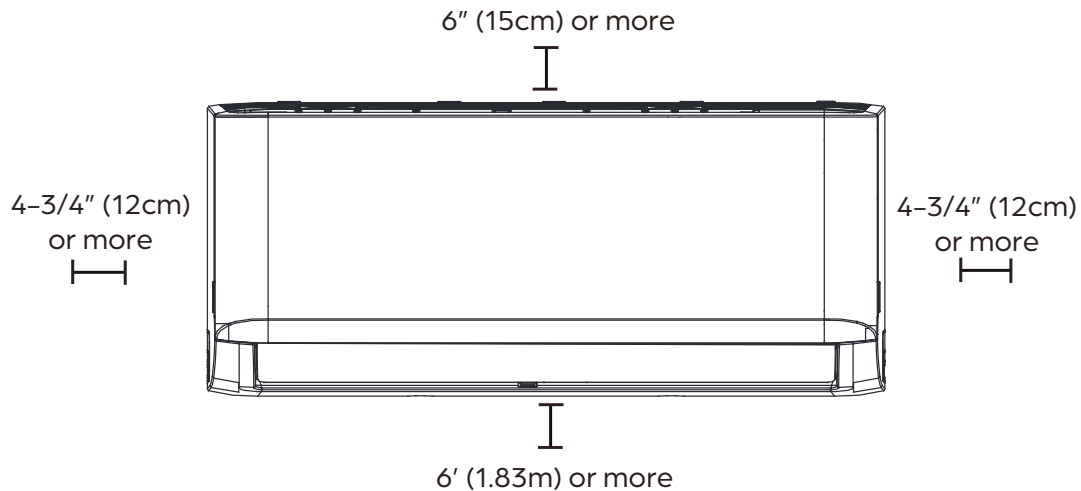

Clearances

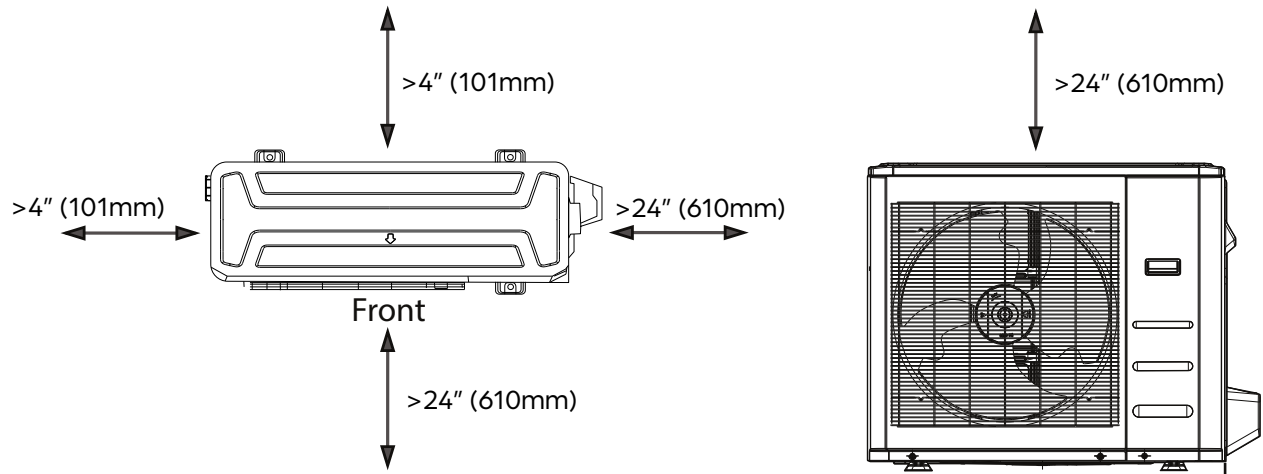

Dimensions

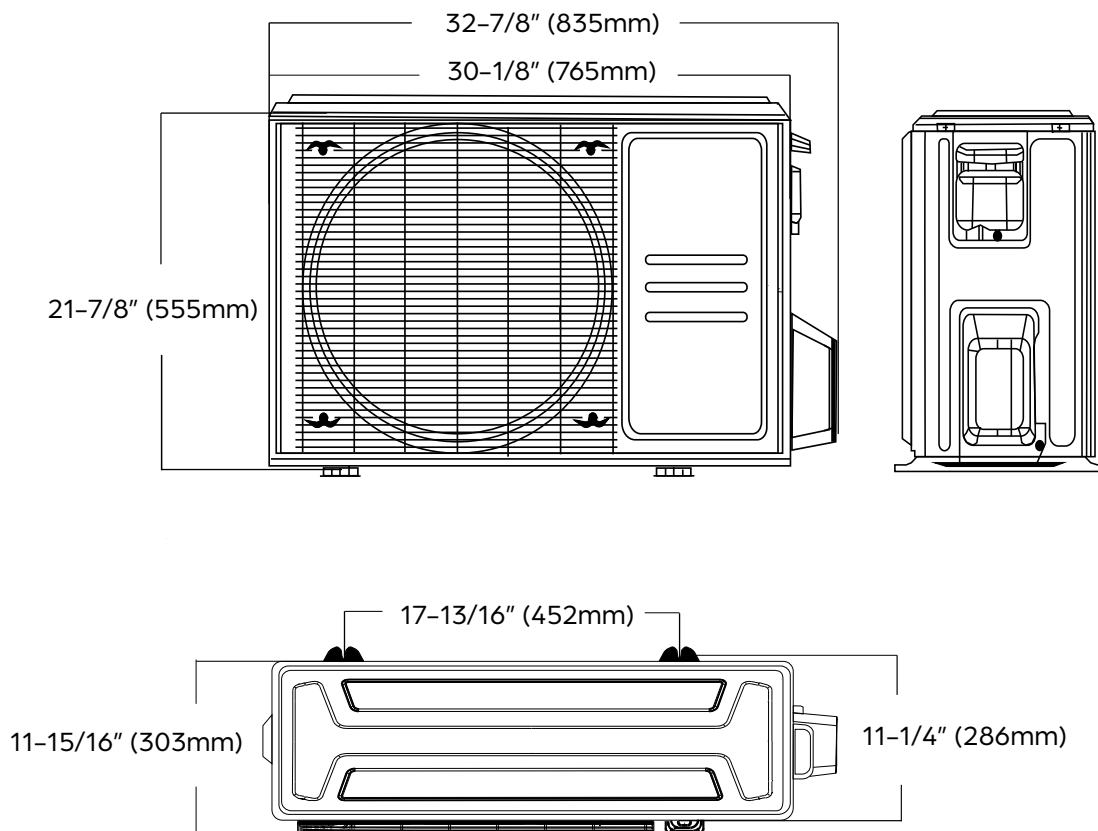

NOTE

Illustrations in this document are for explanatory purposes. The actual shape of your mini-split equipment may vary slightly.