

# RVG2016

GRANITE UNDERMOUNT KITCHEN SINK

**RUVATI®**

SPECIFICATION SHEET

## MATERIAL

- Solid Granite Composite
- 80% crushed natural granite for extreme strength
- Non-porous and resistant to stains

## FEATURES

- Naturally sound proof
- Will never discolor
- Rounded inside corners



## COLOR OPTIONS

**BK:** Midnight Black

**WH:** Arctic White

## IN THE BOX



Basket Strainer  
[RVA1038BL/WH]

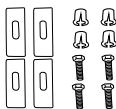

Mounting Clips  
[RVA11059]



Cut-out  
Template

## NOMINAL DIMENSIONS

Exterior: 15" (wide) x 17-1/3" (front-to-back)

Interior Bowl: 13-3/8" (wide) x 15-3/4" (front-to-back)

Bowl Depth: 7-1/2"

Minimum Cabinet Size: 18" wide

Drain Hole Size: 3 1/2"

**Installation Type:**  
Undermount

**Inside Corners:**  
Rounded

**Drain Location:**  
Rear Center

**RUVATI USA**

[www.ruvati.com](http://www.ruvati.com)

Phone: 1.855.478.8284  
Email: [support@ruvati.com](mailto:support@ruvati.com)

# OPTIONAL ACCESSORIES (SOLD SEPARATELY)



Deep Basket  
Disposal Flange  
[RVA1049BL /GG]

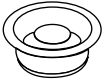

Garbage  
Disposal Flange  
[RVA1041BL /GG]

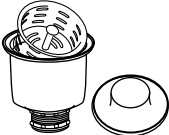

Deep Basket Strainer  
and Stopper  
[RVA1027BL /GG]

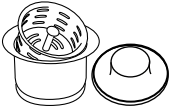

Deep Basket  
Disposal Flange/Stopper  
[RVA1052BL /GG]

## DIMENSIONS

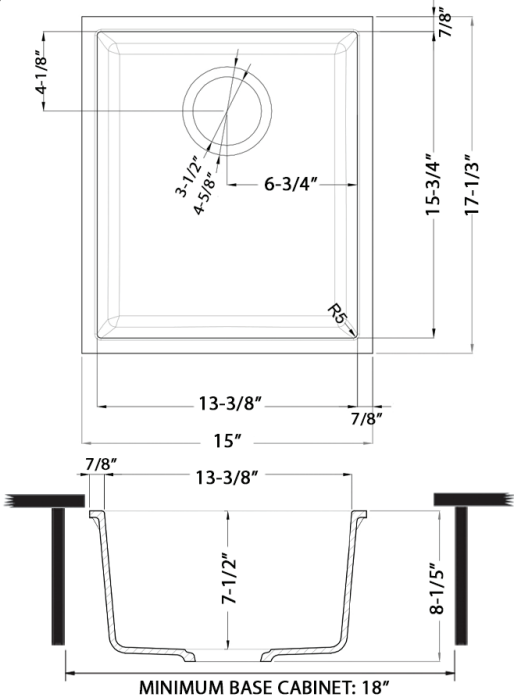



cUPC certified by IAPMO  
to meet US and Canada  
plumbing standards.



**SCAN TO REGISTER  
YOUR WARRANTY**  
or visit  
[ruvati.com/register](http://ruvati.com/register)