



SERVICE PARTS LIST

BULLETIN NO.
54-06-2400

SPECIFY CATALOG NO. AND SERIAL NO. WHEN ORDERING PARTS		REVISED BULLETIN	DATE
M18™ ROVER™ CLAMPING FLOOD LIGHT			June 2024
CATALOG NO.	2358-20	SERIAL NO.	P68A
		WIRING INSTRUCTION	

00 0

EXAMPLE:
Component Parts (Small #)
Are Included When Ordering
The Assembly (Large #).

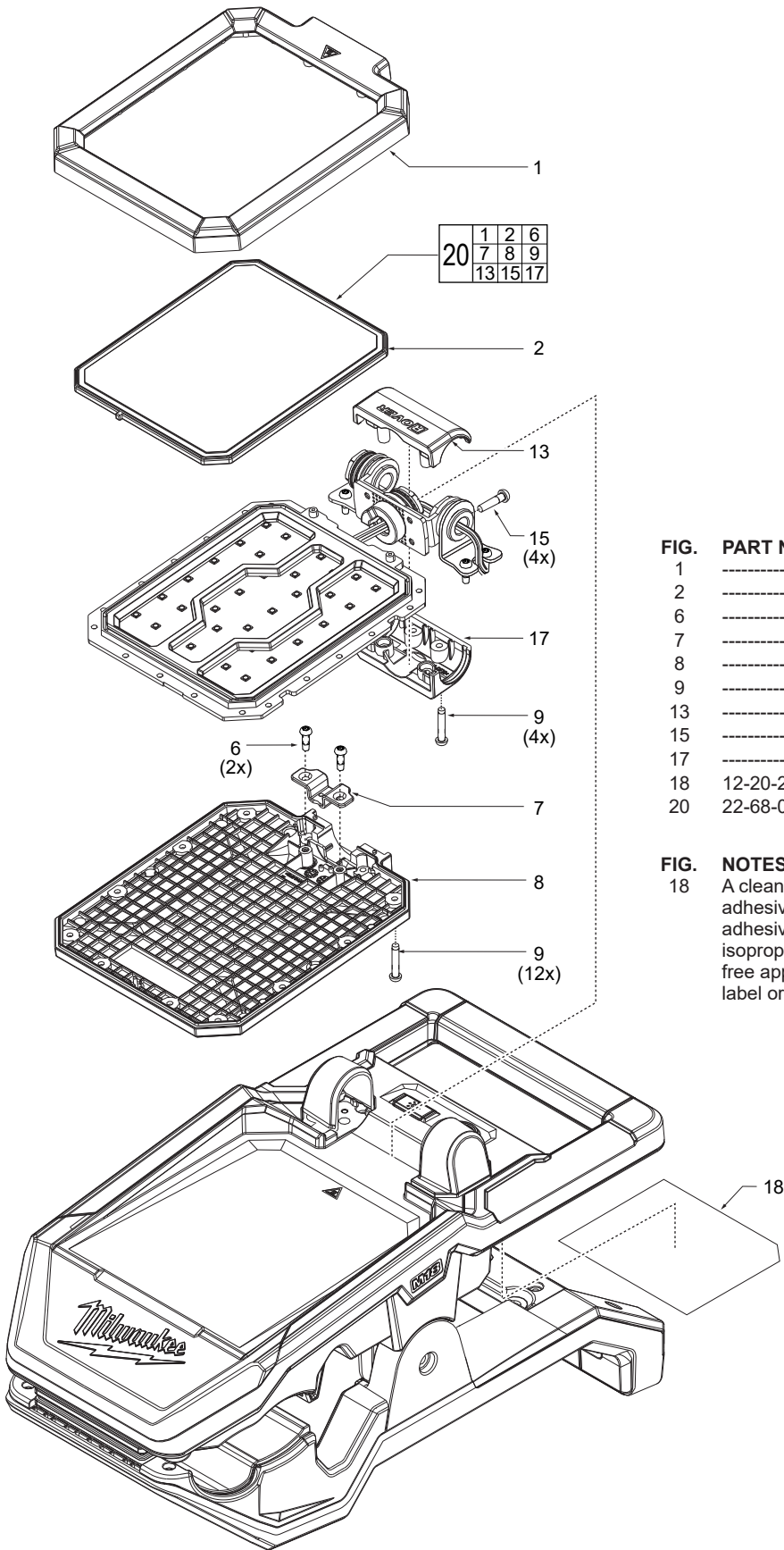

FIG.	PART NO.	DESCRIPTION OF PART	NO. REQ.
1	-----	Light head front housing	(1)
2	-----	Lens	(1)
6	-----	Screw	(2)
7	-----	Support Plate	(1)
8	-----	Light head back cover	(1)
9	-----	Screw	(16)
13	-----	Pivot Top Cover	(1)
15	-----	Screw	(4)
17	-----	Pivot Bottom Cover	(1)
18	12-20-2327	Service Nameplate	(1)
20	22-68-0245	Light Head Repair Kit	(1)

FIG. NOTES
18 A clean, dry surface is essential for proper performance for any adhesive system. The area intended for application of any adhesive label or nameplate must be prepared by cleaning with isopropyl alcohol. The solvent is to be applied with a clean, lint free applicator and the surface allowed to dry before applying the label or nameplate.