

Sivida Washbowl # 266000..00 / 266000..00 / 266000..00 / 266000..00

| < Ø 400 mm > |

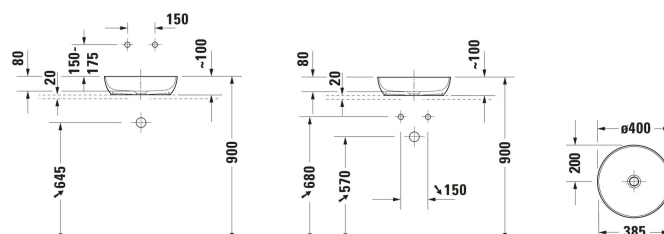

Washbowl	Dimension	Weight	Order number
DuroCast Plus, Round, Number of washing areas: 1 Middle, Overflow: No, 400 mm			
Colors			
32 White Satin Matt FG Interior Pale Green Matt / Exterior White Matt FH Interior White Matt / Exterior Pale Green Matt FI Dark Grey Matt			
Variant			
White Satin Matt	400x105 mm	5.500 kg	266000..00
Interior colour Pale Green Matt, Exterior colour White Satin Matt	400x105 mm	5.500 kg	266000..00
Interior colour White Satin Matt, Exterior colour Pale Green Matt	400x105 mm	5.500 kg	266000..00
Interior colour White Satin Matt, Exterior colour Dark grey Matt	400x105 mm	5.500 kg	266000..00
Accessory			
Slotted waste washbasin without overflow, Material drain covers: Brass, Diameter: 72 mm	Ø 72 mm	0.315 kg	005024
Suitable products			
Console Number of cut-outs: 1, Number of washing areas: 1, Incl. console supports: No, 820 x 510 mm	820 x 510 mm		267011 3/H
Console Number of cut-outs: 1, Number of washing areas: 1, Incl. console supports: No, 680 x 500 mm	680 x 500 mm		267000 3/H
Console Number of cut-outs: 1, Number of washing areas: 1, Incl. console supports: No, 620 x 510 mm	620 x 510 mm		267010 3/H
Console Number of cut-outs: 2, Number of washing areas: 2, Incl. console supports: No, 1610 x 510 mm	1610 x 510 mm		267015 3/H
Console Number of cut-outs: 2, Number of washing areas: 2, Incl. console supports: No, 1410 x 510 mm	1410 x 510 mm		267014 3/H
Console Number of cut-outs: 1, Number of washing areas: 1, Incl. console supports: No, 1220 x 510 mm	1220 x 510 mm		267013 3/H
Console Number of cut-outs: 1, Number of washing areas: 1, Incl. console supports: No, 1020 x 510 mm	1020 x 510 mm		267012 3/H
Console Number of cut-outs: 2, Number of washing areas: 2, Incl. console supports: No, 1350 x 500 mm	1350 x 500 mm		267004 3/H

Sivida Washbowl # 266000..00 / 266000..00 / 266000..00 /
266000..00

|< Ø 400 mm >|

Console Number of cut-outs: 1, Number of washing areas: 1, Incl. console supports: No, 1280 x 500 mm	1280 x 500 mm	267003 3/H
Console Number of cut-outs: 1, Number of washing areas: 1, Incl. console supports: No, 1080 x 500 mm	1080 x 500 mm	267002 3/H
Console Number of cut-outs: 1, Number of washing areas: 1, Incl. console supports: No, 880 x 500 mm	880 x 500 mm	267001 3/H

All drawings contain the necessary measurements which are subject to standard tolerances. They are stated in mm and are non-binding. Exact measurements, in particular for customised installation scenarios, can only be taken from the finished piece.