

HVAC

VCMA-15 Series



Features

- Vertical type pump unit
- 1/2 gallon leakproof, rustproof, ABS tank with mounting tabs
- Stainless steel motor shaft
- 3 drain holes
- 3/8" O.D. barbed discharge adapter
- Built-in check valve
- Optional safety switch
- 15' shut-off head
- 6' power cord
- UL/CSA listed
- Thermal overload protected
- Suitable for high-efficiency, gas furnace condensate

Construction

- Motor — 1/50 HP
- Intermittent Liquid Temp. up to — 120°F
- Discharge — 3/8" OD barbed
- Housing — ABS
- Cover — ABS
- Volute — ABS
- Impeller — Glass filled polypropylene

Engineering Data

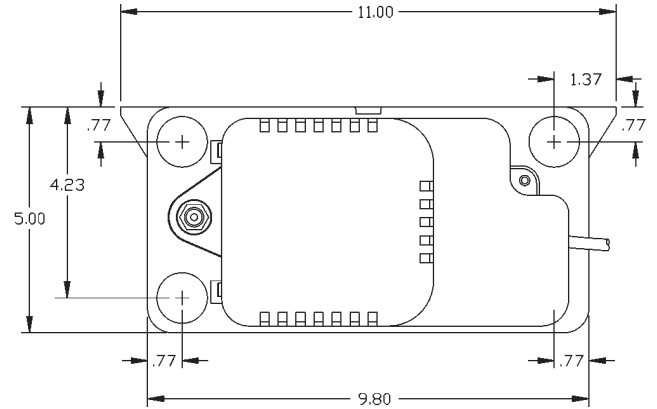
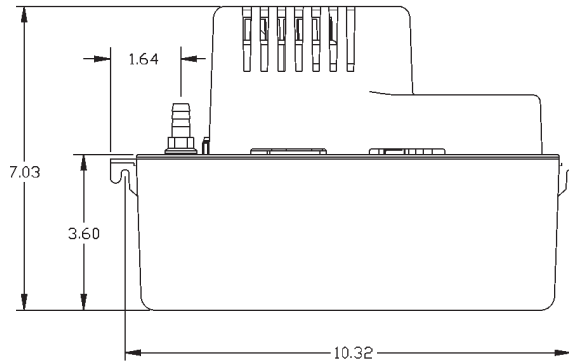

Specifications

Model No.	Item No.	Discharge Size	Listing(s)	HP	Volts	Hertz	Amps	Watts	Performance (GPH @Head)				Shut Off		Pwr. Cord (ft.)	Weight (Lbs)
									1'	5'	10'	20'	Feet	PSI		
VCMA-15 UL	554401	3/8" OD Barbed	UL/CSA	1/50	115	60	1	60	65	50	25	0	15	6.5	6	4.40
VCMA-15 ULT	554411	3/8" OD Barbed	UL/CSA	1/50	115	60	1	60	65	50	25	0	15	6.5	6	5.80
VCMA-15 ULS	554405	3/8" OD Barbed	UL/CSA	1/50	115	60	1	60	65	50	25	0	15	6.5	6	4.40
VCMA-15 ULST	554415	3/8" OD Barbed	UL/CSA	1/50	115	60	1	60	65	50	25	0	15	6.5	6	5.80

NOTE: GPH is through check valve.

Replacement Parts

Tank	154401
Cover, Tank	154411
Motor/Pump Assy	154491
Cover, Motor	154421
Float Arm	154452
Switch Holder	154471
Switch	950337
Check Valve	154715

Performance Data

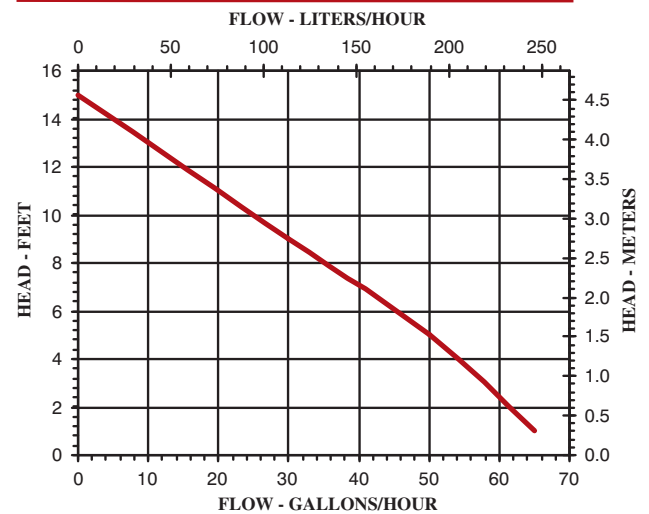

Franklin Electric

P.O. Box 12010
 Oklahoma City, OK 73157-2010
 Phone: 1.800.701.7894
 Fax: 1.800.678.7867
 www.LittleGiantPump.com

©2008 Franklin Electric Co., Inc.
 Little Giant® is a registered trademark of Franklin Electric Co., Inc.
 Form 995124 01/08