



Split Ring Pipe Support J-312-A



Solid Ring Pipe Support J-212-A



Solid Ring Pipe Support with Seat Bumper J-112-A

Pipe Supports

Pipe supports can be used with Sloan Flushometers to help secure the installation. Ideal for use in high vandalism installations, particularly when high rough-in valves have been installed. Pipe supports are designed to accommodate a 1½" diameter tube (when used with a urinal Flushometer Model, install at the top of the Vacuum Breaker Tube).

► **Split Ring Pipe Support J-312-A**

□ YJ Variation

Chrome Plated, Split Ring Pipe Support with adjustable telescoping feature for accurate installation. For existing as well as new Flushometers.

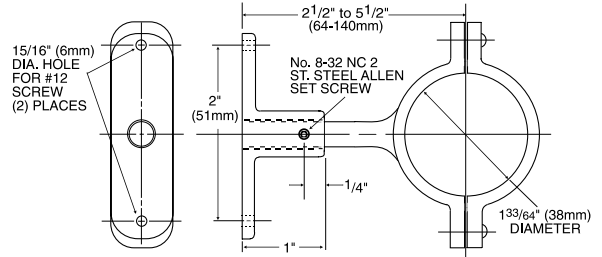

► **Solid Ring Pipe Support J-212-A**

□ YK Variation

Chrome Plated, Solid Ring Pipe Support with adjustable telescoping feature for accurate installation. For new Flushometers.

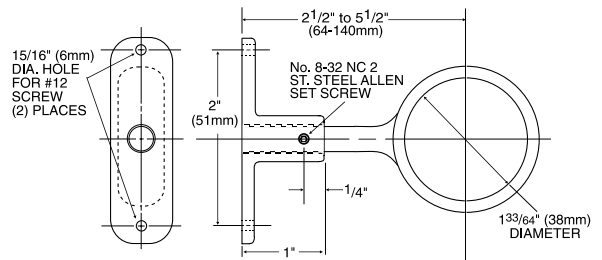

► **Solid Ring Pipe Support with Seat Bumper J-112-A**

□ YL Variation

Chrome Plated, Solid Ring Pipe Support with adjustable telescoping feature for accurate installation. Seat Bumper protects flush tube as well as toilet seat.

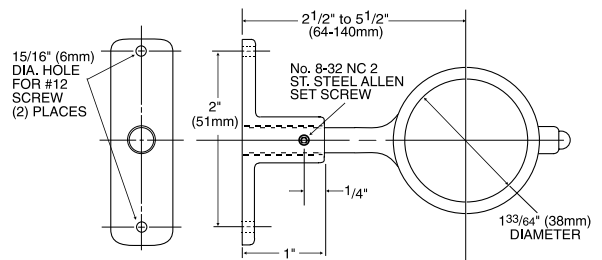

This space for Architect/Engineer approval

The information contained in this document is subject to change without notice.



Made in the U.S.A.

SLOAN VALVE COMPANY • 10500 SEYMOUR AVE. • FRANKLIN PARK, IL. 60131
Ph: 1-800-9-VALVE-9 or 1-847-671-4300 • Fax: 1-800-447-8329 or 1-847-671-4380

<http://www.sloanvalve.com>