

data sheet

94VLF-B series

press end ball valve | lead free



features

- lead free*, ANSI 3rd party certified
- new model - includes expanded range of lever option kits
- full-port flow
- PTFE seats and packing
- adjustable stem packing
- Leak Before Press® feature
- corrosion resistant materials
- 100% factory tested
- 2 year warranty

description

The Apollo International™ 94VLF-B series lead free* two-piece press ball valve is ideal for installation in most plumbing and heating systems, including potable water.

*lead free: the wetted surfaces of this product shall contain no more than 0.25% lead by weighted average. Complies with Federal Public Law 111-380. ANSI 3rd party approved and listed.

approvals

- MSS SP-110 ball valves
- IAPMO/ANSI Z1157 ball valves
- IAPMO PS-117 press connections
- NSF/ANSI/CAN 61 water quality
- NSF/ANSI/CAN 372 lead free
- ASME A112.4.14/CSA B125.14:22

approved applications

- water including potable water
- hydronic heating (90% glycol max)
- not suitable for flammable gas service
- designed for direct mechanical connection to ASTM B88-type K, L, and M copper tubing in the hard drawn condition
- not compatible with soft annealed copper tubing

component	material
body	lead free DZR brass
retainer	lead free DZR brass
ball	type 304 stainless steel
seats	PTFE
stem	brass (½" - 2") type 304 stainless steel (2 ½" - 4")
gland nut	brass
stem packing	PTFE
stem nut	plated steel
handle	plated steel/insulated polyvinyl
washer	plated steel
sealing element	EPDM

performance rating

maximum operating pressure	temperature range
250 psig	0°F - 250°F



this specification is provided for reference only. we reserve the right to change any portion of this specification without notice and without incurring obligation to make such changes to Aalberts integrated piping systems products previously or subsequently sold.

Aalberts integrated piping systems

10715 Sikes Place / suite 200 / Charlotte / NC / 28277

aalberts-ips.us

job name	
job location	
engineer	
contractor	
tag	
PO#	
rep	
wholesaler dist	

data sheet

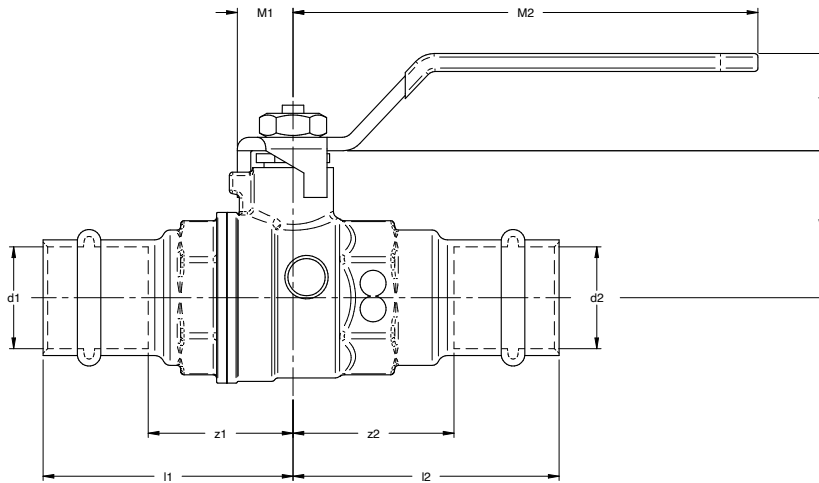

dimensions

1/2" - 2"

part number	size	d1	d2	l1	l2	z1	z2	M1	M2	V	Y	weight
94VLF-103-01B	1/2"	0.63"	0.63"	1.70"	1.70"	0.60"	0.60"	0.51"	3.82"	1.05"	0.61"	0.55 lbs
94VLF-104-01B	3/4"	0.88"	0.88"	1.93"	1.93"	0.75"	0.75"	0.51"	3.82"	1.31"	0.61"	0.56 lbs
94VLF-105-01B	1"	1.13"	1.13"	2.07"	2.07"	0.88"	0.88"	0.59"	4.41"	1.59"	0.71"	0.63 lbs
94VLF-106-01B	1 1/4"	1.38"	1.38"	2.29"	2.29"	1.10"	1.10"	0.69"	5.20"	1.86"	0.87"	1.3 lbs
94VLF-107-01B	1 1/2"	1.63"	1.63"	2.58"	2.58"	1.20"	1.20"	0.69"	5.20"	2.07"	0.87"	1.72 lbs
94VLF-108-01B	2"	2.13"	2.13"	3.00"	3.00"	1.40"	1.40"	0.79"	6.44"	2.42"	1.10"	3.26 lbs

2 1/2" - 4"

part number	size	d1	d2	l1	l2	z1	z2	M1	M2	V	Y	weight
94VLF-109-01B	2 1/2"	2.63"	2.63"	3.25"	3.25"	1.67"	1.67"	1.02"	9.45"	3.12"	1.50"	7.6 lbs
94VLF-100-01B	3"	3.13"	3.13"	3.70"	3.70"	1.91"	1.91"	1.02"	9.45"	3.48"	1.50"	9.6 lbs
94VLF-10A-01B	4"	4.13"	4.13"	4.60"	4.60"	2.48"	2.48"	1.02"	9.45"	4.15"	1.73"	14.2 lbs

kits

part number	size	replacement lever & nut (xxx-xxx-01)	stem extension with mem. stop (xxx-xxx-04) (xxx-xxx-94)	tee handle (xxx-xxx-07)	stainless steel lever & nut (xxx-xxx-10)	latch lock lever & nut (xxx-xxx-27)
94VLF-103-B	1/2"	W234800	78217201	W350312TLF	W234800S	78217303
94VLF-104-B	3/4"	W234900	78217301	W350334TLF	W234900S	78217403
94VLF-105-B	1"	W235000	78217401	W35031TLF	W235000S	78217503
94VLF-106-B	1 1/4"	W235100	78217501	W3503114TLF	W235100S	78217603
94VLF-107-B	1 1/2"	W235200	78217601	--	W235200S	78217703
94VLF-108-B	2"	W235200	78217601	--	W235200S	78217703
94VLF-109-B	2 1/2"	W235300	78217701	--	W235300S	78217803
94VLF-100-B	3"	W235300	78217701	--	W235300S	78217803
94VLF-10A-B	4"	W273800	78217801	--	--	78217903