

Water Filter Housing

Safety Alert Symbols

WARNING

WARNING SIGN: Indicates a potentially hazardous situation which, if not avoided, could result in death or serious injury. It highlights conditions that are a serious risk for personal safety.

CAUTION

CAUTION SIGN: Indicates a potentially hazardous situation which, if not avoided, may result in a minor or moderate injury, and to alert against unsafe practices.

NOTICE

NOTICE SIGN: Alerts you to pertinent facts and conditions.

General Information

CAUTION

PLEASE READ THIS INSTRUCTION MANUAL THOROUGHLY AND CAREFULLY AND UNDERSTAND ITS CONTENTS BEFORE INSTALLING YOUR FILTER HOUSING.

- The information in this instruction manual is subject to modifications without prior notice.

- Keep the instruction manual for future reference.

Product Identification: A label carrying product identification, serial number, production batch is applied on the package of the product. An additional label describing maximum working pressure and maximum working temperature is applied to the filter housing.

The label must not be removed, tampered, hidden, covered, or changed.

If the label on the product is missing or the operational conditions on the label are not legible, applicable working conditions are: max pressure 125 psi (8.6 bar) - max temperature 113°F (45°C).

WARNING

The values of the maximum working temperature and the maximum working pressure shown in the label affixed to the filter housing are intended as maximum working parameters and must not be exceeded under any circumstance.

Precautions, Warnings

READ ALL INSTRUCTIONS AND PRECAUTIONS BEFORE INSTALLING AND USING YOUR PRODUCT.



WARNING

- ⚠ • Before installation ensure that any electric plugs in the vicinity of the area are disconnected.
- ⚠ • Do not install near electric appliances.
- ⚠ • Before the installation, carefully lubricate the housing o-ring which is located at the sump top.
- ⚠ • Do not use with water that is microbiologically unsafe or of unknown quality without adequate disinfection before or after the system. Systems certified for cyst reduction may be used on waters that contain filterable cysts.

CAUTION

Turn off the main water line before installation.

Installation

Refer to figures:

Figure A -General information.

Figure B - IN-OUT directions presentation in different filter housings models.

Figure C -Installation layout:

Before installation, check if the plumbing system has been constructed according to the applicable plumbing code.

- Mount using a wall bracket. If unable to do so, the installer (qualified and licensed personnel) shall be responsible for the most appropriate installation avoiding stress which may affect the housing’s integrity.
- Connect the inlet to the product’s side with the arrow IN and the outlet to the side with the arrow OUT. (Fig. B)
- **Connect to pipes using tapered fittings ONLY in the case of housings specified as NPT in the sticker, preferably with flexible hoses.**
- Connect to pipes using parallel fittings (BSPP) only in the case of housings not specified as NPT in the sticker, preferably with flexible hoses.
- Use only sealing tape as a sealant for the connections.
- The installation of a By-pass is recommended (see Fig. A).
- If the housing is provided complete with cartridge, remove the protective plastic wrap from the cartridge before the use.
- Refer to the Filter Replacement section at the end for step-by-step instructions for the insertion of a (new) cartridge.

Figure A

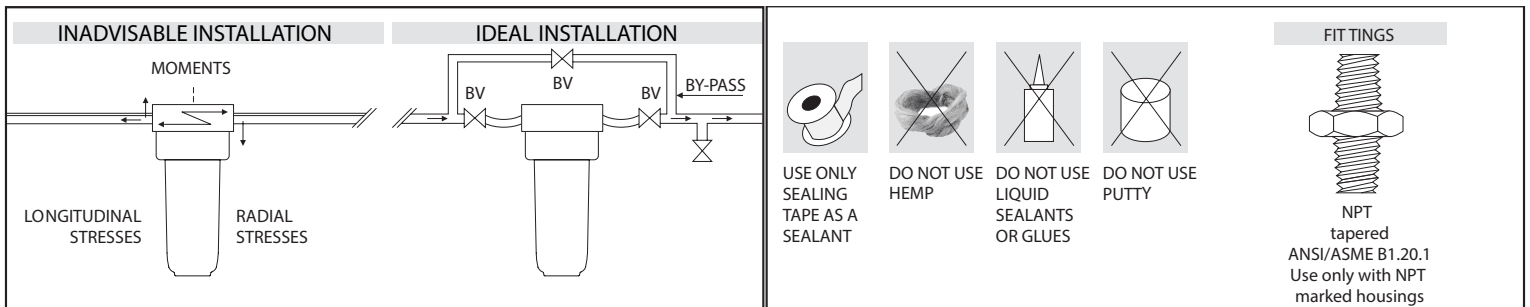
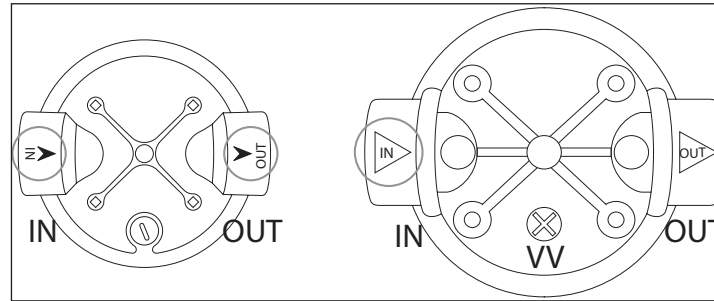

Figure B

Modes for presentation of inlet and outlet directions (arrows) in different filter housing models.



Start Up

- Keep the housing package with sticker (Data Plate) to identify the product.
- Ensure that the sealing is tight and secure.
- After the installation, run the tap and let the water flow for at least 5 minutes before use.

WARNING

Make sure that there are no water leaks from the product, and especially control the tightening between the housing head and the housing sump. In case of leakage, open the housing, remove the o-ring from the bowl, place a new o-ring and apply lubricant.

Use (check the label on the package to identify the filter housing model)

- In case of use for the filtration of drinking water, do not use for filtration of water that is unsafe or of unknown quality. Systems certified for cyst reduction may be used on waters that contain filterable cysts.
- Respect the working parameters shown in the label affixed to the filter housing.
- If pressure exceeds the working conditions, protect the product with a pressure reducer.
- Keep clear filter housings models protected from light. Use only opaque housings models for installation under direct light. The filter housings must be supplied with cold water only.
- Protect from excessive cold or heat: do not expose to temperature below 39°F (4°C) or above 113°F (45°C).
- Protect from back-flows of hot water with a non-return valve.
- Protect from hammering with an anti-hammering device. In case of installation on systems powered by a pump and especially on those equipped with a pressure and flow controller, an additional expansion vessel must be installed upstream the filter to protect it from possible repeated pressure peaks.
- Should the filter (housing + cartridge) be left not in use for more than 1 week replace cartridge/s with new one/s prior to use.

WARNING

Do not use with water that is microbiologically unsafe or of unknown quality without adequate disinfection before or after the system.

CAUTION

-  The values of the maximum working temperature and the maximum working pressure shown in the label affixed to the filter housing are intended as maximum working parameters and must not be exceeded. Use of the filter housing under higher pressure and/or higher temperature conditions could cause ruptures.
- The initial quality of the water will not be optimal unless the tap runs for at least 5 minutes before use.

INSTALLATION LAYOUT

Check from the table for the appropriate device volume (V) depending on piping diameter (Ø).

Figure C

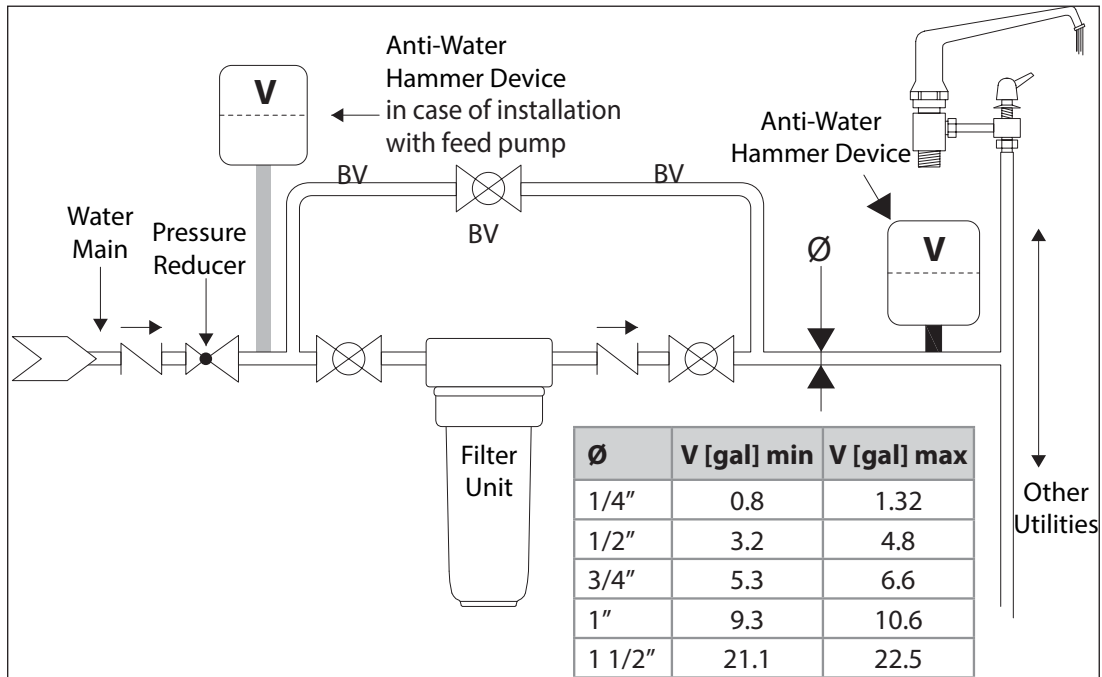

Maintenance

- **Replace the housing sump at least every 5 years.**
- For maintenance and replacement of filter cartridges follow the instructions of the previous chapter.
- **If not in use for more than 1 week remove the filter cartridge, and restart operating as per the maintenance/replacement procedures.**

WARNING

At re-start after every maintenance operation change the o-ring with a new one and carefully lubricate before tightening the sump to the head, then make sure that there are no water leaks. In case of leakage, remove the o-ring from the sump, place a new o-ring and apply lubricant.

CAUTION

After carrying out maintenance operations, run a faucet downstream of the filter for at least 5 minutes before using the water.

FILTER REPLACEMENT

1. Turn off the water main. Place a tray underneath to catch water spillage.

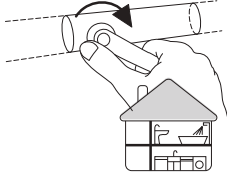

2. Release pressure from the housing by unscrewing the vent valve of the housing head.

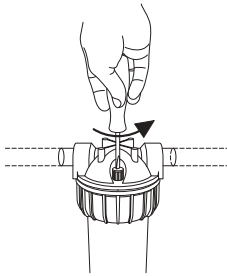

3. Open the housing by unscrewing the bowl from the head.

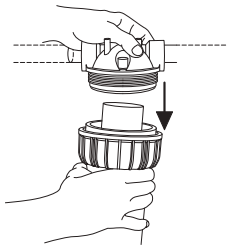

4. Remove the used filter.

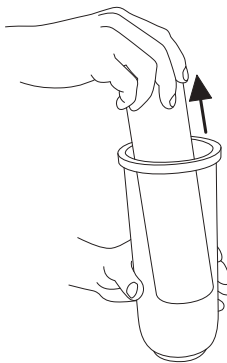

5. Clean the filter housing with cold water and a soft sponge.

6. Unwrap the new filter and place it in the housing. *Make sure the filter is centered in the housing.*

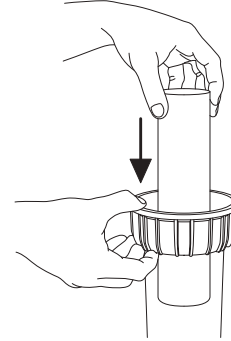

7. Change the O-Ring with a new one and carefully lubricate with Lubrikit, before tightening the sump to the head.

8. Tighten the housing bowl to the head, using the wrench. **DO NOT** overtighten.

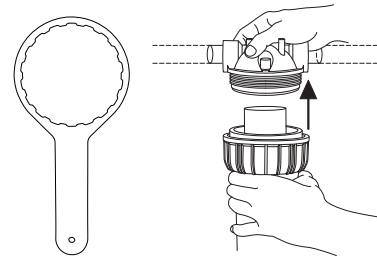

9. Turn on the water main.

10. Slowly turn on the water supply.

11. Wait for air to purge from the vent-valve, then tighten the vent valve.

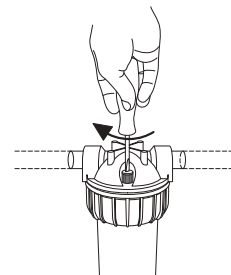

12. Let the water run for at least five minutes before use.

Troubleshooting

MALFUNCTION	CAUSE	REMEDY
Water does not run from faucets	<ul style="list-style-type: none"> - Cartridge clogged - Sump broken - By-pass closed 	<ul style="list-style-type: none"> - Clean the cartridge following the maintenance procedure - Replace the sump and o-ring - Open the closed cut-off valve or by-pass.
Unfiltered water runs from faucets	<ul style="list-style-type: none"> - Cartridge broken - Cartridge gasket damaged 	<ul style="list-style-type: none"> - Replace the cartridge - Replace the cartridge gasket
Water leaks between the filter head and sump.	<ul style="list-style-type: none"> - Sump o-ring damaged - Housing not sufficiently tightened 	<ul style="list-style-type: none"> - Replace the o-ring and lubricate. - Tighten the housing further with the wrench
Water leaks from connections between pipes and from the sides of the filter IN/OUT ports	<ul style="list-style-type: none"> - Sealant insufficient - Improper connection type 	<ul style="list-style-type: none"> - Add a few turns of sealing tape and tighten fittings until snug - Use housings that match the type of fittings as indicated on the data plate. NPT tapered fittings fit only to housing with NPT indication on the data plate.

Filter Housing and Cartridge Disposal

Filters housings and used filter cartridges must be disposed of in accordance with applicable rules and regulations.