



Breeze™ Select
Universal Heat Pump
HEAT PUMP SYSTEMS

PURCHASER	P.O. #	DATE
PROJECT	LOCATION	
ENGINEER	ARCHITECT	
SUBMITTED BY	FOR APPROVAL	FOR REFERENCE

ITEM	PLAN DESIGNATION	QUANTITY	COOLING BTU/H	VOLTAGE	FRIEDRICH MODEL



AIR HANDLER/INDOOR UNITS:



WFH24Y193D, WFH36Y193D



WFH48Y223D, WFH60Y223D

Features

- Universal compatibility to existing air handler or gas furnace (must use R-454B)
- Accommodates long piping runs up to 131 ft. and height differentials up to 98 ft.
- Precision Inverter® delivers efficiencies of up to 18.0 SEER2 and 9HSPF2.
- Operates in extreme temperatures down to -4° F in heat pump mode, with cooling in temperatures as low as 5°F.
- Built-in base pan heater and optional auxiliary heater kit.
- Soft-Start™ technology for quiet start-up, and precise temperature control.
- Quiet operation as low as 54 dB(A).
- Ultra-compact design with a 40% smaller footprint than traditional and top-discharge units.
- 4-way multi-position Air Handler.
- ENERGY STAR® Certified for Cold Climate models available. (2 and 4 ton models)
- Eligible for many federal & local tax credit & rebate incentives.

Heater kits

- AUX5KWA
- AUX7KWA
- AUX10KWA
- AUX15KWA
- AUX20KWA

Thermosmart™ Smart Thermostat

ThermaSmart is a smart, Wi-Fi enabled, thermostat ideally paired with Friedrich's Breeze universal heat pump systems.



Model # SWRT1B

INVERTER HEAT PUMP CONDENSER/OUTDOOR

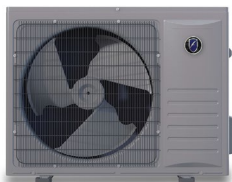

WFPU17Y243D



WFPU17Y363D



WFPU17Y483D



WFPU17Y603D



BREEZE™ | 2-TON UNIVERSAL HEAT PUMP SYSTEM

AIR HANDLER/INDOOR: WFH24Y193D

INVERTER HEAT PUMP CONDENSER/OUTDOOR: WFPU17Y243D



FEATURES

Universal compatibility to existing air handler or gas furnace (with R-454B)

Maximum line length of 98 ft.

Heating down to -4°F (-20°C)

Built-in base pan heater

Optional auxiliary heater kit

4-way Multi-position Air Handler

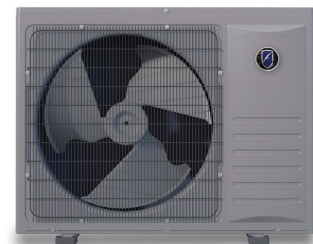

SYSTEM COMPONENTS	
Air Handler/Indoor Model Number	WFH24Y193D
Inverter Heat Pump Condenser/Outdoor Model Number	WFPU17Y243D
ELECTRICAL	
Voltage/Phase/Frequency	208 / 230V, 1-Phase, 60Hz
Voltage Range - V	197 - 253
MCA - Outdoor Unit - A	16
Max Circuit Breaker - Outdoor Unit - A	25
MCA - Indoor Unit - A	3.3
Max Circuit Breaker - Indoor Unit - A	10
Rated Load Amperage (RLA) - A	11.2

CAPACITIES	
Cooling Capacity - Btu-h	24,000
Cooling Capacity Range - Btu-h	6,000 - 24,000
Heating Capacity - Btu-h	24,000
Heating Capacity Range - Btu-h	3,750-25,500
FAN SPEEDS	
Indoor Airflow Rate - CFM rated	800
Outdoor Airflow Rate (H) - CFM	1825
SOUND PRESSURE	
Indoor (H) - dB(A)	55
Sound Pressure Level Outdoor (H) - dB(A)	54
LINESET REQUIREMENTS	
Connection Pipe Diameter - Liquid - in (mm)	3/8 (9.52)
Connection Pipe Diameter - Gas - in (mm)	5/8 (15.88)
Minimum Lineset Length - ft (m)	10 (3.04)
Maximum Lineset Length (Total) - ft (m)	98 (30)
Max Height Difference - ft (m)	66 (20)
Pre-charged Lineset Length -ft (m)	25 (7.6)

STATIC PRESSURE	
Static Pressure Range - inWG (Pa)	0 to 0.8 (0 to 200)
OUTDOOR TEMPERATURE OPERATING RANGE	
Cooling - °F (°C)	5 to 115 (-15 to 46)
Heating - °F (°C)	-4 to 75 (-20 to 24)
TEMPERATURE SET POINT RANGE	
Cooling - °F (°C)	45°F to 95°F (7.2°C to 35°C)
Heating - °F (°C)	45°F to 95°F (7.2°C to 35°C)
Moisture Removal pints/h (L/h)	2.2 (4.6)
EFFICIENCIES	
SEER2	18
EER2	10
HSPF2	8.5
COP2 @ 5 °F	2
ENERGY STAR® Cold Climate	Yes
ENERGY STAR®	No
NET DIMENSIONS & WEIGHTS	
Indoor Unit Net Dimensions (H x W x D) - in	46-1/8 x 19-5/8 x 21-5/8
Indoor Unit Net Dimensions (H x W x D) - mm	1,170 x 500 x 550
Indoor Unit Packing Dimensions (H x W x D) - in	49-5/8 x 22-1/2 x 25-3/8
Indoor Unit Packing Dimensions (H x W x D) - mm	1,260 x 570 x 645
Outdoor Unit Net Dimensions (H x W x D) - in	26-3/8 x 33-7/8 x 12-1/4
Outdoor Unit Net Dimensions (H x W x D) - mm	670 x 860 x 310
Outdoor Unit Packing Dimensions (H x W x D) - in	28-3/4 x 39 x 17-3/4
Outdoor Unit Packing Dimensions (H x W x D) - mm	730 x 990 x 450
Indoor Unit - Net Weight - lbs (kg)	130.5 (59.2)
Indoor Unit - Shipping Weight - lbs (kg)	153.6 (69.7)
Outdoor Unit - Net Weight - lbs (kg)	104.5 (47.4)
Outdoor Unit - Shipping - lbs (kg)	112.2 (50.9)
REFRIGERANT	
Refrigerant Type	R454B
Refrigerant Weight - oz	70.5 oz
Oil type	VG74
COMPRESSOR	
Compressor Type	Rotary Inverter
WARRANTY	

Standard Warranty

10 Year Compressor, 7 Year Parts

Warranty with Registration

10 Year Compressor, 10 Year Parts



Note: Specifications are based on the following conditions:

Cooling: Indoor temperature of 80°F [26.7°C] DB/67°F [19.4°C] WB, and outdoor temperature of 95°F [35°C]DB/75°F [23.9°C] WB, Heating: Indoor temperature of 70°F [21.1°C] DB/60°F [15.6°C] WB, and outdoor temperature of 47°F [8.3°C] DB/43°F [6.1°C] WB. Pipe length: 25ft. [7.5m], Height difference: 0ft. [0m] (Outdoor unit - indoor unit).

Due to continuing research in new energy-saving technology, specifications are subject to change without notice.

BREEZE™ | 3-TON UNIVERSAL HEAT PUMP SYSTEM

AIR HANDLER/INDOOR: WFH36Y193D

INVERTER HEAT PUMP CONDENSER/OUTDOOR: WFPU17Y363D

FEATURES

Universal compatibility to existing air handler or gas furnace (with R-454B)

Maximum line length of 115 ft.

Heating down to -4°F (-20°C)

Built-in base pan heater

Optional auxiliary heater kit

4-way Multi-position Air Handler

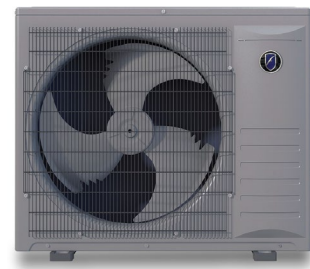

SYSTEM COMPONENTS	
Air Handler/Indoor Model Number	WFH36Y193D
Inverter Heat Pump Condenser/Outdoor Model Number	WFPU17Y363D
ELECTRICAL - Outdoor Unit	
Voltage/Phase/Frequency	208 / 230V, 1-Phase, 60Hz
Voltage Range - V	198 - 253
MCA - Outdoor Unit - A	21
Max Circuit Breaker - Outdoor Unit - A	30
MCA - Indoor Unit - A	4.8
Max Circuit Breaker - Indoor Unit - A	10
Rated Load Amperage (RLA) - A	17.6

CAPACITIES	
Cooling Capacity - Btu-h	35,000
Cooling Capacity Range - BTUh	11,000 - 37,000
Heating Capacity - Btu-h	36,000
Heating Capacity Range - BTUh	10,000 - 37,000

FAN SPEEDS	
Indoor Airflow Rate (H/M/L) - CFM rated	1,120
Outdoor Airflow Rate (H) - CFM	2,350

SOUND PRESSURE	
Indoor (H) - dB(A)	57
Sound Pressure Level Outdoor (H) - dB(A)	57

LINESET REQUIREMENTS	
Connection Pipe Diameter - Liquid - in (mm)	3/8 (9.52)
Connection Pipe Diameter - Gas - in (mm)	5/8 (15.88)
Minimum Lineset Length - ft (m)	10 (3.04)
Maximum Lineset Length (Total) - ft (m)	115 (35)
Max Height Difference - ft (m)	80 (24)
Pre-charged Lineset Length -ft (m)	25 (7.6)

STATIC PRESSURE	
Static Pressure Range - inWG (Pa)	0 to 0.8 (0 to 200)

OUTDOOR TEMPERATURE OPERATING RANGE	
Cooling - °F (°C)	5 to 115 (-15 to 46)
Heating - °F (°C)	-4 to 75 (-20 to 24)

TEMPERATURE SET POINT RANGE	
Cooling - °F (°C)	45°F to 95°F (7.2°C to 35°C)
Heating - °F (°C)	45°F to 95°F (7.2°C to 35°C)
Moisture Removal pints/h (L/h)	4.5 (9.5)

EFFICIENCIES	
SEER2	17.5
EER2	9.8
HSPF2	8.50
COP2 @ 5 °F	2
ENERGY STAR® Cold Climate	No
ENERGY STAR®	No

NET DIMENSIONS & WEIGHTS	
Indoor Unit Net Dimensions (H x W x D) - in	46-1/8 x 19-5/8 x 21-5/8
Indoor Unit Net Dimensions (H x W x D) - mm	1,170 x 500 x 550
Indoor Unit Packing Dimensions (H x W x D) - in	49-5/8 x 22-1/2 x 25-3/8
Indoor Unit Packing Dimensions (H x W x D) -mm	1,260 x 570 x 645
Outdoor Unit Net Dimensions (H x W x D) - in	29-1/2 x 37-3/8 x 13-3/8
Outdoor Unit Net Dimensions (H x W x D) - mm	840 x 950 x 340
Outdoor Unit Packing Dimensions (H x W x D) - in	32-5/8 x 41 x 18 1/8
Outdoor Unit Packing Dimensions (H x W x D)mm	829 x 1,041 x 460
Indoor Unit - Net Weight - lbs (kg)	135.1 (63.5)
Indoor Unit - Shipping Weight - lbs (kg)	158.1 (74)
Outdoor Unit - Net Weight - lbs (kg)	116.8 (53)
Outdoor Unit - Shipping - lbs (kg)	125.7 (57)

REFRIGERANT	
Refrigerant Type	R454B
Refrigerant Weight - oz	88.2 oz
Oil type	VG74

COMPRESSOR	
Compressor Type	Rotary Inverter

WARRANTY	
----------	--

Standard Warranty

10 Year Compressor, 7 Year Parts

Warranty with Registration

10 Year Compressor, 10 Year Parts



Note: Specifications are based on the following conditions:

Cooling: Indoor temperature of 80°F [26.7°C] DB/67°F [19.4°C] WB, and outdoor temperature of 95°F [35°C]DB/75°F [23.9°C] WB, Heating: Indoor temperature of 70°F [21.1°C] DB/60°F [15.6°C] WB, and outdoor temperature of 47°F [8.3°C] DB/43°F [6.1°C] WB. Pipe length: 25ft. (7.5m), Height difference: 0ft. (0m) [Outdoor unit - indoor unit].

Due to continuing research in new energy-saving technology, specifications are subject to change without notice.

BREEZE™ | 4-TON UNIVERSAL HEAT PUMP SYSTEM

AIR HANDLER/INDOOR: WFH48Y223D

INVERTER HEAT PUMP CONDENSER/OUTDOOR: WFPU17Y483D



FEATURES

Universal compatibility to existing air handler or gas furnace (with R-454B)
Maximum line length of 131 ft.
Heating down to -4°F (-20°C)
Built-in base pan heater
Optional auxiliary heater kit
4-way Multi-position Air Handler

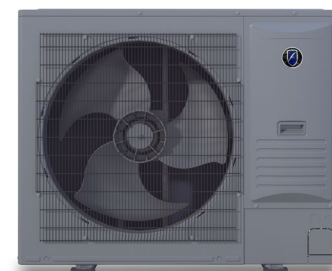

SYSTEM COMPONENTS	
Air Handler/Indoor Model Number	WFH48Y223D
Inverter Heat Pump Condenser/Outdoor Model Number	WFPU17Y483D
ELECTRICAL - Outdoor Unit	
Voltage/Phase/Frequency	208 / 230V, 1-Phase, 60Hz
Voltage Range - V	198 - 253
MCA - Outdoor Unit - A	33
Max Circuit Breaker - Outdoor Unit - A	50
MCA - Indoor Unit - A	6.8
Max Circuit Breaker - Indoor Unit - A	15
Rated Load Amperage (RLA) - A	21.8

CAPACITIES	
Cooling Capacity - Btu-h	48000
Cooling Capacity Range - Btu-h	14000 - 48600
Heating Capacity - Btu-h	48000
Heating Capacity Range - Btu-h	7490 - 49300
FAN SPEEDS	
Indoor Airflow Rate - CFM rated	1706
Outdoor Airflow Rate (H) - CFM	3525
SOUND PRESSURE	
Indoor (H) - dB(A)	57
Sound Pressure Level Outdoor (H) - dB(A)	59
LINESET REQUIREMENTS	
Connection Pipe Diameter - Liquid - in (mm)	3/8 (9.52)
Connection Pipe Diameter - Gas (Flare) - in (mm)	3/4 (19.05)
Minimum Lineset Length - ft (m)	10(3.04)
Maximum Lineset Length (Total) - ft (m)	131 (40)
Max Height Difference - ft (m)	100 (30.5)
Pre-charged Lineset Length -ft (m)	24.6 (7.5)



STATIC PRESSURE	
Static Pressure Range - inWG (Pa)	0 to 0.8 (0 to 200)
OUTDOOR TEMPERATURE OPERATING RANGE	
Cooling - °F (°C)	5 to 115 (-15 to 46)
Heating - °F (°C)	-4 to 75 (-20 to 24)
TEMPERATURE SET POINT RANGE	
Cooling - °F (°C)	45°F to 95°F (7.2°C to 35°C)
Heating - °F (°C)	45°F to 95°F (7.2°C to 35°C)
Moisture Removal pints/h (L/h)	6.2 (13.2)
EFFICIENCIES	
SEER2	18
EER2	10
HSPF2	9
COP2 @ 5 °F	2
ENERGY STAR® Cold Climate	Yes
ENERGY STAR®	No
NET DIMENSIONS & WEIGHTS	
Indoor Unit Net Dimensions (H x W x D) - in	53-7/8 x 22 x 24
Indoor Unit Net Dimensions (H x W x D) - mm	1,370 x 560 x 610
Indoor Unit Packing Dimensions (H x W x D) - in	55-1/2 x 25-1/4 x 28
Indoor Unit Packing Dimensions (H x W x D) - mm	1,410 x 640 x 710
Outdoor Unit Net Dimensions (H x W x D) - in	34-1/2 x 43-1/4 x 17-3/4
Outdoor Unit Net Dimensions (H x W x D) - mm	850 x 1099 x 451
Outdoor Unit Packing Dimensions (H x W x D) - in	39-1/2 x 45-7/8 x 21-1/4
Outdoor Unit Packing Dimensions (H x W x D) - mm	1,007 x 1,165 x 540
Indoor Unit - Net Weight - lbs (kg)	180.6 (82)
Indoor Unit - Shipping Weight - lbs (kg)	204 (92.5)
Outdoor Unit - Net Weight - lbs (kg)	186.7 (84.7)
Outdoor Unit - Shipping - lbs (kg)	210.9 (95.7)
REFRIGERANT	
Refrigerant Type	R454B
Refrigerant Weight - oz	137.6 oz
Oil type	VG74
COMPRESSOR	
Compressor Type	Rotary Inverter
WARRANTY	

Standard Warranty

10 Year Compressor, 7 Year Parts

Warranty with Registration

10 Year Compressor, 10 Year Parts

Note: Specifications are based on the following conditions:

Cooling: Indoor temperature of 80°F (26.7°C) DB/67°F (19.4°C) WB, and outdoor temperature of 95°F (35°C) DB/75°F (23.9°C) WB, Heating: Indoor temperature of 70°F (21.1°C) DB/60°F (15.6°C) WB, and outdoor temperature of 47°F (8.3°C) DB/43°F (6.1°C) WB. Pipe length: 25ft. (7.5m), Height difference: 0ft. (0m) [Outdoor unit - indoor unit].

Due to continuing research in new energy-saving technology, specifications are subject to change without notice.

BREEZE™ | 5-TON UNIVERSAL HEAT PUMP SYSTEM

AIR HANDLER/INDOOR WFH60Y223D

INVERTER HEAT PUMP CONDENSER/OUTDOOR: WFPU17Y603D

FEATURES

Universal compatibility to existing air handler or gas furnace (with R-454B)
Maximum line length of 131 ft.
Heating down to -4°F (-20°C)
Built-in base pan heater
Optional auxiliary heater kit
4-way Multi-position Air Handler

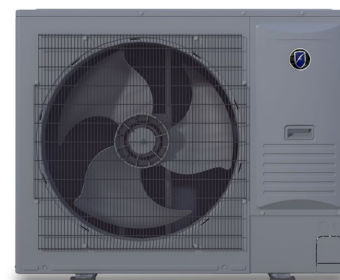

SYSTEM COMPONENTS	
Air Handler/Indoor Model Number	WFH60Z223C
Inverter Heat Pump Condenser/Outdoor Model Number	WFPU17Z603C
ELECTRICAL - Outdoor Unit	
Voltage/Phase/Frequency	208 / 230V, 1-Phase, 60Hz
Voltage Range - V	198 - 253
MCA - Outdoor Unit - A	33
Max Circuit Breaker - Outdoor Unit - A	50
MCA - Indoor Unit - A	6.8
Max Circuit Breaker - Indoor Unit - A	10
Rated Load Amperage (RLA) - A	31.0

CAPACITIES	
Cooling Capacity - Btu-h	54000
Cooling Capacity Range - Btu-h	14000 - 48600
Heating Capacity - Btu-h	55000
Heating Capacity Range - BTUh	7490 - 57300
FAN SPEEDS	
Indoor Airflow Rate - CFM rated	1706
Outdoor Airflow Rate (H) - CFM	3525
SOUND PRESSURE	
Indoor (H) - dB(A)	65
Sound Pressure Level Outdoor (H) - dB(A)	60
LINESET REQUIREMENTS	
Connection Pipe Diameter - Liquid - in (mm)	3/8 (9.52)
Connection Pipe Diameter - Gas - in (mm)	3/4 (19.05)
Minimum Lineset Length - ft (m)	10(3.04)
Maximum Lineset Length (Total) - ft (m)	131 (40)
Max Height Difference - ft (m)	100 (30.5)
Pre-charged Lineset Length -ft (m)	25 (7.5)



STATIC PRESSURE	
Static Pressure Range - inWG (Pa)	0 to 0.8 (0 to 200)
OUTDOOR TEMPERATURE OPERATING RANGE	
Cooling - °F (°C)	5 to 115 (-15 to 46)
Heating - °F (°C)	-4 to 75 (-20 to 24)
TEMPERATURE SET RANGE	
Cooling - °F (°C)	45°F to 95°F (7.2°C to 35°C)
Heating - °F (°C)	45°F to 95°F (7.2°C to 35°C)
Moisture Removal pints/h (L/h)	7.5 (15.8)
EFFICIENCIES	
SEER2	17.00
EER2	8.8
HSPF2	9.0
COP2 @ 5 °F	1.95
ENERGY STAR® COLD CLIMATE	No
ENERGY STAR®	No
NET DIMENSIONS & WEIGHTS	
Indoor Unit Net Dimensions (H x W x D) - in	53-7/8 x 22 x 24
Indoor Unit Net Dimensions (H x W x D) - mm	1,370 x 560 x 610
Indoor Unit Packing Dimensions (H x W x D) - in	55-1/2 x 25-1/4 x 28
Indoor Unit Packing Dimensions (H x W x D) - mm	1,410 x 640 x 710
Outdoor Unit Net Dimensions (H x W x D) - in	34-1/2 x 43-1/4 x 17-3/4
Outdoor Unit Net Dimensions (H x W x D) - mm	876 x 1099 x 451
Outdoor Unit Packing Dimensions (H x W x D) - in	39-1/2 x 45-7/8 x 21-1/4
Outdoor Unit Packing Dimensions (H x W x D) - mm	1006 x 1,165 x 540
Indoor Unit - Net Weight - lbs (kg)	180.6 (81.9)
Indoor Unit - Shipping Weight - lbs (kg)	204.4 (92.7)
Outdoor Unit - Net Weight - lbs (kg)	186.7 (84.7)
Outdoor Unit - Shipping - lbs (kg)	210.9 (95.7)
REFRIGERANT	
Refrigerant Type	R454B
Refrigerant Weight - oz	137.6 oz
Oil type	VG74
COMPRESSOR	
Compressor Type	Rotary Inverter
WARRANTY	

Standard Warranty

10 Year Compressor, 7 Year Parts

Warranty with Registration

10 Year Compressor, 10 Year Parts

Note: Specifications are based on the following conditions:
Cooling: Indoor temperature of 80°F (26.7°C) DB/67°F (19.4°C) WB, and outdoor temperature of 95°F (35°C) DB/75°F (23.9°C) WB, Heating: Indoor temperature of 70°F (21.1°C) DB/60°F (15.6°C) WB, and outdoor temperature of 47°F (8.3°C) DB/43°F (6.1°C) WB. Pipe length: 25ft. (7.5m), Height difference: 0ft. (0m) (Outdoor unit - indoor unit).

Due to continuing research in new energy-saving technology, specifications are subject to change without notice.



BREEZE™ | AIR HANDLER/INDOOR DIMENSIONS

AIR HANDLER/INDOOR MODELS: WFH24Y193D (2-TON), WFH36Y193D (3-TON)

Unit : in.(mm)

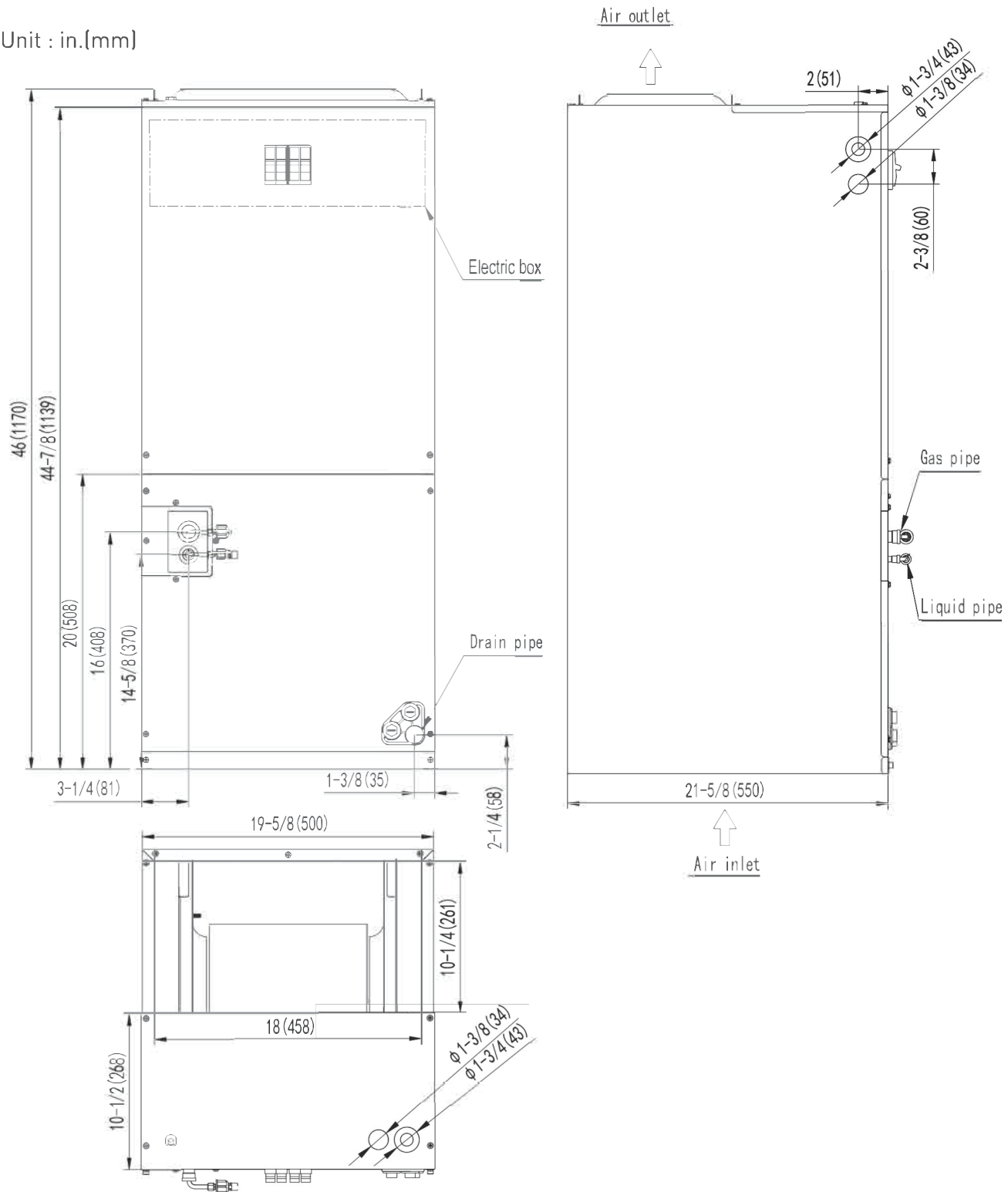

BREEZE™ | AIR HANDLER/INDOOR DIMENSIONS

AIR HANDLER/INDOOR MODELS: WFH48Y223D (4-TON), WFH60Y223D (5-TON)

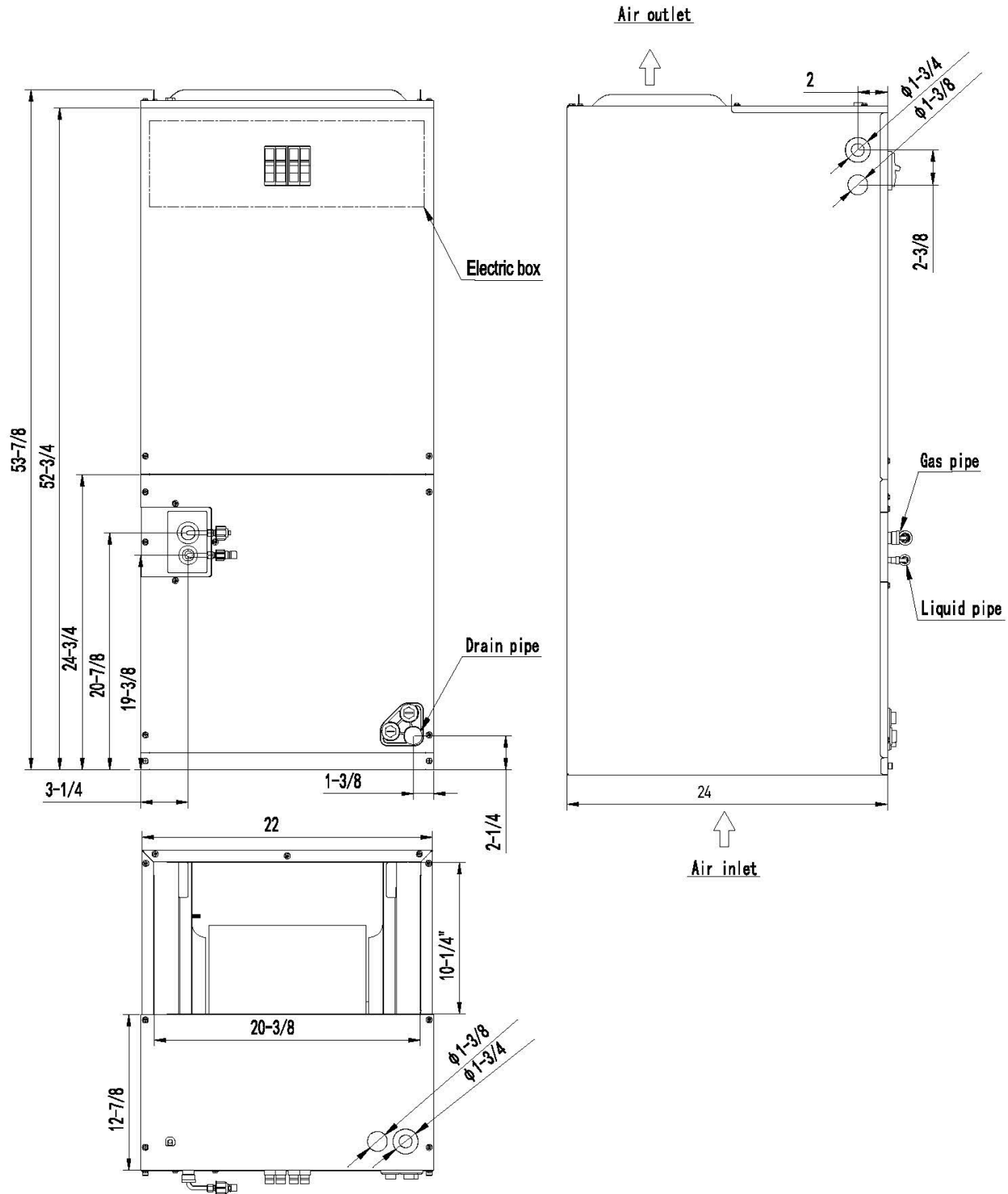

BREEZE™ Select | CONDENSER/OUTDOOR DIMENSIONS

INVERTER HEAT PUMP CONDENSER/OUTDOOR: WFPU17Y243D (2-TON)

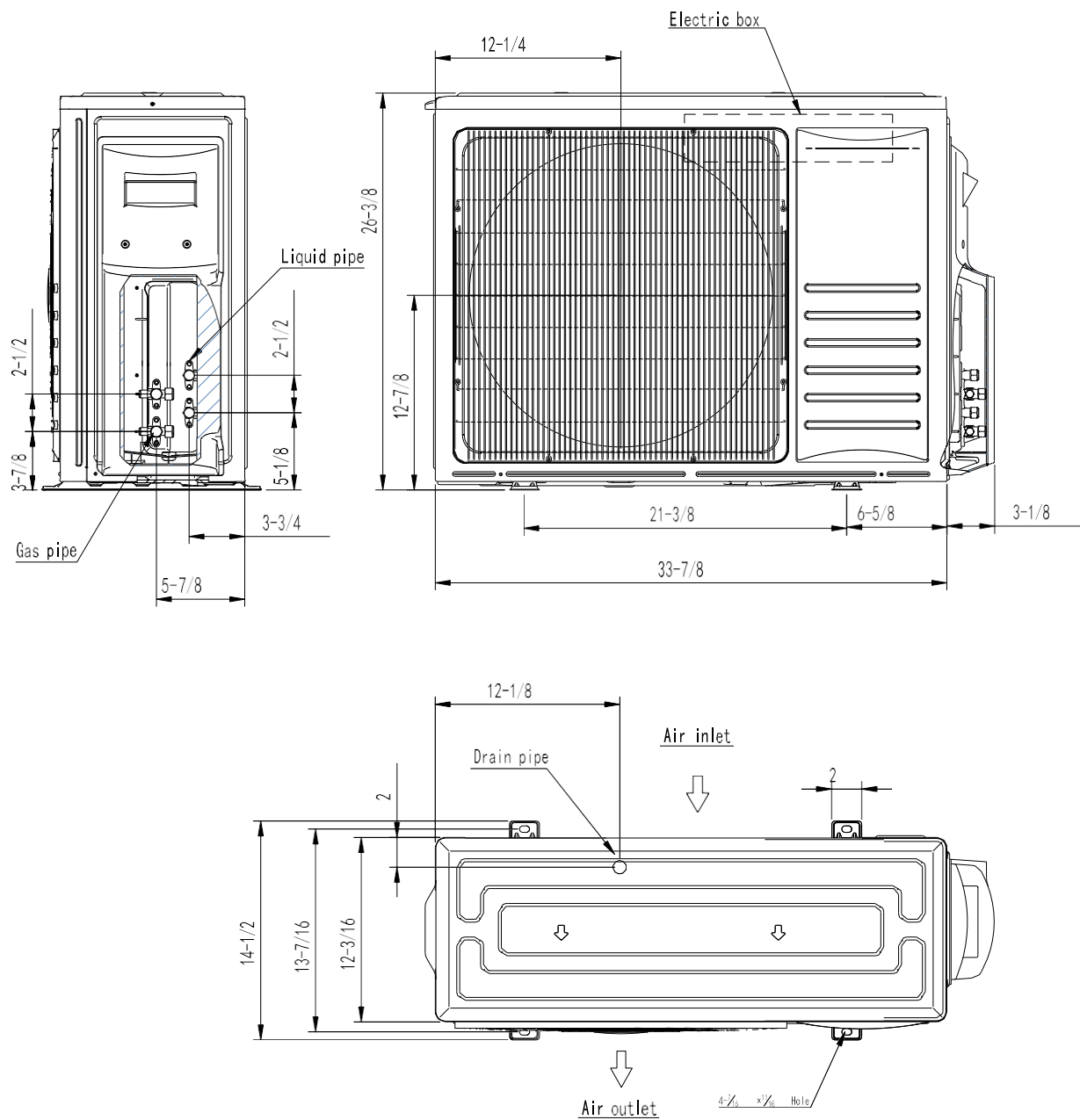

BREEZE™ Select | CONDENSER/OUTDOOR DIMENSIONS

INVERTER HEAT PUMP CONDENSER/OUTDOOR : WFPU17Y363D (3-TON)

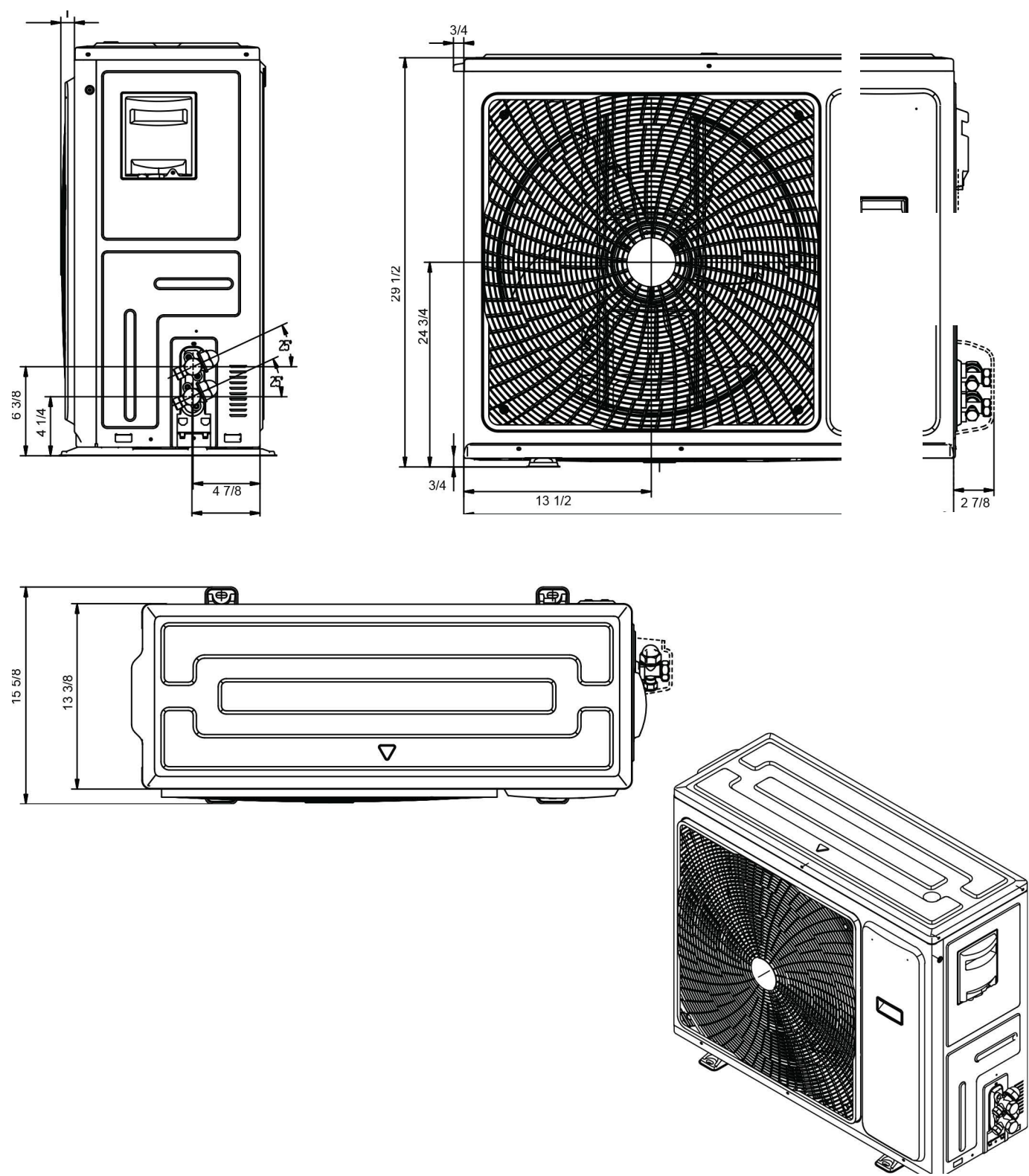

BREEZE™ Select | CONDENSER/OUTDOOR DIMENSIONS

INVERTER HEAT PUMP CONDENSER/OUTDOOR: WFPU17Y483D (4-TON)

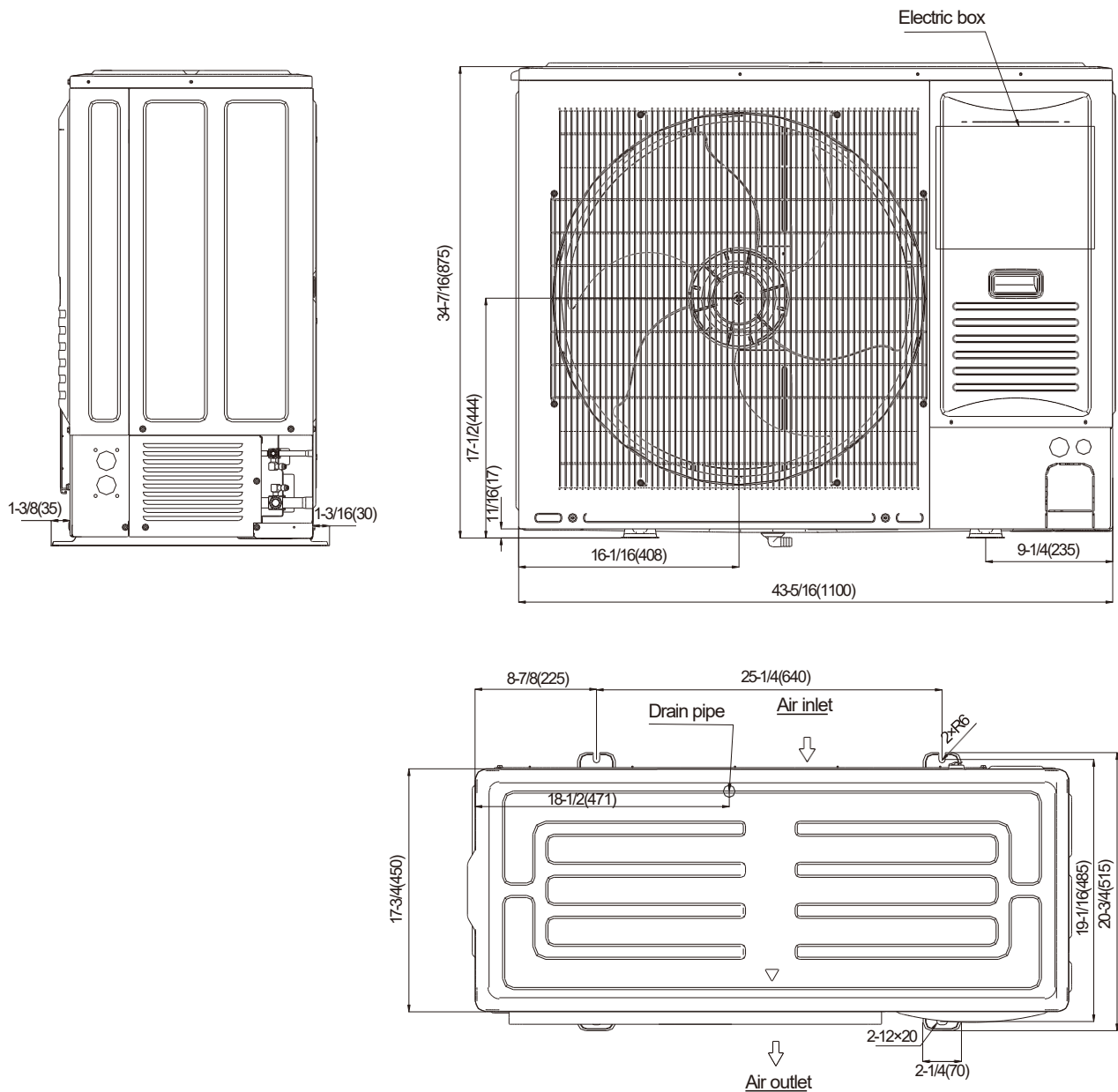

BREEZE™ Select | CONDENSER/OUTDOOR DIMENSIONS

INVERTER HEAT PUMP CONDENSER/OUTDOOR: WFPU17Y603D (5-TON)

Unit : in.(mm)

