



No. 20 Tee



No. 10 Elbow

1.0 PRODUCT DESCRIPTION

Available Sizes

- ¾ – 60"/DN20 – DN1500

Maximum Working Pressure

- Pressure ratings for Victaulic standard fittings conform to the ratings of Victaulic Style 177N couplings (refer to [publication 06.24](#) for more information).

Application

- Connects pipe, provides change in direction and adapts sizes or components
- Supplied with Victaulic OGS grooves
- Exclusively for use with Victaulic couplings, valves, accessories and pipe which feature ends formed with the Victaulic OGS groove profile

Pipe Materials

- Carbon steel or stainless steel

NOTE

- These fittings are not intended for use with Victaulic plain end couplings. Intended for use only in grooved piping systems. When connecting wafer or lug type butterfly valves directly to Victaulic fittings using Style 741 or Style 743 flange adapters, be sure to check disc clearance dimensions with I.D. dimension of fitting.

ALWAYS REFER TO ANY NOTIFICATIONS AT THE END OF THIS DOCUMENT REGARDING PRODUCT INSTALLATION, MAINTENANCE OR SUPPORT.

System No.		Location	
Submitted By		Date	

Spec Section		Paragraph	
Approved		Date	

2.0 CERTIFICATION/LISTINGS



NOTES

- When supplied as “hot dip galvanized” the following fittings are UL Classified in accordance with ANSI/NSF 61 and for use on cold +86°F/+30°C potable water service and ANSI/NSF 372: No. 10 90° Elbow, No. 11 45° Elbow, No. 12 22 ½° Elbow, No. 13 11 ¼° Elbow, No. 100 90° Long Radius Elbow, No. 110 45° Long Radius Elbow, No. 20 Tee, No. 25 Tee with Grooved Branch, No. 30 45° Lateral, No. 60 Cap, No. 50 Concentric Reducers, No. 51 Eccentric Reducers.
- The following Victaulic fittings are VdS approved: No.10 90° Elbow, No.11 45° Elbow, No.20 Tee and No.60 Cap.
- The following Victaulic fittings are LPCB approved: No.10 90° Elbow, No.11 45° Elbow, No.12 22 ½° Elbow, No.13 11 ¼° Elbow, No.30 45° Lateral, No.30-R Reducing Lateral, No.100 Long Radius Elbow, No.110 Long Radius Elbow, No.20 Tee, No.35 Cross, No.60 Cap, No.25 Reducing Tee, No.33 True Wye, No.50 Concentric Reducer, No.51 Eccentric Reducer and No.29M Tee with Threaded Branch.
- The following Victaulic fittings are FM approved: No.10 90° Elbow, No.11 45° Elbow, No.12 22 ½° Elbow, No.13 11 ¼° Elbow, No.30 45° Lateral, No.100 Long Radius Elbow, No.20 Tee, No.35 Cross, No.60 Cap, No.25 Reducing Tee and No.50 Concentric Reducer.

3.0 SPECIFICATIONS - MATERIAL

Fitting: (specify choice)

Standard: Ductile iron conforming to ASTM A536, Grade 65-45-12.

Optional: Segmentally welded steel as shown under nipples

Nipples: (specify choice)

¾ – 4"/DN20 – DN100: Carbon steel, Schedule 40, conforming to ASTM A53, Type F

5 – 6"/DN125 – DN150: Carbon steel, Schedule 40, conforming to ASTM A53, Type E or S, Gr. B

8 – 12"/DN200 – DN300: Carbon steel, Schedule 30 or 40, conforming to ASTM A53, Type E or S, Gr. B

Flanged Adapter Nipples: (specify choice)

Class 125 Flange: Cast iron conforming to ANSI B16.1

Class 150 Flange: Carbon steel conforming to ANSI B16.5, raised or flat face

Class 300 Flange: Carbon steel conforming to ANSI B16.5, raised or flat face

Fitting Coating: (specify choice)

Standard: Orange enamel

Optional: Hot dip galvanized and others. Some fittings supplied electroplated as standard – see product specifications

Flanged Adapter Nipple Coating: (specify choice)

Standard: None (Unfinished)

Optional: Orange enamel, hot dip galvanized and others

4.4 DIMENSIONS

Reducing Tee

No. 25 Grooved Branch

No. 29T Threaded Branch

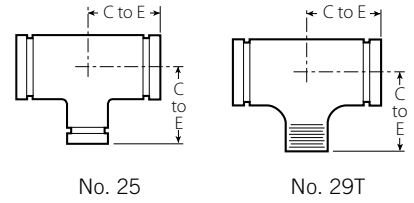
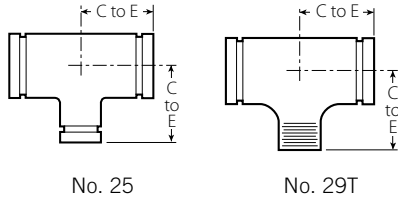

Size			No. 25 Std.	No. 29T w/ Thd. Branch	Approx. Weight (Each) lb kg	
Nominal inches DN			C to E inches mm	C to E inches mm		
1 DN25	x	1 DN25	2.25 (sw) 57	2.25 (sw) 57	1.0 0.5	
1 1/4 DN32	x	1 1/4 DN32	2.75 (sw) 70	2.75 (sw) 70	1.3 0.6	
1 1/2 DN40	x	1 1/2 DN40	3/4 DN20	2.75 (sw) 70	2.75 (sw) 70	1.5 0.7
			1 DN25	2.75 (sw) 70	2.75 (sw) 70	1.5 0.7
			1 1/4 DN32	2.75 (sw) 70	2.75 (sw) 70	1.7 0.8
2 DN50	x	2 DN50	3/4 DN20	3.25 83	3.25 83	2.5 1.1
			1 DN25	3.25 83	3.25 83	2.7 1.2
			1 1/4 DN32	3.25 (sw) 83	3.25 (sw) 83	1.8 0.8
			1 1/2 DN40	3.25 83	3.25 (sw) 83	3.0 1.4
2 1/2	x	2 1/2	3/4 DN20	3.75 (sw) 95	3.75 (sw) 95	3.9 1.8
			1 DN25	3.75 95	3.75 (sw) 95	3.8 1.7
			1 1/4 DN32	3.75 95	3.75 95	4.2 1.7
			1 1/2 DN40	3.75 95	3.75 95	3.9 1.8
			2 DN50	3.75 95	3.75 (sw) 95	4.5 2.0
3 DN80	x	3 DN80	3/4 DN20	4.25 (sw) 108	4.25 (sw) 108	5.7 2.6
			1 DN25	4.25 108	4.25 108	6.1 2.8
			1 1/4 DN32	4.25 108	4.25 108	8.0 3.6
			1 1/2 DN40	4.25 108	4.25 (sw) 108	6.5 2.9
			2 DN50	4.25 108	4.25 (sw) 108	6.2 2.8
			2 1/2	4.25 108	4.25 (sw) 108	6.4 2.9

(s) = Carbon Steel Direct Roll Groove (OGS)

(sw) = Carbon Steel Segmentally Welded

NOTE

- Cast fitting available. Contact Victaulic for details.

Size			No. 25 Std.	No. 29T w/ Thd. Branch	Approx. Weight (Each) lb kg				
Nominal inches DN			C to E inches mm	C to E inches mm					
4 DN100	x	4 DN100	3/4 DN20	5.00 (sw) 127	5.00 (sw) 127	8.0 3.6			
			1 DN25	5.00 127	5.00 127	7.8 3.5			
			1 1/4 DN32	5.00 (sw) 127	5.00 (sw) 127	9.6 4.4			
			1 1/2 DN40	5.00 127	5.00 127	10.2 4.6			
			2 DN50	5.00 127	5.00 127	11.2 5.1			
			2 1/2	5.00 127	5.00 127	11.4 5.2			
			3 DN80	5.00 127	5.00 127	11.6 5.3			
			5	x	5	1 DN25	5.50 (sw) 140	5.50 (sw) 140	14.0 6.4
						1 1/2 DN40	5.50 (sw) 140	5.50 (sw) 140	14.3 6.5
						2 DN50	5.50 (sw) 140	5.50 (sw) 140	14.5 6.6
2 1/2	5.50 140	5.50 (sw) 140				15.2 6.9			
3 DN80	5.50 140	5.50 (sw) 140				16.6 7.5			
4 DN100	5.50 140	5.50 (sw) 140				16.7 7.6			
6 DN150	x	6 DN150	1 DN25	6.50 (sw) 165	6.50 (sw) 165	23.0 10.4			
			1 1/2 DN40	6.50 (sw) 165	6.50 (sw) 165	24.0 10.9			
			2 DN50	6.50 165	6.50 165	21.6 9.8			
			2 1/2	6.50 165	6.50 165	21.4 11.7			
			3 DN80	6.50 165	6.50 165	26.5 12.0			
			4 DN100	6.50 165	6.50 165	25.0 11.3			
6 1/2	x	6 1/2	3 DN80	6.50 165	6.50 (sw) 165	24.0 10.9			
			4 DN100	6.50 165	6.50 (sw) 165	25.0 11.3			

(s) = Carbon Steel Direct Roll Groove (OGS)

(sw) = Carbon Steel Segmentally Welded

NOTE

- Cast fitting available. Contact Victaulic for details.

4.4 DIMENSIONS (Continued)

Reducing Tee

No. 25 Grooved Branch
 No. 29T Threaded Branch

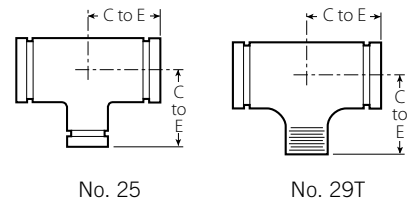
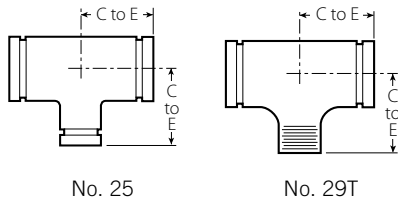

Size		No. 25 Std.	No. 29T w/ Thd. Branch	Approx. Weight (Each)	
Nominal inches DN		C to E inches mm	C to E inches mm	lb kg	
8 DN200 x 8 DN200	1 1/2 DN40	7.75 (sw) 197	7.75 (sw) 197	33.0 15.0	
	2 DN50	7.75 (sw) 197	7.75 (sw) 197	33.5 15.2	
	2 1/2	7.75 (sw) 197	7.75 (sw) 197	39.0 17.7	
	3 DN80	7.75 (sw) 197	7.75 (sw) 197	33.6 15.2	
	4 DN100	7.75 197	7.75 197	41.8 19.0	
	5	7.75 (sw) 197	7.75 (sw) 197	34.0 15.4	
	6 DN150	7.75 197	7.75 197	42.3 19.2	
	165.1mm	7.75 (sw) 197	7.75 (sw) 197	48.0 21.8	
	10 DN250 x 10 DN250	1 1/2 DN40	9.00 229	9.00 229	62.0 28.1
		2 DN50	9.00 (sw) 229	9.00 (sw) 229	62.0 28.1
2 1/2		9.00 (sw) 229	9.00 (sw) 229	62.4 28.3	
3 DN80		9.00 (sw) 229	9.00 (sw) 229	60.0 27.2	
4 DN100		9.00 (sw) 229	9.00 (sw) 229	61.0 27.7	
5		9.00 (sw) 229	9.00 (sw) 229	52.0 23.6	
6 DN150		9.00 (sw) 229	9.00 (sw) 229	59.0 26.8	
8 DN200		9.00 (sw) 229	9.00 (sw) 229	64.7 29.3	

(s) = Carbon Steel Direct Roll Groove (OGS)
 (sw) = Carbon Steel Segmentally Welded

NOTE

- Cast fitting available. Contact Victaulic for details.

Size		No. 25 Std.	No. 29T w/ Thd. Branch	Approx. Weight (Each)	
Nominal inches DN		C to E inches mm	C to E inches mm	lb kg	
12 DN300 x 12 DN300	1 DN25	10.00 (sw) 254	10.00 (sw) 254	77.0 34.9	
	2 DN50	10.00 (sw) 254	10.00 (sw) 254	80.0 36.3	
	2 1/2	10.00 (sw) 254	10.00 (sw) 254	78.0 35.4	
	3 DN80	10.00 (sw) 254	10.00 (sw) 254	82.0 37.2	
	4 DN100	10.00 (sw) 254	10.00 (sw) 254	80.0 36.3	
	5	10.00 (sw) 254	10.00 (sw) 254	75.0 34.0	
	6 DN150	10.00 (sw) 254	10.00 (sw) 254	75.0 34.0	
	8 DN200	10.00 (sw) 254	10.00 (sw) 254	80.0 36.3	
	10 DN250	10.00 (sw) 254	10.00 (sw) 254	84.0 38.1	
	14 ² DN350 x 14 DN350	4 DN100	11.00 (sw) 279	11.00 (sw) 279	102.0 46.3
6 DN150		11.00 (sw) 279	11.00 (sw) 279	108.2 49.1	
8 DN200		11.00 279	11.00 279	112.0 50.8	
10 DN250		11.00 279	11.00 279	120.0 54.4	
12 DN300		11.00 279	11.00 279	129.1 58.6	
16 ² DN400 x 16 DN400		4 DN100	12.00 305	12.00 305	130.0 59.0
		6 DN150	12.00 (sw) 305	12.00 (sw) 305	133.5 60.6
	8 DN200	12.00 305	12.00 305	145.0 65.8	
	10 DN250	12.00 305	12.00 305	149.5 67.8	
	12 DN300	12.00 305	12.00 305	154.0 69.9	
	14 DN350	12.00 (sw) 305	—	167.0 75.8	

² For 14"/DN350 and larger roll grooved systems, Victaulic offers the Advanced Groove System (AGS). For pricing and availability of cut groove fittings in this size, contact your nearest Victaulic sales representative.

(s) = Carbon Steel Direct Roll Groove (OGS)
 (sw) = Carbon Steel Segmentally Welded

NOTE

- Cast fitting available. Contact Victaulic for details.

4.4 DIMENSIONS (Continued)

Reducing Tee

No. 25 Grooved Branch

No. 29T Threaded Branch

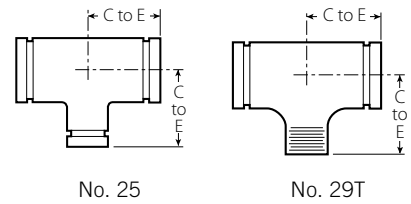
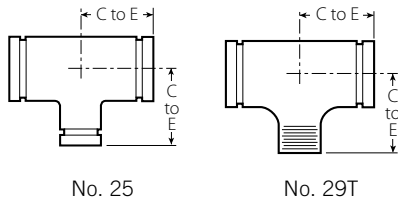

Size		No. 25 Std.	No. 29T w/ Thd. Branch	Approx. Weight (Each)			
Nominal inches	DN	C to E inches	C to E inches	lb			
		mm	mm	kg			
18 ² DN450	x 18 DN450	4 DN100	15.50 (sw) 394	15.50 (sw) 394	194.0 88.0		
		6 DN150	15.50 (sw) 394	15.50 (sw) 394	200.0 90.7		
		8 DN200	15.50 (sw) 394	15.50 (sw) 394	202.0 91.6		
		10 DN250	15.50 394	15.50 394	212.0 96.2		
		12 DN300	15.50 394	15.50 394	222.6 101.0		
		14 DN350	15.50 394	—	230.1 104.4		
		16 DN400	15.50 394	—	247.6 112.3		
		20 ² DN500	x 20 DN500	6 DN150	17.25 438	17.25 438	240.0 108.9
				8 DN200	17.25 438	17.25 438	244.0 110.7
				10 DN250	17.25 438	17.25 438	256.0 116.1
12 DN300	17.25 438			17.25 438	264.0 119.8		
14 DN350	17.25 438			—	275.0 124.7		
16 DN400	17.25 438			—	288.6 130.9		
18 DN450	17.25 438			—	297.0 134.7		

Size	No. 25 Std.	No. 29T w/ Thd. Branch	Approx. Weight (Each)		
Nominal inches	C to E inches	C to E inches	lb		
DN	mm	mm	kg		
24 ² DN600	x 24 DN600	8 DN200	20.00 508	20.00 508	340.0 154.2
		10 DN250	20.00 508	20.00 508	343.9 156.0
		12 DN300	20.00 508	20.00 508	352.8 160.0
		14 DN350	20.00 508	—	360.0 163.3
		16 DN400	20.00 508	—	378.0 171.5
		18 DN450	20.00 508	—	380.0 172.4
		20 DN500	20.00 508	—	373.0 169.2
		14 – 60 DN350 – 1500			For AGS fitting information, see publication 20.05

² For 14"/DN350 and larger roll grooved systems, Victaulic offers the Advanced Groove System (AGS). For pricing and availability of cut groove fittings in this size, contact your nearest Victaulic sales representative.

(s) = Carbon Steel Direct Roll Groove (OGS)

(sw) = Carbon Steel Segmentally Welded

NOTES

- No. 29T Threaded Outlet Reducing Tees are supplied NPT and are available with British Standard threads. For British Standard specify "BSP" clearly on order.
- All fittings are ductile iron unless otherwise noted with an (sw) or (s).
- Cast fitting available. Contact Victaulic for details.

² For 14"/DN350 and larger roll grooved systems, Victaulic offers the Advanced Groove System (AGS). For pricing and availability of cut groove fittings in this size, contact your nearest Victaulic sales representative.

(s) = Carbon Steel Direct Roll Groove (OGS)

(sw) = Carbon Steel Segmentally Welded

NOTE

- Cast fitting available. Contact Victaulic for details.