



MULTI FITTINGS

# LAYING LENGTH

ISSUE DATE: OCT 30/17  
SUPERCEDES: MAR 11/05

## INCREASER BUSHING - ECCENTRIC (SxG)

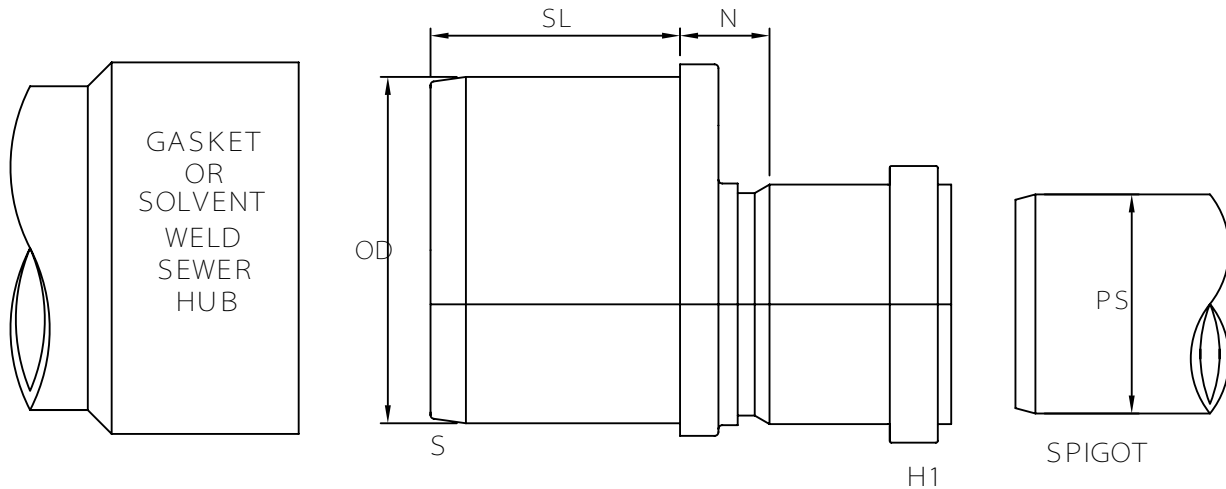

FABRICATED FITTING (F)

	SIZE SxH1	PART NUMBER	N REF	SL REF	OD	PS (SEWER)
F @	10x4	043268	4.500	8.000	10.500	4.215
F @	10x6	043269	5.000	8.000	10.500	6.275
F @	12x4	043271	4.750	8.000	12.500	4.215
F @	12x6	043272	5.500	8.000	12.500	6.275
F @	12x8	043273	5.750	8.000	12.500	8.400
F @	15x4	043275	4.750	10.000	15.300	4.215
F @	15x6	043277	5.500	10.000	15.300	6.275
F @	15x8	043278	5.750	10.000	15.300	8.400
F @	15x10	043279	7.000	10.000	15.300	10.500
F @	15x12	043280	8.000	10.000	15.300	12.500
F @	18x4	043281	5.000	14.000	18.701	4.215
F @	18x6	043282	5.000	14.000	18.701	6.275
F @	18x8	043230	5.250	14.000	18.701	8.400
F @	18x10	043512	5.500	14.000	18.701	10.500
F @	18x12	043283	6.750	14.000	18.701	12.500
F @	18x15	043284	6.750	14.000	18.701	15.300
F @	21x18	043146	-	-	22.047	18.701
F @	24x18	043408	-	-	24.803	18.701

Note: @ Refer to Page G5 for Hub Detail, Fabricated