

SCHEDULE 40 PVC DWV FITTINGS



FEATURES & BENEFITS

Lower Installation Costs

PVC pipe and fittings are easily handled, stored, cut and joined, meaning significant reductions in labor and transportation costs on typical installations.

Superior Chemical Resistance

PVC DWV pipe and fittings handle exceptionally well against such chemicals as acids, alkalies and normally diluted hydrocarbons. Aggressive industrial effluents and acid rain are easily tolerated as well.

Corrosion Resistance

PVC DWV fittings are immune to damage from naturally corrosive, soil conditions as well as electrochemical and galvanic corrosion. Our fittings' non-corroding properties ensure improved flow, lower maintenance costs and longer performance life.

Lower Thermal Conductivity

With a dramatically lower thermal conductivity factor as compared to metal, plastic systems have less heat loss or gain and sustain the temperature of the service with less variation than metal piping. As a result, pipe insulation is often not required.

SIZES

Injection Molded
4" – 12"

Fabricated Molded
10" – 24"

Multi Fittings offers a wide range of injection molded and fabricated Schedule 40 DWV fittings for the sewer market.

PVC DWV fittings are typically used for drainage and effluent piping and rainwater leaders for buildings such as parking garages or from roof tops in commercial and industrial applications.

For over 50 years, Multi Fittings has been an industry leader in offering the most comprehensively engineered and tested fittings for plastic pipe in North America.

Multi Fittings produces the widest range of injection molded fittings for pressurized water mains and sewer forcemains, gravity flow sewers and drain, waste and vent applications.

MULTI FITTINGS

Telephone: 519 681-2140

Toll Free: 800 265-1815

Fax: 519 681-2156



MULTI FITTINGS

LAYING LENGTH

ISSUE DATE: JUN 30/05
SUPERCEDES: MAR 16/01

SANITARY TEE (HxHxH)

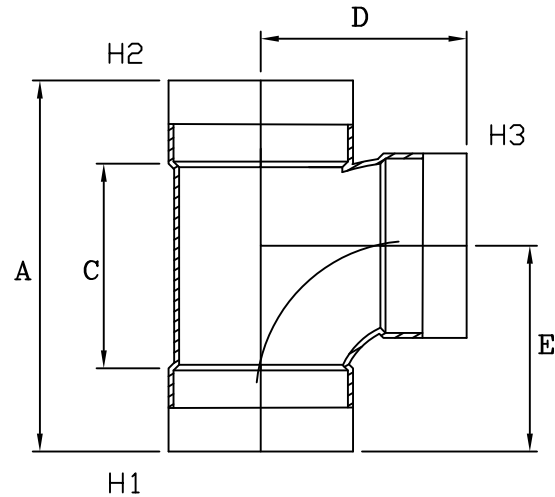

INJECTION MOLDED FITTING (M)

	SIZE H1xH2xH3	PART NUMBER	REFERENCE NUMBER	A REF	C REF	D REF	E REF	
-	4x4x4	026470	-	-	-	-	-	P
M=	6x6x4	026079	32138W	12. 000	6. 000	6. 125	6. 875	084
M=	6x6x6	026080	32156W	15. 500	9. 500	8. 500	9. 250	084
-	8x8x4	026340	-	-	-	-	-	P
-	8x8x6	026546	-	-	-	-	-	P
-	8x8x8	026013	-	-	-	-	-	P
-	10x10x4	026665	-	-	-	-	-	P
-	10x10x6	026641	-	-	-	-	-	P
-	10x10x8	026695	-	-	-	-	-	P
-	12x12x4	026883	-	-	-	-	-	P
-	12x12x6	026892	-	-	-	-	-	P

NOTE: = Refer to Page LPD5 for hub detail