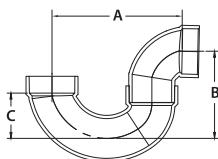
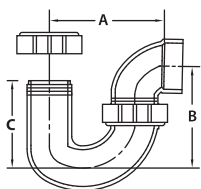

PART NO. PVC 710
Low Profile P-Trap with Solvent Weld

SIZE	HUB X HUB		
	A	B	C
2 (PVC)	6 ¹³ / ₁₆	4 ⁹ / ₁₆	2 ³ / ₈

PART NO. 711P
**L.A. Pattern P-Trap Furnished with a
 1 1/2" and 1 1/2" x 1 1/4" Polyethylene
 Nut/Washer Combination**

SIZE	SLIP Union X HUB		
	A	B	C
1 1/2 (PVC)	4 ³ / ₄	4 ¹⁵ / ₆₄	3 ⁷ / ₁₆
1 1/2 (ABS)	4 ⁹ / ₁₆	4 ¹ / ₈	3 ¹⁷ / ₃₂

PART NO. 711W
**L.A. Pattern P-Trap Furnished with a
 1 1/2" ABS or PVC Nut, a 1 1/2" Washer
 and a 1 1/2" x 1 1/4" Washer**

SIZE	SLIP Union X HUB		
	A	B	C
1 1/2 (PVC)	4 ³ / ₄	4 ¹⁵ / ₆₄	3 ⁷ / ₁₆
1 1/2 (ABS)	5 ⁵ / ₃₂	4 ¹⁵ / ₆₄	3 ⁴⁵ / ₆₄

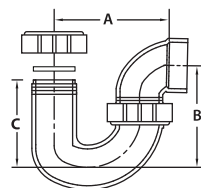
PART NO. PVC 711X
**L.A. Pattern P-Trap Furnished with a
 1 1/2" Chrome Nut, a 1 1/2" Washer
 and a 1 1/2" x 1 1/4" Washer**

SIZE	SLIP Union X HUB		
	A	B	C
1 1/2 (PVC)	4 ³ / ₄	4 ¹⁵ / ₆₄	3 ⁷ / ₁₆

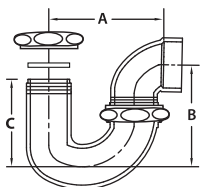

Note: If PVC or ABS is not listed for a specific size, that size fitting is available in PVC and ABS materials, and the dimensions listed are the same for both materials.