



Technical Information

Application

Molded CLASS 150 Flange fittings are coupling devices designed for joining IPS (Iron Pipe Size) plastic piping systems, where frequent disassembly may be required, and can be used as a transitional fitting for joining plastic to metal piping systems. Suitability of application is at the discretion of the user.

Pressure Rating

150 psi, water at 73°F.

Flange Types

One Piece — Available in socket configuration, sizes 1/2" through 8"; threaded and SR threaded (Special Reinforced) configuration sizes 1/2" through 4".

Van Stone Style — Two-piece design with rotating flange ring, available in socket configurations, sizes 1/2" through 16"; threaded configurations, sizes 1/2" through 4" and spigot configurations, sizes 1/2" through 12".

Blind — Closed ring design for capping off a mating flange, flanged fitting or flanged valve, available in sizes 1/2" through 12".

Materials

All injection molded flanges are produced from either PVC or CPVC materials approved for potable water use by the National Sanitation Foundation (NSF®).

Glass-filled PVC or CPVC materials may be used in certain Van Stone Style flange rings and large diameter Blind flanges where additional reinforcement is deemed necessary.

Conformance Standards

Socket & Spigot — ASTM D 2467 (PVC); ASTM F 439 (CPVC), as applicable.

Threads — ASTM F 1498.

Bolt Hole Pattern — ANSI B16.5; ASTM D 4024.

Material — ASTM D 1784 (PVC Cell Classification 12454-B, CPVC Cell Classification 23447-B).

Weights & Dimensions

Specified minimum bolt lengths are based on the use of two Spears® Flanges, two standard flat washers, standard nut and 1/8" thick elastomer full face gasket. Mating with other brands or accessories may require variation. Bolts and gaskets are not supplied with flanges.

Dimension references:

- L** = Overall length of hub, $\pm 1/16$ inch.
- M** = Outside diameter of socket hub, $\pm 1/16$ inch.
- N** = (Laying Length) socket/spigot bottom to seal-ring face of flange, $\pm 1/16$ inch.
- R** = Height (thickness) of flange ring, $\pm 1/16$ inch.
- Max O.D.** = Outside diameter of ring, $\pm 1/16$ inch.
- Bolt Circle Diameter** = ANSI B 16.5 Standard; ASTM D 4024, $\pm 1/16$ inch.

PVC & CPVC INJECTION MOLDED CLASS 150 FLANGES



Flange Van Stone Style

(Two Piece)

Fipt

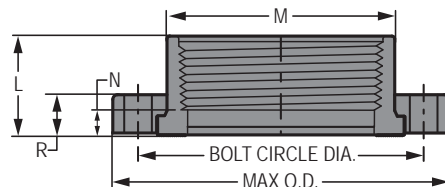

Part Number		Size	L	M	N	R	Bolt Circle Dia.	No. of Bolt Holes	Bolt Size	Min. Bolt Length	Max. O.D.	Approx. Wt. (Lbs.)	
PVC	CPVC											PVC	CPVC
855-005	855-005C	1/2	1-1/32	1-7/32	9/32	17/32	2-3/8	4	1/2	2	3-1/2	.19	.20
855-007	855-007C	3/4	1-5/32	1-3/8	13/32	9/16	2-3/4	4	1/2	2	3-7/8	.27	.28
855-010	855-010C	1	1-1/4	1-3/4	5/16	5/8	3-1/8	4	1/2	2-1/4	4-1/4	.36	.39
855-012	855-012C	1-1/4	1-3/8	2-1/8	13/32	11/16	3-1/2	4	1/2	2-1/4	4-5/8	.46	.47
855-015	855-015C	1-1/2	1-15/32	2-7/16	13/32	3/4	3-7/8	4	1/2	2-1/2	5	.55	.61
855-020	855-020C	2	1-9/16	2-31/32	1/2	13/16	4-3/4	4	5/8	3	6	.87	.94
855-025	855-025C	2-1/2	2	3-9/16	7/16	1	5-1/2	4	5/8	3-1/4	7	1.22	1.50
855-030	855-030C	3	2-1/8	4-1/4	1/2	1-1/16	6	4	5/8	3-1/4	7-1/2	1.73	1.79
855-040	855-040C	4	2-1/16	5-1/4	3/8	1-1/4	7-1/2	8	5/8	3-1/2	9	2.61	2.78
855-060F	855-060CF	6	6-3/8	7-3/16	4-15/16	1-1/4	9-1/2	8	3/4	4	11	7.62	7.69
855-080F	855-080CF	8	8-1/8	9-5/16	6-7/16	1-1/2	11-3/4	8	3/4	4-1/2	13-1/2	12.84	13.92
855-100F	855-100CF	10	10-3/8	11-9/16	8-9/16	1-11/16	14-1/4	12	7/8	5	16	20.65	20.72
855-120F	855-120CF	12	11-13/16	13-3/4	9-3/4	1-5/8	17	12	7/8	5	19	33.52	34.00

Flange Van Stone Style

(Two Piece)

Spigot

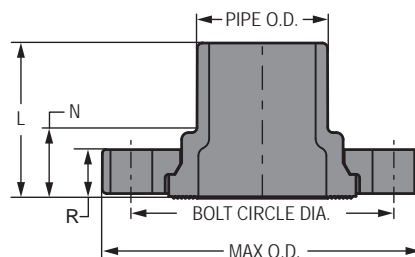

Part Number		Size	L	N	R	Bolt Circle Dia.	No. of Bolt Holes	Bolt Size	Min. Bolt Length	Max. O.D.	Approx. Wt. (Lbs.)	
PVC	CPVC										PVC	CPVC
856-005	856-005C	1/2	1-3/4	29/32	17/32	2-3/8	4	1/2	2	3-1/2	.20	.21
856-007	856-007C	3/4	1-15/16	31/32	9/16	2-3/4	4	1/2	2	3-7/8	.29	.30
856-010	856-010C	1	2-3/16	1-1/32	5/8	3-1/8	4	1/2	2-1/4	4-1/4	.39	.41
856-012	856-012C	1-1/4	2-11/32	1-3/32	11/16	3-1/2	4	1/2	2-1/4	4-5/8	.50	.50