

# Central Brass®

The Easy Choice

## TWO-VALVE BATH FILLER, SHOWER & BATH & SHOWER Cast Brass Body



### **8" Centers, I.P. Unions, Compression Stems, Replaceable Seats**

0905 Series	Bath Valve only
0906 Series	Bath Filler Valve only with Twin Ell & 3/4 IPS Diverter
0907 Series	Bath & Shower Valve same as 0906 with Shower Head, Arm & Flange
0908 Series	Bath Filler Valve with Spout
0926 Series	Shower Valve with Shower Head, Arm & Flange
0986 Series	Bath Filler Valve with Transfer Valve & Slip Fit Diverter Spout
0987 Series	Bath & Shower Valve same as 0986 with Shower Head, Arm & Flange
0995 Series	Bath Filler Valve only with Transfer Valve
0996 Series	Bath Filler Valve with Transfer Valve & 1/2 IPS Diverter Spout
0997 Series	Bath & Shower Valve same as 0996 with Shower Head, Arm & Flange

### **8" Centers, I.P. Unions, Ceramic Stem Assemblies**

80908 Series	Bath Valve with 1/2 IPS Spout
80926 Series	Bath Valve with Shower Head, Arm & Flange
80997 Series	Bath Valve with 1/2 IPS Spout, Shower Head, Arm & Flange

CENTRAL BRASS MFG CO

2950 East 55th Street, Cleveland, Ohio 44127

Phone: 216-883-0220 Fax: 216-883-0875 Email: sales @CentralBrass.com

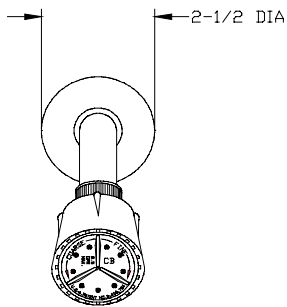

## INSTALLATION INSTRUCTIONS

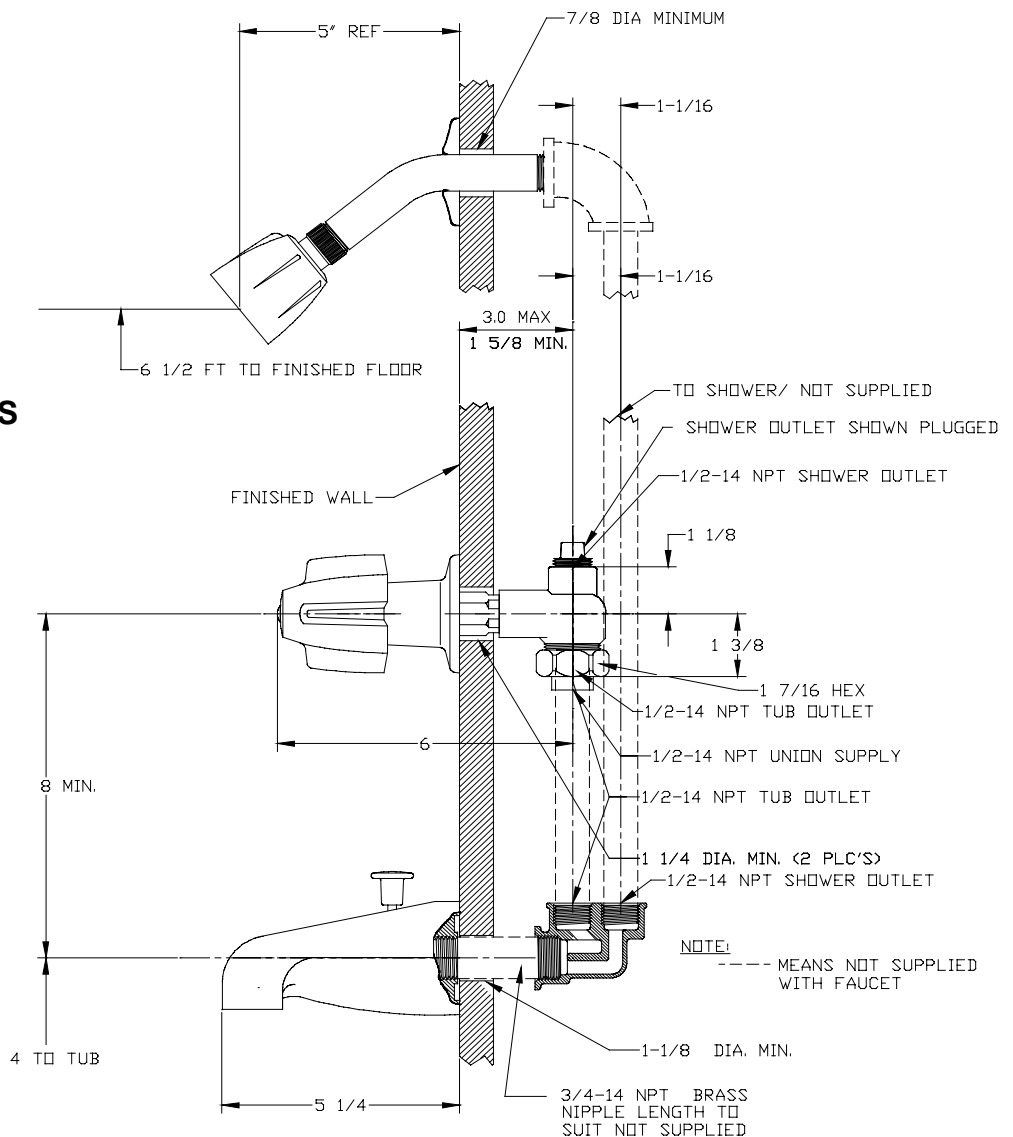
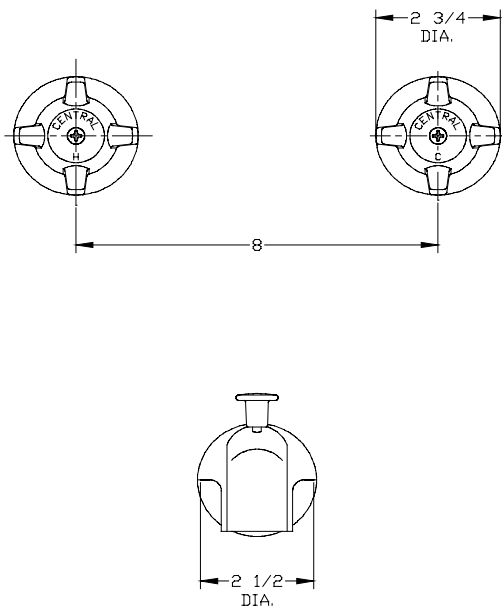

### 3/4 IPS Diverter Spout

#### Roughing In Instructions

1. Locate and install valve assembly as shown.
2. Connect hot and cold supply lines.
3. Fabricate and install line for showerhead and spout.
4. Anchor fittings to studs in proper location.
5. Test for operation and leakage before finishing wall.
6. Install protectors on all exposed fittings.

**NOTE:** Flush waterlines to remove debris before installation.

#### Finishing Instructions

1. Remove fitting protectors.
2. Apply putty as required to prevent water damage to wall.
3. Install finished trim.
4. Test for operation and leakage.

### CENTRAL BRASS MFG CO

2950 East 55th Street, Cleveland, Ohio 44127

Phone: 216-883-0220

Fax: 216-883-0875

Email: sales @CentralBrass.com

## INSTALLATION INSTRUCTIONS for Integral Stops

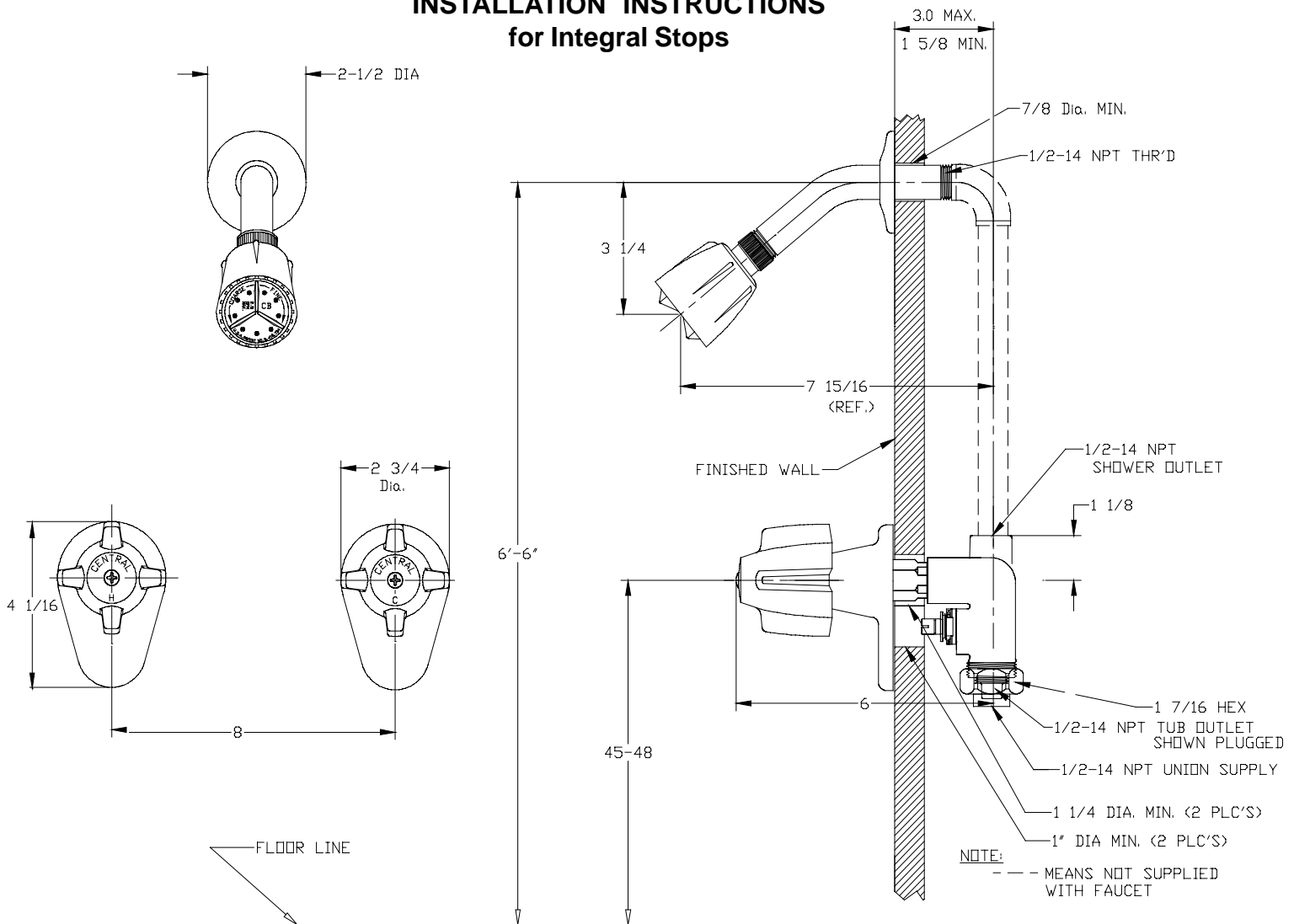

### Roughing In Instructions

1. Locate and install valve assembly as shown.
2. Connect hot and cold supply lines.
3. Fabricate and install line for showerhead and spout.
4. Anchor fittings to studs in proper location.
5. Test for operation and leakage before finishing wall.
6. Install protectors on all exposed fittings.

**NOTE:** Flush waterlines to  
remove debris before  
installation.

### Finishing Instructions

1. Remove fitting protectors.
2. Apply putty as required to prevent water damage to wall.
3. Install finished trim.
4. Test for operation and leakage.

**CENTRAL BRASS MFG CO**

2950 East 55th Street, Cleveland, Ohio 44127

Phone: 216-883-0220

Fax: 216-883-0875

Email: sales @CentralBrass.com

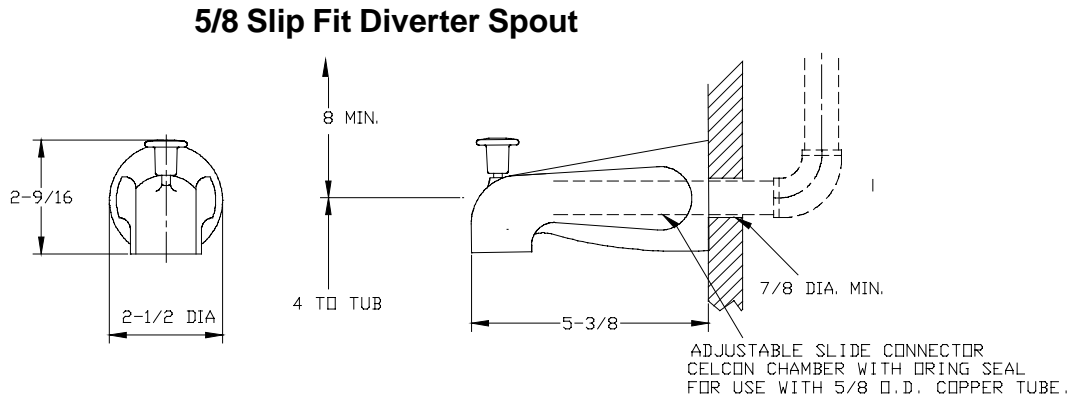
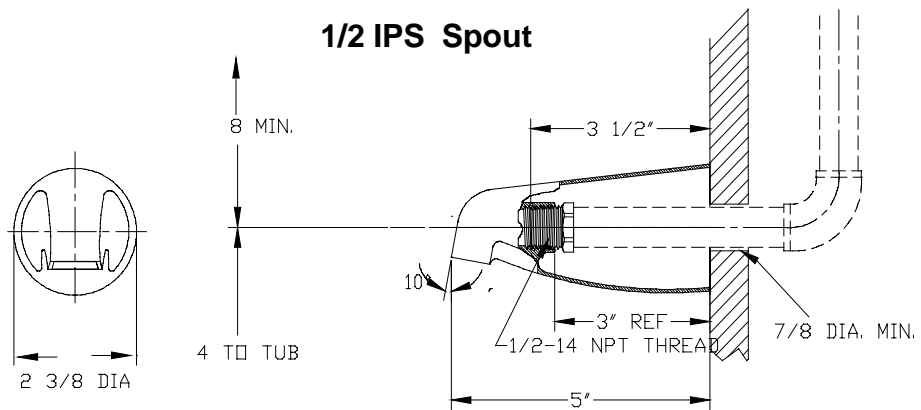

## 80 - Silver Crown Handle Suffix

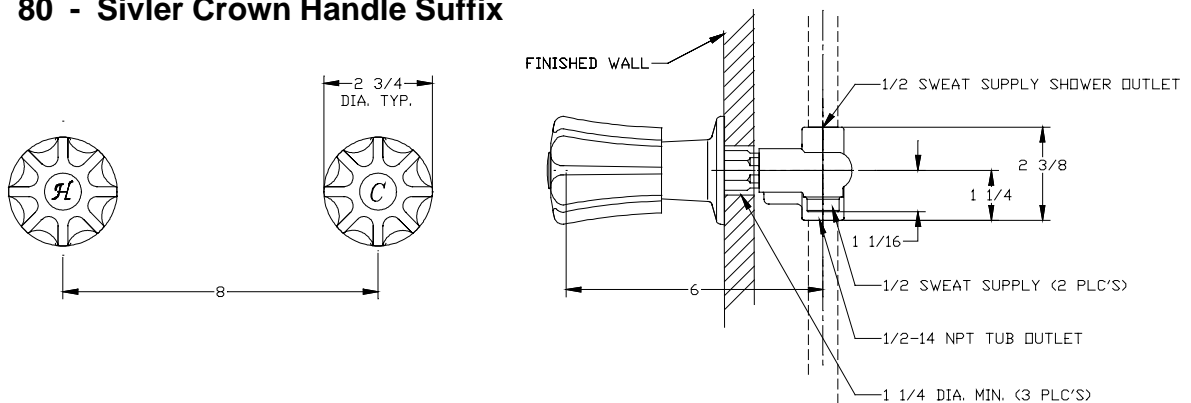

### CAUTION for Compression Stem Assemblies

Soldered connections should be made with valve stems OPEN. DO NOT overheat.  
Let valve assembly cool after connection is made before closing valve stems

### WARNING for Ceramic Stem Assemblies

Remove hot and cold stem units before soldering. Failure to do so will result in damage to ceramic stem units. Cool valve assembly after solder connections are completed before reinstalling ceramic stem assemblies.

## CENTRAL BRASS MFG CO

2950 East 55th Street, Cleveland, Ohio 44127

Phone: 216-883-0220 Fax: 216-883-0875 Email: sales @CentralBrass.com

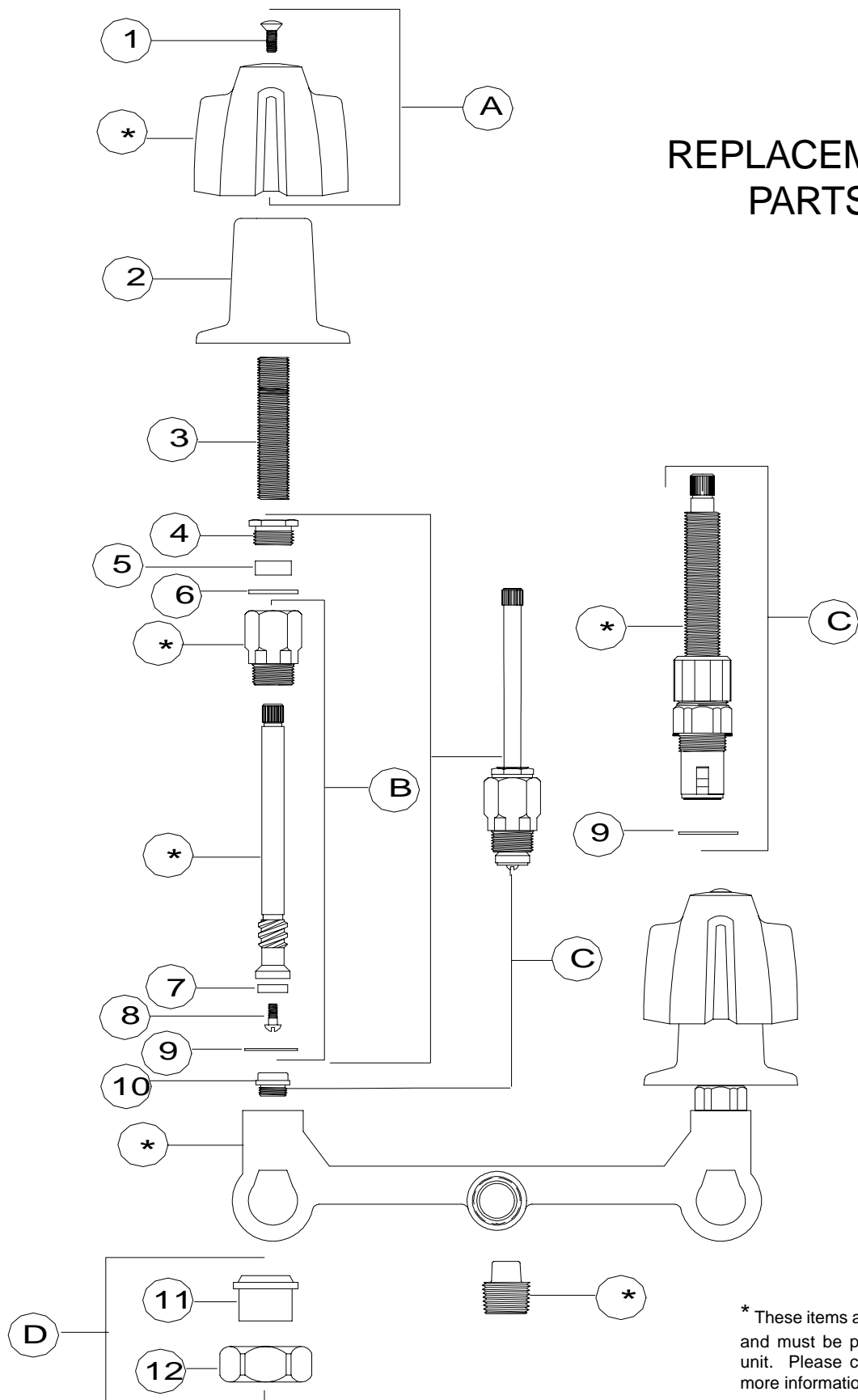

## REPLACEMENT PARTS

\* These items are not offered individually and must be purchased as a group or unit. Please contact Central Brass for more information.

**CENTRAL BRASS MFG CO**

2950 East 55th Street, Cleveland, Ohio 44127

Phone: 216-883-0220

Fax: 216-883-0875

Email: sales @CentralBrass.com

[www.CentralBrass.com](http://www.CentralBrass.com)

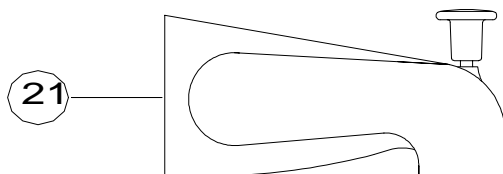
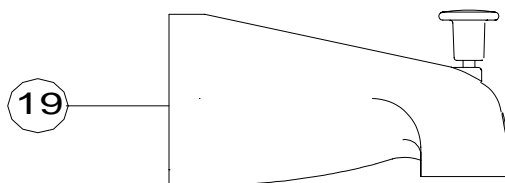
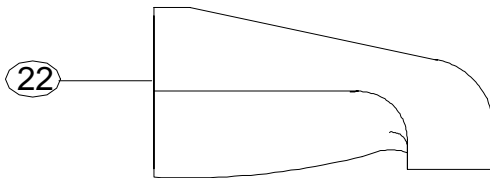
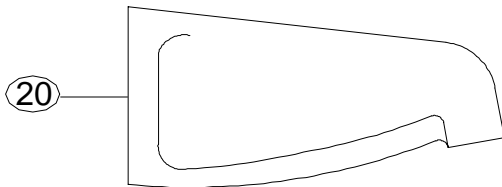
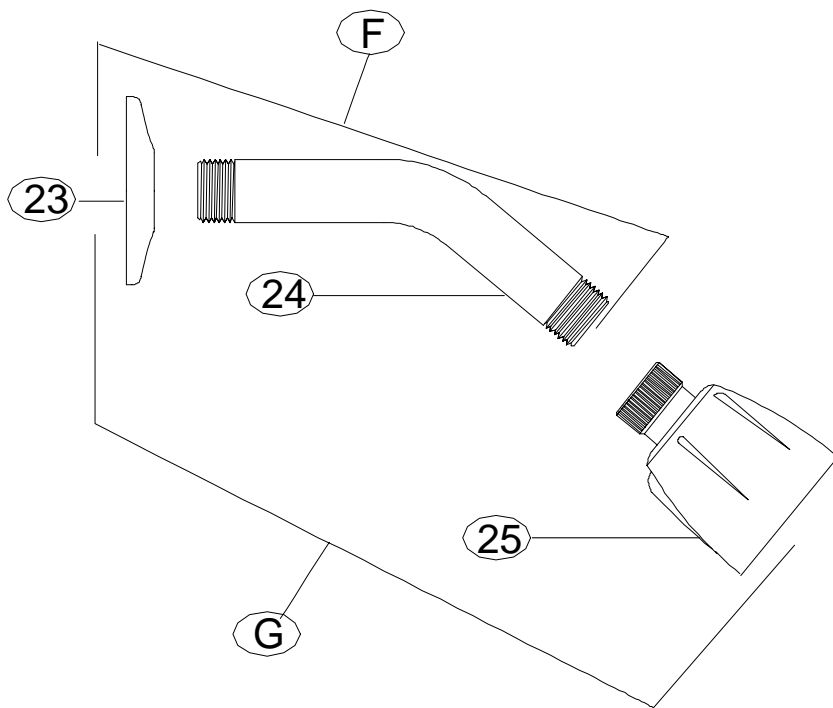

## Parts for Integral Stops

For items with **I** suffix only

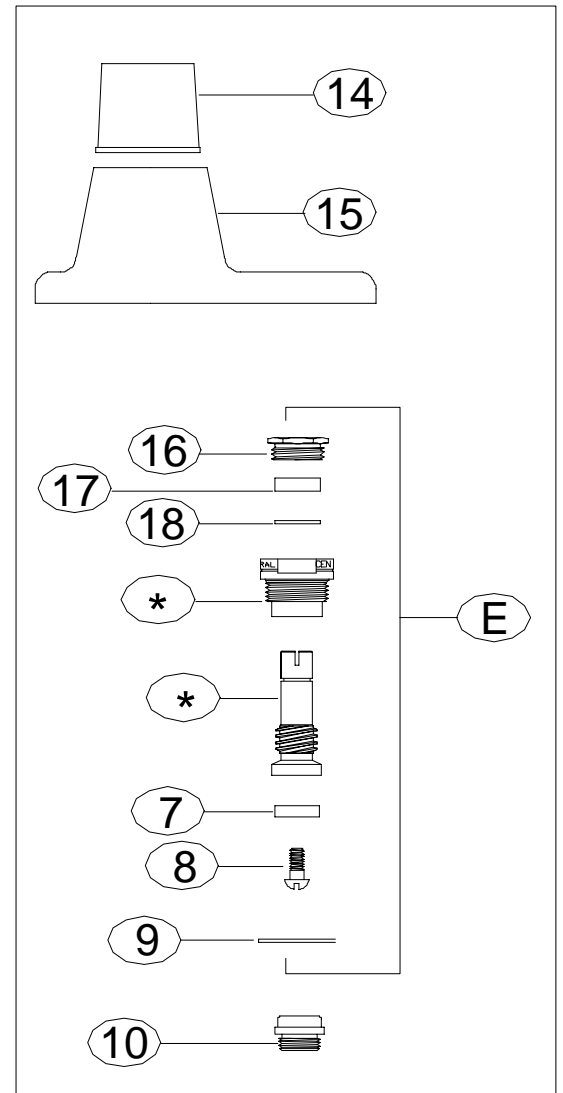

\* These items are not offered individually and must be purchased as a group or unit. Please contact Central Brass for more information.

**CENTRAL BRASS MFG CO**

2950 East 55th Street, Cleveland, Ohio 44127

Phone: 216-883-0220

Fax: 216-883-0875

Email: sales @CentralBrass.com

## REPLACEMENT PARTS

#	Part #	Description
A	G-508-C	Large Canopy Handle indexed C with Screw (X107-F)
A	G-508-H	Large Canopy Handle indexed H with Screw (X107-F)
B	G-1549-CT	Stem & Bonnet Group with Seat Washer (X901-WN) & Screw (X104) for items 0905, 0908 & 0926 only
C	K-3-CT	Complete Stem Assembly with Gasket (X1028-Y) & Bronze Seat (X263-BC) for items 0905, 0908 & 0926 only
C	K-351-C	Ceramic-disc Stem Cartridge Cold with Gasket (X1028-Y) for items 80908 & 80926
D	G-30	IP Union Sleeve (X1875) & Nut (X1876-BB)
E	XSU-353-ERS	Integral Stop Stem Assembly with Gasket (X1028-Y) (2 pcs per pack) for I suffix Integral Valve only
F	3007-6	6-inch Shower Arm (714-WT-02) & Flange (X1035-SS)
G	G-3113-6	Shower Head (3034-1/2-02), 6-inch Shower Arm (714-WT-02) & Flange (X1035-SS)
1	X107-F	Handle Screw (25 pcs per pack)
2	521-B	Escutcheon
3	X269-29/16	2 <sup>9</sup> / <sub>16</sub> Long Nipple (10 pcs per pack)
4	X765-TA	Packing Nut (6 pcs per pack) for items 0905, 0908 & 0926 only
5	X814-BA	Packing (10 pcs per pack) for items 0905, 0908 & 0926 only
6	X4-L	Packing Washer (6 pcs per pack) for items 0905, 0908 & 0926 only
7	X901-WNN	Seat Washer (25 pcs per pack) for items 0905, 0908 & 0926 only
8	X104	Seat Washer Screw (25 pcs per pack) for items 0905, 0908 & 0926 only
9	X1028-Y	Gasket (25 pcs per pack)
10	XPF-263-B	Replacement Seat (4 pcs per pack) for items 0905, 0908 & 0926 only
11	X1875	IP Union Sleeve (2 pcs per pack)
12	X1876-BB	Coupling Nut (2 pcs per pack)
14	1037-ES	Escutcheon Sleeve for I suffix Integral Valve only
15	1037-ET	Teardrop Escutcheon for I suffix Integral Valve only
16	X353-DH	Packing Nut (10 pcs per pack) for I suffix Integral Valve only
17	X353-CW	Packing (10 pcs per pack) for I suffix Integral Valve only
18	X193-B	Brass Washer (6 pcs per pack) for I suffix Integral Valve only
19	3061-AZ1/2	½ IPS Diverter Spout for items 0996, 0997 & 80997 only
20	3145-D	½ IPS Brass Spout for item 0908, 80908 only
21	1062	<sup>5</sup> / <sub>8</sub> Slip Joint Diverter Spout for items 0986 & 0987 only
22	3154-Z	Zamak Spout for item 0908-Z , 80908-Z only
23	X1035-SS	Shower Arm Flange (10 pcs per pack)
24	714-WT-02	6-inch Shower Arm
25	3034-1/2-02	Shower Head 2.5 GPM

### CENTRAL BRASS MFG CO

2950 East 55th Street, Cleveland, Ohio 44127

Phone: 216-883-0220      Fax: 216-883-0875      Email: sales @CentralBrass.com

## OPTIONS & REPLACEMENT PARTS

Suffix Number	Replaces Item #	Part Number	Description
80	A	K-505-1C	Silver Crown Acrylic Handles with indexed C metal button (G-503-M-02)
		K-505-1H	Silver Crown Acrylic Handles with indexed H metal button (G-503-M-02)
		X126-625B	Handle Screw for Acrylic Handles suffix 80 (6 pcs per pack)
		G-503-M-02	Metal indexed buttons C & H for Acrylic Handles suffix 80 (one pair per pack)
C	D	G-30-C	Direct Sweat Union Sleeve (X1875) & Nut (X1876-BB) For C suffix items only
	12	X1875-C	Direct Sweat Union Sleeve (2 pcs per pack) for Item with C suffix
	10	X263-BC	Bronze Replacement Seat (10 pcs per pack) for items 0905, 0908 & 0926 only
	D	3007-8	8-inch Shower Arm (714-WT-02) & Flange (X1035-SS)
	E	G-3113-8	Shower Head (3034-1/2-02), 8-inch Shower Arm (714-WT-02) & Flange (X1035-SS)
		<b>Accessories</b>	
		G-1548-ET	Stem Extension with Screw (X105-F)
		X105-F	Screw for stem extension (4 pcs per pack)
Prefix Number	Replaces Item #	Part Number	Description
8	C	K-351-C	Ceramic-disc Stem Cartridge Cold with Gasket (X1028-Y)
8	C	K-351-H	Ceramic-disc Stem Cartridge Hot with Gasket (X1028-Y)
		For items	<b>80908 &amp; 80926 only</b>

- If faucet has round handles (70 or 80 suffixes) , use two Hot stem assemblies
- If faucet has lever handles, use one Hot and one Cold stem assemblies

### CENTRAL BRASS MFG CO

2950 East 55th Street, Cleveland, Ohio 44127

Phone: 216-883-0220    Fax: 216-883-0875    Email: sales @CentralBrass.com



# CENTRAL BRASS MAINTENANCE INSTRUCTIONS

DISASSEMBLY	REPLACEMENT
<div data-bbox="350 432 824 499"> <b>1 REMOVE HANDLE</b>            1. Turn off water supply            2. Remove the handle screw &amp; handle            3. Unscrew the escutcheon         </div> <div data-bbox="402 625 782 777"> </div>	<div data-bbox="906 520 1198 592"> <b>Use Only Central Replacement Parts</b> </div> <div data-bbox="896 697 977 722"> <b>K-3-CT</b> </div> <div data-bbox="1075 697 1172 722"> <b>K-351-C</b> </div> <div data-bbox="896 739 971 1129"> </div> <div data-bbox="1091 739 1156 1138"> </div> <div data-bbox="850 1188 1269 1289"> <p>NOTE: If replacing compression units with ceramic units make sure PF-263-B seat is removed from body before installing stem units.</p> </div> <div data-bbox="850 1302 1253 1365"> <p><b>Replace components in reverse order of disassembly</b></p> </div>
<div data-bbox="350 785 824 852"> <b>2 REMOVE STEM ASSEMBLY</b>            1. Use adjustable wrench.            2. Turn stem to open position            3. Unscrew counterclockwise.            Remove stem unit.         </div> <div data-bbox="305 970 799 1150"> </div>	
<div data-bbox="350 1171 824 1239"> <b>3 REMOVE SEAT</b>            1. Insert 5/16" allen wrench in seat.            2. Turn seat (counterclockwise) to remove.         </div> <div data-bbox="263 1297 815 1442"> </div> <div data-bbox="263 1390 393 1442"> <p>Use 5/16" Allen Wrench</p> </div> <div data-bbox="630 1373 815 1428"> <p><b>For Compression stems only</b></p> </div>	

- If faucet has round handles (70 or 80 suffixes) , use two Hot stem assemblies
- If faucet has lever handles, use one Hot and one Cold stem assemblies

**CENTRAL BRASS MFG CO**  
 2950 East 55th Street, Cleveland, Ohio 44127  
 Phone: 216-883-0220    Fax: 216-883-0875    Email: sales @CentralBrass.com