



SDS1



SDS2

# Sink Drain System

MODEL

## SDS1/SDS2

### APPLICATIONS

- Laundry tray
- Wet bar sink
- Air conditioning condensate or dehumidifier water
- Residential dishwashers
- Beautician sink

### SPECIFICATIONS

#### SDS1

- 0.4 HP, 115 V, 1 PH, 1550 RPM, with 10' cord
- Maximum Amps: 12.
- 3/4" maximum solids handling.
- Capacities: up to 55 GPM.
- Total heads: up to 24 feet.
- Built in overload with automatic reset.

#### SDS2

- 1/3 HP, 115 V, 1 PH, with 10' cord.
- Maximum Amps: 3.
- 3/8" maximum solids handling.
- Capacities: up to 40 GPM.
- Total heads: up to 30 feet.
- Built in overload with automatic reset.

### FEATURES

- Fully assembled (individually cartoned).
- Capable of running dry without damage to components.
- Severe duty rated oil and water resistant power cable.

### ASSEMBLED COMPONENTS

#### SDS1

- EP0411, 0.4 HP, 3/4" solids handling pump is CSA listed.
- CSA listed pump.
- A2H11 Vertimaster vertical level switch with 10 foot cord and piggy-back plug is UL and CSA listed.
- 10 gallon structural foam basin and cover.
- 1 1/2" NPT threaded vent, discharge and inlet connections.
- 1 1/2" schedule 40 PVC discharge pipe (internal).

#### SDS2

- SP035V, 1/3 HP, 3/8" solids handling pump.
- UL and CSA listed pump.
- 7 gallon polyethylene basin.
- 2" threaded vent.
- 1 1/2" threaded inlet and discharge.
- Translucent basin allows easy water level inspection.
- 1 1/2" schedule 40 PVC discharge pipe (internal).

Goulds Pumps is ISO 9001 Registered.

### PERFORMANCE RATINGS

#### SDS1

Total Head (feet of water)	GPM
5	53
10	46
15	36
20	21
22.5	10

#### SDS2

Total Head (feet of water)	GPM
5	40
10	33
15	25
20	17
25	9

### DIMENSIONS

(All dimensions are in inches and weights in lbs.  
Do not use for construction purposes.)

Model	Base Dia. A	Height B	Outside Dia. C
SDS1	14"	16½"	17"
SDS2	12½"	14½"	16"

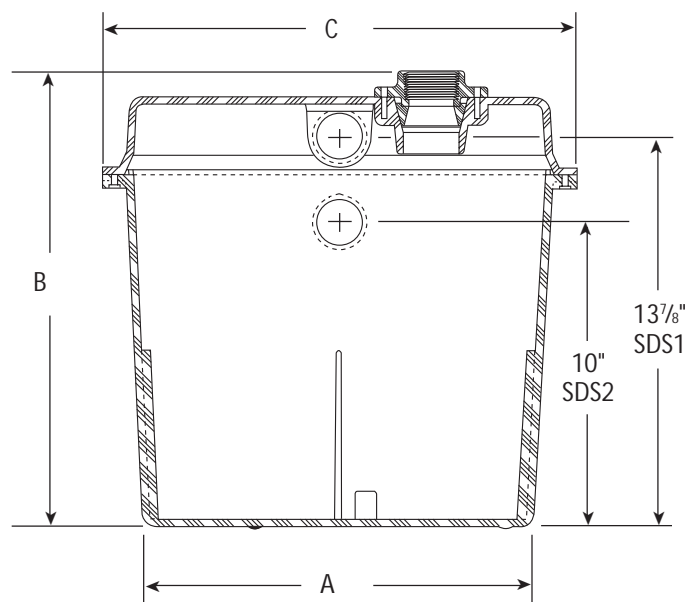

SDS1 shown

