

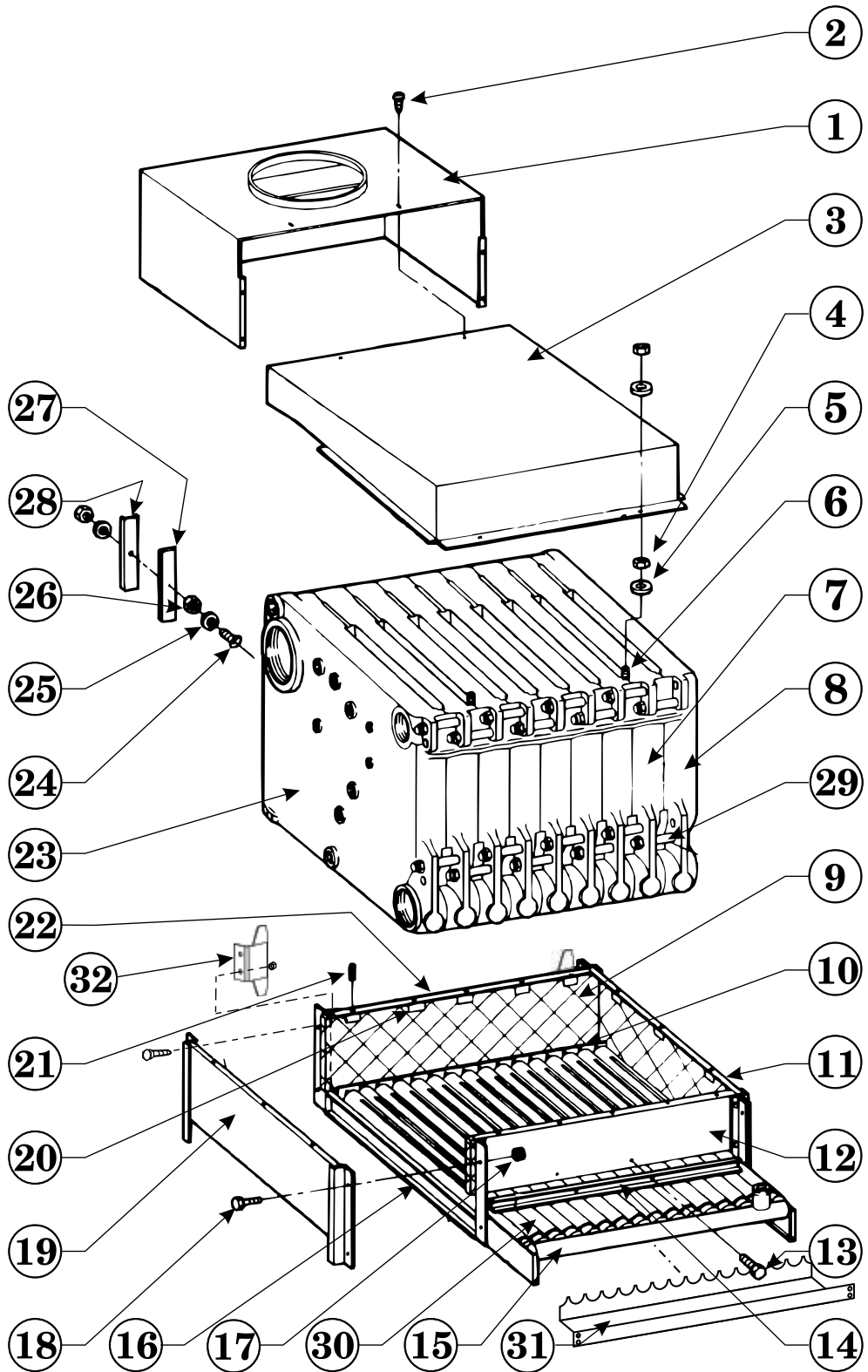

11 Replacement parts



Base Size (Note 1)	Base Insulation Size (Note 2)
4	4
5	5
A	A
B	B
C	C
D	A and K
E	B and K
F	A and J
G	A and J

Notes:
 1. See page 9, **Base Arrangement Table**, to determine base size for your boiler.
 2. Contains one (1) each front and back.



Item	Description	Size	Weil-McLain Part Number
1	Horizontal Draft Hood	4	443-300-098
		5	443-300-099
		A	443-300-100
		B	443-300-101
		C	443-300-102
		D	443-300-103
		E	443-300-104
		F	443-300-105
2	Screw, Phillips #10 x1/2		*
3	Horizontal Collector Hood	4	450-019-858
		5	450-019-859
		A	450-019-851
		B	450-019-852
		C	450-019-853
		D	450-019-854
		E	450-019-855
		F	450-019-856
4	Hex Nut, Regular 1/4-20		*
5	Washer, Plain 1/4- .312 x .734 x .065		*
6	Carriage Bolt, 1/4-20 x 1-1/2		*
7	Intermediate Section (3318)		313-300-110
8	Right End Section		313-300-111
9	Base Insulation (Front & Back)	4	591-221-330
			591-221-331
		5	591-221-332
			591-221-333
		A	591-221-334
			591-221-335
		B	591-221-336
			591-221-337
		C	591-221-338
			591-221-339
		J	591-221-340
K	591-221-341		
	591-221-342		
	591-221-343		
10	Base Burner Rest	4	450-003-600
		5	450-003-601
		A	450-003-560
		B	450-003-561
		C	450-003-562
		D	450-003-563
		E	450-003-564
		F	450-003-565
G	450-003-566		
11,19	Base End Panel		383-300-165
	Insulation		591-221-126
12	Base Front Panel	4	450-003-543
		5	450-003-544
		A	450-003-545
		B	450-003-546
		C	450-003-547
		D	450-003-548
		E	450-003-549
		F	450-003-550
G	450-003-551		
13	Screw, Hex Washer Head Slotted #10-32 x 3/8		*

* Purchase at local supply house

Item	Description	Size	Weil-McLain Part Number
14	Base Access Shield	4	450-003-606
		5	450-003-607
		A	450-003-582
		B	450-003-583
		C	450-003-584
		D	450-003-585
		E	450-003-586
		F	450-003-587
G	450-003-588		
15	Manifold	4	591-125-908
		5	591-125-909
		A	591-125-910
		B	591-125-911
		C	591-125-912
		D	591-125-913
		E	591-125-914
		F	591-125-915
G	591-125-916		
16	Base Cross Tie		*
17	Nut, Flange Whiz-Lock 1/4-20		*
18	Screw, Hex Head Cap 1/4-20 x 3/4		*
20	Base Insulation Support Clip		562-650-104
21	Roll Pin 1/8 x 2		562-930-236
22	Base Back Panel	4	450-003-598
		5	450-003-599
		A	450-003-553
		B	450-003-554
		C	450-003-555
		D	450-003-556
		E	450-003-557
		F	450-003-558
G	450-003-559		
23	Left End Section (3314)		313-300-109
24	Carriage Bolt, 1/4-20 x 1-3/4		*
25	Washer, Plain 1/4-.312 x .734 x .065		*
26	Hex Nut, Regular 1/4-20		*
27	Insulation		591-221-115
28	Cleanout Plate		450-029-549
29	Draw Rod, 5/8-11 x 8 Washer, Plain 5/8-.656 x 1.312 x .095 Hex Nut, Regular 5/8-11		560-134-480
			*
			*
30	Main Burner		512-200-050
			6" Square Cut Seal
			592-800-007
	9" Square Cut Seal		592-800-005
	Sealing Rope 1/2" HD500		590-735-140
31	Burner Shield	4	450-003-350
		5	450-003-352
		A	450-003-354
		B	450-003-356
		C	450-003-358
		D	450-003-360
		E	450-003-362
		F	450-003-364
G	450-003-366		
32	Base Brkt Right and Left		450-003-614

* Purchase at local supply house