

### BEFORE YOU BEGIN

#### HOW TO USE THESE INSTRUCTIONS

These instructions contain important installation information. Please leave instructions for the consumer.

#### ORDERING INFORMATION

##### Triton™ Sink Faucets

Standard Handles .....	7308-2A-**-AA
Cross Handles .....	7308-3A-**-AA
Lever Handles .....	7308-4A-**-AA
Wristblade Handles .....	7308-5A-**-AA

\*\*Variation and/or finish/color code may be required when ordering.

##### Triton™ Vandal Proof Sink Faucets

Standard Handles .....	7308-2E-**-AA
Cross Handles .....	7308-3E-**-AA
Lever Handles .....	7308-4E-**-AA
Wristblade Handles .....	7308-5E-**-AA

### INSTALLATION

#### INSTALL STOPS

**NOTE:** Ensure flange is threaded onto each stop.

Thread stops onto 1/2" IPS supply pipes. Use thread sealant.

Thread flange until tight against wall or fixture.

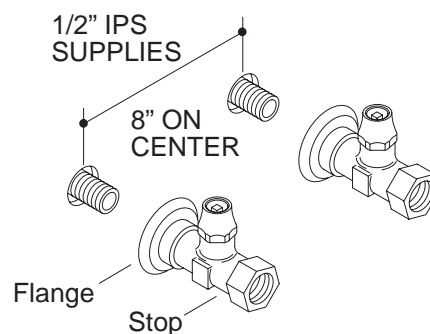

Fig. #1

#### INSTALL SPOUT

Thread spout onto faucet body until tight and properly aligned. Use thread sealant.

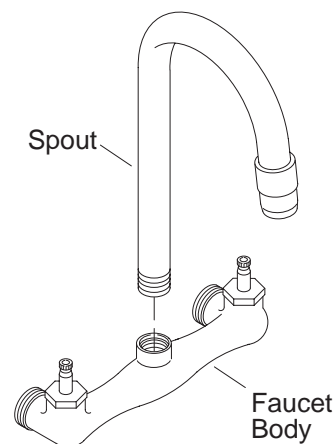

Fig. #2

## INSTALL FAUCET BODY

Place a washer inside each stop nut.

Hold faucet body against stops and thread stop nuts onto faucet body. Tighten stop nuts.

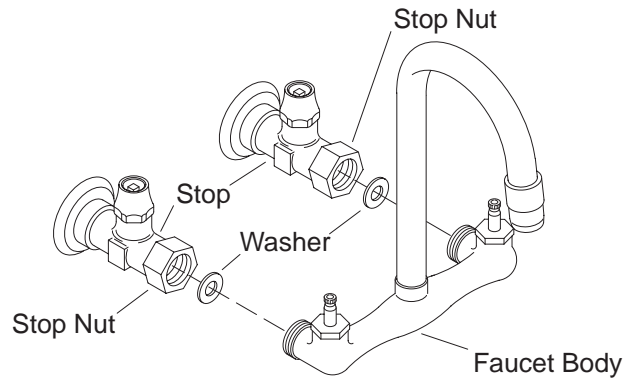

Fig. #3

## INSTALL HANDLES

**NOTE:** Following instructions are applicable to blade handle configurations only. Faucets ordered with standard, cross or lever handles are supplied with handles installed.

**NOTE:** The spline adapter supplied in wristblade handle kit is not used with this faucet.

Press handle onto valve stem. Ensure that splines inside handle and valve stem splines are engaged and handle is properly aligned.

Secure handle with screw and press plug button in place; for vandal proof configurations, insert applicable red or blue vandal proof button and secure with screw.

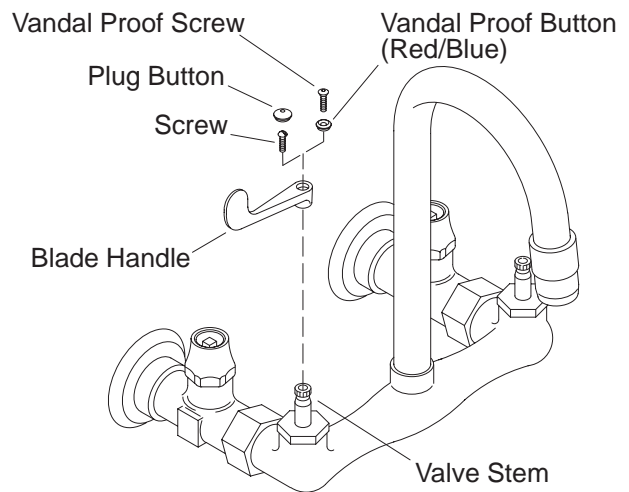

Fig. #4

## CHECK INSTALLATION

Ensure main water supplies are on.

Using key, rotate both stop adjustments fully counterclockwise (open).

Unthread and remove aerator from spout.

**NOTE:** Use special wrench to unthread vandal proof aerator.

Open both faucet valves (hot-fully counterclockwise, cold-fully clockwise) and run water through faucet to flush out debris.

Check for leaks and repair as required.

Reinstall aerator into spout.

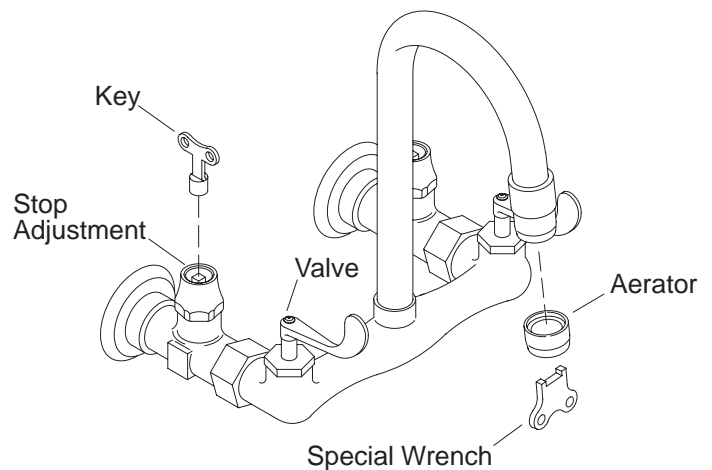

Fig. #5