



www.phd-mfg.com

PIPE CLAMPS

FIG. 552 & 554

COPPER TUBING RISER CLAMP

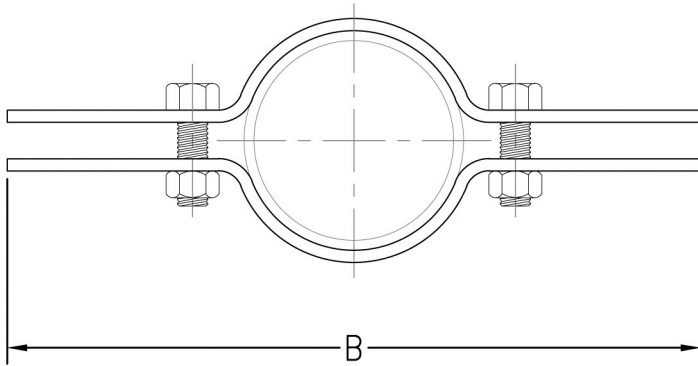

Function: Designed for supporting and stabilizing vertical tubing runs. The PVC coating on Fig. 554 protects the tube from the metal surface of the clamp.

Material: Carbon steel

Finish: Copper color epoxy (Fig. 552), or Copper color epoxy with PVC coating (Fig. 554)

Approvals: Complies with Federal Specification A-A-1192A (Type 8) and Manufacturers' Standardization Society ANSI/MSS SP-58 (Type 8) which supersedes ANSI/MSS SP-69.

Ordering: Specify figure number, pipe size, material, and finish.

Installation practice for Model 550 Riser Clamps:

When possible the clamp should be placed under a coupling, hub, or welded lugs on steel pipe. Bolt torques should be per industry standards.

Pipe Size		B		Bolt Size	Max. Rec. Load		Wt. Each	
					lbs.	kN	lbs.	kg
1/2	(15)	6 ¹¹ / ₁₆	(169.86)	1/4	75	(.33)	.50	(.23)
3/4	(20)	7	(177.80)	1/4	75	(.33)	.52	(.24)
1	(25)	8 ³ / ₄	(222.25)	1/4	120	(.53)	.64	(.29)
1 1/4	(32)	9	(228.60)	1/4	150	(.67)	.65	(.29)
1 1/2	(40)	9 ³ / ₈	(238.13)	1/4	150	(.67)	.70	(.32)
2	(50)	9 ¹⁵ / ₁₆	(252.41)	3/8	150	(.67)	.98	(.44)
2 1/2	(65)	10 1/2	(266.70)	3/8	300	(1.33)	1.09	(.49)
3	(80)	11	(279.40)	3/8	300	(1.33)	1.17	(.53)
3 1/2	(90)	12 ³ / ₁₆	(309.56)	3/8	300	(1.33)	1.53	(.69)
4	(100)	12 ⁵ / ₈	(320.68)	3/8	300	(1.33)	1.67	(.76)
5	(125)	14 1/8	(358.78)	1/2	500	(2.22)	2.42	(1.10)
6	(150)	15	(381.00)	1/2	500	(2.22)	2.68	(1.22)

Recommended Torque For Pipe Clamp Hardware						
Bolt Size	1/4"-20	5/16"-18	3/8"-16	1/2"-13	5/8"-11	3/4"-10 & Larger
ft-lbs.	6	11	19	50	65	75
N-m	(8)	(15)	(26)	(68)	(88)	(102)

THREADED ACCESSORIES
CPVC STRAPS
BAND HANGERS
BEAM CLAMPS
CLEVIS HANGERS
PIPE ROLLER SUPPORTS
SPLIT RING HANGERS
PIPE CLAMPS
CENTER LOAD BEAM CLAMPS
PIPE SHIELDS, INSULATION, & SADDLES
PIPE GUIDES & SLIDES
WALL BRACKETS
PIPE SUPPORTS
STRUCTURAL ATTACHMENTS
SEISMIC BRACING