

ANGLE FITTINGS

FIG. 5301 - 5315

2-HOLE OPEN ANGLE CONNECTOR

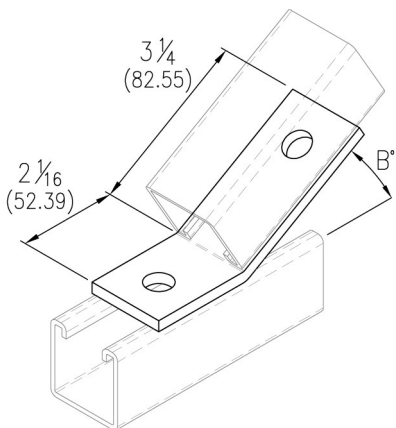

Fig. No.	Angle B°	Wt. Each	
		lbs.	kg
5301	7 1/2	.58	(.26)
5302	15	.58	(.26)
5303	22 1/2	.58	(.26)
5304	30	.58	(.26)
5306	37 1/2	.58	(.26)
5307	52 1/2	.58	(.26)
5308	60	.58	(.26)
5309	67 1/2	.58	(.26)
5310	75	.58	(.26)
5311	82 1/2	.58	(.26)
5315	45	.58	(.26)

FIG. 5340 - 5350

4-HOLE OPEN ANGLE CONNECTOR

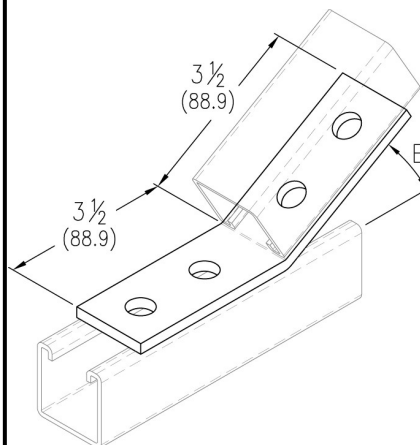

Fig. No.	Angle B°	Wt. Each	
		lbs.	kg
5340	7 1/2	.78	(.35)
5341	15	.78	(.35)
5342	22 1/2	.78	(.35)
5343	30	.78	(.35)
5344	37 1/2	.78	(.35)
5345	45	.78	(.35)
5346	52 1/2	.78	(.35)
5347	60	.78	(.35)
5348	67 1/2	.78	(.35)
5349	75	.78	(.35)
5350	82 1/2	.78	(.35)

FIG. 5360 - 5366

2-HOLE CLOSED ANGLE CONNECTOR

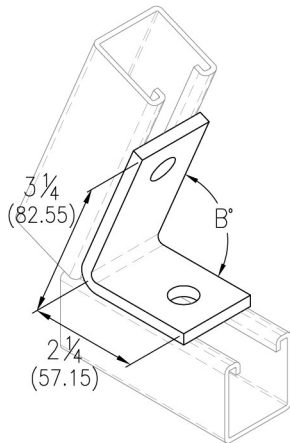

Fig. No.	Angle B°	Wt. Each	
		lbs.	kg
5360	37 1/2	.58	(.26)
5361	45	.58	(.26)
5362	52 1/2	.58	(.26)
5363	60	.58	(.26)
5364	67 1/2	.58	(.26)
5365	75	.58	(.26)
5366	82 1/2	.58	(.26)

FIG. 5370 - 5376

4-HOLE CLOSED ANGLE CONNECTOR

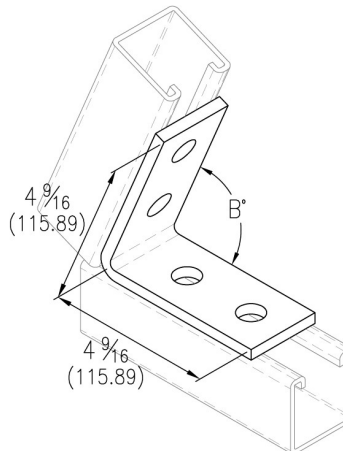
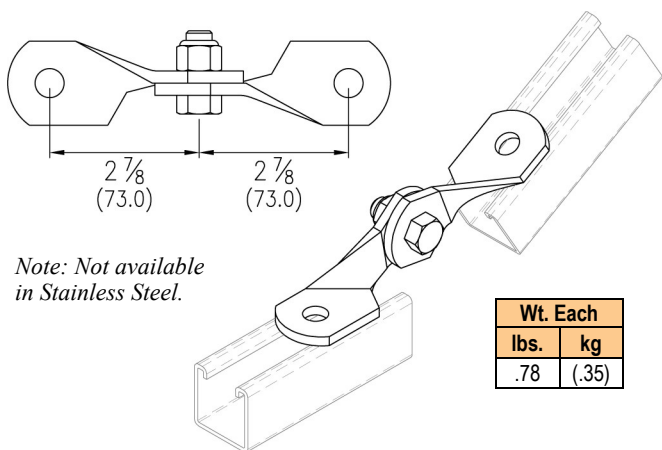

Fig. No.	Angle B°	Wt. Each	
		lbs.	kg
5370	37 1/2	.95	(.43)
5371	45	.95	(.43)
5372	52 1/2	.95	(.43)
5373	60	.95	(.43)
5374	67 1/2	.95	(.43)
5375	75	.95	(.43)
5376	82 1/2	.95	(.43)

FIG. 5380

2-HOLE ADJUSTABLE HINGE



Note: Not available in Stainless Steel.

Wt. Each	
lbs.	kg
.78	(.35)

FIG. 5381 & 5382

3-HOLE ADJUSTABLE HINGE

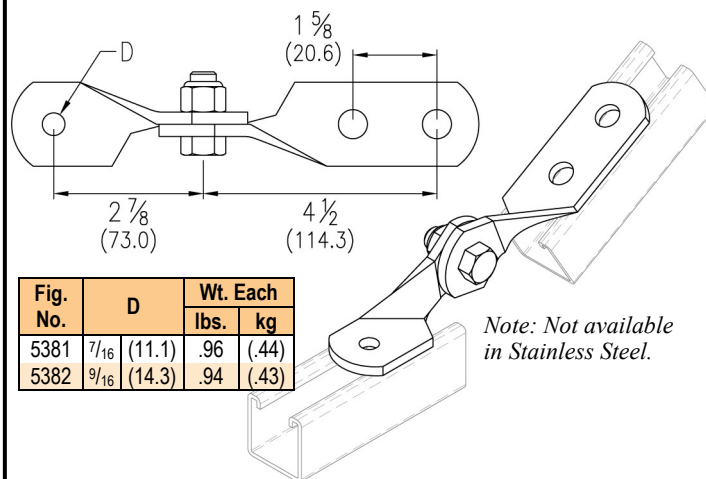

Note: Not available in Stainless Steel.

Fig. No.	D	Wt. Each	
		lbs.	kg
5381	7/16 (11.1)	.96	(.44)
5382	9/16 (14.3)	.94	(.43)

Standard Product Information for 1 5/8" (41.3) width series channel fittings (Unless Otherwise Noted)

Hole Diameter: 9/16" (14.3); Hole Spacing-From End: 1 3/16" (20.6); Hole Spacing-On Center: 1 7/8" (47.6); Width: 1 5/8" (41.3); Thickness: 1/4" (6.4)
Material: Carbon steel (Type 304 or 316 Stainless Steel upon request); Finish: Electro-galvanized (hot-dip galvanized, e-coat, and powder coated upon request)
Ordering: Specify figure number, material, and finish.

Unless otherwise specified, all dimensions on drawings and in charts are in inches and dimensions shown in parentheses are in millimeters.

ANGLE FITTINGS



FIG. 5383

4-HOLE ADJUSTABLE HINGE

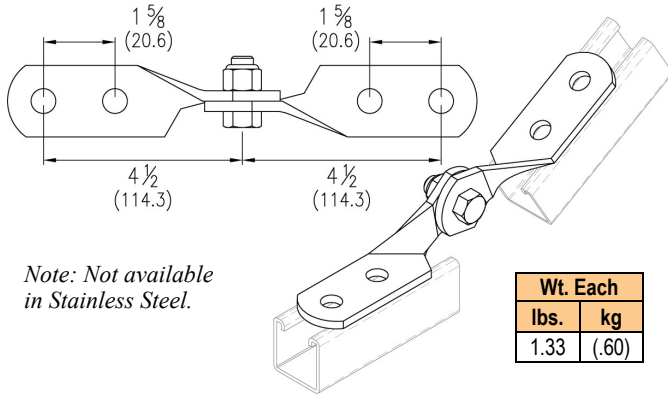

FIG. 5384

2-HOLE ADJUSTABLE HINGE

Wt. Each	
lbs.	kg
.68	(.31)

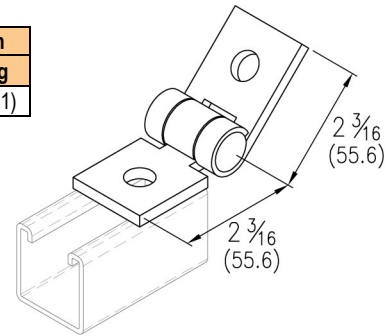

FIG. 5385

3-HOLE ADJUSTABLE HINGE

Wt. Each	
lbs.	kg
.89	(.40)

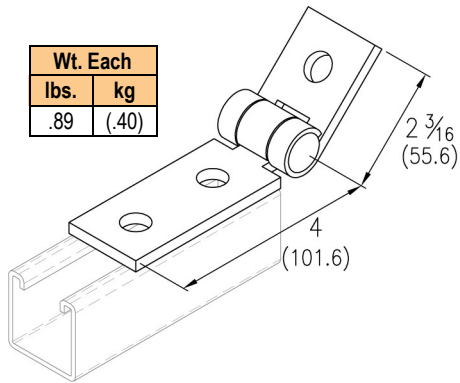
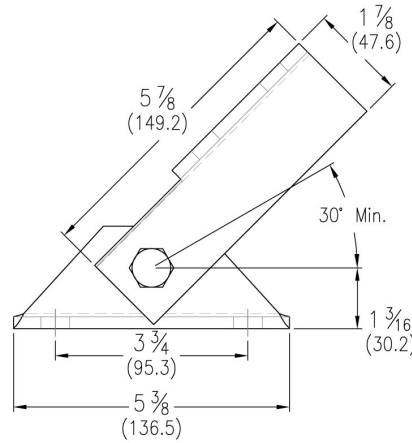

FIG. 5390

SINGLE ADJUSTABLE BRACE FOR USE WITH 1 5/8" STRUT



Wt. Each	
lbs.	kg
3.07	(1.40)

Note: Not available in Stainless Steel.

FIG. 5386

4-HOLE ADJUSTABLE HINGE

Wt. Each	
lbs.	kg
1.09	(.49)

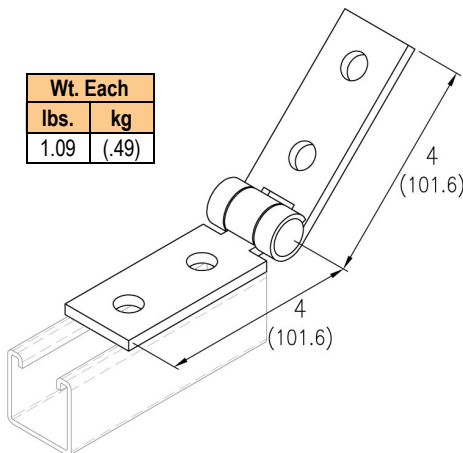
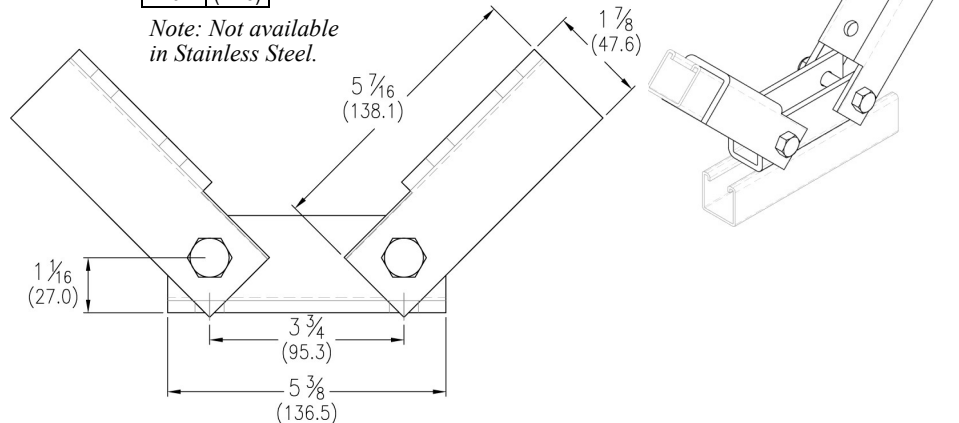

FIG. 5395

DOUBLE ADJUSTABLE BRACE FOR USE WITH 1 5/8" STRUT

Wt. Each	
lbs.	kg
4.97	(2.25)

Note: Not available in Stainless Steel.



Standard Product Information for 1 5/8" (41.3) width series channel fittings (Unless Otherwise Noted)

Hole Diameter: 9/16" (14.3); Hole Spacing-From End: 1 3/16" (20.6); Hole Spacing-On Center: 1 7/8" (47.6); Width: 1 5/8" (41.3); Thickness: 1/4" (6.4)
 Material: Carbon steel (Type 304 or 316 Stainless Steel upon request); Finish: Electro-galvanized (hot-dip galvanized, e-coat, and powder coated upon request)
 Ordering: Specify figure number, material, and finish.

Unless otherwise specified, all dimensions on drawings and in charts are in inches and dimensions shown in parentheses are in millimeters.

CHANNEL
 PIPE & CONDUIT SUPPORTS
 STRUT NUTS & HARDWARE
 CONCRETE INSERTS
 END CAPS & CLOSURES
 FLAT PLATE FITTINGS
 90° ANGLE FITTINGS
 ANGLE FITTINGS
 "U" FITTINGS
 "Z" FITTINGS
 WING FITTINGS
 SPECIALTY FITTINGS
 TROLLEY ASSEMBLIES
 POST BASES
 BRACKETS & BRACE FITTINGS
 BEAM CLAMPS
 ROOFTOP SUPPORTS