



MULTI FITTINGS

LAYING LENGTH

ISSUE DATE: OCT 30/17
SUPERCEDES: MAR 11/05

COUPLING (GxG) (WITH PIPE STOP)

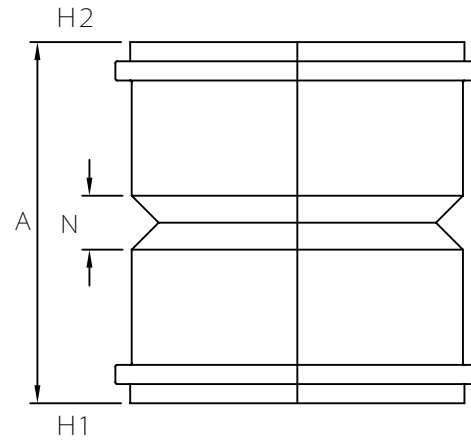
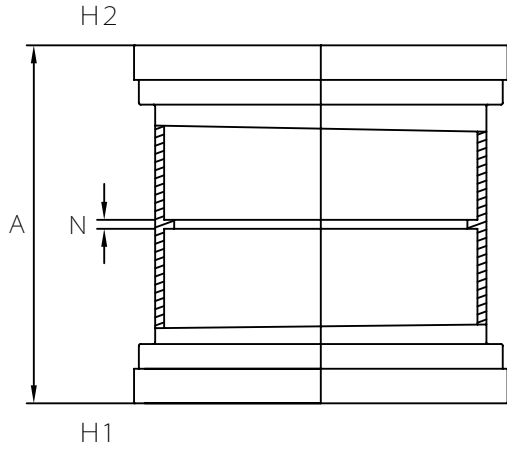

INJECTION MOLDED FITTING (M)

FABRICATED FITTING (F)

| | SIZE H1xH2 | PART NUMBER | A REF | N REF |
|--------|---------------|----------------|----------|----------|
| M = | 4x4 | 063640 | 4.250 | 0.125 |
| M = | 6x6 | 063643 | 6.000 | 0.180 |
| M = | 8x8 | 063644 | 9.625 | 0.240 |
| M = | 10x10 | 063645 | 10.000 | 0.300 |
| F @ | 12x12 | 043632 | 15.000 | - |
| F @ | 15x15 | 043638 | 17.500 | - |
| ++ F @ | 18x18 | 043935 | 23.500 | - |
| ++ F @ | 21x21 | 043934 | 32.250 | - |
| ++ F @ | 24x24 | 043933 | 34.500 | - |

Note: = Refer to Page G4 for Hub Detail, Type A
 @ Refer to Page G5 for Hub Detail, Fabricated
 ++ FRP Reinforced