



EasyInstall™

**PRE-RINSE UNIT
B-0133 Series
(B-0133-B, Pre-Rinse
Unit w/Wall Bracket)**

Installation and Maintenance Instructions

Limited One Year Warranty

T&S warrants to the original purchaser (other than for purposes of resale) that such product is free from defects in material and workmanship for a period of one (1) year from the date of purchase. During this one-year warranty period, if the product is found to be defective, T&S shall, at its option, repair and/or replace it. To obtain warranty service, products must be returned to....

T&S Brass and Bronze Works, Inc.
Attn: Warranty Repair Department
2 Saddleback Cove
Travelers Rest, SC 29690

Shipping, freight, insurance, and other transportation charges of the product to T&S and the return of repaired or replaced product to the purchaser are the responsibility of the purchaser. Repair and/or replacement shall be made within a reasonable time after receipt by T&S of the returned product. This warranty does not cover items which have received secondary finishing or have been altered or modified after purchase, or for defects caused by physical abuse to or misuse of the product, or shipment of the products.

Any express warranty not provided herein, and any remedy for Breach of Contract which might arise, is hereby excluded and disclaimed. Any implied warranties of merchantability or fitness for a particular purpose are limited to one year in duration. Under no circumstance shall T&S be liable for loss of use or any special consequential cost, expenses or damages.

Some states do not allow limitations on how long an implied warranty lasts or the exclusion or limitation of incidental or consequential damages, so the above limitations or exclusions may not apply to you. Specific rights under this warranty and other rights vary from state to state.

P/N: 098-014497-45 REV. 6
DATE: 04-26-12
DRAWN: TEH
CHECKED: JRM 06-13-12
APPROVED: JHB 06-21-12



Step 1:
Apply plumber's putty to backside of body and insert into mounting hole. Line up water supply lines and couplings, attach and tighten with wrench.



Step 2:
Apply plumber's tape to top of riser threads and attach to spring assembly. Tighten with wrench.



Step 3:
Make sure that the EasyInstall® locking washer is seated properly inside the faucet body.

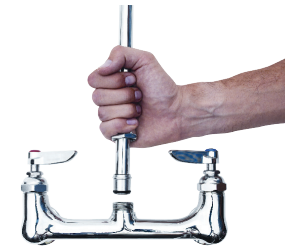

Step 4:
Grab riser assembly and lower the EasyInstall® end-fitting into faucet body. Press down until the end-fitting "pops" in.



Step 5:
Lock the EasyInstall® locking nut in place and tighten with wrench.

Base Faucet Assembly

| | | |
|----------------------|--------------------------------------|-----------|
| Base Faucet Assembly | | |
| 1 | Faucet Body Assembly | 014209-40 |
| | Faucet Base Asm w/ Cerama Cartridge | 015068-40 |
| 2 | Asm, Spindle - Hot w/ Spring Check | 002712-40 |
| | Hot Cartridge Only w/ Spring Check | 012443-40 |
| 3 | Asm, Spindle - Cold w/ Spring Check | 002711-40 |
| | Cold Cartridge Only w/ Spring Check | 012442-40 |
| 41 | Cerama Cartridge w/ Check Valve, RTC | 011311-25 |
| 42 | Cerama Cartridge w/ Check Valve, LTC | 011312-25 |
| 4 | Handle, Lever - Blank | 001638-45 |
| 5 | Screw, Handle | 000922-45 |
| 6 | Index, Button - Hot (Red) | 001661-45 |
| 7 | Index, Button - Cold (Blue) | 001660-45 |
| 8 | Washer | 001019-45 |
| 9 | Asm, Coupling Flange | 00AA |
| 10 | Lock Washer, EasyInstall® | 014200-45 |

Riser Assembly

| | | |
|---------------------|---|-----------|
| Riser Assembly, 18" | | |
| 11 | Nipple, 3/8" x 18" | 000369-40 |
| 12 | Swivel Assembly, EasyInstall® | EZ-K |
| 13 | Swivel Piece | N/A |
| 14 | O-Ring, Swivel Piece | 001065-45 |
| 15 | Asm, Finger Hook & Screw | 004R |
| 43 | Wall Bracket, 6" (add -B to model no. for wall bracket) | B-0109-01 |

Pre-Rinse Unit

| | | |
|--------------------|--------------------------------|-----------|
| Pre-Rinse Assembly | | |
| 16 | Spring, Body | 000821-40 |
| 17 | Spring, Overhead | 000888-45 |
| 18 | Asm, Flex Stainless Steel Hose | B-0044-H |
| 19 | Asm, Spray Valve | B-0107 |

Spray Valve Assembly

| | | |
|------------------------------|-------------------------------|-----------|
| Asm, Hold Down Ring & Washer | | |
| 20 | Washer | 010476-45 |
| 21 | Ring, Hold Down | 000907-45 |
| 22 | Body, Spray Valve (No Handle) | 000065-40 |
| 23 | Handle | 001120-45 |
| 24 | Nut, Handle | 003198-45 |
| 25 | Screw, Handle | 003199-45 |
| 26 | Nipple | 000694-40 |
| 27 | Cup, Spray | 000019-40 |
| 28 | * Ring, Sprayhead | 007861-45 |
| 29 | * Sprayface | 001121-45 |
| 30 | * Screw, Sprayface | 000913-45 |

Bonnet Assembly

| | | |
|-------------|----------------------------------|-----------|
| Asm, Bonnet | | |
| 31 | Asm, Bonnet | 002856-40 |
| 32 | * Stem | 009306-20 |
| 33 | * Washer, Seat | 012915-45 |
| 34 | * Washer, Bonnet Binding | 001040-45 |
| 35 | Bonnet | 000608-25 |
| 36 | * Washer, Bonnet Brass | 000974-45 |
| 37 | * Stem, Packing | 001100-45 |
| 38 | * Spring, Bonnet | 000895-45 |
| 39 | Push Button | 000753-25 |
| 40 | * Grease Pack (O-Ring Lubricant) | 012665-45 |

* Parts included in B-10K parts kit

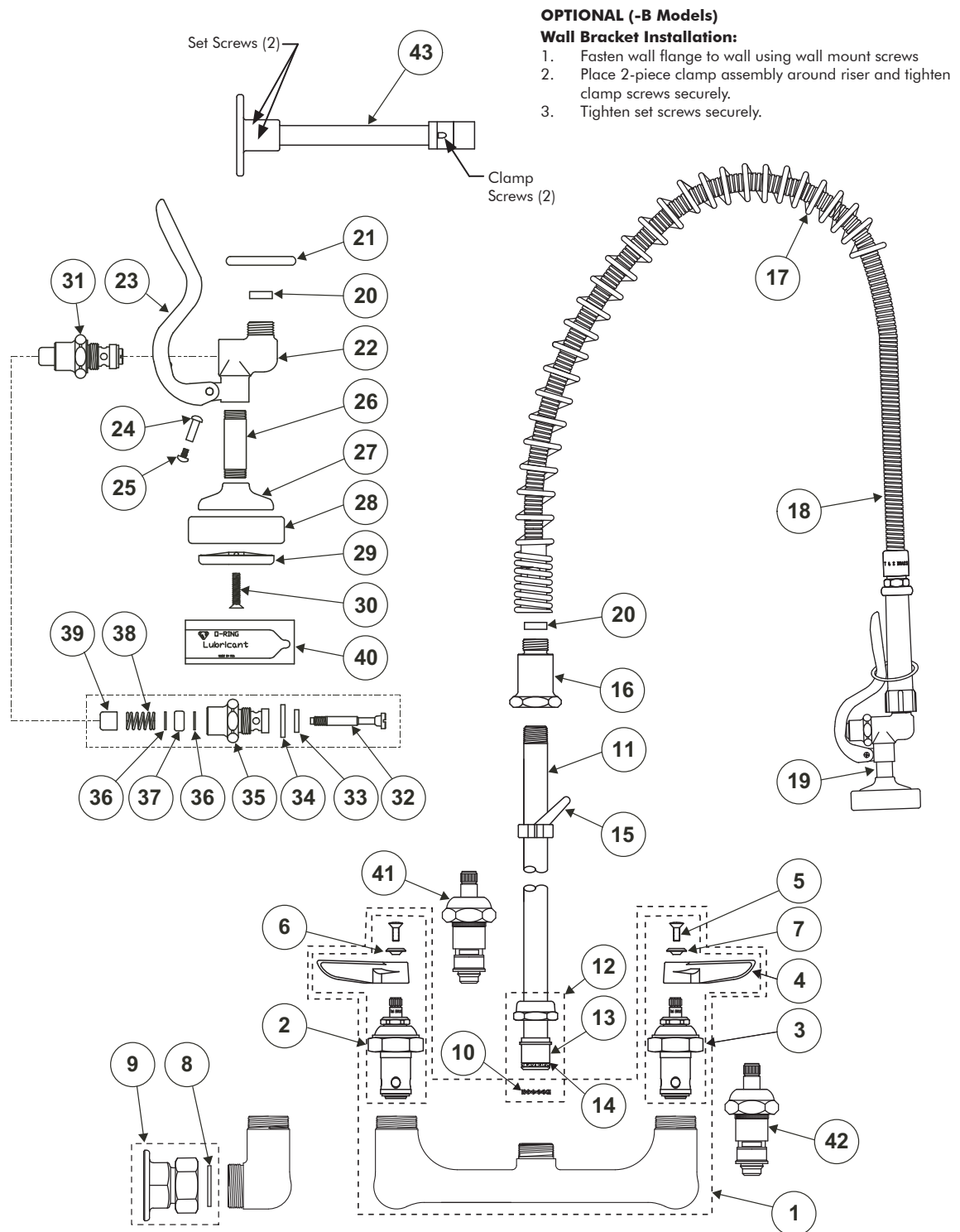

OPTIONAL (-B Models)

Wall Bracket Installation:

1. Fasten wall flange to wall using wall mount screws
2. Place 2-piece clamp assembly around riser and tighten clamp screws securely.
3. Tighten set screws securely.