

# INSTALLATION INSTRUCTIONS SOAP/ LOTION DISPENSER

NEWPORT BRASS®

Flawless Beauty. From Faucet to Finish.™

Model No's:  
124, 125, 127

## Installation Instructions:

1. Remove the Head/Pump assembly from Dispenser.
2. Remove Bottle and Mounting Kit from Nipple.
3. With Housing, Escutcheon and Nipple assembled, place Nipple through hole in Mounting Deck (minimum hole diameter is 1-1/8").
4. From underside of Deck, secure into place with Mounting Kit.
5. Securely attach Bottle to Nipple.
6. Fill Dispenser Bottle, with desired liquid, to 1" below top of Housing.
7. Insert head/pump assembly into Housing.

Note: Dispenser Housing and Tube Extensions available (#5-004), but not included.

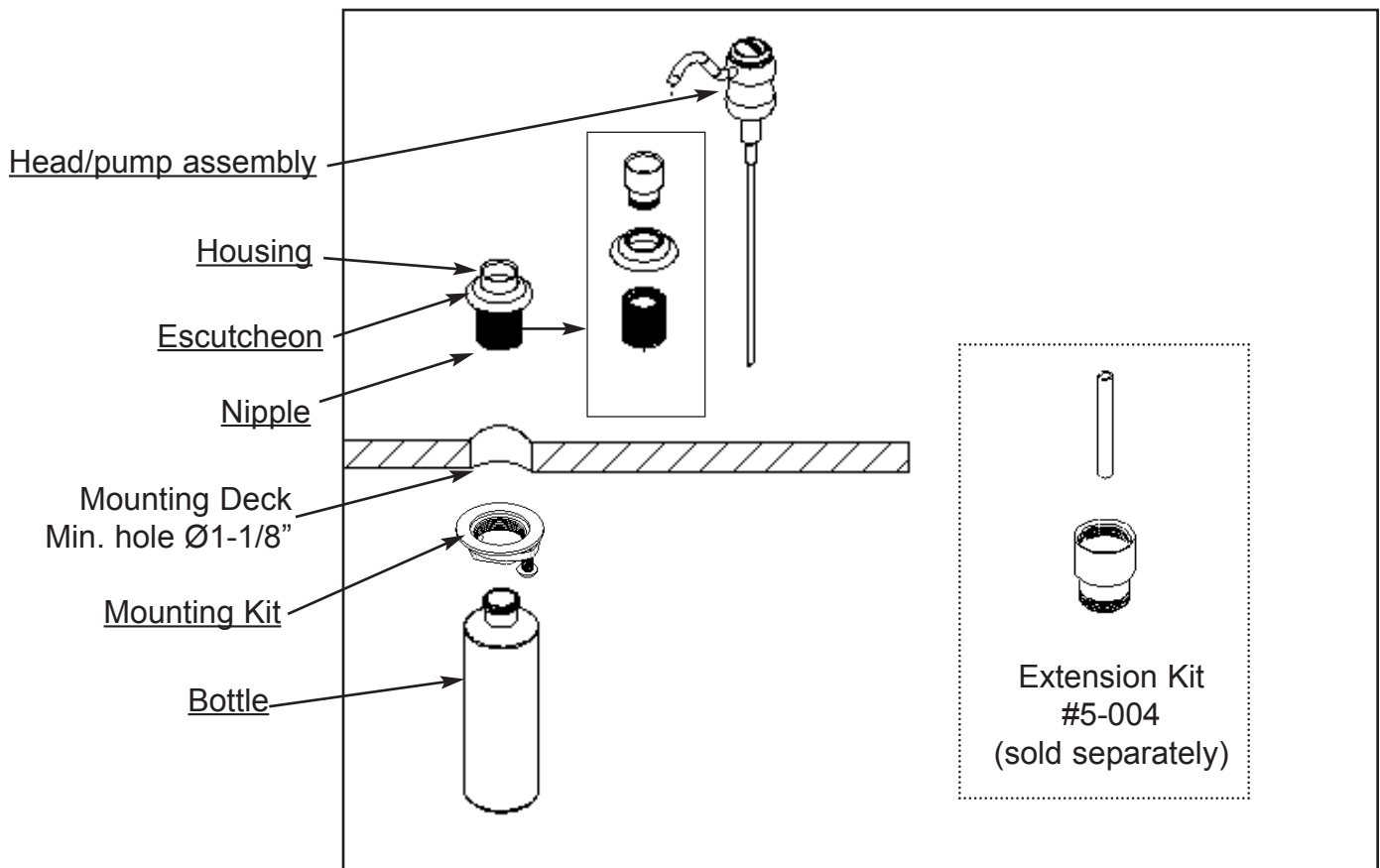

2001 CARNEGIE AVE, SANTA ANA CA 92705

(949) 417-5207

WWW.NEWPORTBRASS.COM

NWP-124 Rev B  
EN-3763

12/31/18