



MULTI FITTINGS

LAYING LENGTH

ISSUE DATE: 2018 02 07
SUPERCEDES: 2005 06 30

CLEANOUT TEE (W/PLUG) (HxHxFPT)

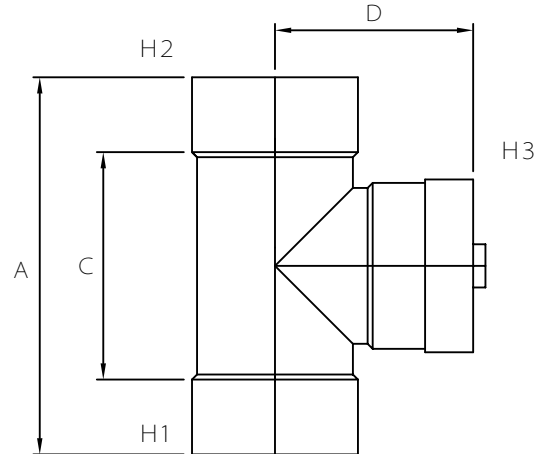

| | SIZE H1xH2xH3 | PART NUMBER | A REF | C REF | D REF |
|---|------------------|----------------|----------|----------|----------|
| A | 4x4x4 | 026004 | - | - | - |
| P | 6x6x4 | 026529 | - | - | - |
| A | 6x6x6 | 026530 | - | - | - |
| P | 8x8x4 | 026116 | - | - | - |
| P | 8x8x6 | 026531 | - | - | - |
| P | 8x8x8 | 026959 | - | - | - |
| F | 10x10x4 | 295521 | 20.50 | 10.50 | - |
| F | 10x10x6 | 295522 | 22.75 | 12.75 | - |
| F | 10x10x8 | 295523 | 24.75 | 14.75 | - |
| F | 10x10x10 | 295515 | 26.75 | 16.75 | - |
| F | 12x12x4 | 295524 | 22.75 | 10.75 | - |
| F | 12x12x6 | 295525 | 25.00 | 13.00 | - |
| F | 12x12x8 | 295526 | 27.00 | 15.00 | - |
| F | 12x12x10 | 295527 | 29.00 | 17.00 | - |
| F | 12x12x12 | 295516 | 31.00 | 19.00 | - |
| F | 14x14x4 | 295528 | 24.75 | 10.75 | - |
| F | 14x14x6 | 295529 | 27.00 | 13.00 | - |
| F | 14x14x8 | 295530 | 29.00 | 15.00 | - |
| F | 14x14x10 | 295531 | 31.00 | 17.00 | - |
| F | 14x14x12 | 295532 | 33.00 | 19.00 | - |
| F | 16x16x4 | 295533 | 27.00 | 11.00 | - |
| F | 16x16x6 | 295534 | 29.25 | 13.25 | - |
| F | 16x16x8 | 295535 | 31.25 | 15.25 | - |
| F | 16x16x10 | 295536 | 33.25 | 17.25 | - |
| F | 16x16x12 | 295537 | 35.25 | 19.25 | - |
| F | 18x18x8 | 026160 | - | - | - |

NOTE: Refer to Page LPD5 for Molded hub detail
Refer to Page LPD5 - 1 for Fabricated hub detail