

Fast & Tite® Thermoplastic Fittings

Fast & Tite® fittings are the most complete line of plastic fittings for thermoplastic tubing in the industry.

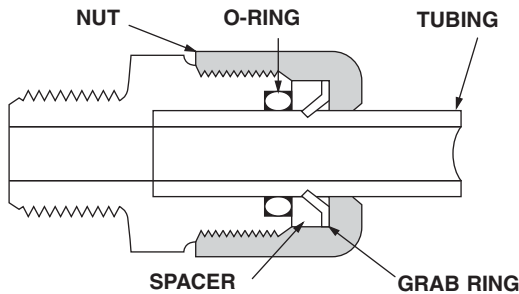

Fast & Tite® thermoplastic tube fittings from Parker will prove to be the answer to your tubing connector needs. Patented Fast & Tite® fittings install in seconds without tools and provide a tight, sure, leak proof seal without clamps or adjustments. A unique 302 stainless steel grab ring for tube retention, coupled with a Nitrile O-Ring for positive seal, assures good tube connection with only hand tight assembly. A plastic grab ring is also available upon special request. Vibration or tube movement will not break the seal and cause leakage. Preassembled in either highly inert polypropylene, or strong, durable nylon, Fast & Tite® fittings are the answer to full flow thermoplastic tubing system requirements. When necessary, Fast & Tite® fittings can be disassembled by hand for fast system drainage. Fittings are completely reusable.

Parts are easily replaced. O-Rings are standard size and universally available. (For applications requiring other than Nitrile O-Rings, consult your Fast & Tite® distributor.)

Use Fast & Tite® fittings with Parker Parflex tubing or other plastic, glass or metal tubing for low pressure or vacuum lines up to the pressure limits shown below.

Fast & Tite® fittings meet FDA and NSF-51 requirements for food contact.

Working Pressures for Fast & Tite® Fittings

Tube O. D., in.	Air-Oil-Water Pressure in PSI		
	Up to 75°F	76° to 125°F	126° to 175°F
1/4	300	300	300
5/16	300	300	300
3/8	250	250	150
1/2	200	200	150
5/8	150	100	50

Ratings are based on use with copper tubing, and in all cases represent the maximum recommended working pressure of the fitting only. Working pressures (vs. temperatures) of other types of tubing may limit the tube and fitting assembly to pressures lower than shown above. Consult factory for recommendations on applications other than shown above.

Temperature Range:

Black/White Polypropylene: 0°F (-18°C) to +212°F (+100°C)
White Nylon: -40°F (-40°C) to +200°F (+93°C)

Fast Assembly

Step 1.

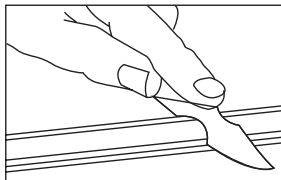

Cut the tube squarely and remove any burrs.

Step 2.

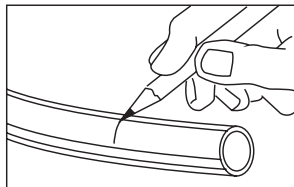

Mark from end of tube the length of insertion. (See table below)

Tube O.D. (in.)	Insertion Length with Tube Support (in.)	Insertion Length without Tube Support (in.)
1/4	5/8	9/16
5/16	5/8	9/16
3/8	13/16	3/4
1/2	7/8	13/16
5/8	1	15/16

Step 3.

Loosen nut on fitting until three threads are visible. Fittings for glass tubes must be disassembled and the grab ring removed.

Step 4.

Moisten end of the tube with water. Push the tube **Straight** into fitting until it bottoms on the fitting's shoulder. Tighten nut by hand. Additional tightening should not be necessary, but 1/4 additional turn may be added if desired. **Do not overtighten** nut as the threads will strip and the fitting will not function properly. A proper assembly will not show the insertion mark extending beyond the nut. If the insertion mark is visible, then steps 1 thru 4 must be repeated.

Step 5.

When using clear vinyl tubing or urethane tubing, it is necessary to use a **TS** tube support. Disassemble the fitting and place the nut, grab ring, spacer and tube support, in that order on the tube. Locate the grab ring at the insertion mark as shown. Seat the O-ring in the body, then proceed with Step 4.

Note: Provide adequate fail-safe mechanisms such as leakage detection sensors, automatic shut-off controls or other industry and code appropriate fail-safe devices in the design of your water-handling appliance to protect against personal injury and property damage.

Plastic fittings containing an o-ring that are used in water applications should be replaced at least every five years or more frequently depending on the environment and severity of the application.

MC - Male Connector

Tube to male pipe

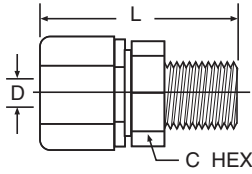

White Polypropylene Part Number	Black Polypropylene Part Number	White Nylon Part Number	Nom. Tube O. D.	NPTF Thread Size	C Hex	L Overall Length	D Thru-Hole Min.
#	#	#					
W4MC2	P4MC2	N4MC2	1/4	1/8	11/16	1.38	.170
W4MC4	P4MC4	N4MC4	1/4	1/4	11/16	1.51	.170
W4MC6	P4MC6	N4MC6	1/4	3/8	11/16	1.48	.170
W5MC2	P5MC2	N5MC2	5/16	1/8	11/16	1.38	.170
W5MC4	P5MC4	N5MC4	5/16	1/4	11/16	1.50	.250
W6MC2	P6MC2	N6MC2	3/8	1/8	13/16	1.50	.170
W6MC4	P6MC4	N6MC4	3/8	1/4	13/16	1.67	.250
W6MC6	P6MC6	N6MC6	3/8	3/8	13/16	1.67	.250
W6MC8	P6MC8	N6MC8	3/8	1/2	1	1.78	.250
W6MC12	P6MC12	N6MC12	3/8	3/4	1	1.84	.250
W8MC2	P8MC2	N8MC2	1/2	1/8	1	1.61	.170
W8MC4	P8MC4	N8MC4	1/2	1/4	1	1.74	.250
W8MC6	P8MC6	N8MC6	1/2	3/8	1	1.74	.375
W8MC8	P8MC8	N8MC8	1/2	1/2	1	1.87	.375
W8MC12	P8MC12	N8MC12	1/2	3/4	1	1.89	.375
W10MC2	P10MC2	N10MC2	5/8	1/8	1-1/8	1.75	.170
W10MC4	P10MC4	N10MC4	5/8	1/4	1-1/8	1.90	.250
W10MC6	P10MC6	N10MC6	5/8	3/8	1-1/8	1.90	.375
W10MC8	P10MC8	N10MC8	5/8	1/2	1-1/8	2.01	.500
W10MC12	P10MC12	N10MC12	5/8	3/4	1-1/8	2.04	.500

E

UC - Union Connector

Tube to tube

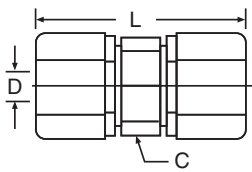

White Polypropylene Part Number	Black Polypropylene Part Number	White Nylon Part Number	Nom. Tube O. D.	C Hex	L Overall Length	D Thru-Hole Min.
#	#	#				
W4UC4	P4UC4	N4UC4	1/4	11/16	1.62	.170
W5UC4	P5UC4	N5UC4	5/16-1/4	11/16	1.62	.170
W5UC5	P5UC5	N5UC5	5/16	11/16	1.62	.190
W6UC4	P6UC4	N6UC4	3/8-1/4	13/16	1.80	.170
W6UC5	P6UC5	N6UC5	3/8-5/16	13/16	1.80	.190
W6UC6	P6UC6	N6UC6	3/8	13/16	1.92	.250
W8UC6	P8UC6	N8UC6	1/2-3/8	1	1.95	.250
W8UC8	P8UC8	N8UC8	1/2	1	2.03	.375
W10UC6	P10UC6	N10UC6	5/8-3/8	1-1/8	2.19	.250
W10UC8	P10UC8	N10UC8	5/8-1/2	1-1/8	2.24	.375
W10UC10	P10UC10	N10UC10	5/8	1-1/8	2.40	.500

ME - Male Elbow

Tube to male pipe

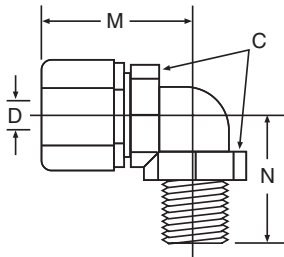

White Polypropylene Part Number	Black Polypropylene Part Number	White Nylon Part Number	Nom. Tube O. D.	NPTF Thread Size	C Hex	M	N	D Thru-Hole Min.
#	#	#						
W4ME2	P4ME2	N4ME2	1/4	1/8	3/4	1.06	0.81	.170
W4ME4	P4ME4	N4ME4	1/4	1/4	3/4	1.06	1.02	.170
W4ME6	P4ME6	N4ME6	1/4	3/8	3/4	1.06	1.02	.170
W5ME2	P5ME2	N5ME2	5/16	1/8	3/4	1.06	0.81	.193
W5ME4	P5ME4	N5ME4	5/16	1/4	3/4	1.06	1.02	.193
W5ME6	P5ME6	N5ME6	5/16	3/8	3/4	1.06	1.02	.193
W6ME4	P6ME4	N6ME4	3/8	1/4	7/8	1.28	1.12	.250
W6ME6	P6ME6	N6ME6	3/8	3/8	7/8	1.28	1.12	.250
W6ME8	P6ME8	N6ME8	3/8	1/2	1-1/16	1.28	1.34	.250
W6ME12	P6ME12	N6ME12	3/8	3/4	1-3/16	1.59	1.40	.250
W8ME4	P8ME4	N8ME4	1/2	1/4	1-1/16	1.48	1.22	.250
W8ME6	P8ME6	N8ME6	1/2	3/8	1-1/16	1.56	1.21	.375
W8ME8	P8ME8	N8ME8	1/2	1/2	1-1/16	1.56	1.34	.375
W8ME12	P8ME12	N8ME12	1/2	3/4	1-1/8	1.50	1.40	.375
W10ME8	P10ME8	N10ME8	5/8	1/2	1-3/16	1.72	1.40	.500

EU - Elbow Union

Tube to tube

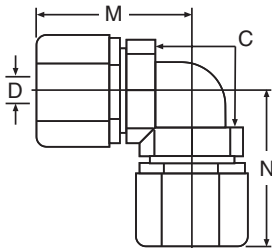

White Polypropylene Part Number	Black Polypropylene Part Number	White Nylon Part Number	Nom. Tube O. D.	C Hex	M	N	D Thru-Hole Min.
#	#	#					
W4EU4	P4EU4	N4EU4	1/4	3/4	1.06	1.06	.170
W5EU4	P5EU4	N5EU4	5/16-1/4	3/4	1.06	1.06	.170
W5EU5	P5EU5	N5EU5	5/16	3/4	1.06	1.06	.193
W6EU4	P6EU4	N6EU4	3/8-1/4	7/8	1.06	1.28	.170
W6EU5	P6EU5	N6EU5	3/8-5/16	7/8	1.06	1.28	.170
W6EU6	P6EU6	N6EU6	3/8	7/8	1.28	1.28	.250
W8EU6	P8EU6	N8EU6	1/2-3/8	1-1/16	1.37	1.56	.250
W8EU8	P8EU8	N8EU8	1/2	1-1/16	1.56	1.56	.375
W10EU10	P10EU10	N10EU10	5/8	1-3/16	1.72	1.72	.500

BU - Bulkhead Union

Tube to tube

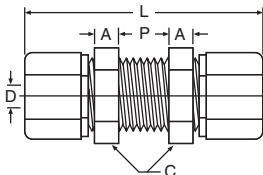

White Polypropylene Part Number	Black Polypropylene Part Number	White Nylon Part Number	Nom. Tube O. D.	A Ref.	C Hex	L Overall Length	P Max.	D Thru-Hole Min.	Bulkhead Hole Drill Size
#	#	#							
W4BU4	P4BU4	N4BU4	1/4	1/4	13/16	2-11/64	3/8	.170	21/32
W5BU5	P5BU5	N5BU5	5/16	1/4	13/16	2-11/64	3/8	.187	21/32
W6BU6	P6BU6	N6BU6	3/8	9/32	15/16	2-39/64	1/2	.250	25/32
W8BU8	P8BU8	N8BU8	1/2	5/16	1-5/32	2-3/4	1/2	.375	31/32



FE - Female Elbow

Tube to female pipe

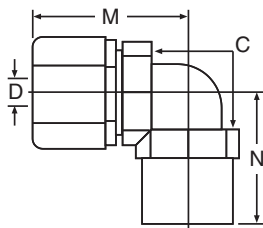

White Polypropylene Part Number	Black Polypropylene Part Number	White Nylon Part Number	Nom. Tube O. D.	NPTF Thread Size	C Hex	M	N	D Thru-Hole Min.
#	#	#						
W4FE2	P4FE2	N4FE2	1/4	1/8	11/16	1.10	0.84	.170
W4FE4	P4FE4	N4FE4	1/4	1/4	11/16	1.10	0.97	.170
W5FE2	P5FE2	N5FE2	5/16	1/8	11/16	1.10	0.84	.193
W6FE4	P6FE4	N6FE4	3/8	1/4	13/16	1.30	1.06	.250
W6FE6	P6FE6	N6FE6	3/8	3/8	13/16	1.30	1.03	.250
W8FE6	P8FE6	N8FE6	1/2	3/8	1	1.50	1.16	.375
W8FE8	P8FE8	N8FE8	1/2	1/2	1	1.50	1.27	.375
W10FE8	P10FE8	N10FE8	5/8	1/2	1-1/8	1.70	1.34	.500

FC - Female Connector

Tube to female pipe

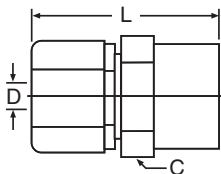

White Polypropylene Part Number	Black Polypropylene Part Number	White Nylon Part Number	Nom. Tube O. D.	NPTF Thread Size	C Hex	L Overall Length	D Thru-Hole Min.
#	#	#					
W4FC2	P4FC2	N4FC2	1/4	1/8	11/16	1.30	.170
W4FC4	P4FC4	N4FC4	1/4	1/4	11/16	1.40	.170
W6FC4	P6FC4	N6FC4	3/8	1/4	1	1.57	.250
W6FC6	P6FC6	N6FC6	3/8	3/8	1-1/8	1.57	.250
W6FC8	P6FC8	N6FC8	3/8	1/2	1-1/8	1.67	.250
W8FC6	P8FC6	N8FC6	1/2	3/8	1	1.66	.375
W8FC8	P8FC8	N8FC8	1/2	1/2	1-1/8	1.78	.375
W10FC8	P10FC8	N10FC8	5/8	1/2	1-1/8	1.95	.500

MR - Male Run Tee

Tube to male pipe

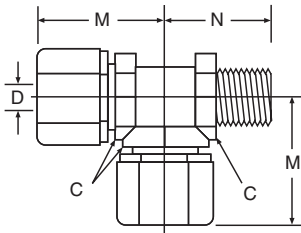

White Polypropylene Part Number	Black Polypropylene Part Number	White Nylon Part Number	Nom. Tube O. D.	NPTF Thread Size	C Hex	M	N	D Thru-Hole Min.
#	#	#						
W4MR2	P4MR2	N4MR2	1/4	1/8	11/16	1.09	0.89	.170
W6MR4	P6MR4	N6MR4	3/8	1/4	13/16	1.30	1.17	.250
W8MR6	P8MR6	N8MR6	1/2	3/8	1	1.46	1.28	.375
W10MR8	P10MR8	N10MR8	5/8	1/2	1-1/8	1.68	1.50	.500

TU - Tee Union

Tube to tube

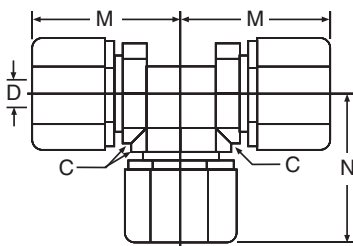

White Polypropylene Part Number	Black Polypropylene Part Number	White Nylon Part Number	Nom. Tube O. D.	C Hex	M	N	D Thru-Hole Min.
#	#	#					
W4TU4	P4TU4	N4TU4	1/4	11/16	1.09	1.09	.170
W5TU5	P5TU5	N5TU5	5/16	11/16	1.09	1.09	.187
W6TU6	P6TU6	N6TU6	3/8	13/16	1.30	1.30	.250
W8TU6	P8TU6	N8TU6	1/2-3/8	1	1.46	1.39	.250
W8TU8	P8TU8	N8TU8	1/2	1	1.46	1.46	.375
W10TU6	P10TU6	N10TU6	5/8-3/8	1-1/8	1.68	1.46	.250
W10TU10	P10TU10	N10TU10	5/8	1-3/16	1.68	1.68	.500

MT - Male Branch Tee

Tube to male pipe

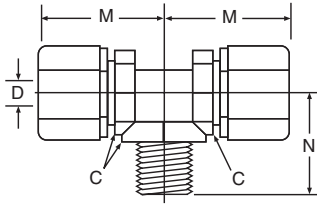

White Polypropylene Part Number	Black Polypropylene Part Number	White Nylon Part Number	Nom. Tube O. D.	NPTF Thread Size	C Hex	M	N	D Thru-Hole Min.
#	#	#						
W4MT2	P4MT2	N4MT2	1/4	1/8	11/16	1.09	0.89	.170
W4MT4	P4MT4	N4MT4	1/4	1/4	11/16	1.09	1.06	.170
W5MT2	P5MT2	N5MT2	5/16	1/8	11/16	1.09	0.89	.170
W5MT4	P5MT4	N5MT4	5/16	1/4	11/16	1.09	1.06	.187
W6MT4	P6MT4	N6MT4	3/8	1/4	13/16	1.30	1.12	.250
W6MT6	P6MT6	N6MT6	3/8	3/8	13/16	1.30	1.10	.250
W8MT6	P8MT6	N8MT6	1/2	3/8	1	1.46	1.22	.375
W8MT8	P8MT8	N8MT8	1/2	1/2	1	1.46	1.43	.375
W10MT8	P10MT8	N10MT8	5/8	1/2	1-1/8	1.68	1.41	.500

E

GR - Grab Ring (Stainless or Plastic)



Stainless Grab Ring Part Number	Plastic Grab Ring Part Number	O-Ring Part Number	For Nom. Tube O. D.
#	#	#	
4GR	4GRP	4OR	1/4
5GR	5GRP	5OR	5/16
6GR	6GRP	6OR	3/8
8GR	8GRP	8OR	1/2
10GR	10GRP	10OR	5/8

OR - O-Ring



TS - Tube Support

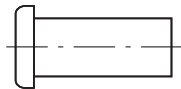

Polypropylene Part Number	Nylon Part Number	For Tube Part Number
#	#	
P4TS3	N4TS3	PV43
P5TS3	N5TS3	PV53
P6TS4	N6TS4	PV64
P8TS6	N8TS6	PV86
P10TS8	N10TS8	PV108

NS - Nut and Spacer Sets

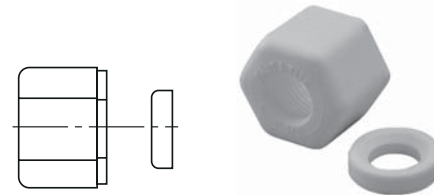

White Polypropylene Part Number	Black Polypropylene Part Number	White Nylon Part Number	For Nom. Tube O. D.
#	#	#	
W4NS	P4NS	N4NS	1/4
W5NS	P5NS	N5NS	5/16
W6NS	P6NS	N6NS	3/8
W8NS	P8NS	N8NS	1/2
W10NS	P10NS	N10NS	5/8