

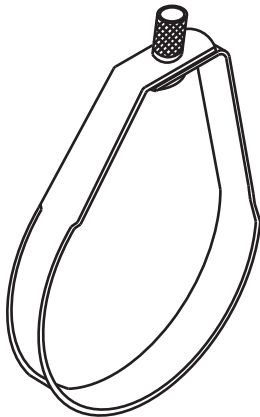

P.O. Box 3365 South El Monte, CA 91733 626.444.0541 Fax 626.444.3887 www.Afcon.org

### 300

## RING HANGER



1 thru 4 inch pipe  
LISTED FOR STEEL/CPVC



1/2 & 3/4 inch pipe  
5 thru 8 inch pipe

**SIZE - ROD-** 3/8" or 1/2"

**SIZE - SYSTEM PIPE -** 1/2" thru 8"

**MATERIAL -** Carbon Steel, Mil. Galvanized to G-90 spec.

**LISTING/APPROVAL -**



203-EX 2551 1" - 8"



Approval guide - 1" - 8"

OSHPD OPA-0601 See Website.

**CONFORMS WITH:** Federal Specification WW-H-171E, Type 10.

Manufacturers Standardization Society ANSI/MSS-SP-58 Type 10.

**MAXIMUM TEMPERATURE -** 650°F.

**FUNCTION -** Pipe hanger component of an *AFCON* hanger.

To support steel, CPVC or copper pipe.

**INSTALLATION -** Per NFPA 13, 13R, 13D, these instructions and the CPVC or copper pipe manufacturers instructions.

**FEATURES -**

\* Sized and listed exclusively for use with #310 Surge Restrainer.

\* Band edge is offset for EASY pipe insertion.

\* Custom fit swivel nut for better retention in ring.

**ORDERING -** Part #, pipe size.

NFPA 13				
PIPE	ROD	1 WT.	5 WT.+250	UL TEST LOAD
1	3/8	30.75	403.75	750
1 1/4	3/8	43.95	469.75	750
1 1/2	3/8	54.15	520.75	750
2	3/8	76.95	634.75	750
2 1/2	3/8	118.35	841.75	850
3	3/8	162.30	1061.50	1050
4	3/8	246.00	1480.00	1500
5	1/2	349.45	1996.75	2000
6	1/2	476.35	2631.75	2650
8	1/2	711.00	3805.00	4050

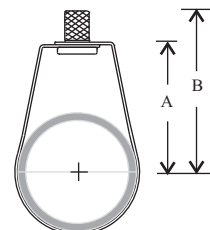

PIPE	A	B
1	1.8793	2.5259
1 1/4	2.1382	2.7850
1 1/2	2.2673	2.9140
2	2.6048	3.2516
2 1/2	3.4920	4.1150
3	3.7845	4.4311
4	4.3582	4.9992
6	6.0668	6.8180
8	7.5768	8.3290

