

## Features

- Brass construction
- Deck- or rim-mount
- 6-7/8" (175 mm) high-arch non-diverter spout with slip-fit connection

## BATH SPOUT K-956

## Codes/Standards Applicable

Specified model meets or exceeds the following:

- ASME A112.18.1/CSA B125.1

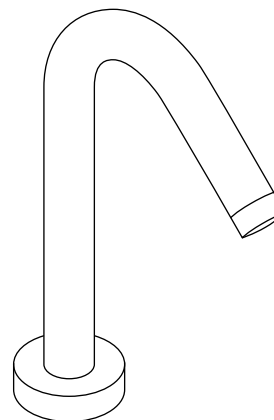

## Colors/Finishes

- CP: Polished Chrome
- Other: Refer to Price Book for additional colors/finishes

## Accessories

- NA: None applicable

## Specified Model:

Model	Description	Color/Finishes	
K-956	Bath spout	<input type="checkbox"/> CP	<input type="checkbox"/> Other_____

Required Accessories		
K-300-K	HiFlow valve system <b>OR</b>	<input type="checkbox"/> NA
K-300-KR	HiFlow valve system with rigid connections <b>OR</b>	<input type="checkbox"/> NA
K-301-K	HiFlow valve system <b>OR</b>	<input type="checkbox"/> NA
K-306-KS	HiFlow Rite-Temp pressure-balancing valve (use with K-411-K) <b>OR</b>	<input type="checkbox"/> NA
K-400-K	3/4" Thermostatic mixer less volume control (use with K-411-K) <b>OR</b>	<input type="checkbox"/> NA
K-401-K	3/4" Thermostatic mixer with volume control (use with K-411-K) <b>OR</b>	<input type="checkbox"/> NA
K-411-K	Bath filler spout stem	<input type="checkbox"/> NA

## Product Specification

Deck- or rim-mount bath spout shall be of brass construction. Product shall include 6-7/8" (175 mm) high-arch non-diverter spout with slip-fit connection. Spout shall be Kohler Model K-956-\_\_\_\_\_ and valve system shall be Kohler Model K-\_\_\_\_\_-\_\_\_\_\_-\_\_\_\_\_.

# STILLNESS®

## Installation Notes

Install this product according to the installation guide.

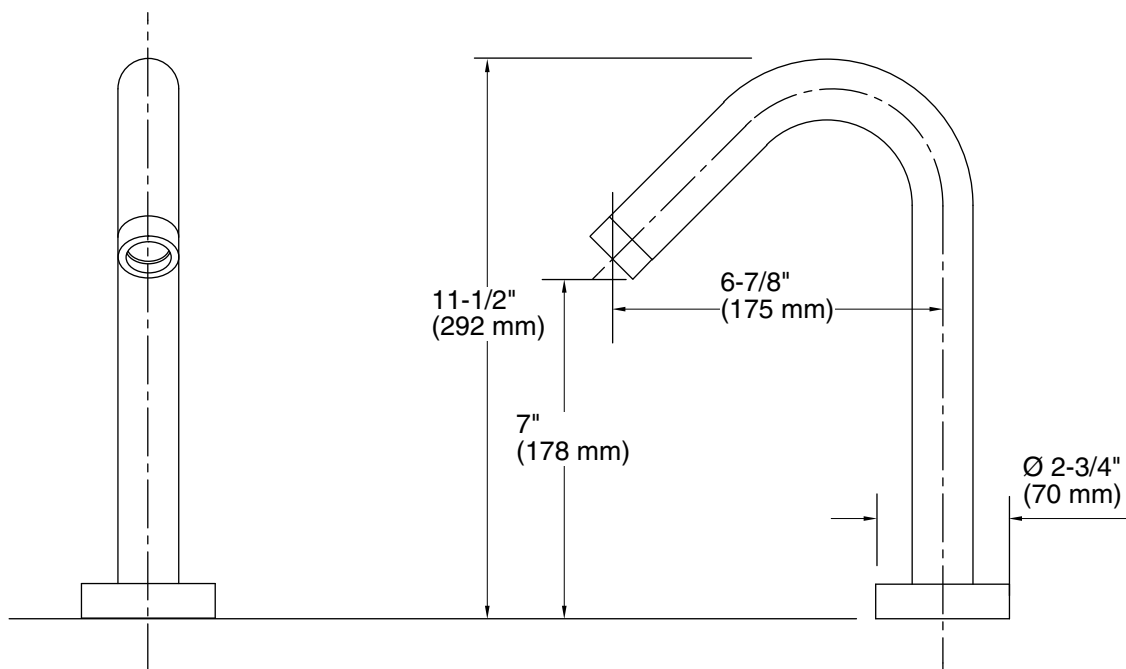

**Product Diagram**