

## Optima Plus® EBF-550

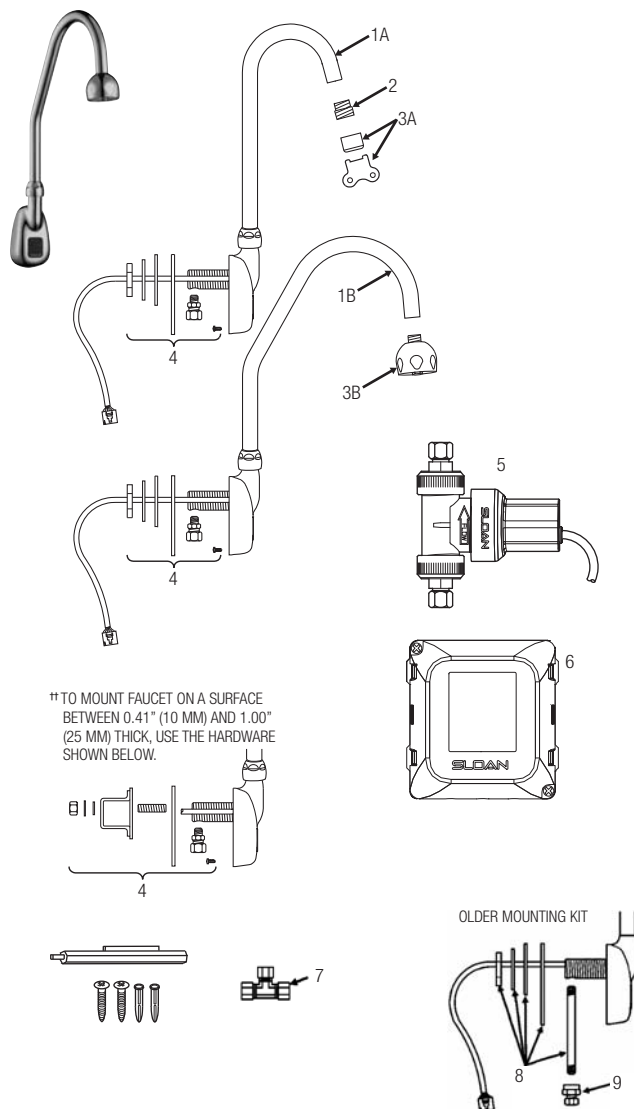

\*\* TO MOUNT FAUCET ON A SURFACE BETWEEN 0.41" (10 MM) AND 1.00" (25 MM) THICK, USE THE HARDWARE SHOWN BELOW.

### New Base Gasket

The new base gasket (in production since October 1999) is shown below. An older base gasket design did not have the u-shaped drainage hole.



### PARTS LIST—EBF-550 FAUCET

Item No.	Code No.	Part No.	Description
1A.	<b>0315224</b>	EBF-222-A-ST	Faucet and Sensor Assembly with Standard Gooseneck Spout (EBF-550)
1B.	<b>0315227</b>	EBF-222-A-SU	Faucet and Sensor Assembly with Surgical Bend Gooseneck Spout (EBF-550-S)
2.	<b>0305784</b>	ETF-178	Adapter for Spray Heads (not required for AC-55-A Shower Spray Head)
3A.	<b>0365147</b>	ETF-621	2.2 gpm (8.3 Lpm) Laminar Flow Spray Head with Key (female thread)
	<b>0365793</b>	ETF-839	0.35 gpm (1.3 Lpm) Multi-Lam Spray Head
	<b>0305927</b>	ETF-435	Replacement Key ONLY
3B.	<b>0328134</b>	AC-55-A	Shower Spray Head Assembly, 2.2 gpm (8.3 Lpm)
4.	<b>0315060</b>	EBF-110-A	Faucet Mounting Kit includes Base Gasket, large Flat Washer, large Lockwasher, large Nut, Mounting Spacer, Mounting Stud, small Flat Washer, small Lockwasher, small Nut, Anti-Rotation Screw, and Compression Fitting Connector (male)
—	<b>0365152</b>	ETF-591	1/8" NPT Pipe to 3/8" Tube Male Compression Fitting Connector
5.	<b>0365758</b>	ETF-740-A	6 VDC Solenoid Assembly
6.	<b>0365752</b>	ETF-735-A	Control Module
7.	<b>3365461</b>	ETF-617-A	Bak-Chek® "T" Assembly

— = Not shown in illustration

For additional information about Sloan Mixing Valves or Trim Plates, consult our Installation Instructions and Maintenance Guides.

### OLD MOUNTING KIT AND FAUCET SHANK

8.	<b>N/A**</b>	EBF-110-A	Old Faucet Mounting Kit included 3/8" Water Supply Tube, Base Gasket, large Flat Washer, large Lock Washer, large Nut, and Compression Fitting Connector (order Items 4 and 10 as replacement parts)
9.	<b>0365058**</b>	ETF-547	1/8" NPT Pipe to 3/8" Tube Female Compression Fitting Connector

The new mounting kit (in production since June 1999; Item 4 shown at left) includes parts for installation on both thin and thick surfaces, an ETF-591 male compression fitting, and an anti-rotation screw for installation on sheet metal surfaces less than 0.41" (10 mm) thick. For surfaces between 0.41" (10 mm) and 1.00" (25 mm) thick, use the mounting spacer and mounting stud hardware. The faucet sensor cable is threaded through a groove on the side of the shank.

The older mounting kits (Items 9 and 10) can be identified by a copper supply tube attached to the faucet shank, requires an ETF-547 compression fitting, and threads the faucet sensor cable through the interior of the shank.

The current parts breakdown shown on the left has been in production since September 2008. For earlier EBF-650/615 faucet models, please refer to the parts breakdown below and right or consult your nearest Sloan representative.

Note: earlier faucet models are not compatible with the current models.

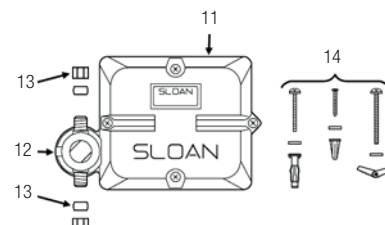

### PARTS PRIOR TO SEPTEMBER 2008

11.	<b>0315104</b>	EBF-60-A	Control Module assembly
12.	<b>0315254</b>	EBF-1011-A	Solenoid replacement kit
13.	<b>3315029</b>	EBF-113-A	Single solenoid supply compression nut kit
14.	<b>3315018</b>	EBF-79-A	Mounting hardware kit