

Large Diameter Tapcon (LDT) Self-threading



SPECIFIED FOR ANCHORAGE INTO CONCRETE

The LDT anchor is a high performance anchor that cuts its own threads into concrete.

Anchor bodies are made of hardened carbon steel and zinc plated.

Grade 5

The anchors shall have a finished hex washer head with anti-rotation serrations to prevent anchor back-out. The head of the anchor is stamped with a length identification code for easy inspection.

The anchor shall be installed with carbide tipped hammer drill bits made in accordance to ANSI B212.15-1994.

LDT 3/8" and 1/2" are available with EnvireX coating

1,000 hours salt spray ASTM B117. Approved for use in ACQ and MCQ lumber*

*Excessive content of copper in the ACQ and MCQ lumber may affect the anchor finish.

LENGTH INDICATION CODE*

CODE	LENGTH OF ANCHOR In. (mm)	
A	1-1/2 < 2	(38.1 < 50.8)
B	2 < 2-1/2	(50.8 < 63.5)
C	2-1/2 < 3	(63.5 < 76.2)
D	3 < 3-1/2	(76.2 < 88.9)
E	3-1/4 < 4	(88.9 < 101.6)
F	4 < 4-1/2	(101.6 < 114.3)
G	4-1/2 < 5	(114.3 < 127.0)
H	5 < 5-1/2	(127.0 < 139.7)

* Located on top of anchor for easy inspection.

Selection Chart

LDT Size	ANSI Standard Drill Bit Diameter	Anchor Head (Socket Size) Diameter	Washer Diameter	Minimum Embedment	Hole Depth	USE IN		
						Concrete	CMU	
							Hollow	Grout-filled
LDT 3/8"	5/16"	9/16"	13/16"	1-1/2"	2-1/2"	YES	YES	YES
LDT 1/2"	7/16"	3/4"	1"	2-1/2"	3-1/2"	YES	NO	YES
LDT 5/8"	1/2"	13/16"	1-3/16"	2-3/4"	3-3/4"	YES	NO	YES
LDT 3/4"	5/8"	15/16"	1-5/16"	3-1/4"	4-1/4"	YES	NO	YES

© See catalog for effective lengths and length indication code.

INSTALLATION STEPS

Installation Steps for Concrete, Lightweight Concrete and Metal Deck

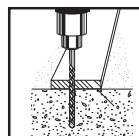

1. Using the proper size carbide bit (see chart) drill a pilot hole at least 1" deeper than anchor embedment.

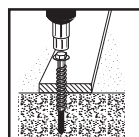

2. Using an **electric impact wrench**, or socket wrench (hand install) insert anchor into hole and tighten anchor until fully seated. (see chart for socket size) (do not over tighten).

Installation Steps for Hollow or Grout-Filled CMU (3/8" and 1/2" diameter)

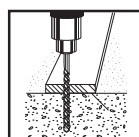

1. Using a 5/16" (for 3/8" LDT) or 7/16" (for 1/2" LDT) carbide tipped bit, drill a pilot hole at least 1" deeper than anchor embedment.

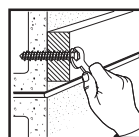

2. Using a socket wrench insert anchor into hole and hand tighten (only) anchor until fully seated. (9/16" socket for 3/8" and 3/4" socket for 1/2") (do not over tighten).



LDT's can be installed by hand or with an impact wrench

Installation by hand—is easy, simply using a socket wrench



Installation by impact wrench—is recommended for faster installations or for high volume projects. Installation with impact wrench—is **not** recommended for hollow block.

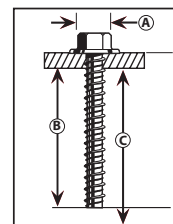

PERFORMANCE TABLES

LDT Anchors Ultimate Tension and Shear Values (Lbs/kN) in Concrete

ANCHOR DIA. In. (mm)	EMBEDMENT DEPTH In. (mm)	f'c = 2000 PSI (13.8 MPa)		f'c = 3000 PSI (20.7 MPa)		f'c = 4000 PSI (27.6 MPa)	
		TENSION Lbs. (kN)	SHEAR Lbs. (kN)	TENSION Lbs. (kN)	SHEAR Lbs. (kN)	TENSION Lbs. (kN)	SHEAR Lbs. (kN)
3/8 (9.5)	1-1/2 (38.1)	1,336 (5.9)	2,108 (9.4)	1,652 (7.3)	2,764 (12.3)	1,968 (8.8)	3,416 (15.2)
	2 (50.8)	1,492 (6.6)	3,036 (13.5)	2,024 (9.0)	3,228 (14.4)	2,552 (11.4)	3,420 (15.2)
	2-1/2 (63.5)	3,732 (16.6)	3,312 (14.7)	3,748 (16.7)	3,364 (15.0)	3,760 (16.7)	3,424 (15.2)
	3-1/2 (88.9)	5,396 (24.0)	3,312 (14.7)	6,624 (29.5)	3,368 (15.0)	7,852 (34.9)	3,428 (15.2)
1/2 (12.7)	2 (50.8)	3,580 (15.9)	5,644 (25.1)	3,908 (17.4)	6,512 (29.0)	4,236 (18.8)	7,380 (32.8)
	3-1/2 (88.9)	7,252 (32.3)	6,436 (28.6)	8,044 (35.8)	7,288 (32.4)	8,836 (39.3)	8,140 (36.2)
	4-1/2 (114.3)	10,176 (45.3)	7,384 (32.8)	10,332 (46.0)	7,968 (35.4)	10,488 (46.7)	8,552 (38.0)
5/8 (15.9)	2-3/4 (69.9)	5,276 (23.5)	8,656 (38.5)	6,560 (29.2)	11,064 (49.2)	7,844 (34.8)	13,476 (59.9)
	3-1/2 (88.9)	7,972 (35.5)	10,224 (45.5)	9,848 (43.8)	12,144 (54.0)	11,724 (52.2)	14,060 (62.5)
	4-1/2 (114.3)	11,568 (51.5)	12,316 (54.8)	13,432 (59.8)	13,580 (60.4)	16,892 (75.1)	14,840 (66.0)
3/4 (19.1)	3-1/4 (82.6)	6,876 (30.6)	7,140 (31.8)	9,756 (43.4)	10,728 (47.7)	12,636 (56.2)	14,316 (63.6)
	4-1/2 (114.3)	10,304 (45.8)	13,120 (58.4)	14,424 (64.2)	16,868 (75.0)	18,540 (82.5)	20,612 (91.7)
	5-1/2 (139.7)	13,048 (58.0)	17,908 (79.7)	18,156 (80.8)	21,718 (96.9)	23,268 (130.5)	25,652 (114.1)

LDT Anchors Allowable Tension and Shear Values* (Lbs/kN) in Concrete Carbon and Stainless Steel

ANCHOR DIA. In. (mm)	EMBEDMENT DEPTH In. (mm)	f'c = 2000 PSI (13.8 MPa)		f'c = 3000 PSI (20.7 MPa)		f'c = 4000 PSI (27.6 MPa)	
		TENSION Lbs. (kN)	SHEAR Lbs. (kN)	TENSION Lbs. (kN)	SHEAR Lbs. (kN)	TENSION Lbs. (kN)	SHEAR Lbs. (kN)
3/8 (9.5)	1-1/2 (38.1)	334 (1.5)	527 (2.3)	413 (1.8)	691 (3.1)	492 (2.1)	854 (3.8)
	2 (50.8)	373 (1.7)	759 (3.4)	506 (2.2)	807 (3.6)	638 (2.8)	855 (3.8)
	2-1/2 (63.5)	933 (4.2)	828 (3.7)	937 (4.2)	841 (3.7)	940 (4.2)	856 (3.8)
	3-1/2 (88.9)	1,349 (6.0)	828 (3.7)	1,656 (7.4)	842 (3.7)	1,963 (8.7)	857 (3.8)
1/2 (12.7)	2 (50.8)	895 (4.0)	1,411 (6.3)	977 (4.3)	1,628 (7.2)	1,059 (4.7)	1,845 (8.2)
	3-1/2 (88.9)	1,813 (8.0)	1,609 (7.2)	2,011 (8.9)	1,822 (8.1)	2,209 (9.8)	2,035 (9.0)
	4-1/2 (114.3)	2,544 (11.3)	1,846 (8.2)	2,583 (11.5)	1,992 (8.9)	2,622 (11.7)	2,138 (9.5)
5/8 (15.9)	2-3/4 (69.9)	1,319 (5.9)	2,164 (9.7)	1,640 (7.3)	2,766 (12.3)	1,961 (8.7)	3,369 (15.0)
	3-1/2 (88.9)	1,993 (8.9)	2,556 (11.4)	2,462 (10.9)	3,036 (13.5)	2,931 (13.0)	3,515 (15.6)
	4-1/2 (114.3)	2,892 (12.9)	3,079 (13.7)	3,358 (14.9)	3,395 (15.1)	4,223 (18.8)	3,710 (16.5)
3/4 (19.1)	3-1/4 (82.6)	1,719 (7.6)	1,785 (7.9)	2,439 (10.8)	2,682 (11.9)	3,159 (14.0)	3,579 (15.9)
	4-1/2 (114.3)	2,576 (11.5)	3,280 (14.6)	3,606 (16.0)	4,217 (18.7)	4,635 (20.6)	5,153 (22.9)
	5-1/2 (139.7)	3,262 (14.5)	4,477 (19.9)	4,539 (20.2)	5,445 (24.2)	5,817 (25.9)	6,413 (28.5)

* Allowable values are based upon a 4 to 1 safety factor. (Ultimate/4)

LDT Anchors Recommended Edge & Spacing Requirements for Tension Loads* Carbon and Stainless Steel

ANCHOR DIA. In. (mm)	EMBEDMENT DEPTH In. (mm)	EDGE DISTANCE REQUIRED TO OBTAIN MAX. WORKING LOAD In. (mm)	LOAD FACTOR APPLIED AT MIN. EDGE DISTANCE 1-3/4 Inches (44mm)	SPACING DISTANCE REQUIRED TO OBTAIN MAX. WORKING LOAD In. (mm)	LOAD FACTOR APPLIED AT MIN. SPACING DISTANCE 3 Inches (76mm)
3/8 (9.5)	1-1/2 (38.1)	2 (50.8)	70%	6 (152.4)	44%
	2 (50.8)	2 (50.8)	70%	6 (152.4)	44%
	2-1/2 (63.5)	3 (76.2)	70%	6 (152.4)	44%
	3-1/2 (88.9)	4 (101.6)	70%	6 (152.4)	44%
1/2 (12.7)	2 (50.8)	2-1/4 (57.2)	65%	8 (203.2)	27%
	3-1/2 (88.9)	3 (76.2)	65%	8 (203.2)	27%
	4-1/2 (114.3)	4 (101.6)	65%	8 (203.2)	27%

* Edge and spacing distance shall be divided by .75 when anchors are placed in structural lightweight concrete. Linear interpolation may be used for intermediate spacing and edge distances.

For 5/8" and 3/4" LDT Anchors, the critical edge distance for these anchors is 10 times the anchor diameter. The edge distance of these anchors may be reduced to 1-3/4" provided a 0.65 load factor is used for tension loads, a 0.15 load factor is used for shear loads applied perpendicular to the edge, or a 0.60 load factor is used for shear loads applied parallel to the edge. Linear interpolation may be used for intermediate edge distances.

PERFORMANCE TABLES

LDT Anchors

Recommended Edge & Spacing Requirements for Shear Loads* Carbon and Stainless Steel

ANCHOR DIA. In. (mm)	EMBEDMENT DEPTH In. (mm)	EDGE DISTANCE REQUIRED TO OBTAIN MAX. WORKING LOAD In. (mm)	LOAD FACTOR APPLIED AT MIN. EDGE DISTANCE 1-3/4 Inches (44mm)	SPACING DISTANCE REQUIRED TO OBTAIN MAX. WORKING LOAD In. (mm)	LOAD FACTOR APPLIED AT MIN. SPACING DISTANCE 3 Inches (76mm)
3/8 (9.5)	1-1/2 (38.1)	3 (76.2)	25%	6 (152.4)	57%
	2 (50.8)	4 (101.6)	25%	6 (152.4)	57%
	2-1/2 (63.5)	5 (127.0)	25%	6 (152.4)	57%
	3-1/2 (88.9)	5 (127.0)	25%	6 (152.4)	57%
1/2 (12.7)	2 (50.8)	5 (127.0)	25%	8 (203.2)	60%
	3-1/2 (88.9)	5 (127.0)	25%	8 (203.2)	60%
	4-1/2 (114.3)	5-1/2 (139.7)	25%	8 (203.2)	60%

* Edge and spacing distances shall be divided by .75 when anchors are placed in structural lightweight concrete. Linear interpolation may be used for intermediate spacing and edge distances.

LDT Anchors

Ultimate Tension Load (Lbs/kN) in Concrete Block (anchors should be installed by hand in hollow block)

ANCHOR DIA. In. (mm)	EMBEDMENT DEPTH In. (mm)	HOLLOW CONCRETE BLOCK		GROUT FILLED CONCRETE BLOCK	
		TENSION Lbs. (kN)	SHEAR Lbs. (kN)	TENSION Lbs. (kN)	SHEAR Lbs. (kN)
3/8 (9.5)	1-1/2 (38.1)	916 (4.1)	3,176 (14.1)	1,592 (7.1)	3,900 (17.3)
1/2 (12.7)	2-1/2 (63.5)	N/A	N/A	5,924 (26.4)	6,680 (29.7)

LDT Anchors

Allowable Tension and Shear* (Lbs/kN) in Concrete Block (anchors should be installed by hand in hollow block)

ANCHOR DIA. In. (mm)	EMBEDMENT DEPTH In. (mm)	HOLLOW CONCRETE BLOCK		GROUT FILLED CONCRETE BLOCK	
		TENSION Lbs. (kN)	SHEAR Lbs. (kN)	TENSION Lbs. (kN)	SHEAR Lbs. (kN)
3/8 (9.5)	1-1/2 (38.1)	229 (1.0)	794 (3.5)	398 (1.8)	975 (4.3)
1/2 (12.7)	2-1/2 (63.5)	N/A	N/A	1,481 (6.6)	1,670 (7.4)

*Allowable values are based upon a 4 to 1 safety factor. (Ultimate/4)

LDT Anchors

Anchoring Overhead in 3000 PSI Lightweight Concrete On Metal Deck

ANCHOR In. (mm)	DRILL HOLE DIAMETER In. (mm)	EMBEDMENT In. (mm) Lbs. (kN)	3000PSI (20.7 MPa) CONCRETE	
			ULTIMATE TENSION LOAD Lbs. (kN)	ALLOWABLE WORKING LOAD
3/8" LDT	5/16 (7.9)	1-1/2 (38.1)	Upper Flute	722 (3.2)
			Lower Flute	465 (2.1)

