

INSTALLATION STEPS FOR REDI-DRIVE

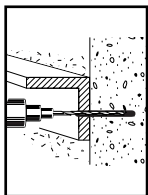

1. Drill a 3/16" diameter hole (1/4" for 3/8" pipe drive) at a minimum depth (see chart) and clean hole.

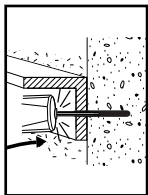

2. Insert anchor through material to be fastened (insert tie-wire or pipe version Redi-Drive Anchors into drilled holes) and drive anchor with a 3-lb. hammer until the head is flush with surface or desired embedment.

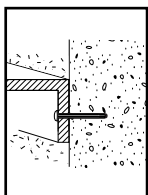

3. Anchor is now set.

INSTALLATION STEPS FOR REDI-TIE-DRIVE

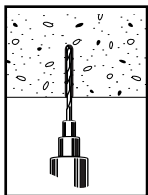

1. Drill 3/16" diameter hole in concrete.

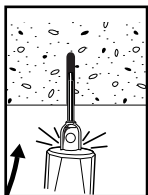

2. Hammer in flat side of Redi-Drive 1-1/4".

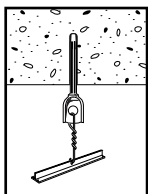

3. The Redi-Drive is set. Tie acoustical or electrical drop wire to open hole.

INSTALLATION STEPS FOR REDI-PIPE-DRIVE

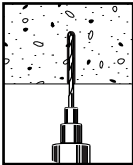

1. Drill 3/16" diameter hole for 1/4" anchor (1/4" diameter hole for 3/8" anchor).

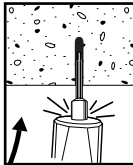

2. Hammer in anchor 1-1/4" for 1/4" anchor (1-3/4" for 3/8" anchor).

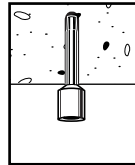

3. The Redi-Drive is set. Run 1/4" or 3/8" threaded rod or bolt into anchor.