

# HARCO PVC C-900 GASKETED FITTINGS

## DESIGN DATA

### BELL SPECIFICATIONS

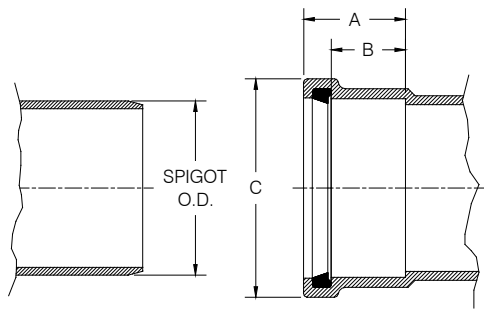

| SIZE | STYLE | A   | B   | C    | Spigot O.D. |
|------|-------|-----|-----|------|-------------|
| 4    | M     | 4.3 | 3.1 | 6.3  | 4.80        |
| 6    | M     | 4.8 | 3.5 | 8.6  | 6.90        |
| 8    | M     | 5.4 | 4.0 | 11.0 | 9.05        |
| 10   | F     | 9.0 | 5.0 | 13.0 | 11.10       |
| 12   | F     | 9.5 | 5.5 | 15.5 | 13.20       |

### COUPLING

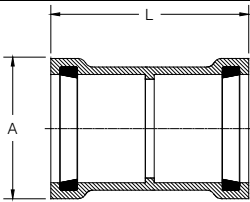

| SIZE | PART #  | STYLE | A    | L    | WT (approx.) |
|------|---------|-------|------|------|--------------|
| 4    | 18-0804 | M     | 6.3  | 8.9  | 2.9          |
| 6    | 18-0806 | M     | 8.3  | 10.0 | 6.0          |
| 8    | 18-0808 | M     | 11.0 | 11.0 | 11.5         |
| 10   | 18-0810 | M C   | 13.0 | 19.7 | 27           |
| 12   | 18-0812 | M C   | 15.5 | 22.3 | 40           |

### REPAIR COUPLING

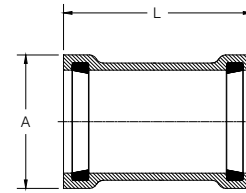

| SIZE | PART #  | STYLE | A    | L    | WT (approx.) |
|------|---------|-------|------|------|--------------|
| 4    | 18-0904 | M     | 6.3  | 8.9  | 3.4          |
| 6    | 18-0906 | M     | 8.6  | 10.0 | 6.7          |
| 8    | 18-0908 | M     | 11.0 | 11.3 | 12.5         |
| 10   | 18-0910 | M C   | 13.0 | 11.3 | 22           |
| 12   | 18-0912 | M C   | 15.5 | 12.1 | 36           |

### TAPPED TEE (FNPT Thread)

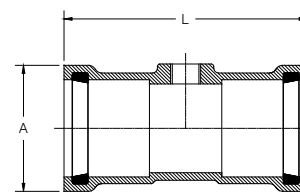

| SIZE      | PART #    | STYLE | A    | L    | WT (approx.) |
|-----------|-----------|-------|------|------|--------------|
| 4 x 3/4   | 18-510403 | M     | 6.9  | 12.0 | 5.0          |
| 4 x 1     | 18-510404 | M     | 6.9  | 12.0 | 5.0          |
| 4 x 1 1/2 | 18-510406 | M     | 6.9  | 12.0 | 5.0          |
| 4 x 2     | 18-510408 | M     | 6.9  | 12.0 | 5.0          |
| 6 x 3/4   | 18-510603 | M     | 8.5  | 13.0 | 9.2          |
| 6 x 1     | 18-510604 | M     | 8.5  | 13.0 | 9.2          |
| 6 x 1 1/2 | 18-510606 | M     | 8.5  | 13.0 | 9.2          |
| 6 x 2     | 18-510608 | M     | 8.5  | 13.0 | 9.2          |
| 8 x 3/4   | 18-510803 | M     | 11.0 | 14.9 | 16.0         |
| 8 x 1     | 18-510804 | M     | 11.0 | 14.9 | 16.0         |
| 8 x 1 1/2 | 18-510806 | M     | 11.0 | 14.9 | 16.0         |
| 8 x 2     | 18-510808 | M     | 11.0 | 14.9 | 16.0         |

### TAPPED TEE (AWWA Thread)

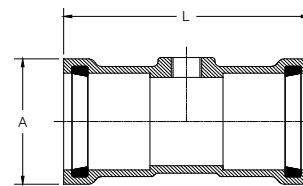

| SIZE    | PART #    | STYLE | A    | L    | WT (approx.) |
|---------|-----------|-------|------|------|--------------|
| 4 x 3/4 | 18-520403 | M     | 6.9  | 12.0 | 4.3          |
| 4 x 1   | 18-520404 | M     | 6.9  | 12.0 | 4.3          |
| 4 x 2   | 18-520408 | M     | 6.9  | 12.0 | 4.3          |
| 6 x 3/4 | 18-520603 | M     | 8.5  | 13.3 | 8.5          |
| 6 x 1   | 18-520604 | M     | 8.5  | 13.3 | 8.5          |
| 6 x 2   | 18-520608 | M     | 8.5  | 13.3 | 8.5          |
| 8 x 3/4 | 18-520803 | M     | 11.0 | 14.9 | 15.0         |
| 8 x 1   | 18-520804 | M     | 11.0 | 14.9 | 15.0         |
| 8 x 2   | 18-520808 | M     | 11.0 | 14.9 | 15.0         |

#### Notes:

- All lay lengths & weights are approximate and are subject to change without notice
- Fabricated fitting configurations may vary

#### Style Legend:

- M - Molded fittings are Pressure Class 150 unless otherwise noted
- C - Machined from extruded stock as manufactured by North American Pipe
- F - Fabricated fittings are made from sections of C-900 pipe and are not pressure rated

The use of anything but properly designed and installed thrust blocks will reduce the life of plastic fittings. Thrust blocks must be of poured concrete only and sized for the soil conditions. Mechanical joint restraint products may also be considered for use.

**WARNING:** Frequent or high amplitude pressure surges (water hammer) can reduce the life of PVC fittings. Refer to AWWA C907.

Call For Other Sizes, Configurations & Gasket Materials



### THE HARRINGTON CORPORATION

P.O. BOX 10335 • LYNCHBURG, VIRGINIA 24506 • 3721 COHEN PLACE • LYNCHBURG, VIRGINIA 24501  
 PHONE: (434) 845-7094 • FAX: (434) 845-8562 • E-MAIL: sales@harcofittings.com • WEB: www.harcofittings.com

20180402

# HARCO PVC C-900 GASKETED FITTINGS

## DESIGN DATA

### CAP

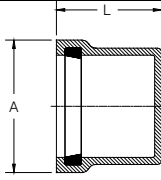

(Molded fitting shown)

For this item do not use joint restraint, poured concrete thrust blocks only

| SIZE | PART #  | STYLE | A    | L    | WT (approx.) |
|------|---------|-------|------|------|--------------|
| 4    | 18-4904 | M     | 6.3  | 4.5  | 2.1          |
| 6    | 18-4906 | M     | 8.6  | 5.2  | 4.5          |
| 8    | 18-4908 | M     | 11.0 | 6.0  | 8.5          |
| 6    | 18-5006 | M     | 8.0  | 5.0  | 4.5          |
| 10   | 18-4910 | F     | 13.0 | 13.7 | 7.0          |
| 12   | 18-4912 | F     | 15.5 | 17.8 | 10.0         |

### REDUCER (S x G)

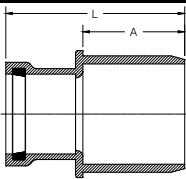

(Molded fitting shown)

| SIZE    | PART #    | STYLE | A    | L    | WT (approx.) |
|---------|-----------|-------|------|------|--------------|
| 6 x 4   | 18-160604 | M     | 4.7  | 9.4  | 4.0          |
| 8 x 6   | 18-160806 | M     | 5.3  | 10.5 | 7.7          |
| 8 x 4   | 18-160804 | F     | 8.0  | 16.2 | 14.0         |
| 10 x 4  | 18-161004 | F     | 9.6  | 18.3 | 22.0         |
| 10 x 6  | 18-161006 | F     | 11.0 | 20.5 | 28.0         |
| 10 x 8  | 18-161008 | F     | 10.5 | 20.7 | 27.0         |
| 12 x 4  | 18-161204 | F     | 9.6  | 20.3 | 35.0         |
| 12 x 6  | 18-161206 | F     | 11.4 | 21.9 | 38.0         |
| 12 x 8  | 18-161208 | F     | 10.5 | 23.7 | 45.0         |
| 12 x 10 | 18-161210 | F     | 10.5 | 24.0 | 43.0         |

### FLANGE ADAPTER (G x F)

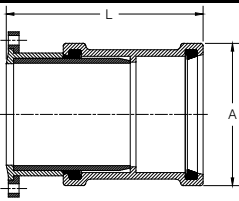

These fittings use SCH-40/80 PVC fittings which DO NOT HAVE LONG TERM PRESSURE RATINGS. Use of these fittings in pressure systems is at users' risk. Internal joint is not restrained and therefore does not transfer load.

| SIZE | PART #  | STYLE | A    | L    | WT (approx.) |
|------|---------|-------|------|------|--------------|
| 4    | 18-5404 | M     | 6.3  | 11.5 | 7.3          |
| 6    | 18-5406 | M     | 8.6  | 13.3 | 14.2         |
| 8    | 18-5408 | M     | 11.0 | 15.8 | 25.7         |

#### Notes:

- All lay lengths & weights are approximate and are subject to change without notice
- Fabricated fitting configurations may vary

#### Style Legend:

- M - Molded fittings are Pressure Class 150 unless otherwise noted
- F - Fabricated fittings are made from sections of C-900 pipe and are not pressure rated
- FTO - Fabricated To Order

### REDUCER (G x G)

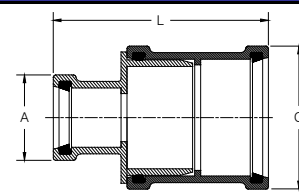

(Molded fitting shown)

| SIZE    | PART #    | STYLE | A    | C    | L    | WT (approx.) |
|---------|-----------|-------|------|------|------|--------------|
| 6 x 4   | 18-170604 | M     | 6.3  | 8.6  | 13.6 | 10.4         |
| 8 x 6   | 18-170806 | M     | 8.6  | 11.0 | 15.3 | 19.6         |
| 8 x 4   | 18-170804 | F     | 6.3  | 11.0 | 18.5 | 14.0         |
| 10 x 4  | 18-171004 | F     | 6.3  | 13.0 | 23.1 | 22.0         |
| 10 x 6  | 18-171006 | F     | 8.6  | 13.0 | 25.4 | 28.0         |
| 10 x 8  | 18-171008 | F     | 11.0 | 13.0 | 25.5 | 27.0         |
| 12 x 4  | 18-171204 | F     | 6.3  | 15.5 | 25.5 | 35.0         |
| 12 x 6  | 18-171206 | F     | 8.6  | 15.5 | 27.0 | 38.0         |
| 12 x 8  | 18-171208 | F     | 11.0 | 15.5 | 28.9 | 45.0         |
| 12 x 10 | 18-171210 | F     | 13.0 | 15.5 | 29.0 | 43.0         |

### MALEHOLE ADAPTER (Double Bell - No Stop)

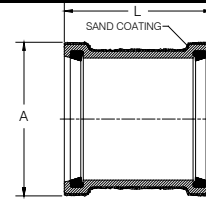

(Molded fitting shown)

| SIZE | PART #  | STYLE | A    | L    | WT (approx.) |
|------|---------|-------|------|------|--------------|
| 4    | 18-5704 | M     | 8.9  | 6.5  | 3.4          |
| 6    | 18-5706 | M     | 10.0 | 8.8  | 8.0          |
| 8    | 18-5706 | M     | 11.3 | 11.2 | 15.0         |
| 10   | 18-5710 | F     | 13.3 | 18.0 | 24.0         |
| 12   | 18-5712 | F     | 15.8 | 18.0 | 28.0         |

### MALEHOLE ADAPTER (Single Bell - No Stop)

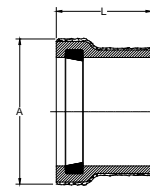

| SIZE | PART #  | STYLE | A    | L   | WT (approx.) |
|------|---------|-------|------|-----|--------------|
| 8    | 18-5808 | FTO   | 11.1 | 5.7 | 6.3          |
| 10   | 18-5810 | FTO   | 13.1 | 9.0 | 11.0         |
| 12   | 18-5812 | FTO   | 15.6 | 9.0 | 18.0         |

### CLEAN-OUT ADAPTER (Hub)

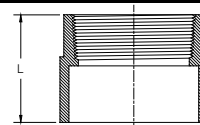

(Non-Pressure)

| SIZE | PART #  | STYLE            | L   | WT (approx.) |
|------|---------|------------------|-----|--------------|
| 4    | 18-5904 | M (Solvent Weld) | 3.3 | 0.6          |
| 6    | 18-5906 | M (Solvent Weld) | 4.4 | 1.3          |

Call For Other Sizes, Configurations & Gasket Materials



### THE HARRINGTON CORPORATION

P.O. BOX 10335 • LYNCHBURG, VIRGINIA 24506 • 3721 COHEN PLACE • LYNCHBURG, VIRGINIA 24501  
 PHONE: (434) 845-7094 • FAX: (434) 845-8562 • E-MAIL: sales@harcofittings.com • WEB: www.harcofittings.com

# HARCO PVC C-900 GASKETED FITTINGS

## DESIGN DATA

### 90° BEND (G x G)

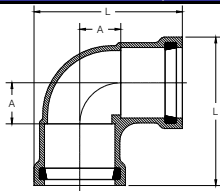

(Molded fitting shown)

| SIZE | PART #  | STYLE | A    | L    | WT (approx.) |
|------|---------|-------|------|------|--------------|
| 4    | 18-1804 | M     | 2.8  | 10.3 | 6.0          |
| 6    | 18-1806 | M     | 3.9  | 13.1 | 12.0         |
| 8    | 18-1808 | M     | 5.1  | 16.0 | 23.0         |
| 10   | 18-1810 | F     | 12.0 | 28.5 | 52.0         |
| 12   | 18-1812 | F     | 14.0 | 34.5 | 80.0         |

### 11¼° BEND (G x G)

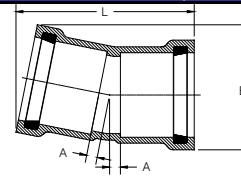

(Molded fitting shown)

| SIZE | PART #  | STYLE | A   | B    | L    | WT (approx.) |
|------|---------|-------|-----|------|------|--------------|
| 4    | 18-2804 | M     | 0.6 | 7.3  | 10.5 | 3.8          |
| 6    | 18-2806 | M     | 0.8 | 9.3  | 12.0 | 7.5          |
| 8    | 18-2808 | M     | 0.9 | 11.8 | 13.5 | 13.1         |
| 10   | 18-2810 | F     | 1.0 | 14.0 | 26.0 | 34.0         |
| 12   | 18-2812 | F     | 1.0 | 15.5 | 28.5 | 55.0         |

### 45° BEND (G x G)

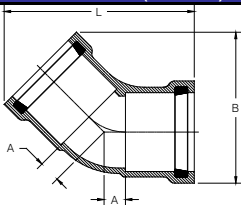

(Molded fitting shown)

| SIZE | PART #  | STYLE | A   | B    | L    | WT (approx.) |
|------|---------|-------|-----|------|------|--------------|
| 4    | 18-2204 | M     | 1.3 | 9.9  | 11.5 | 4.1          |
| 6    | 18-2206 | M     | 1.8 | 12.6 | 14.0 | 8.2          |
| 8    | 18-2208 | M     | 2.2 | 14.8 | 16.8 | 16.1         |
| 10   | 18-2210 | F     | 8.8 | 22.5 | 26.0 | 42.0         |
| 12   | 18-2212 | F     | 8.9 | 23.0 | 29.0 | 68.0         |

### 90° BEND (G x S)

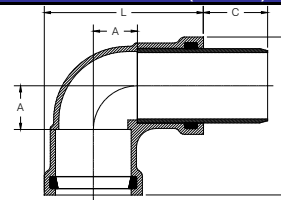

(Molded fitting shown)

| SIZE | PART #  | STYLE | A    | B    | C    | L    | WT (approx.) |
|------|---------|-------|------|------|------|------|--------------|
| 4    | 18-1904 | MA    | 2.8  | 10.3 | 4.3  | 10.3 | 6.0          |
| 6    | 18-1906 | MA    | 3.9  | 13.1 | 4.5  | 13.1 | 12.0         |
| 8    | 18-1908 | MA    | 5.1  | 16.0 | 4.8  | 16.0 | 23.0         |
| 10   | 18-1910 | F     | 12.0 | 28.5 | 10.5 | 28.5 | 45.0         |
| 12   | 18-1912 | F     | 14.0 | 34.5 | 10.5 | 34.5 | 70.0         |

### 22½° BEND (G x G)

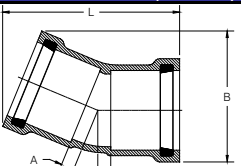

(Molded fitting shown)

| SIZE | PART #  | STYLE | A   | B    | L    | WT (approx.) |
|------|---------|-------|-----|------|------|--------------|
| 4    | 18-2404 | M     | 0.8 | 8.0  | 11.0 | 4.0          |
| 6    | 18-2406 | M     | 1.1 | 10.3 | 13.0 | 8.0          |
| 8    | 18-2408 | M     | 1.3 | 13.3 | 15.0 | 15.0         |
| 10   | 18-2410 | F     | 6.6 | 16.0 | 26.8 | 36.0         |
| 12   | 18-2412 | F     | 7.8 | 19.3 | 28.5 | 60.0         |

### 45° BEND (G x S)

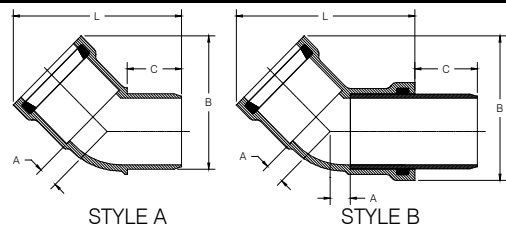

(Molded fitting shown)

| SIZE | PART #  | STYLE  | A   | B    | C    | L    | WT (approx.) |
|------|---------|--------|-----|------|------|------|--------------|
| 4    | 18-2304 | (A) M  | 1.3 | 9.9  | 3.6  | 11.5 | 3.5          |
| 6    | 18-2306 | (A) M  | 1.8 | 12.6 | 3.8  | 14.0 | 7.7          |
| 8    | 18-2308 | (B) MA | 2.2 | 14.8 | 4.8  | 16.8 | 16.1         |
| 10   | 18-2310 | F      | 8.8 | 22.5 | 10.5 | 26.0 | 35.0         |
| 12   | 18-2312 | F      | 8.9 | 23.0 | 10.5 | 29.0 | 58.0         |

Call For Other Sizes, Configurations & Gasket Materials

#### Notes:

- All lay lengths & weights are approximate and are subject to change without notice
- Fabricated fitting configurations may vary

#### Style Legend:

- F - Fabricated fittings are made from sections of C-900 pipe and are not pressure rated
- M - Molded fittings are Pressure Class 150 unless otherwise noted
- MA - Assembled from molded or extruded components

### 22½° BEND (G x S)

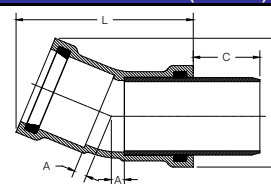

(Molded fitting shown)

| SIZE | PART #  | STYLE | A   | B    | C    | L    | WT (approx.) |
|------|---------|-------|-----|------|------|------|--------------|
| 4    | 18-2504 | MA    | 0.8 | 8.0  | 4.3  | 11.0 | 4.0          |
| 6    | 18-2506 | MA    | 1.1 | 10.3 | 4.5  | 13.0 | 8.0          |
| 8    | 18-2508 | MA    | 1.3 | 13.3 | 4.8  | 15.0 | 15.0         |
| 10   | 18-2510 | F     | 6.6 | 15.5 | 10.5 | 26.8 | 35.0         |
| 12   | 18-2512 | F     | 7.8 | 19.5 | 10.5 | 28.5 | 58.0         |



#### THE HARRINGTON CORPORATION

P.O. BOX 10335 • LYNCHBURG, VIRGINIA 24506 • 3721 COHEN PLACE • LYNCHBURG, VIRGINIA 24501  
 PHONE: (434) 845-7094 • FAX: (434) 845-8562 • E-MAIL: sales@harcofittings.com • WEB: www.harcofittings.com

20180402

# HARCO PVC C-900 GASKETED FITTINGS

## DESIGN DATA

### 11¼° BEND (G x S)

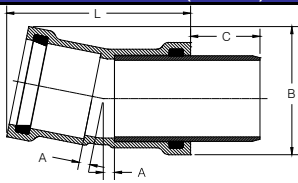

(Molded fitting shown)

| SIZE | PART #  | STYLE | A   | B    | C    | L    | WT (approx.) |
|------|---------|-------|-----|------|------|------|--------------|
| 4    | 18-2904 | MA    | 0.6 | 7.3  | 4.3  | 10.5 | 3.8          |
| 6    | 18-2906 | MA    | 0.8 | 9.3  | 4.5  | 12.0 | 7.5          |
| 8    | 18-2908 | MA    | 0.9 | 11.8 | 4.75 | 13.5 | 13.1         |
| 10   | 18-2910 | F     | 1.0 | 14.0 | 10.5 | 14.5 | 33.0         |
| 12   | 18-2912 | F     | 1.0 | 15.5 | 10.5 | 16.3 | 53.0         |

### 45° WYE (G x G x G) (continued)

| SIZE    | PART #    | STYLE | C    | L    | WT (approx.) |
|---------|-----------|-------|------|------|--------------|
| 8 x 4   | 18-010804 | M     | 9.7  | 19.0 | 23.5         |
| 8 x 6   | 18-010806 | M     | 10.2 | 21.8 | 27.0         |
| 8 x 8   | 18-010808 | F     | 10.0 | 34.4 | 39.0         |
| 10 x 4  | 18-011004 | F     | 9.8  | 31.0 | 40.0         |
| 10 x 6  | 18-011006 | F     | 9.7  | 33.5 | 48.0         |
| 10 x 8  | 18-011008 | F     | 10.2 | 36.5 | 53.0         |
| 10 x 10 | 18-011010 | F     | 11.4 | 39.5 | 53.0         |
| 12 x 4  | 18-011204 | F     | 10.7 | 34.0 | 61.0         |
| 12 x 6  | 18-011206 | F     | 11.2 | 36.8 | 70.0         |
| 12 x 8  | 18-011208 | F     | 11.7 | 39.8 | 81.0         |
| 12 x 10 | 18-011210 | F     | 12.9 | 42.5 | 97.0         |
| 12 x 12 | 18-011212 | F     | 15.4 | 46.5 | 114.0        |

### 45° WYE – C900 x Sewer (G x G x G)

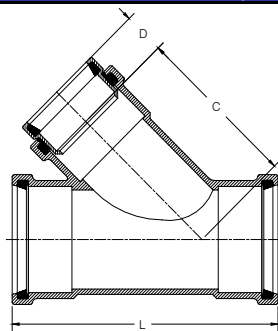

(Non-pressure)

(Molded fitting shown)

| SIZE  | PART #     | STYLE | C    | D   | L    | WT (approx.) |
|-------|------------|-------|------|-----|------|--------------|
| 4 x 4 | 18-6650404 | MA    | 6.8  | 2.7 | 16.8 | 9.0          |
| 6 x 4 | 18-6650604 | MA    | 9.6  | 2.7 | 21.3 | 16.0         |
| 6 x 6 | 18-6650606 | MA    | 9.6  | 3.5 | 21.3 | 21.0         |
| 8 x 4 | 18-6650804 | M     | 10.2 | 2.7 | 21.8 | 29.1         |
| 8 x 6 | 18-6650806 | M     | 10.2 | 3.5 | 21.8 | 29.0         |
| 8 x 8 | 18-6650808 | FTO   | 14.0 | 4.0 | 34.4 | 60.0         |

### ADAPTER – C900 x Sewer (G x G)

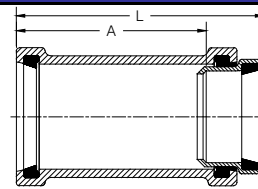

(Non-pressure)

(Molded fitting shown)

| SIZE | PART #   | STYLE | A    | L    | WT (approx.) |
|------|----------|-------|------|------|--------------|
| 4    | 18-39004 | M     | 7.4  | 10.0 | 2.0          |
| 6    | 18-39006 | M     | 7.6  | 11.1 | 2.0          |
| 8    | 18-39008 | M     | 8.7  | 12.5 | 7.5          |
| 10   | 18-39010 | F     | 12.0 | 19.5 | 12.0         |
| 12   | 18-39012 | F     | 13.5 | 21.0 | 18.0         |

### ADAPTER – C900 x Sewer (S x G)

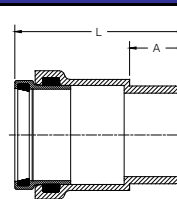

STYLE-A

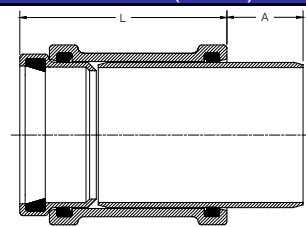

STYLE-B

(Non-pressure)

(Molded fitting shown)

| SIZE | PART #   | STYLE | A    | L    | WT (approx.) |
|------|----------|-------|------|------|--------------|
| 4    | 18-39204 | (A) M | 2.7  | 8.2  | 4.0          |
| 6    | 18-39206 | (A) M | 3.7  | 10.0 | 6.0          |
| 8    | 18-39208 | (B) M | 5.5  | 12.6 | 12.0         |
| 10   | 18-39210 | F     | 9.25 | 17.8 | 21.0         |
| 12   | 18-39212 | F     | 10.0 | 18.8 | 31.0         |

### 45° WYE (G x G x G)

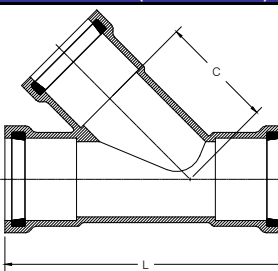

(Non-pressure)

| SIZE  | PART #    | STYLE | C   | L    | WT (approx.) |
|-------|-----------|-------|-----|------|--------------|
| 4 x 4 | 18-010404 | M     | 6.8 | 16.8 | 8.2          |
| 6 x 4 | 18-010604 | MA    | 9.6 | 21.3 | 15.0         |
| 6 x 6 | 18-010606 | M     | 9.6 | 21.3 | 19.1         |

Call For Other Sizes, Configurations & Gasket Materials

#### Notes:

- All lay lengths & weights are approximate and are subject to change without notice
- Fabricated fitting configurations may vary

#### Style Legend:

- F - Fabricated fittings are made from sections of C-900 pipe and are not pressure rated
- FTO - Fabricated To Order
- M - Molded fittings are Pressure Class 150 unless otherwise noted
- MA - Assembled from molded or extruded components



### THE HARRINGTON CORPORATION

P.O. BOX 10335 • LYNCHBURG, VIRGINIA 24506 • 3721 COHEN PLACE • LYNCHBURG, VIRGINIA 24501  
 PHONE: (434) 845-7094 • FAX: (434) 845-8562 • E-MAIL: sales@harcofittings.com • WEB: www.harcofittings.com

20180402

# HARCO PVC C-900 GASKETED FITTINGS

## DESIGN DATA

### ADAPTER – C900 x Sewer (G x S)

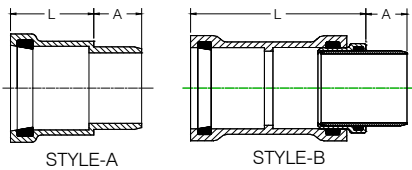

(Non-pressure)

(Molded fitting shown)

| SIZE | PART #   | STYLE  | A   | L    | WT (approx.) |
|------|----------|--------|-----|------|--------------|
| 4    | 18-39104 | (B) MA | 3.2 | 10.0 | 4.0          |
| 6    | 18-39106 | (A) M  | 2.9 | 3.5  | 2.0          |
| 8    | 18-39108 | (B) MA | 4.0 | 12.5 | 15.0         |
| 10   | 18-39110 | F      | 7.5 | 18.8 | 11.0         |
| 12   | 18-39112 | F      | 7.5 | 20.0 | 16.0         |

### ADAPTER – C900 x IPS (G x G)

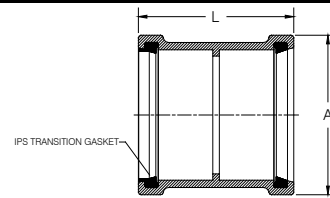

(Non-pressure)

| SIZE | PART #   | STYLE | A    | L    | WT (approx.) |
|------|----------|-------|------|------|--------------|
| 4    | 18-37004 | MA    | 6.3  | 8.9  | 2.9          |
| 6    | 18-37006 | M     | 8.3  | 10.0 | 6.0          |
| 8    | 18-37008 | M     | 11.1 | 11.3 | 12.5         |

### ADAPTER – C900 x IPS (S x G)

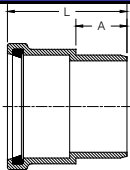

(Molded fitting shown)

| SIZE | PART #   | STYLE | A   | L   | WT (approx.) |
|------|----------|-------|-----|-----|--------------|
| 4    | 18-37204 | M     | 2.7 | 7.0 | 2.4          |
| 6    | 18-37206 | M     | 3.7 | 8.6 | 5.0          |
| 8    | 18-37208 | F     |     |     | 28.0         |

### TAPPED PLUG (FNPT Thread)

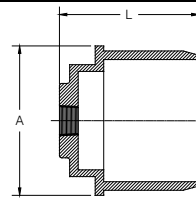

Use poured concrete thrust blocks only

| SIZE      | PART #    | STYLE | A   | L   | WT (approx.) |
|-----------|-----------|-------|-----|-----|--------------|
| 4 x 3/4   | 18-450403 | M     | 5.3 | 4.5 | 1.2          |
| 4 x 1     | 18-450404 | M     | 5.3 | 4.5 | 1.2          |
| 4 x 1 1/2 | 18-450406 | M     | 5.3 | 4.5 | 1.2          |
| 4 x 2     | 18-450408 | M     | 5.3 | 4.5 | 1.2          |
| 6 x 3/4   | 18-450603 | M     | 7.4 | 6.4 | 3.1          |
| 6 x 1     | 18-450604 | M     | 7.4 | 6.4 | 3.1          |
| 6 x 1 1/2 | 18-450606 | M     | 7.4 | 6.4 | 3.1          |
| 6 x 2     | 18-450608 | M     | 7.4 | 6.4 | 3.1          |
| 8 x 3/4   | 18-450803 | M     | 9.5 | 7.3 | 6.2          |
| 8 x 1     | 18-450804 | M     | 9.5 | 7.3 | 6.2          |
| 8 x 1 1/2 | 18-450806 | M     | 9.5 | 7.3 | 6.2          |
| 8 x 2     | 18-450808 | M     | 9.5 | 7.3 | 6.2          |

### TEE (G x G x G)

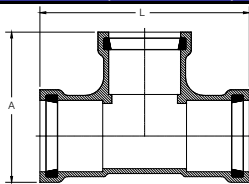

(Molded fitting shown)

| SIZE    | PART #    | STYLE | A    | L    | WT (approx.) |
|---------|-----------|-------|------|------|--------------|
| 4 x 4   | 18-120404 | M     | 10.1 | 14.2 | 6.7          |
| 6 x 4   | 18-120604 | M     | 12.3 | 15.4 | 11.5         |
| 6 x 6   | 18-120606 | M     | 13.0 | 17.4 | 14.5         |
| 8 x 4   | 18-120804 | M     | 14.9 | 16.3 | 19.0         |
| 8 x 6   | 18-120806 | M     | 15.4 | 18.5 | 23.0         |
| 8 x 8   | 18-120808 | M     | 16.0 | 20.9 | 26.0         |
| 10 x 4  | 18-121004 | F     | 22.0 | 29.3 | 37           |
| 10 x 6  | 18-121006 | F     | 23.0 | 30.3 | 40           |
| 10 x 8  | 18-121008 | F     | 22.5 | 33.0 | 43           |
| 10 x 10 | 18-121010 | F     | 22.5 | 35.5 | 68           |
| 12 x 4  | 18-121204 | F     | 24.0 | 32.5 | 56           |
| 12 x 6  | 18-121206 | F     | 25.0 | 33.5 | 60           |
| 12 x 8  | 18-121208 | F     | 26.5 | 36.5 | 65           |
| 12 x 10 | 18-121210 | F     | 26.0 | 38.5 | 72           |
| 12 x 12 | 18-121212 | F     | 26.0 | 40.5 | 99           |

### PLUG

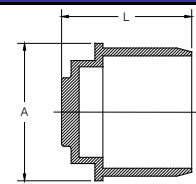

Use poured concrete thrust blocks only

(Molded fitting shown)

| SIZE | PART #  | STYLE | A    | L    | WT (approx.) |
|------|---------|-------|------|------|--------------|
| 4    | 18-4404 | M     | 5.3  | 4.5  | 1.2          |
| 6    | 18-4406 | M     | 7.4  | 6.4  | 3.1          |
| 8    | 18-4408 | M     | 9.5  | 7.3  | 6.2          |
| 10   | 18-4410 | F     | 12.3 | 14.0 | 21.0         |
| 12   | 18-4412 | F     | 14.5 | 14.0 | 32.0         |

Call For Other Sizes, Configurations & Gasket Materials

#### Notes:

- All lay lengths & weights are approximate and are subject to change without notice
- Fabricated fitting configurations may vary

#### Style Legend:

- F - Fabricated fittings are made from sections of C-900 pipe and are not pressure rated
- M - Molded fittings are Pressure Class 150 unless otherwise noted
- MA - Assembled from molded or extruded components



### THE HARRINGTON CORPORATION

P.O. BOX 10335 • LYNCHBURG, VIRGINIA 24506 • 3721 COHEN PLACE • LYNCHBURG, VIRGINIA 24501  
 PHONE: (434) 845-7094 • FAX: (434) 845-8562 • E-MAIL: sales@harcofittings.com • WEB: www.harcofittings.com

20180402

# HARCO PVC C-900 GASKETED FITTINGS

## DESIGN DATA

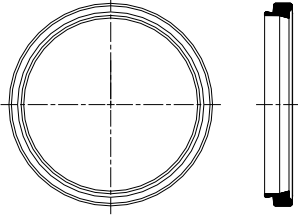
| TRANSITION GASKET - C900 x IPS  |          |       |              |
|---|----------|-------|--------------|
|  |          |       |              |
| (Non-pressure)  |          |       |              |
| SIZE  | PART #   | STYLE | WT (approx.) |
| 4   | 18-G9604 | M     | 0.3          |
| 6   | 18-G9606 | M     | 0.5          |
| 8   | 18-G9608 | M     | 0.7          |

Call For Other Sizes, Configurations & Gasket Materials

### Style Legend:

M - Molded fittings are Pressure Class 150 unless otherwise noted



### THE HARRINGTON CORPORATION

P.O. BOX 10335 • LYNCHBURG, VIRGINIA 24506 • 3721 COHEN PLACE • LYNCHBURG, VIRGINIA 24501  
PHONE: (434) 845-7094 • FAX: (434) 845-8562 • E-MAIL: sales@harcofittings.com • WEB: www.harcofittings.com