

Installation Instructions / Warranty

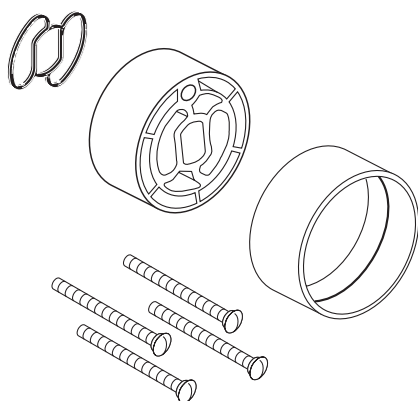

Extension Kits

13591001

13592001

13593001

hangrohe

Extension Kits

13591001 ThermoPlus / ThermoBalance I

13592001 ThermoBalance II

13593001 ThermoBalance III

Installation

- Make sure that the water is turned off at the stops or at the main before beginning this installation!
- Confirm that the sealing ring is in place on the rear of the extension.

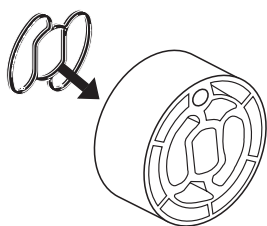

13591001

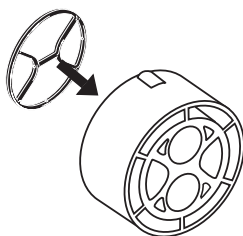

13592001

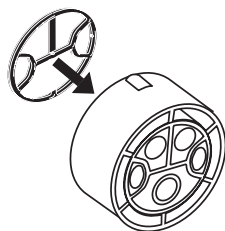

13593001

ThermoPlus / ThermoBalance I:

Position the extension and the stabilizer sleeve in the rough.

Make sure that the pin on the back of the extension goes straight into the hole in the rough.

Install the thermoelement with retainer plate. Use the screws included with the extension kit to attach the retainer plate to the valve rough. Tighten the screws evenly by hand, in a crosswise pattern.

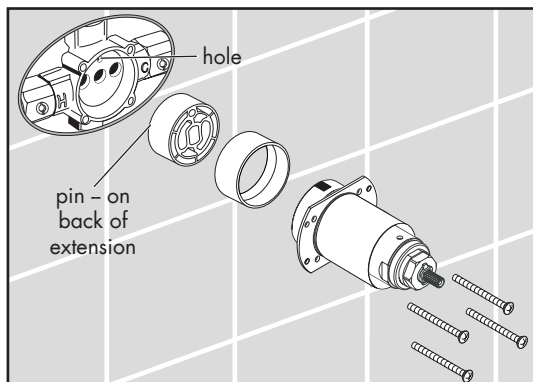

ThermoBalance II / ThermoBalance III:

Position the extension and the stabilizer sleeve in the rough.

Make sure that the locator tab on the rear of the extension goes straight into the notch in the valve rough.

Install the thermoelement with retainer plate. Use the screws included with the extension kit to attach the retainer plate to the valve rough. Tighten the screws evenly by hand, in a crosswise pattern.

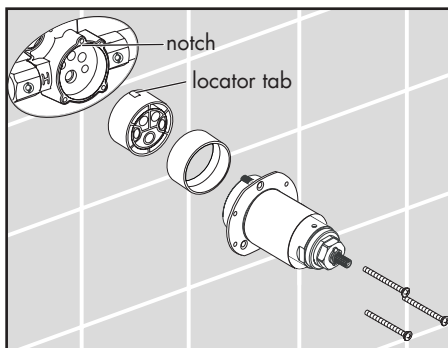
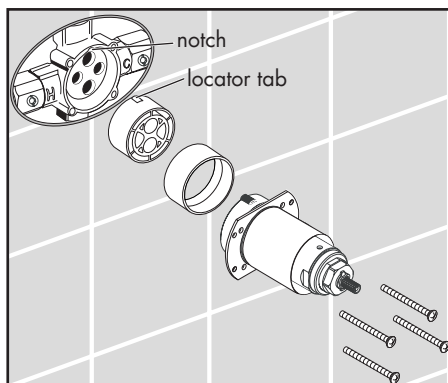

All models:

Turn on the water and check for leaks.

Continue the installation of the trim.

hansgrohe

Hansgrohe, Inc. • 1490 Bluegrass Lakes Parkway • Alpharetta, GA 30004
Tel. 770 360-9880 • Fax 770 360 9887

www.hansgrohe-USA.com