



**Serif®**

Drop-in Bathroom Sink  
**K-2075-8**

### Features

- 8-inch center faucet holes.
- Oval basin.
- Overflow drain.
- Coordinates with other products in the Serif collection.

### Material

- Vitreous china.

### Installation

- Drop-in

### Recommended Accessories

K-8998 P-Trap



ADA

### Codes/Standards

ASME A112.19.2/CSA B45.1

ADA







ICC/ANSI A117.1

### KOHLER® One-Year Limited Warranty

See website for detailed warranty information.

### Available Color/Finishes

*Color tiles intended for reference only.*

Color	Code	Description
	0	White
	96	Biscuit
	47	Almond
	NY	Dune
	95	Ice™ Grey
	G9	Sandbar
	7	Black Black™

1-800-4KOHLER (1-800-456-4537)

Kohler Co. reserves the right to make revisions without notice to product specifications.

For the most current Specification Sheet, go to [www.kohler.com](http://www.kohler.com).

12-4-2018 11:50 - US/CA/MX

THE BOLD LOOK  
OF **KOHLER®**

# KOHLER®

## Serif® Drop-in Bathroom Sink K-2075-8

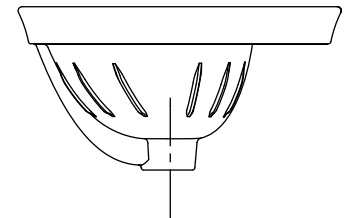
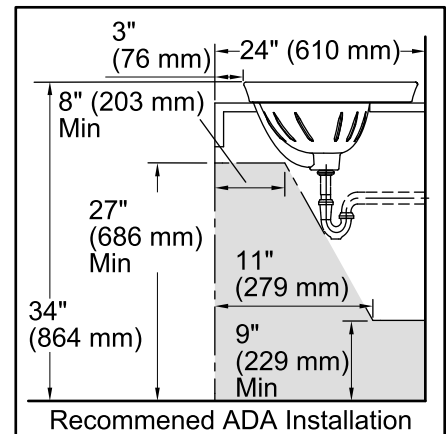
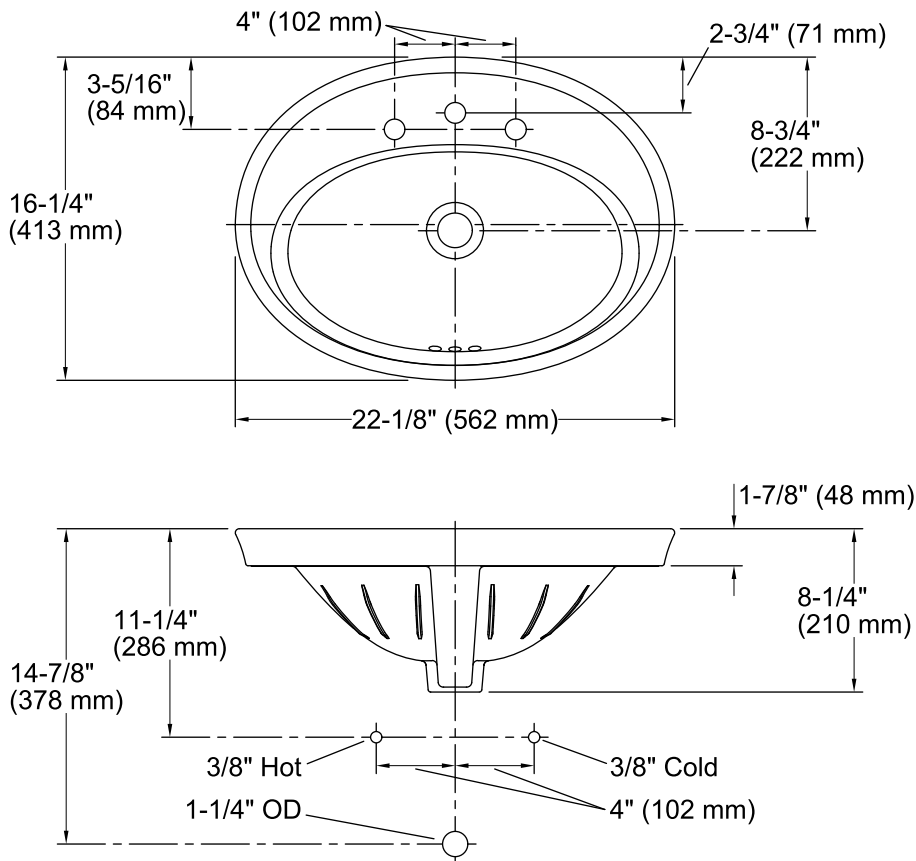

### Technical Information

All product dimensions are nominal.

Bowl configuration: Single

Installation: Drop-in

Bowl area (Only): Length: 16-7/8" (429 mm)  
Width: 10-1/8" (257 mm)  
Water depth: 4-7/8" (124 mm)

Number of deck holes: 1

Faucet hole(s): 1-3/8" (35 mm)

Drain hole: 1-3/4" (44 mm)

Template: 1014189-7, required, included

### Notes

Install this product according to the installation instructions.

NOTICE: Countertop manufacturer or cutter must use the cut-out template provided with the product, or a current one provided by Kohler Co. (call 1-800-4-KOHLER). Kohler Co. is not responsible for cutout errors when the incorrect cut-out template is used.

ADA compliant when installed to the specific requirements of these regulations.

1-800-4KOHLER (1-800-456-4537)

Kohler Co. reserves the right to make revisions without notice to product specifications.

For the most current Specification Sheet, go to [www.kohler.com](http://www.kohler.com).

12-4-2018 11:50 - US/CA/MX

THE BOLD LOOK  
OF **KOHLER®**