

90°
BENDS

MOLDED
FOR YOUR
INDUSTRY

IntegriFuse™



 **INTEGRITY**
Fusion Products, Inc.

TOLL FREE 1-888-770-6330

INTEGRITYFUSION.COM

90° BENDS

The difference MOLDED Makes

Molded 90 elbows from Integrity Fusion Products offer performance, availability, and value that eliminate the need for fabricated fittings.

The molded difference includes:

- No inner fusion beads
- Fully Pressure Rated
- Wall thickness remains consistent throughout

IntegriFuse fittings are manufactured from 100% Virgin Resin with black high density bimodal polyethylene copolymer designed for use in, but not limited to, potable water, natural gas, industrial, landfill, oil & gas, and mining applications.

All IntegriFuse fittings meet ASTM-D2513 & ASTM-D3261 requirements.

All butt fusion, electrofusion, and transition fittings meet AWWA C-901/C-906, NSF-61, and NSF-372. IntegriFuse fittings are manufactured with resin having a material designation code of PE 3408, PE3608, PE 4710, and PE 100.

Integrity Fusion Products, Inc.
270 Parkade Court
Peachtree City, GA 30269
Phone 770.632.7530 | Fax 770.632.7540
www.IntegrityFusion.com
Call Toll Free at 888.770.6330

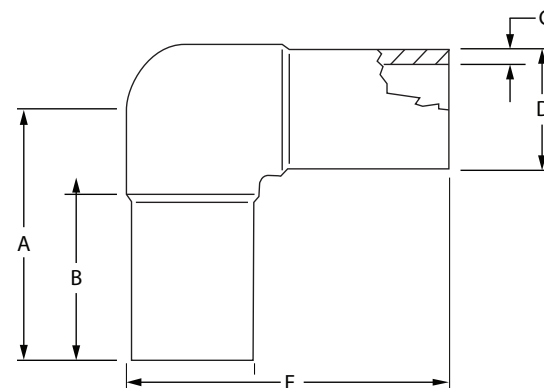

IPS

SDR 9 (Standard Dimension Ratio) 255 PSI (Working Pressure at 73.4° F)

Nominal Size	A	B	C	D	E	Weight	Item Code	Notes
2" IPS	4.36"	2.64"	0.264"	2.375"	5.63"	0.6 lbs.	100108	FM 250
3" IPS	5.85"	3.50"	0.389"	3.500"	7.73"	1.7 lbs.	100112	FM 250
4" IPS	6.85"	3.80"	0.500"	4.500"	9.21"	3.3 lbs.	100116	FM 250
6" IPS	8.94"	4.75"	0.736"	6.625"	12.40"	8.8 lbs.	100120	FM 250
8" IPS	11.81"	7.20"	0.958"	8.625"	16.13"	19.6 lbs.	100124	FM 250

SDR 7 (Standard Dimension Ratio) 335 PSI (Working Pressure at 73.4° F)

Nominal Size	A	B	C	D	E	Weight	Item Code	Notes
2" IPS	4.36"	2.64"	0.339"	2.375"	5.63"	0.7 lbs.	100107	FM 335
3" IPS	5.85"	3.50"	0.500"	3.500"	7.73"	2.2 lbs.	100111	FM 335
4" IPS	6.85"	3.80"	0.643"	4.500"	9.21"	4.0 lbs.	100114	FM 335
6" IPS	8.94"	4.75"	0.946"	6.625"	12.40"	10.9 lbs.	100119	FM 335
8" IPS	11.81"	7.20"	1.232"	8.625"	16.13"	23.9 lbs.	100123	FM 335

DIPS

SDR 11 (Standard Dimension Ratio) 200 PSI (Working Pressure at 73.4° F)

Nominal Size	A	B	C	D	E	Weight	Item Code	Notes
4" DIPS	7.55"	4.10"	0.436"	4.800"	10.04"	3.2 lbs.	100129	FM 200
6" DIPS	9.67"	5.10"	0.627"	6.900"	13.34"	8.7 lbs.	100130	FM 200
8" DIPS	11.58"	5.20"	0.823"	9.050"	16.33"	19.5 lbs.	100131	FM 200
10" DIPS	13.00"	5.5"	1.010"	11.10"	18.00"	28.5 lbs.	100132	FM 200
12" DIPS	14.00"	5.87"	1.200"	13.20"	20.00"	43.8 lbs.	100133	FM 200