

EQUAL  
TEE

MOLDED  
FOR YOUR  
INDUSTRY

IntegriFuse<sup>TM</sup>



 **INTEGRITY**  
Fusion Products, Inc.

TOLL FREE 1-888-770-6330

INTEGRITYFUSION.COM

# The difference MOLDED

Molded Tees from Integrity Fusion Products are the market leader for butt fusion tees. These fittings offer performance, availability, and value that eliminate the need for fabricated fittings.

## The Molded difference includes:

- No inner fusion bead
- Fully pressure rated
- Wall thickness remains consistent throughout

IntegriFuse EF Fittings are manufactured from the highest quality Virgin black high density bimodal polyethylene copolymer resin designed for use in, but not limited to, potable water, natural gas, industrial, landfill, oil & gas, and mining applications.

All IntegriFuse fittings meet ASTM –D2513 & ASTM D3261 (where applicable). F Approved. All butt fusion, electrofusion, and transition fittings meet AWWA C-901/ C-906, NSF-61, and NSF-371 (where applicable) IntegriFuse fittings are manufactured with resin having a material designation code of PE 3408, PE 3608, PE 4710, and PE 100

Integrity Fusion Products, Inc.  
270 Parkade Court  
Peachtree City, GA 30269  
P: 1-888-770-6330 • P: 770-632-7530  
F: 770-632-7540

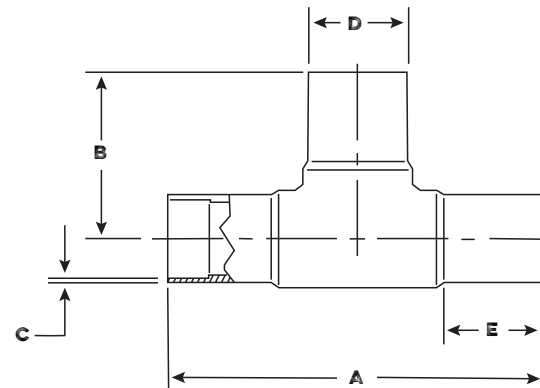

## IPS-SDR 17 - 125 PSI (Working Pressure at 73.4° F)

Nominal Size	A	B	C	D	E	Weight	Item Code
3" IPS	11.81"	5.91"	0.206"	3.500"	3.54"	1.5 lbs.	100709
4" IPS	13.78"	6.89"	0.264"	4.500"	3.94"	2.8 lbs.	100713
6" IPS	18.11"	9.06"	0.390"	6.625"	4.72"	7.5 lbs.	100717
8" IPS	23.62"	11.81"	0.507"	8.625"	5.71"	17.5 lbs.	100721
10" IPS	27.56"	13.78"	0.632"	10.750"	6.30"	28.3 lbs.	100725
12" IPS	31.57"	15.97"	0.750"	12.750"	7.52"	47.5 lbs.	100727
14" IPS	25.50"	14.70"	0.923"	14.26"	4.52"	48.0 lbs.	100751
16" IPS	29.80"	15.29"	1.070"	16.25"	5.25"	66.0 lbs.	100753

## IPS-SDR 11 - 200 PSI (Working Pressure at 73.4° F)

Nominal Size	A	B	C	D	E	Weight	Item Code	Notes
¾" IPS	6.38"	3.19"	0.095"	1.050"	2.14"	0.2 lbs.	100700	-
1" IPS	6.62"	3.31"	0.120"	1.315"	2.18"	0.2 lbs.	100701	-
1 ¼" IPS	6.97"	3.48"	0.151"	1.660"	2.15"	0.4 lbs.	100702	-
1 ½" IPS	7.84"	3.92"	0.173"	1.900"	2.37"	0.6 lbs.	100704	-
2" IPS	8.66"	4.33"	0.216"	2.375"	2.48"	1.0 lbs.	100705	FM 200
3" IPS	11.81"	5.91"	0.318"	3.500"	3.54"	1.5 lbs.	100708	FM 200
4" IPS	13.78"	6.89"	0.409"	4.500"	3.94"	3.9 lbs.	100712	FM 200
6" IPS	18.11"	9.06"	0.602"	6.625"	4.72"	10.5 lbs.	100716	FM 200
8" IPS	23.62"	11.81"	0.784"	8.625"	5.71"	23.2 lbs.	100720	FM 200
10" IPS	27.56"	13.78"	0.977"	10.750"	6.30"	39.4 lbs.	100724	FM 200
12" IPS	31.57"	15.97"	1.159"	12.750"	7.52"	66.3 lbs.	100726	FM 200
14" IPS	31.75"	14.56"	1.300"	14.020"	6.50"	70.0 lbs.	100750	-
16" IPS	29.90"	15.30"	1.072"	16.270"	5.14"	94.0 lbs.	100752	-

