

"E-4" DRILLING MACHINE

FOR DRILLING OPERATIONS $\frac{7}{16}$ " TO 1" INCLUSIVE UNDER PRESSURE

**CAPACITY AND USE:**

The "E-4" Drilling Machine drills holes from $\frac{7}{16}$ " to 1" inclusive in any size or kind of main. This is done under pressure by using a stop or valve between the machine and the main. The stop is not required when there is no pressure.

WORKING PRESSURE AND TEMPERATURE:

500 p.s.i. Maximum Working Pressure at 100° F.
250° F. Maximum Temperature Rating at 375 p.s.i.
The working pressure or temperature rating is reduced accordingly if any attachment, valve or fitting, subjected to pressure or temperature during the drilling operation, has a maximum working pressure or temperature rating less than that specified above.

LENGTH OF TRAVEL: $9\frac{9}{16}$ "

EQUIPMENT FURNISHED WITH EACH MACHINE:

Ratchet Handle
Body Gasket
Adjustable Wrench
2 Double Open End Wrenches.
Lubricating Oil
Cutting Grease
Metal Case

EQUIPMENT TO BE SELECTED:

Drill and Drill Holder from Page 2-3.
Machine Adapter Nipple from Page 2-4.

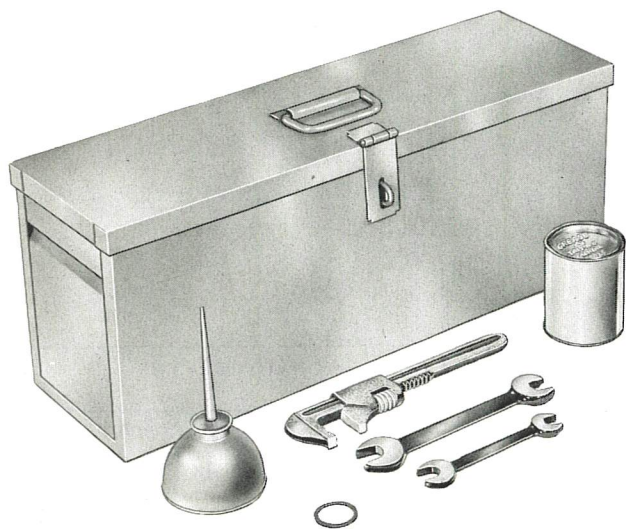
**"E-4" MACHINE AND EQUIPMENT FURNISHED**

Furnished in a Metal Carrying Case.
Total Shipping Weight: 45 pounds
Machine weight only: 22 pounds

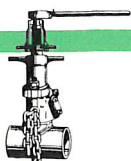

"E-4" MACHINE DRILLS AND DRILL HOLDERS

DRILLING MACHINES

The maximum drill size is specified for each Corporation Stop in Section 3. Smaller size drills may be used, if desired. In the smaller sizes, the drill and drill holder are combined. In the larger sizes, the drill and drill holder are furnished as separate parts.

SIZE	COMBINED DRILL & HOLDER			DRILL			DRILL HOLDER
	Regular	CEM-RES	Tungsten Carbide Tipped	Regular	CEM-RES	Tungsten Carbide Tipped	
7/16"	61879	79175					
1/2"	61788	68315					
9/16"	62011						
5/8"	49955			61982		83436	61981
11/16"	37030			61992	36037	83142	61981
3/4"				61790	36038		61789
13/16"				61991			61789
7/8"				61990	33253		61993
15/16"			83147	61989	36039	83143	61993
1"				61968	36040		61969



DRILL HOLDER



DRILL



COMBINED DRILL AND HOLDER

REGULAR Drills (or Combined Drills and Holders) are for use with cast iron pipe and steel pipe.

CEM-RES Drills (or Combined Drills and Holders) are for use with asbestos-cement pipe and cement-lined pipe.

TUNGSTEN CARBIDE TIPPED Drills (or Combined Drills and Holders) are for use with concrete pipe. They may also be used for asbestos-cement pipe.

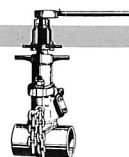

COPPER COUPLING
THREAD

MUELLER THREAD

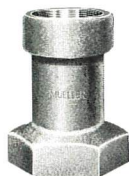
LEAD FLANGE
EXTRA STRONGLEAD FLANGE
DOUBLE EXTRA
STRONGINSIDE
I.P. THREADOUTSIDE
I.P. THREADI.P. THREADED
COPPER COUPLING

The Machine Adapter Nipples listed on this page are used between the lower end of the "E-4" Drilling Machine and the outlet end of the Corporation Stop.

Type of Machine Adapter Nipple (also see Section 3)	Maximum Pressure & Temperature Rating	Size of the Outlet Pipe Connection of the Corporation Stop to be Used				
		1/2"	5/8"	3/4"	1"	1 1/4"
With Inside Thread for Copper Coupling (MUELLER Copper Service Pipe Coupling)	200 p.s.i. at 100° F.	63796		52019	36750	45385
With Inside MUELLER Thread	200 p.s.i. at 100° F.	75493	75494	75495	75496	
With Inside Thread for Lead Flange Coupling for Extra Strong Lead Pipe	200 p.s.i. at 100° F.	75498	75499	75937	75938	
With Inside Thread for Lead Flange Coupling for Double Extra Strong Lead Pipe	200 p.s.i. at 100° F.			78637	45122	
With Inside I.P. Thread	1200 p.s.i. at 100° F. 500° F. at 1000 p.s.i.	36966		36919	36917	36928
With Outside I.P. Thread	1200 p.s.i. at 100° F. 500° F. at 1000 p.s.i.	36967		36920	36918	36733
Inside Diameter of Nipple		15/32"		25/32"	31/32"	1 1/4"
Maximum Drill Size *		7/16"		3/4"	15/16"	1"
With Inside Thread for I.P. Threaded Copper Coupling (See Section 13)	200 p.s.i. at 100° F.			43900	43870	

*This is the maximum drill size which can be used with these machine adapter nipples having Outside I.P. Threads.

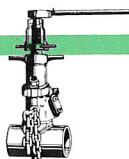

"E-4" MACHINE PARTS-MODEL NO. 5

DRILLING MACHINES

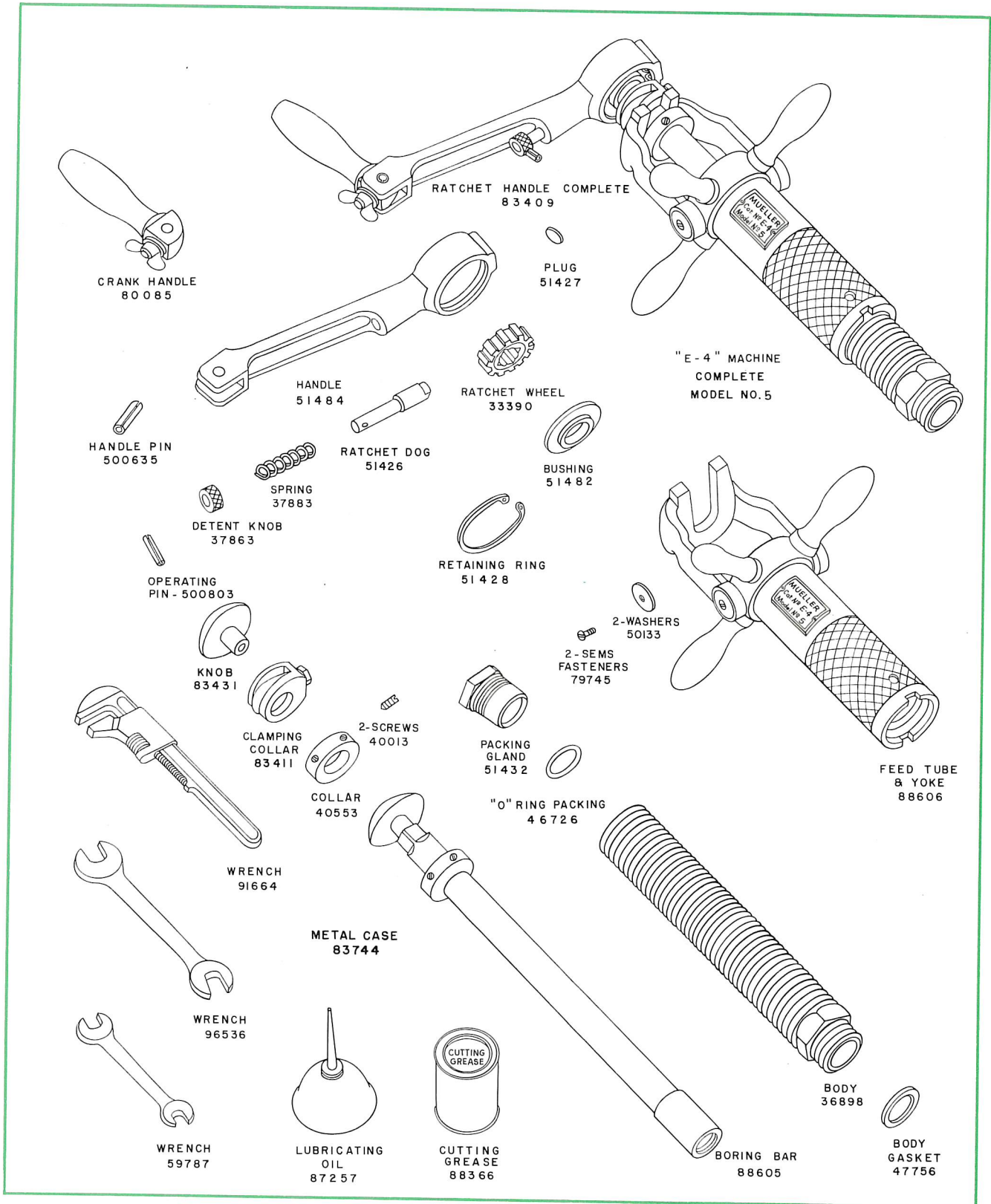

ORDER BY QUANTITY, PART NUMBER, PART NAME,
CATALOG NUMBER, AND MODEL NUMBER OF
MACHINE

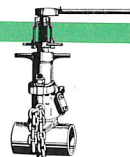

MUELLER CO.
DECATUR, ILL.