

Backing Flanges

SK-39-SO and SK-39-PSO Backing Flanges

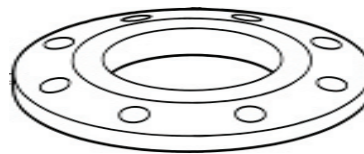
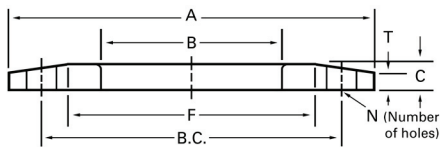

- An economical light-weight backing flange for use with slip-on type stub ends.
- Tapered face on the flange improves visibility during gasket alignment.
- Cast in commercial quality steel or machined from ASTM A 36 plate.
- Cast or drilled hole patterns per ANSI B16.1, Class 125 (identical to ANSI B16.5, Class 150).
- Coated with red oxide primer. Galvanized, epoxy and other coatings are also available.
- Normally used with Alaskan slip-on stub ends SK-36-SO, SK-36-PSO, SK-38-SO, SK-38-PSO.
- Also available in T304 and T316 Stainless Steel.

SK-39-SO

Made to Fit With OD Tube Size Slip-On Stub Ends

Tube OD	2	2 1/2	3	4	5	6	8	10	12	14	16	18	20	24	30	36	42
A (OD)	6	7	7 1/2	9	10	11	13 1/2	16	19	21	23 1/2	25	27 1/2	32	38 3/4	46	53
B (ID)	2 5/8	3 1/8	3 3/4	4 3/4	5 7/8	7	9	11 1/8	13 1/8	15	17	19	21	25	31	37	43 1/2
C (THK)	5/8	5/8	5/8	5/8	3/4	3/4	3/4	7/8	7/8	1	1	1 1/8	1 1/8	1 1/8	1 1/4	1 1/4	1 1/4
B.C.	4 3/4	5 1/2	6	7 1/2	8 1/2	9 1/2	11 3/4	14 1/4	17	18 3/4	21 1/4	22 3/4	25	29 1/2	36	42 3/4	48 1/2
Hole Size	3/4	3/4	3/4	3/4	7/8	7/8	7/8	1	1	1 1/8	1 1/8	1 1/4	1 1/4	1 3/8	1 3/8	1 5/8	1 5/8
N	4	4	4	8	8	8	8	12	12	12	16	16	20	20	28	32	36
F	3 5/8	4 5/8	5	6 3/16	7 3/8	8 1/2	10 5/8	12 3/4	15	16 1/4	18 1/2	21	23	27 5/8	34 1/2	39	46 1/4
T	3/8	3/8	3/8	3/8	3/8	3/8	3/8	1/2	1/2	1/2	1/2	5/8	5/8	5/8	3/4	3/4	3/4
Weights	2.8	4.2	4.5	6.7	7.5	9.5	12.5	19.0	28.0	32.0	42.0	50.0	58.0	82.0	115	145	195

SK-39-PSO

Made to Fit With Nominal Pipe Size Slip-On Stub Ends (Identical to SK-39-SO Except for B Dimension)

Nominal Pipe Size	2	2 1/2	3	4	5	6	8	10	12	14 thru 24 see SK-39-SO
Pipe OD	2 3/8	2 7/8	3 1/2	4 1/2	5 9/16	6 5/8	8 5/8	10 3/4	12 3/4	
B (ID)	3	3 1/2	4 1/8	5 1/8	6 1/4	7 3/8	9 3/8	11 5/8	13 5/8	
Weights	2.7	4.0	4.3	5.5	7.0	7.5	11.0	16.5	26.0	

Dimensions are in inches. All weights are in pounds based on a metal density of .2836 lb/in³
When ordering galvanized flanges, specify SK-39-SOG or SK-39-PSOG.