

# Permanent Split Capacitor Condenser Fan

## 5.6" Diameter, Totally Enclosed Air Over (TEAO)

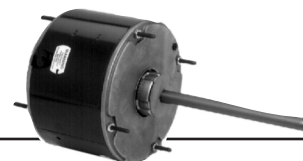

### APPLICATIONS:

Residential and commercial condensing unit fan motors to meet manufacturer's requirements.

### FEATURES:

- 140°F (60°C) Ambient Design
- Sleeve Bearings have All Angle Thrust System
- Class B Insulation
- Designed for use with 370V Capacitors
- Extended Studs
- 30" Leads
- Hubless Lead End
- Drain Holes Both Ends
- Reversible Rotation
- Automatic Reset Thermal Overload Protector
- Continuous Duty
- **Discount Symbol: DS-3HAC**

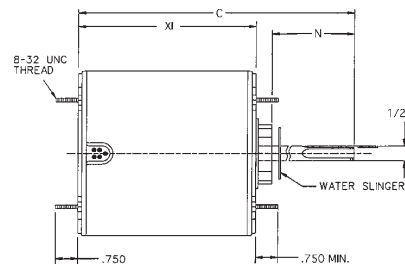

### Stud Mount, Without Capacitor, High Ambient Design, All Angle Mount

HP	RPM	Volts	Catalog Number	List	Bearings	Cap. MFD	Amps	Shaft N	Shell XI	Total C	Ship Wgt.	Notes	OEM
1/12	1100	208-230	3401	\$151	Slv	5.0	0.7	1.6	4.1	5.7	9		CA
1/10	825	208-230	1871	\$149	Slv	3.0	1.0	6.0	3.8	10.4	10		
	1100	208-230	3402	\$160	Slv	5.0	0.8	1.6	4.1	5.7	9		CA
1/8	825	208-230	1872	\$150	Slv	5.0	0.8	6.0	4.1	10.6	11	72	
	825	208-230	5456	\$167	Slv	5.0	1.2	3.8	4.1	7.8	11	72	RH
1/6	825	208-230	1873	\$164	Slv	5.0	1.0	6.0	4.1	10.6	12	72	
	825	208-230	5457	\$177	Slv	7.5	1.2	3.8	4.6	8.3	13	72	RH
	825/2	208-230	8673	\$214	Slv	5.0	1.0	6.0	4.4	10.9	14		
	1075	208-230	1859	\$101	Slv	5.0	1.0	5.0	3.8	9.4	11		CA
1/5	1075	208-230	5450	\$168	Slv	3.0	1.3	3.7	3.8	7.5	11	72	RH
	1075	208-230	5454	\$135	Slv	3.0	1.7	3.7	3.8	8.1	11	72	RH
1/4-1/8	825	208-230	1874	\$164	Slv	5.0	2.0	6.0	4.3	10.9	13	72	
1/4	825	460	1880	\$254	Ball	5.0	1.0	6.0	5.1	11.6	14		
	840	208-230	1123	\$257	Slv	5.0	1.4	2.5	4.6	7.6	16		IC
	850	208-230	1743	\$167	Slv	5.0	1.5	2.8	4.6	7.3	10		YK
	825/2	208-230	8674	\$242	Slv	7.5	2.0	6.0	4.6	11.1	15		
	1075	208-230	1860	\$105	Slv	5.0	1.7	5.0	4.1	9.6	12		
	1075	208-230	1876	\$108	Ball	5.0	1.7	5.0	4.1	9.6	11		
	1075	460	3736	\$235	Ball	7.5	0.8	6.0	4.6	11.1	12		
	1100	208-230	3404	\$201	Slv	5.0	1.8	1.6	4.6	6.2	12		CA
1/3	1625	208-230	1890	\$231	Slv	5.0	1.4	5.0	4.3	9.9	12		
	825	208-230	1875	\$186	Slv	7.5	2.4	6.0	5.1	11.6	17	72	
	825	460	1881	\$333	Ball	7.5	1.0	6.0	5.6	12.1	17		

CA = Carrier    IC = ICP    RH = Rheem    YK = York

Note 71    1.5" Stud Ext., Shaft End only, 104°F (40°C) Ambient, Double Flats

Note 72    Includes 4 Holes in Shell for Rheem Mount

† All marks shown within this document are properties of their respective owners



DRIVES  
BRAKE MOTORS  
GENERAL PURPOSE SINGLE PHASE  
HVAC  
WASHDOWN  
AGRICULTURE  
COMMERCIAL PUMP MOTORS  
CLOSE COUPLED PUMP MOTORS  
FIRE PUMP MOTORS  
POOL & SPA MOTORS  
RESIDENTIAL WATER PUMP  
ELEVATOR AND GATE & DOOR

# Permanent Split Capacitor Condenser Fan

## 5.6" Diameter, Totally Enclosed Air Over (TEAO)

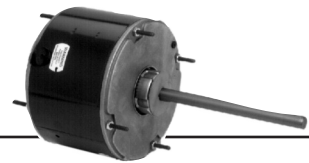

HP	RPM	Volts	Catalog Number	List	Bearings	Cap. MFD	Amps	Shaft N	Shell XI	Total C	Ship Wgt.	Notes	OEM
1/3	825/2	208-230	8675	\$253	Slv	7.5	2.0	6.0	5.4	11.9	17		
	1075	208-230	1861	\$112	Slv	7.5	2.1	5.0	4.6	10.1	14		
	1075	208-230	5455	\$144	Slv	5.0	2.0	3.7	4.1	8.3	13	72	RH
	1075	208-230	1877	\$115	Ball	7.5	2.1	5.0	4.6	10.1	14		
	1075	460	3737	\$269	Ball	7.5	1.3	6.0	5.4	11.9	17		
	1075/2	208-230	8670	\$222	Slv	7.5	2.2	6.0	4.8	11.4	16	71	
	1625	208-230	1891	\$263	Slv	5.0	1.9	5.0	4.6	10.1	13		
1/2	825	208-230	1870	\$237	Slv	12.5	2.8	6.0	6.4	12.4	20		
	825	460	1882	\$385	Ball	10.0	1.6	6.0	6.3	12.9	21		
	1075	208-230	1862	\$124	Slv	10.0	3.0	6.0	5.3	11.9	18		
	1075	208-230	1878	\$127	Ball	10.0	3.0	6.0	5.3	11.9	18		
	1075	460	3738	\$277	Ball	10.0	1.5	6.0	5.9	12.4	19		
	1075/2	208-230	8671	\$257	Slv	10.0	2.9	6.0	4.3	10.8	21	71	
	1625	208-230	1892	\$321	Slv	5.0	3.0	5.0	5.1	10.6	15		
3/4	1075	208-230	1868	\$153	Slv	10.0	4.5	5.0	5.8	10.3	20		
	1075	208-230	1879	\$156	Ball	10.0	4.7	5.0	5.8	11.4	21		
	1075	460	3742	\$319	Ball	10.0	2.0	6.0	6.4	12.9	22		

RH = Rheem

Note 71 1.5" Stud Ext., Shaft End only, 104°F (40°C) Ambient, Double Flats

Note 72 Includes 4 Holes in Shell for Rheem Mount

† All marks shown within this document are properties of their respective owners