



## DUCTILE IRON FLANGED FITTINGS

ANSI/AWWA-C110/A21.10 Standard

### REDUCING ELBOWS

Furnished Faced and Drilled to 125 Pound Template Unless Otherwise Ordered.

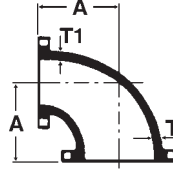

Reducing 90° Elbow

#### DIMENSIONS AND WEIGHTS

Nominal Pipe Size Inches	Dimensions Inches			Approximate Weight Pounds	Nominal Pipe Size Inches	Dimensions Inches			Approximate Weight Pounds
	T	T1	A			T	T1	A	
4 x 3	.50	.37	6.50	35	14 x 12	.87	.81	14.00	320
5 x 4	.50	.50	7.50	48	16 x 8	1.0	.62	15.00	300
6 x 4	.56	.50	8.00	55	16 x 10	1.0	.75	15.00	340
6 x 5	.56	.50	8.00	60	16 x 12	1.0	.81	15.00	380
8 x 4	.62	.50	9.00	75	16 x 14	1.0	.87	15.00	420
8 x 5	.62	.50	9.00	82	18 x 12	1.06	.81	16.50	440
8 x 6	.62	.56	9.00	90	18 x 14	1.06	.87	16.50	480
10 x 4	.75	.50	11.00	105	18 x 16	1.06	1.0	16.50	540
10 x 5	.75	.50	11.00	115	20 x 12	1.12	.81	18.00	520
10 x 6	.75	.56	11.00	125	20 x 14	1.12	.87	18.00	570
10 x 8	.75	.62	11.00	150	20 x 16	1.12	1.0	18.00	640
12 x 6	.81	.56	12.00	165	20 x 18	1.12	1.06	18.00	680
12 x 8	.81	.62	12.00	190	24 x 14	1.25	.87	22.00	865
12 x 10	.81	.75	12.00	220	24 x 16	1.25	1.0	22.00	880
14 x 6	.81	.56	14.00	230	24 x 18	1.25	1.06	22.00	930
14 x 8	.81	.62	14.00	240	24 x 20	1.25	1.12	22.00	1010
14 x 10	.87	.75	14.00	280	...	...	...	...	...

### SIDE OUTLET ELBOWS

For Pressure Ratings and For Drilling Template See Page 52

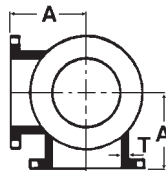

Straight Side Outlet Elbows\*

Nominal pipe size Inches	Dimension T Inches	Dimension A Inches	Approximate weight Pounds	Nominal pipe size Inches	Dimension T Inches	Dimension A Inches	Approximate Weight Pounds
3	.37	5.50	34	12	.81	12.00	340
4	.50	6.50	59	14	.87	14.00	470
5	.50	7.50	75	16	1.0	15.00	620
6	.56	8.00	96	18	1.06	16.50	760
8	.62	9.00	150	20	1.12	18.00	970
10	.75	11.00	240	24	1.25	22.00	1510

\*In certain sizes, we can furnish side outlet elbows with the side outlet smaller than the main openings where there is a need of such fittings, please check with us before placing your order. Flange accessories must be ordered separately.