

TOLCO™ Fig. 4B Pipe Clamp for Sway Bracing

Size Range: 3/4" (20mm) thru 8" (200mm) pipe

Material: Steel

Function: For bracing pipe against sway and seismic disturbance

Approvals: Included in our Seismic Engineering Guidelines approved by the State of California Office of Statewide Health Planning and Development (OSHPD). For additional load, spacing and placement information relating to OSHPD projects, please refer to our Seismic Engineering Guidelines, OPM-0052-13.

Installation Instructions: Fig. 4B is the "braced pipe" attachment component of a longitudinal or lateral sway brace assembly. It is intended to be combined with the "bracing pipe" and transitional and structural attachment component(s) to form a complete bracing assembly. OSHPD guidelines should be followed.

To Install: Place the Fig. 4B over the pipe to be braced. Attach other transitional fitting, Fig. 909, 910, 980, or 990. Tighten bolts and nuts. Transitional fitting attachment can pivot for adjustment to proper brace angle.

Standard Finish: Plain or Electro-Plated

Order By: Part number and finish.

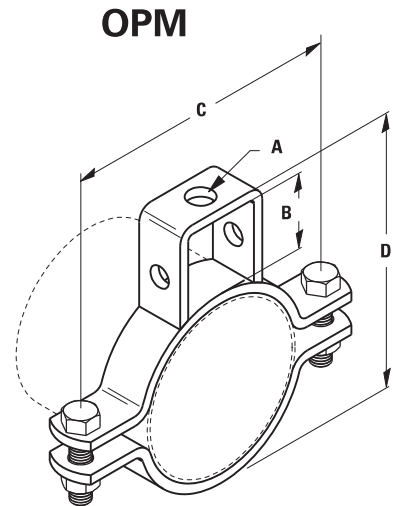

Part No.	Pipe Size in. (mm)	Rod Size A	B in. (mm)	C in. (mm)	D in. (mm)	Bolt Size	Approx. Wt./100 lbs. (kg)
4B-3/4	3/4" (20)	3/8"-16	1" (25.4)	2 7/8" (73.0)	2 5/8" (66.7)	5/16"-18	56 (25.4)
4B-1	1" (25)	3/8"-16	1" (25.4)	3 1/4" (82.5)	2 15/16" (74.6)	5/16"-18	60 (27.2)
4B-1 1/4	1 1/4" (32)	3/8"-16	1" (25.4)	3 9/16" (90.6)	3 1/4" (82.5)	5/16"-18	74 (33.5)
4B-1 1/2	1 1/2" (40)	3/8"-16	1" (25.4)	3 13/16" (96.8)	3 7/16" (87.3)	5/16"-18	79 (35.8)
4B-2	2" (50)	3/8"-16	1 1/2" (38.1)	5 1/8" (130.2)	4 5/8" (117.5)	5/16"-18	156 (70.7)
4B-2 1/2	2 1/2" (65)	1/2"-13	1 3/4" (44.4)	5 5/8" (142.9)	5 3/8" (136.5)	3/8"-16	176 (79.8)
4B-3	3" (80)	1/2"-13	1 7/8" (47.6)	6 3/4" (171.4)	6 1/8" (155.5)	3/8"-16	198 (89.9)
4B-3 1/2	3 1/2" (90)	1/2"-13	2" (50.8)	7 1/4" (184.1)	6 3/4" (171.4)	3/8"-16	219 (99.3)
4B-4	4" (100)	5/8"-11	2" (50.8)	8 5/8" (219.1)	7 1/4" (184.1)	1/2"-13	288 (130.6)
4B-5	5" (125)	5/8"-11	2" (50.8)	9 7/8" (250.8)	8 5/16" (211.1)	5/8"-11	390 (176.9)
4B-6	6" (150)	3/4"-10	2 1/8" (54.0)	10 15/16" (277.8)	9 1/2" (241.3)	5/8"-11	448 (203.2)
4B-8	8" (200)	7/8"-9	2 1/8" (54.0)	13 7/16" (341.2)	11 1/2" (292.1)	3/4"-10	691 (313.4)

Refer to OPM-0052-13 for approved loads.

Eaton's B-Line series seismic bracing components are designed to be compatible only with other B-Line series bracing components, resulting in a listed seismic bracing assembly. Eaton B-Line Division warranty for seismic bracing components will be the warranty provided in Eaton B-Line Division standard terms and conditions of sale made available by Eaton, except that, in addition to the other exclusions from Eaton B-Line Division warranty, Eaton makes no warranty relating to B-Line series seismic bracing components that are combined with products not provided by Eaton.

All dimensions in charts and on drawings are in inches. Dimensions shown in parentheses are in millimeters unless otherwise specified.