



Sonata®

60" shower stall integral high-dome ceiling, requires grab bar
K-1688

Features

- Integral soap ledges.
- Single threshold for alcove installation.
- Center drain.
- Requires the K-9459 Sonata accessory kit (sold separately).
- Please contact your distributor for this product's pricing information.

Material

- Acrylic.

Recommended Products/Accessories

K-1665 Shower Light
K-1695 Steam Generator
K-9499 Removable Shower Seat
K-9132 Shower Drain
K-9459 Grab Bar and Shelf Accessory Kit
K-5526 7 kW Steam Generator
K-5557 steam generator control kit
K-23726 Drain treatment
K-23732 Tub & shower cleaner



Codes/Standards

CSA B45.5/IAPMO Z124
ASTM E162
ASTM E662

KOHLER® Plastic Baths and Receptors Lifetime Limited Warranty

See website for detailed warranty information.

Available Colors/Finishes

Color tiles intended for reference only.

Color	Code	Description
-------	------	-------------



0	White
---	-------



G9	Sandbar
----	---------

KOHLER®

Sonata®

60" shower stall integral high-dome ceiling, requires grab bar

K-1688

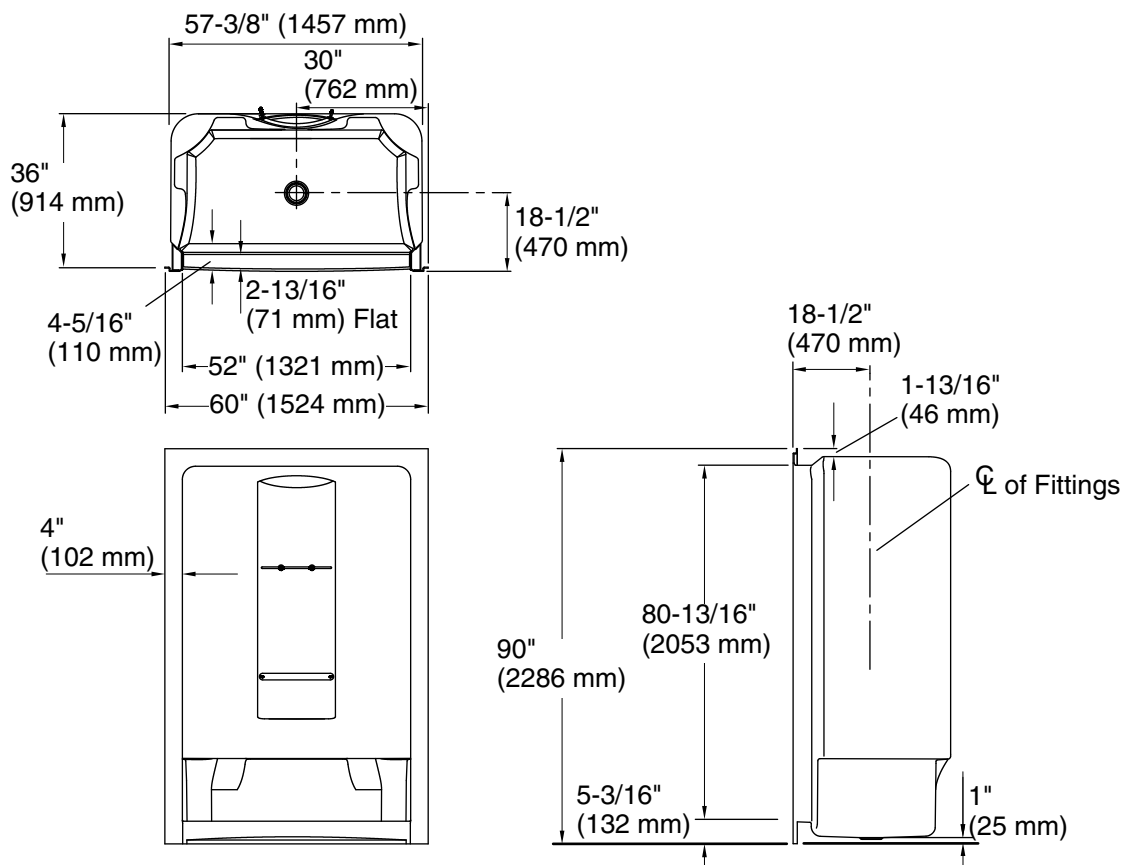

Technical Information

All product dimensions are nominal.

Installation: Three-wall alcove

Drain location: Center

Weight: 200 lbs (90.7 kg)

Minimum floor load: 28 lbs/ft² (136.7 kg/m²)

Notes

Measure your actual product for rough-in details.

Install this product according to the installation instructions.

KOHLER steam generator/control kit are designed for use with this product. Kohler Co. shall not be responsible for problems encountered due to the installation and use of other manufacturer's steam generators.